

# Final Reclamation Inspection

March 23, 2026

Operator: PDC ENERGY INC

Location ID: 323520

Inspection Document #: 720300201

Weld County, CO

Isaac Thibedeau  
Reclamation Specialist, ECMC



**COLORADO**

**Energy & Carbon Management  
Commission**

Department of Natural Resources

Inspection Photos  
Location Name: SKURICH-ROTHE-65N63W /6NESE  
Location ID: 323520

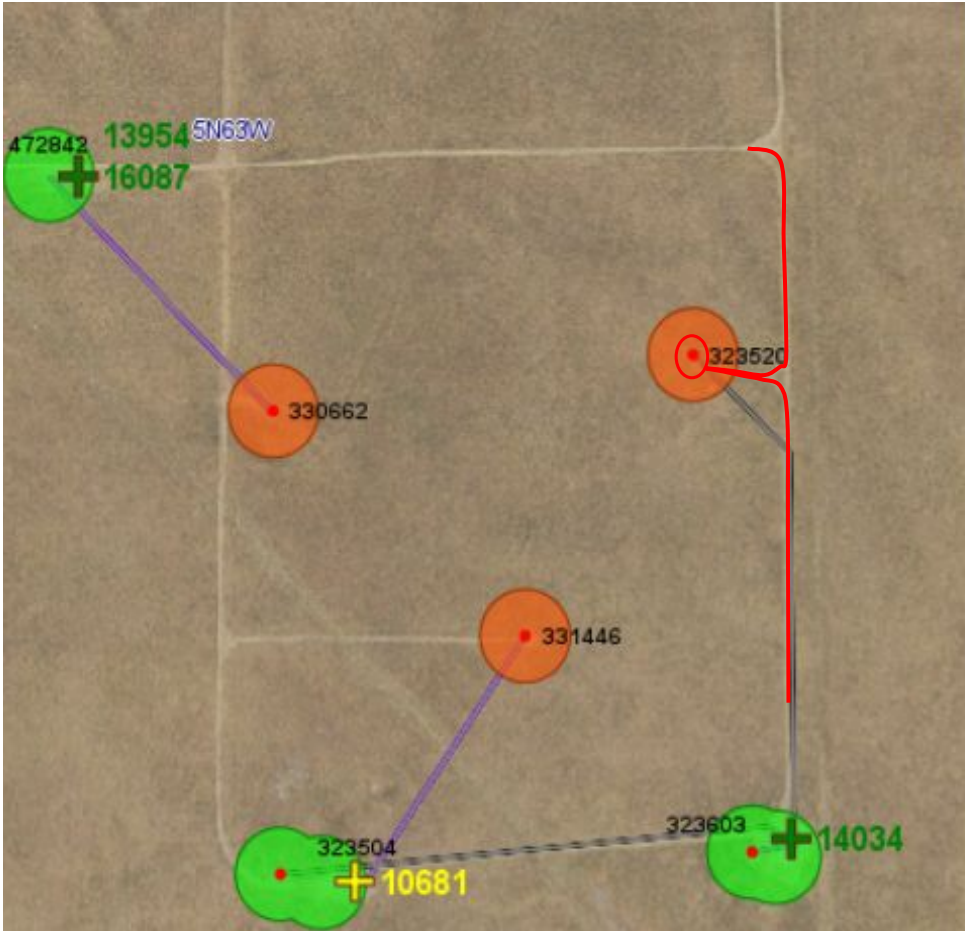
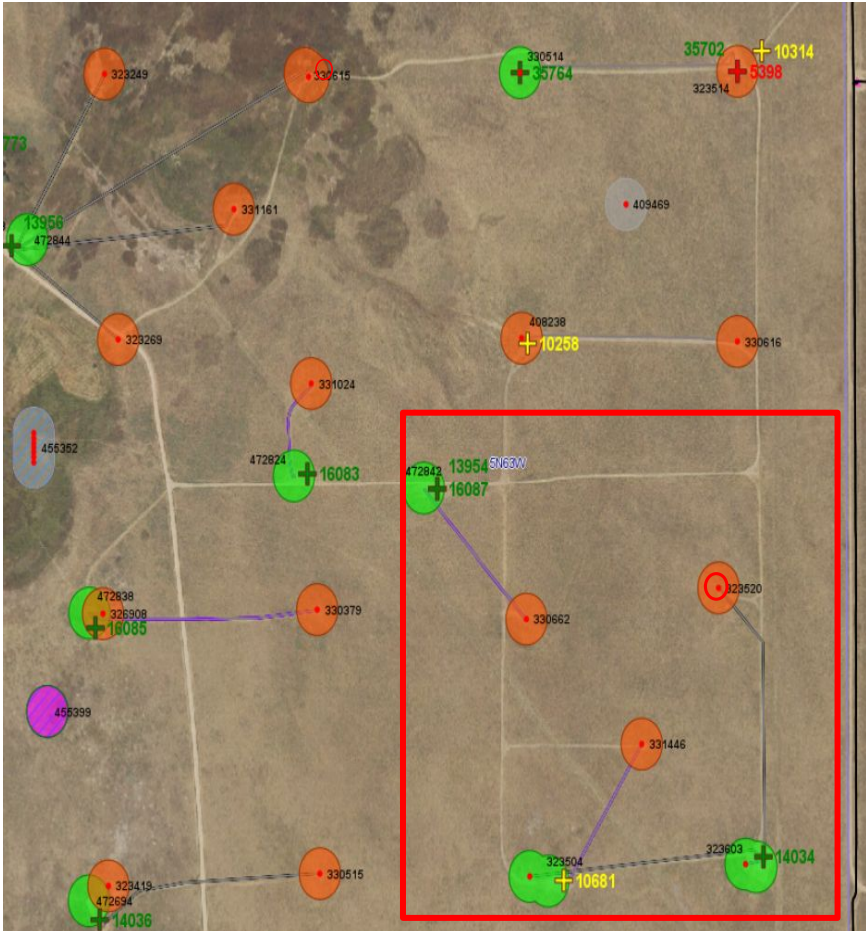

**Photo 1 & 2:** Satellite image of the location showing an overview of the area; the access road and well location are highlighted with a red circle and line.



## Inspection Photos

Location Name: SKURICH-ROTHER-65N63W /6NESE

Location ID: 323520



**Photo 3.** Photo taken from the disturbance area facing east showing the establishment of desirable vegetation in the disturbance area. Bare soil is present where the well was previously located and on the access road.



**Photo 4.** Photo taken from the disturbance area facing west, see comment under photo 3.



Inspection Photos

Location Name: SKURICH-ROTHER-65N63W /6NESE

Location ID: 323520



**Photo 5.** Photo taken from the disturbance area facing south showing the establishment of desirable vegetation.



**Photo 6.** Photo taken from the disturbance area facing north, showing the establishment of some desirable vegetation and bare soil where the well was located.



## Inspection Photos

Location Name: SKURICH-ROTHE-65N63W /6NESE

Location ID: 323520



**Photo 7.** Photo taken from the disturbance area facing southeast, showing establishment of desirable vegetation.



**Photo 8.** From the access road, facing east, the well location is approximately 30 feet west of the photo location. Road has a small amount of desirable vegetation establishment, but is mostly bare soil.

Inspection Photos

Location Name: SKURICH-ROTHE-65N63W /6NESE

Location ID: 323520



**Photo 9.** Photo taken from the east side of the well access road at its intersection with the lease road, showing bare soil and the establishment of undesirable vegetation.



**Photo 10.** Photo taken from the lease road facing south showing bare soil and the establishment of undesirable vegetation.



Inspection Photos

Location Name: SKURICH-ROTHE-65N63W /6NESE

Location ID: 323520



**Photo 11.** Photo taken from the lease road north of the well location, showing bare soil and some establishment of desirable vegetation on the east side of the road.



**Photo 12.** Photo taken from access road north of well location, showing bare soil and some establishment of desirable vegetation on the east side of access road.

