

Final Reclamation Inspection

March 23, 2026

Operator: PDC ENERGY INC

Location ID: 330514

Inspection Document #: 720300170

Weld County, CO

Isaac Thibedeau
Reclamation Specialist, ECMC



COLORADO

**Energy & Carbon Management
Commission**

Department of Natural Resources

Inspection Photos
Location Name: SKURICH ROTHE-65N63W 6NENW
Location ID: 330514

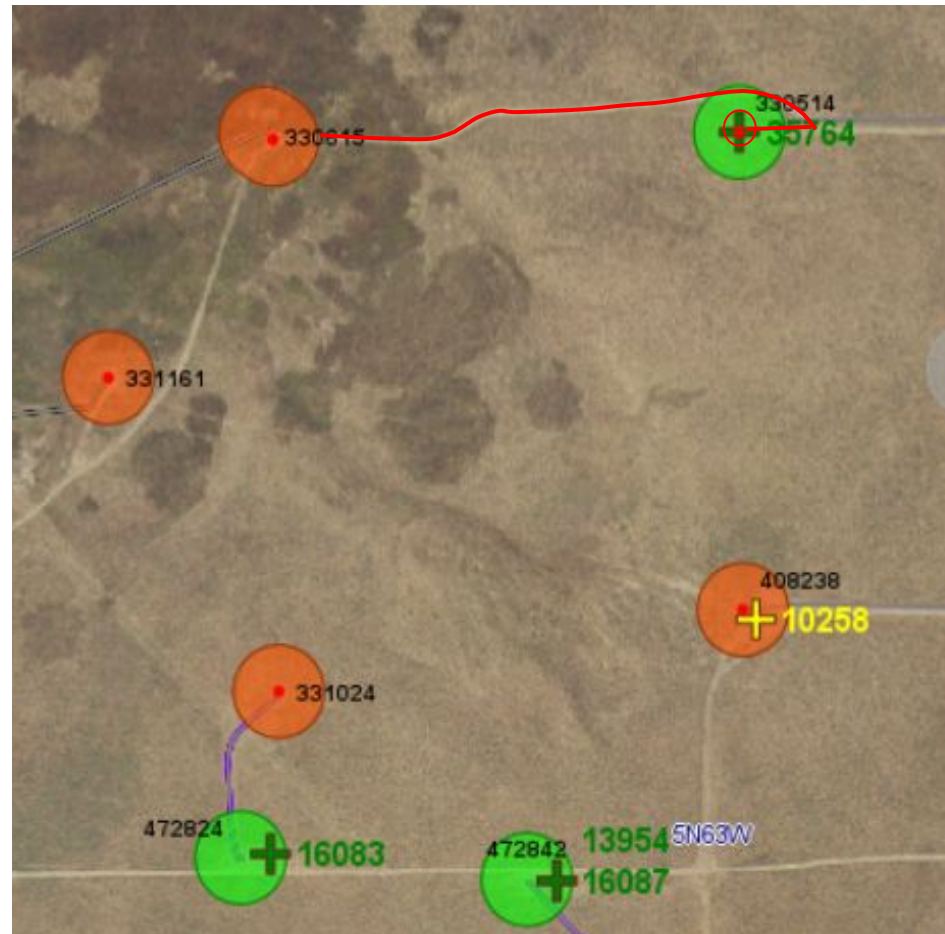
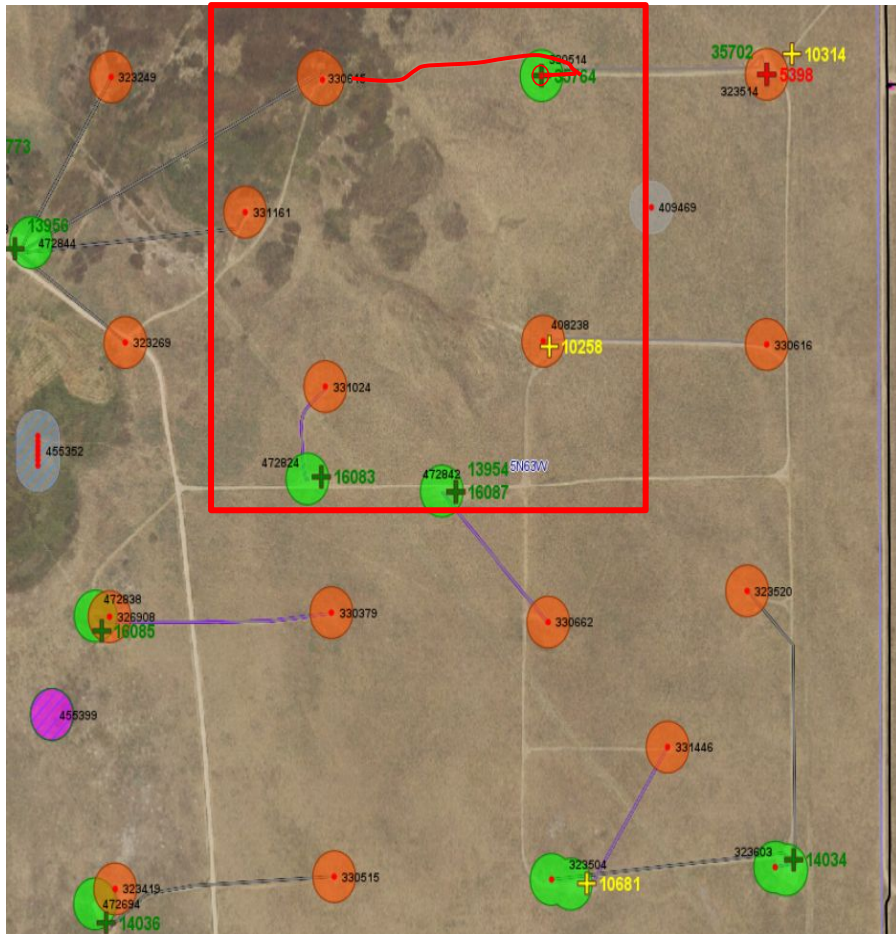

Photo 1 & 2: Satellite image of location showing an overview of area with the main lease road, access road and location highlighted in red.

Inspection Photos

Location Name: SKURICH ROTHE-65N63W 6NENW

Location ID: 330514



Photo 3. Photo taken north of main lease road facing northeast, Showing reference are for road.



Photo 4. Photo taken from the main lease going west to east, facing northeast, showing bare soil. Some drill seeding was performed, and manure was spread on the main lease road. The majority of the road is comprised of bare soil, and more work is needed to meet final reclamation standards.



Inspection Photos

Location Name: SKURICH ROTHE-65N63W 6NENW

Location ID: 330514



Photo 5. Photo taken from the main lease going west to east, facing northeast. See comment under photo 4.



Photo 6. Photo taken from the main lease going west to east. See comment under photo 4. Baling twine from reclamation activities was found throughout the access road.



Inspection Photos

Location Name:SKURICH ROTHE-65N63W 6NENW

Location ID: 330514



Photo 7. Photo taken from location facing north, showing growth of some desirable grass species as well as bare soil present on disturbance area.



Photo 8. Photo taken from the location facing east showing bare soil on the location and the location access road.



Inspection Photos

Location Name:SKURICH ROTHE-65N63W 6NENW

Location ID: 330514



Photo 9. Photo taken from the location, facing south, showing bare soil in the foreground; in the mid-ground, a small number of undesirable weed species; and in the background, desirable vegetation growth.



Photo 10. Photo taken from the location facing west shows bare soil as well as some desirable grass species growing. Some undesirable weeds are present, highlighted in the red circle.



Inspection Photos

Location Name: SKURICH ROTHE-65N63W 6NENW

Location ID: 330514



Photo 11. Photo taken from the western edge of the disturbance area facing west, showing the reference area with desirable grass species growing.



Photo 12. Photo taken from the location access road, facing east, showing that most of the road is bare soil.

Inspection Photos
Location Name:SKURICH ROTHE-65N63W 6NENW
Location ID: 330514



Photo 13. Photo taken at the point where the secondary access road intersects the main lease road. To the right of the red line is the main lease road and the location access road is outlined by the two blue lines. Both roads have significant bare soil, and more work is needed to meet final reclamation standards. Work was recently completed on the main lease road but not on access road to well location.