



**Flowlines**

- Abandoned
- Active
- Out of Service
- Pre-Commissioned
- Removed
- Turned into Air Line
- Area of Conflict  
(Proposed Abandon-in-Place Area)
- X Proposed Soil Sample Location
- Field Screening Location

**Wells**

- Active Well
- ◆ Abandoned Location
- ✦ Plugged & Abandoned
- ✦ Producing
- ✦ Shut-In
- ✦ Temporarily Abandoned
- ✦ Waiting on Completion

**Third-Party Pipelines**

- — — —
- — — —
- NWI Wetlands

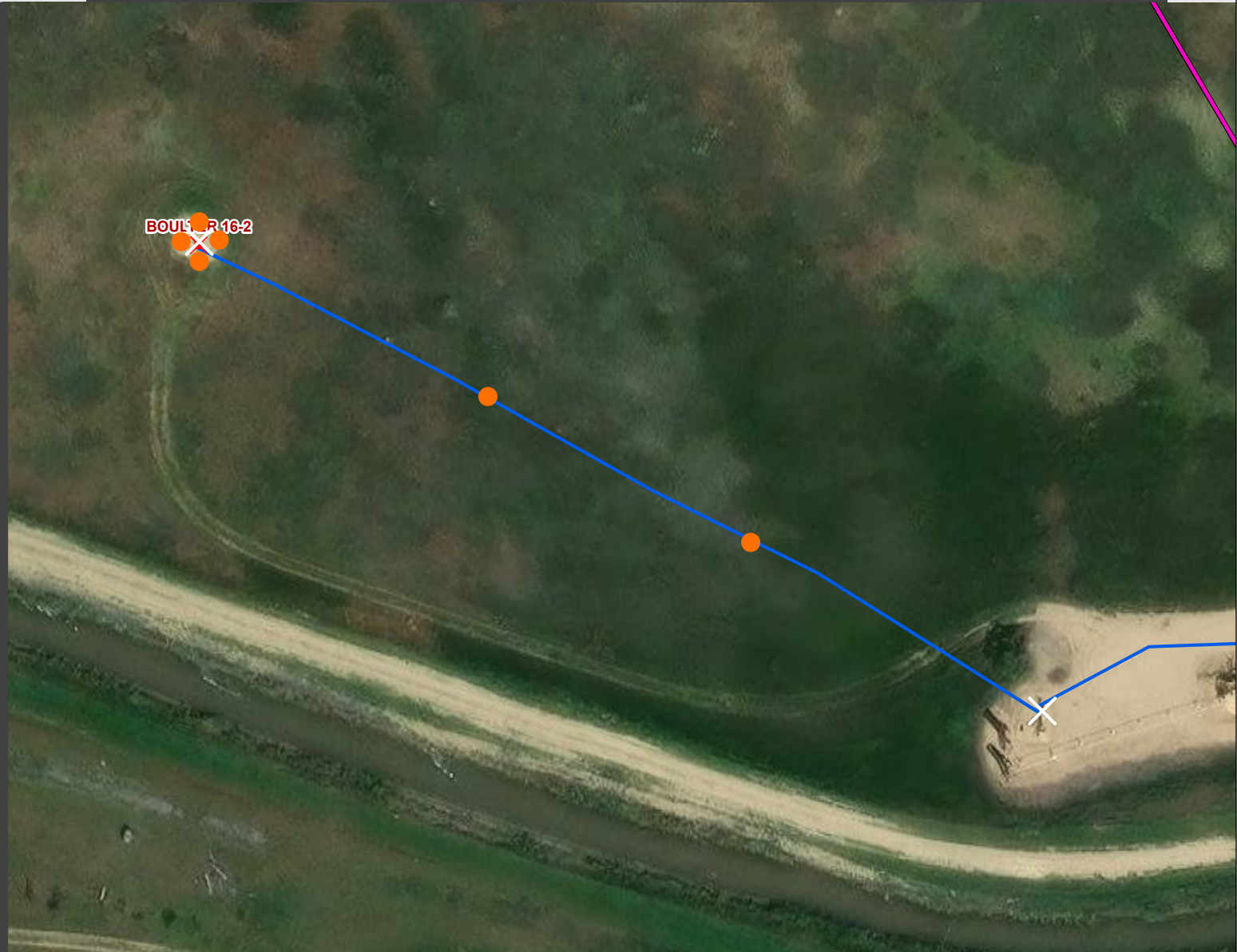

Well Latitude/Longitude: 40.3082800/-104.6702500  
Flowline Length (ft): 470

Flowline Point A Latitude/Longitude: 40.3076375/-104.6687865  
Flowline Point B Latitude/Longitude: 40.3082720/-104.6702539

Created by: CJENCK  
Date: 3/12/2026

