







Legend

-  P&A'd Wellhead
 -  Soil Sample
 -  Soil Screening
 -  Soil Vapor Point (SVP)
 -  Approximate Location of Flowline (Removed)
 -  Excavation Extent
- Note: Verification sample results have been omitted from the figure.



Rangeland

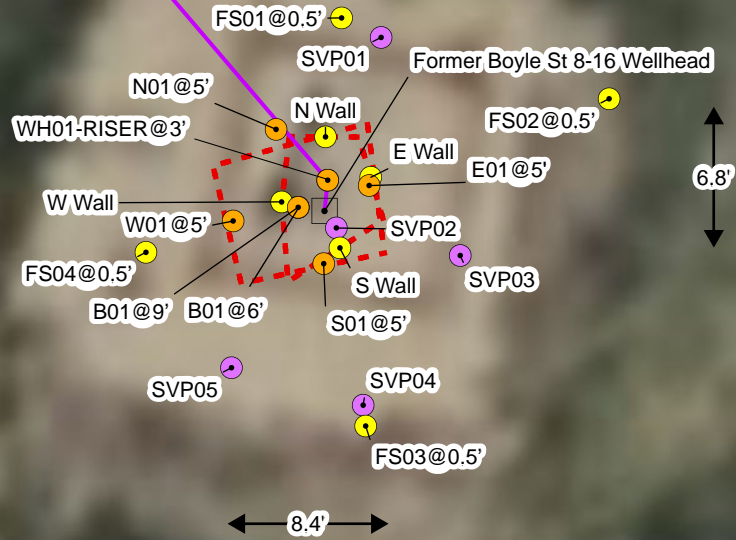

Rangeland

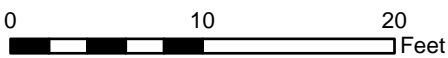

Sources: Environmental Systems Research Institute (ESRI)

Default Folder: C:\Users\Maregan\OneDrive - ENSOLUM, LLC\Ensolium\GIS\0 - Projects\Kerr-McGee Oil & Gas Onshore, LP\09A1417746 - Boyle St 8-16 Wellhead

Wellhead Excavation Site Map

Boyle St 8-16 Wellhead
 Kerr-McGee Oil & Gas Onshore, LP
 SENE SEC 16-T2N-R66W
 Weld County, CO

Project Number: 09A1417746



FIGURE
1