

UNION PACIFIC 112X21

API# 05-103-08735

Existing facilities & roads

To reach Union Pacific 112x21 well location in NW ¼ NW ¼ of Section 21, T2N, R102W, 6<sup>th</sup> P.M., Rio Blanco County, Colorado. Proceed west from Rangely town on Colorado State Highway 64 for approximately 2.3 miles to County Road 1 and then turn right (north) for 1.93 miles, turn right (east) for 0.8 miles, turn right (north) for 0.23 miles stay to the left and continue heading north for another 0.3 miles, then turn left onto access road to UP 119x21 continue through location to existing well location Union Pacific 112x21.

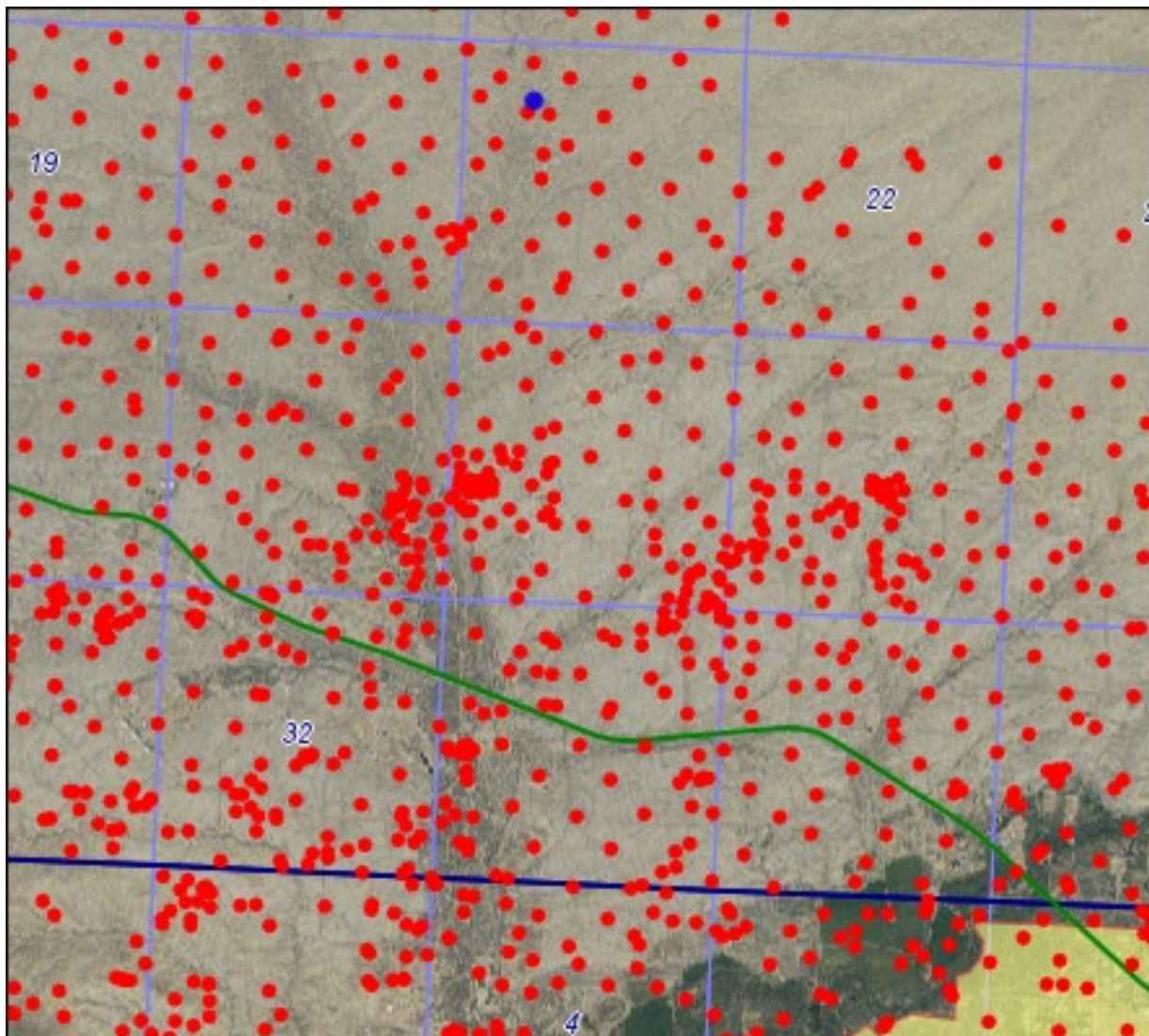

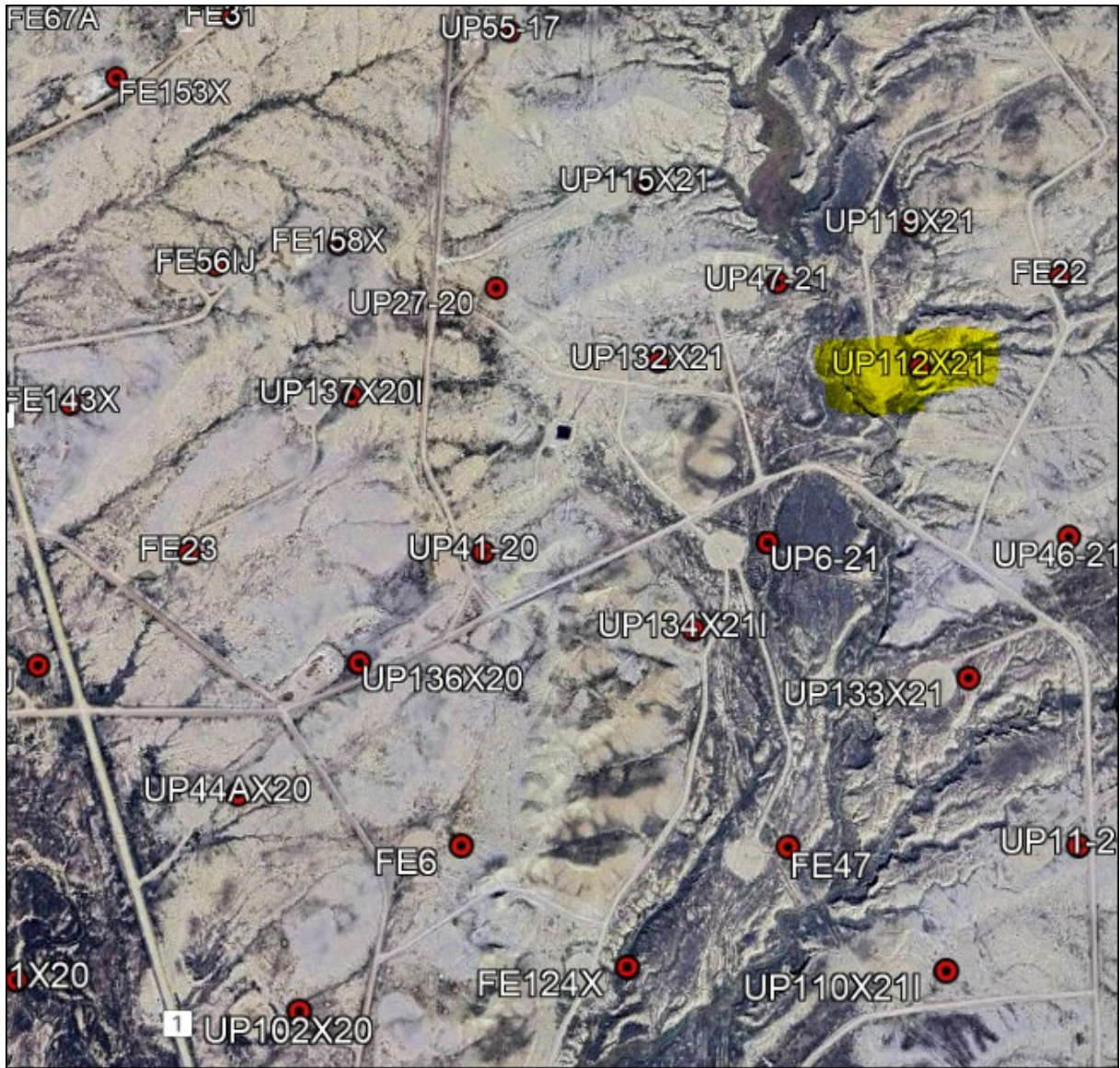

There is no anticipated construction on any portion of the above-described roads. They will meet the necessary standards required to facilitate an orderly flow of traffic during the recompletion and production activities.

The proposed UIC conversion to injection will support the efficient management of our produced water and our Enhanced Oil Recovery efforts in the Rangely Weber Sand Unit. Improved economics associated with this UIC conversion will help prolong the life of the field and support ongoing production.

Scout Energy Partners will minimize impacts to wildlife and the surrounding ecosystems by utilizing the existing Union Pacific 112x21 well pad, roads, and wellbore. This will eliminate the need for drilling and completion operations to take place as well as road and well pad construction. Also, by increasing our produced water injection capacity we reduce the possibility of having to use trucks to haul off excess water which will benefit wildlife species that experience adverse effects from increases in traffic and benefit the surrounding ecosystem by reducing vehicle emissions. Lastly, by converting this existing well to an injection well and increasing our produced water injection capacity we will reduce the injection pressures within our system which also reduced the chances of a flowline leak which can negatively affect the surrounding wildlife and ecosystems.

Water Source – The nearest water of the state is 3.54 miles south the nearest water resource is the White River. Scout Energy Partners does not anticipate any impacts to any water resources in the area.

1500 Feet Radius Map

