

103-08365

Exhibit "A"

Location & Elevation Plat

FORM F-108



21900314

R. 101 W

RECEIVED N

JUN 7 1979

SOIL OIL & GAS COMS. COMM.

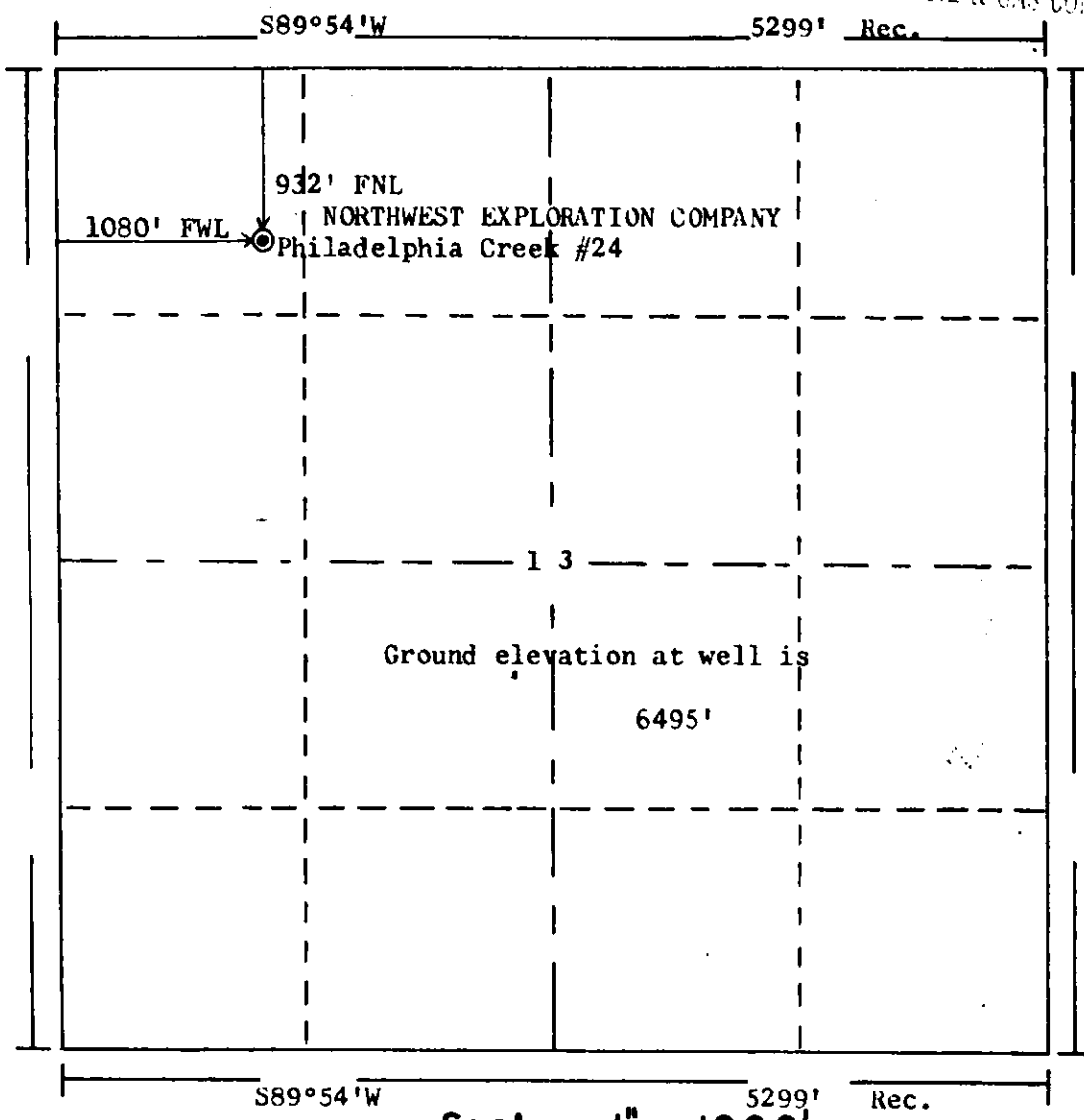

N0°01'W
5280'
Rec.



T.2 S

North
5280'
Rec.

Scale... 1" = 1000'

Powers Elevation Company, Inc. of Denver, Colorado
 has in accordance with a request from Don Maroncelli
 for **NORTHWEST EXPLORATION COMPANY**
 determined the location of Philadelphia Creek # 24
 to be 932' FNL & 1080' FWL Section 13 Township 2 S
 Range 101 W of the Sixth Principal Meridian, Colorado
 Rio Blanco County, Colorado

I hereby certify that this plat is an
 accurate representation of a correct
 survey showing the location of
 Philadelphia Creek #24

Date: 11/17/78

T. Nelson
 Licensed Land Surveyor No.
 State of Colorado

PELS #2188

RECEIVED

JUN 7 1979

STATE OIL & GAS COM. COMM.

LEASE DESCRIPTION

USA C-12997

Township 2 South, Range 101 West

Section 1: S/2

Section 11: all

Section 12: all

Section 13: all