



BEST COPY AVAILABLE

RECEIVED

OCT 16 1973

R. 55W



00247778

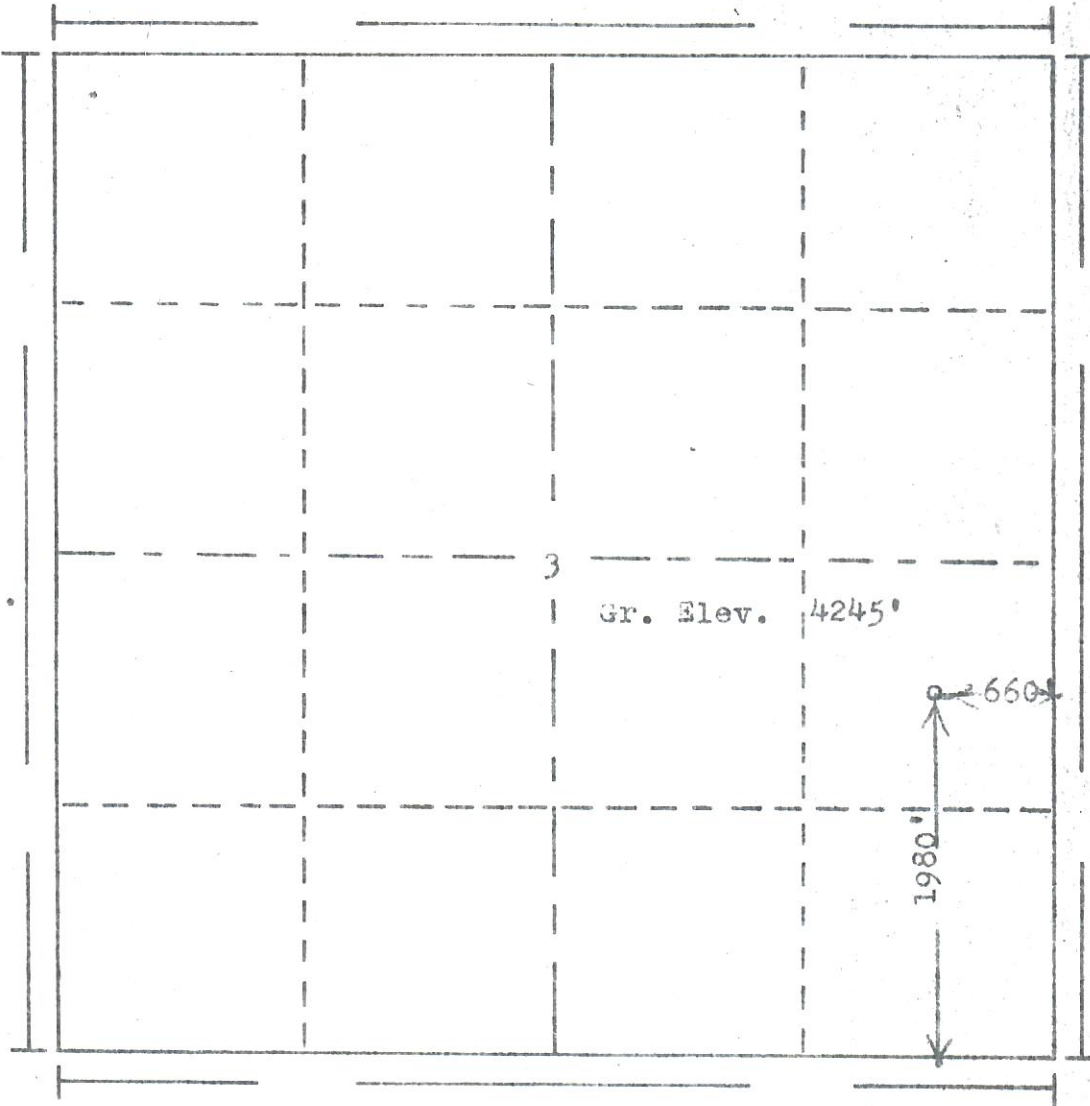

T. 8 N

Scale... 1" = 1000'

Powers Elevation Company, Inc. of Denver, Colorado has in accordance with a request from Mr. Murphree for Onmar Oil Co.

determined the location of No.17 Budin to be 1980'FS & 660'FE Section 3 Township 8N Range 55W of the 6th Principal Meridian Logan County, Colorado

I hereby certify that this plat is an accurate representation of a correct survey showing the location of

Date: 10-2-78

*B. J. H. [Signature]*  
Licensed Land Surveyor No) 2853  
State of Colorado

X 13