



RECEIVED

APR 12 1979

COLO. OIL & GAS CONS. COMM.

R. 55W

79-243

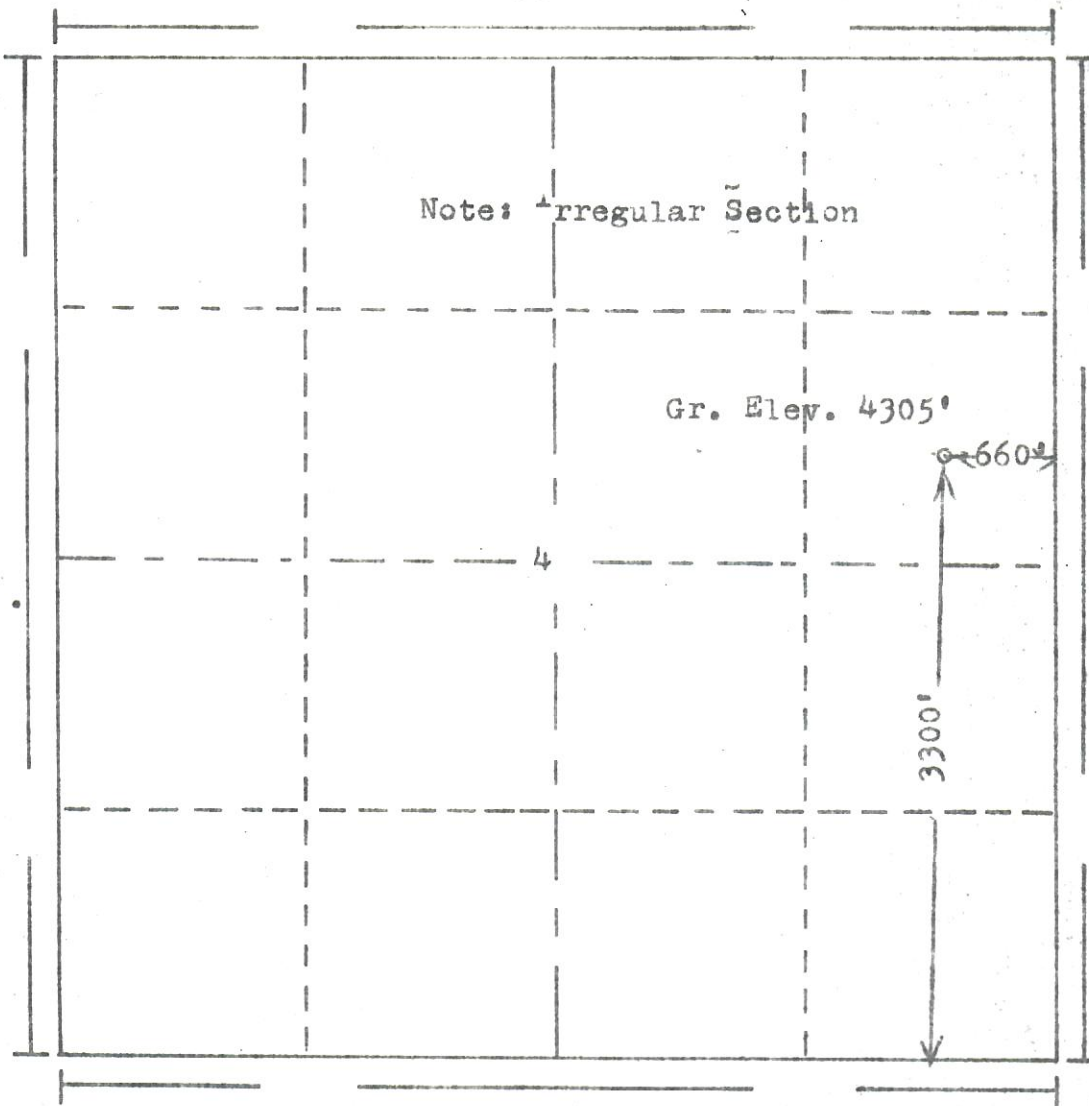

T.
8
N

Scale... 1" = 1000'

Powers Elevation Company, Inc. of Denver, Colorado has in accordance with a request from Mr. Brown for Kimbark Operating Co.

determined the location of No.1 Sandhouse to be 3300'FS & 660'FE Section 4 Township 8N Range 55W of the 6th Principal Meridian Logan County, Colorado

I hereby certify that this plat is an accurate representation of a correct survey showing the location of

Date: 4-5-79

Barry J. Hickey
Licensed Land Surveyor No. 2853
State of Colorado