

103-10 256



01735173

ENCANA OIL & GAS (USA) INC.

ADDENDUM TO LEGAL PLAT FOR

FOUNDATION CREEK #7445

SECTION 23, T4S, R102W, 6th P.M.

1017' FSL 1053' FWL



SCALE: 1" = 50'
DATE: 09-04-02
Drawn By: D.COX

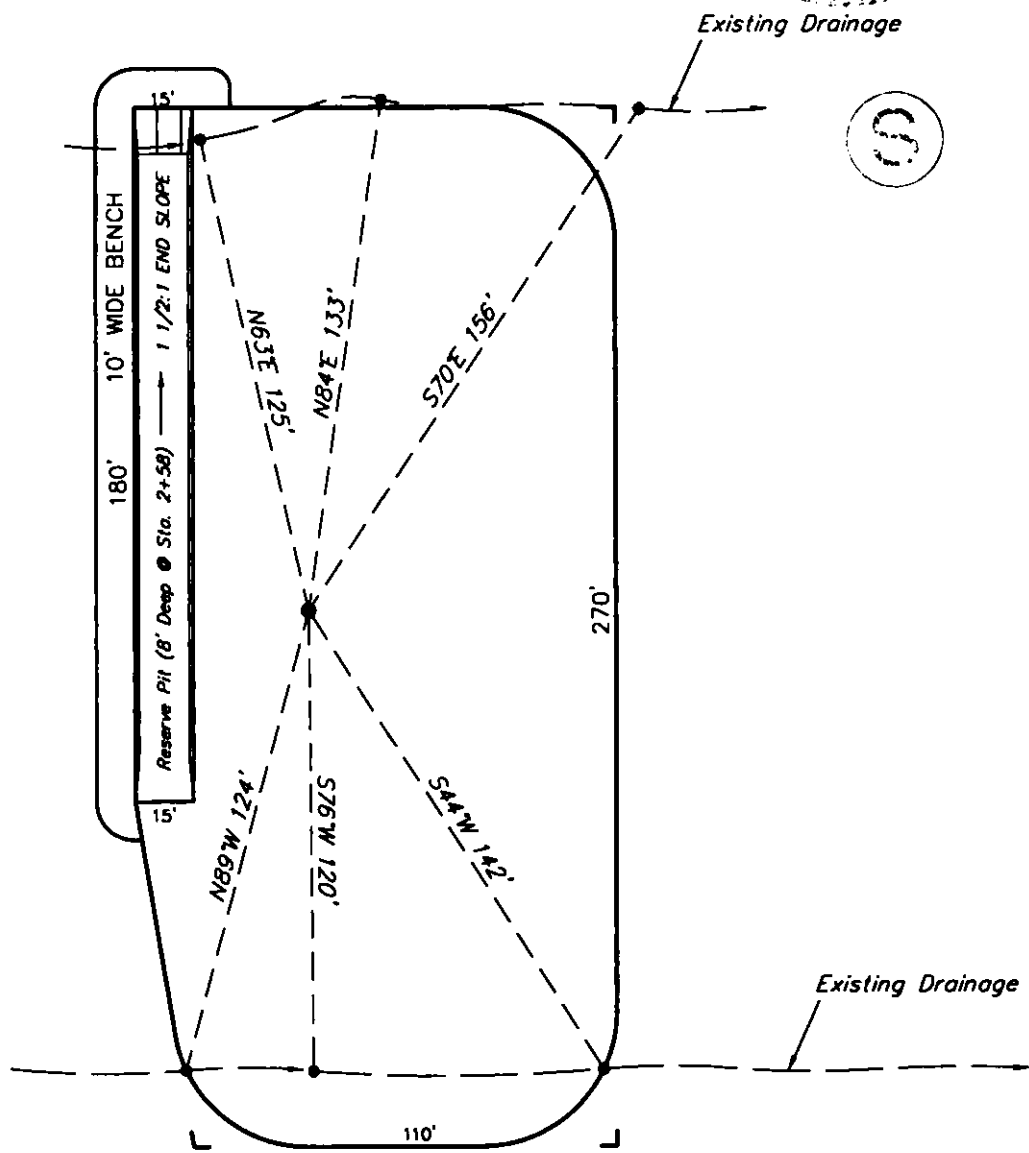

Note:
Pit Capacity With
2' of Freeboard
is ±820 Bbls.

NOTE:
SURFACE USE OF LOCATION IS GRAZING,
VEGETATION CONSISTS MAINLY OF
SAGEBRUSH, SERVICEBERRY, GREASEWOOD,
PINION AND NATIVE GRASSES.

FIGURE #3