



FORM F-106

103-08364



01920309

R. 101 W

EXHIBIT "A"  
Location & Elevation Plat

RECEIVED

JUN 7 1979

POWERS OIL & GAS CORP. CORP.  
Rec.

N



T. 2 S

NO°01'W  
5280'  
Rec.

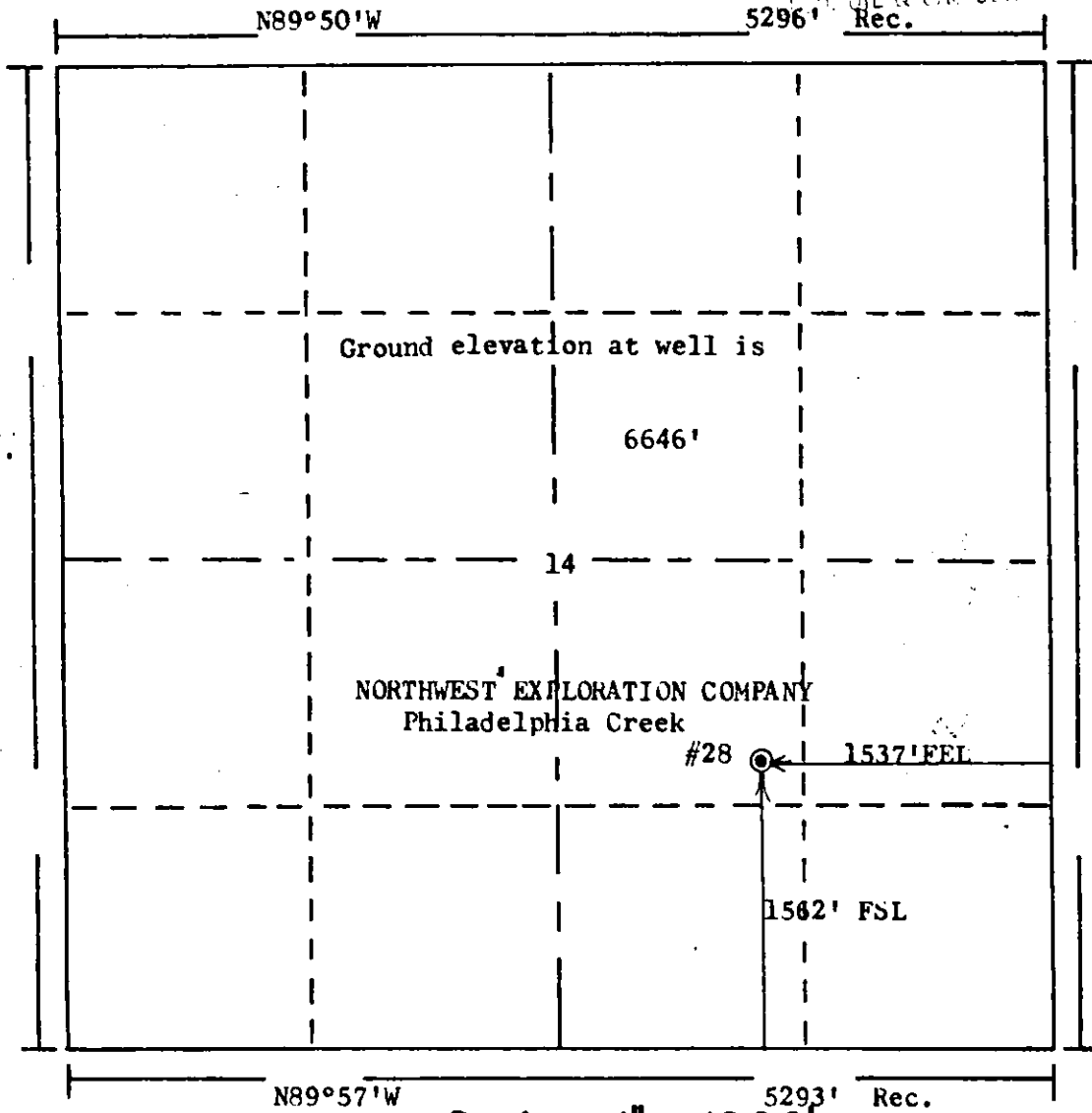

Scale... 1" = 1000'

**Powers Elevation Company, Inc. of Denver, Colorado**  
 has in accordance with a request from Don Maroncelli  
 for **NORTHWEST EXPLORATION COMPANY**  
 determined the location of **Philadelphia Creek #28**  
 to be 1562' FSL & 1537' FEL **Section 14 Township 2 S**  
**Range 101 W of the Sixth Principal Meridian, Colorado**  
Rio Blanco **County, Colorado**

I hereby certify that this plat is an  
 accurate representation of a correct  
 survey showing the location of  
 Philadelphia Creek #28

Date: 11/18/78

J. Nelson  
 Licensed Land Surveyor No. **PELS #2188**  
 State of **Colorado**