

103-08224



01900323

T2S, R101W, 6th P.M.

PROJECT

NORTHWEST PIPELINE CORP.

Well location, PHILADELPHIA CREEK  
 No 12X located as shown in the SE1/4  
 NW 1/4 Section 12, T2S, R101W, 6th  
 P.M., Rio Blanco County, Colorado.

Original plat Well #12  
 amended for Well #12X

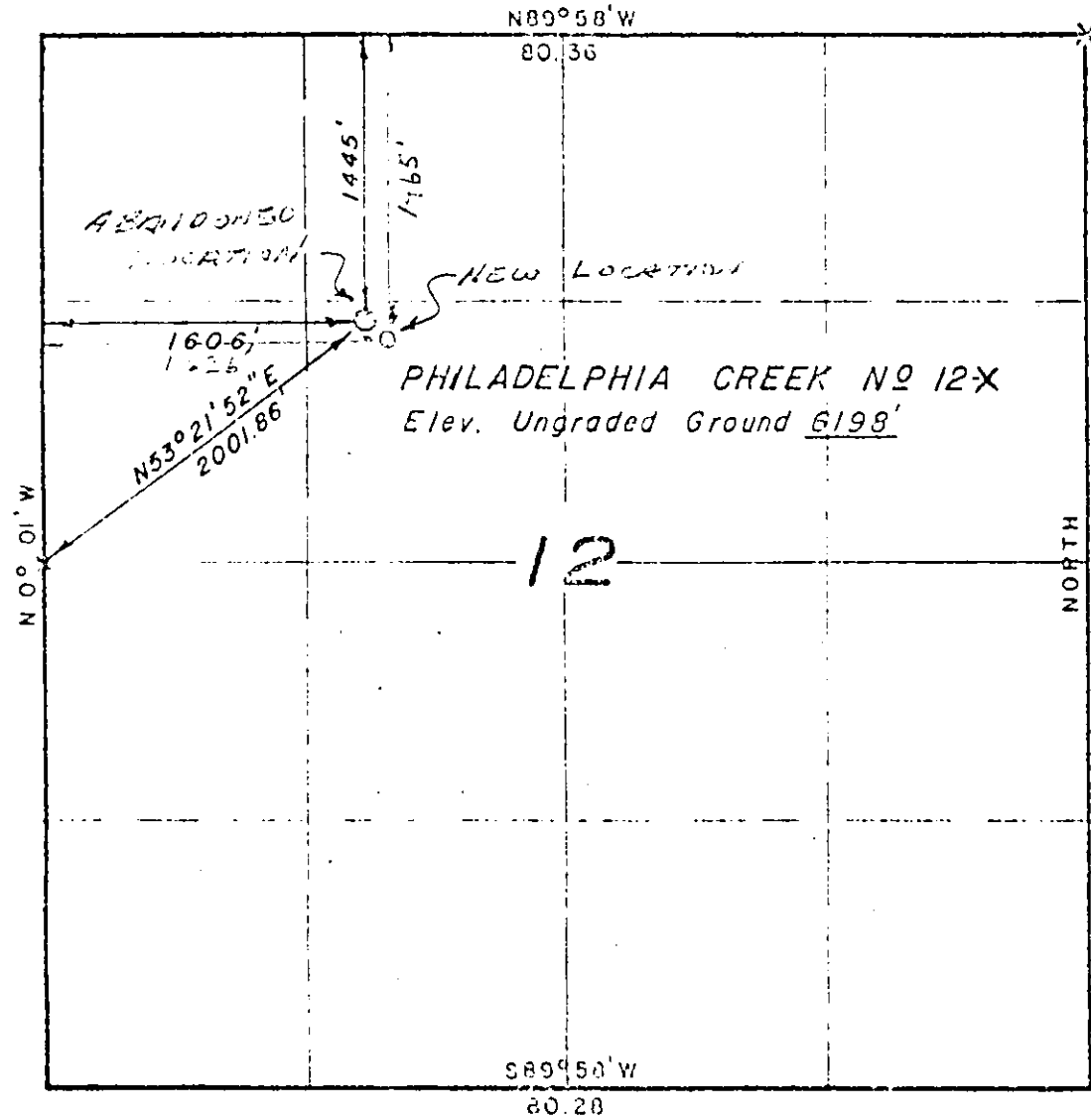

RECEIVED JUN 10 1978  
 1978  
 COLO. OIL & GAS CONS. COM.  
 DENVER, CO.

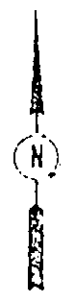

CERTIFICATE

THIS IS TO CERTIFY THAT THE ABOVE PLAT WAS PREPARED FROM  
 FIELD NOTES OF ACTUAL SURVEYS MADE BY ME OR UNDER MY  
 SUPERVISION AND THAT THE SAME ARE TRUE AND CORRECT TO THE  
 BEST OF MY KNOWLEDGE AND BELIEF

*Lawrence C. Key*  
 REGISTERED LAND SURVEYOR  
 REGISTRATION NO 9019  
 STATE OF COLORADO

UINTAH ENGINEERING & LAND SURVEYING  
 P.O. BOX Q - 110 EAST - FIRST SOUTH  
 VERNAL, UTAH - 84078

X = Corners Located & Used.

SCALE 1" = 1000'	DATE 28 April 1977
PARTY R.K., D.D. & D.J.	REFERENCES GLO Plat
WEATHER Cool	FILE Northwest Pipeline Corp.