

Rig # 4

RECEIVED

AUG 29 1975

COLO. OIL & GAS CONS. COMM.

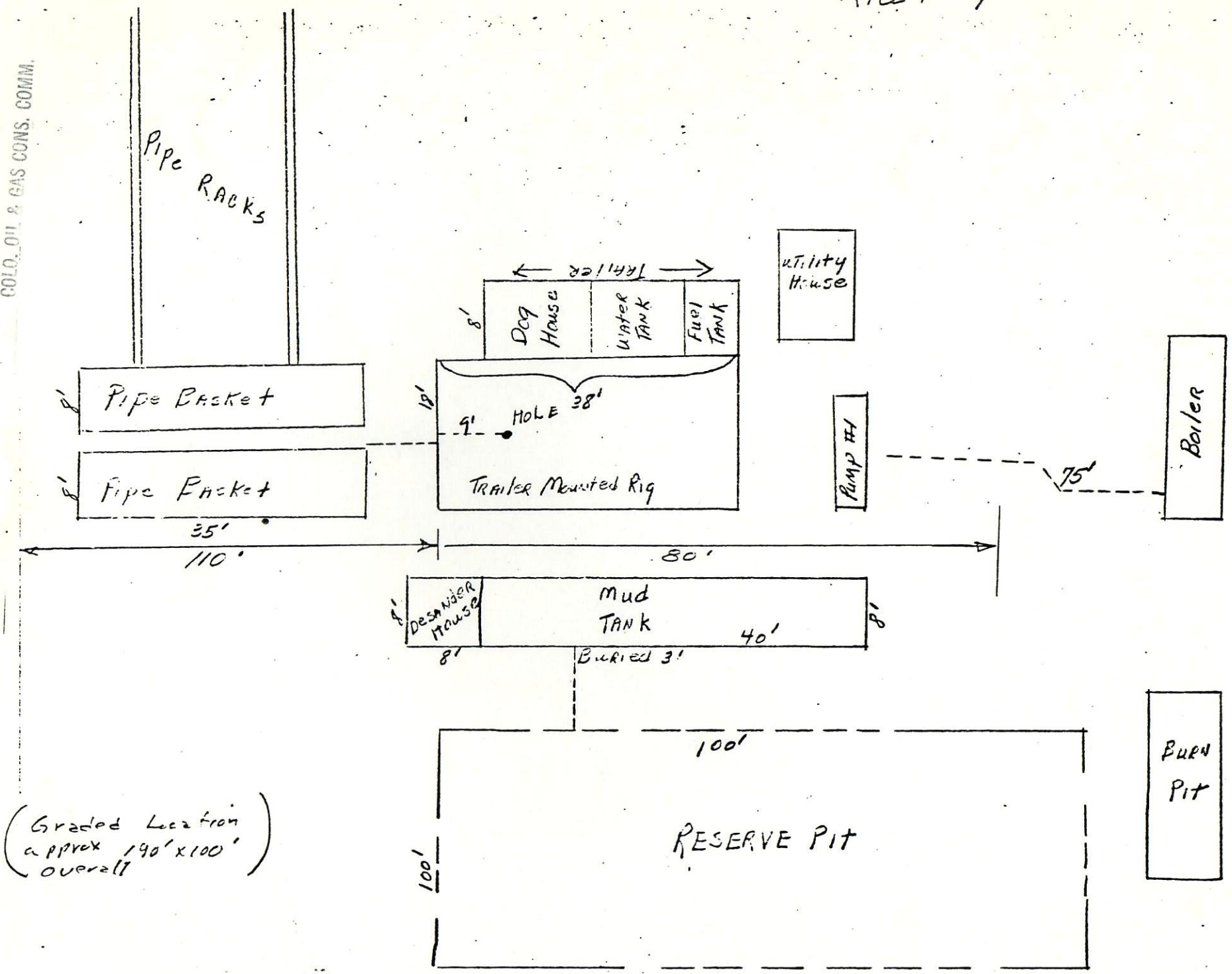

(Graded Loc from approx 190' x 100' overall)



00257646

Mr. E. W. Gynn
August 28, 1975
Page 2

10. Location Layout to Include Position of the Rig, Mud Tank, Reserve Pit, Trash Pit, Pipe, Rock, etc. - See rig layout plat.
11. Plans for Restoration of the Surface - Return surface grade to approximate conformation prior to operations.
12. Any other information which the Approving Officer considers essential to this Assessment of the Impact on the Environment.
This is gently sloping terrain, sparsely covered with scrubby sage brush and range grass. All grading will be held to a minimum. Surface is owned by Lynn Dean Seldomridge and Verla Lee Williams of Hawthorne, California, and leased by Visintainer Sheep Company. Agreement has been made with Visintainer to clean up and return surface to satisfactory condition.

The following is the seven point pressure monitoring and control data:

1. Surface casing - 8-5/8", 24#, new K-55 casing to be set at 300' and cemented to surface.
2. Casing head - 3000#, 10" flanged with 2000# working pressure valves.
3. No intermediate casing.
4. Blowout preventers:
10" 900 API series hydraulic double gate (pipe and blind rams).
5. Auxiliary equipment - Float at bit. Sub on floor with full opening valve for stabbing into drill pipe.
6. Anticipated bottom hole pressure at total depth 1840 psi maximum.
7. To be drilled with water to 3500', mud up with 9.5#/gallon mud to drill to total depth.

Yours very truly,

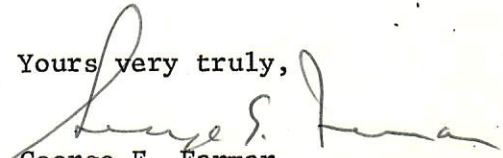
George E. Farmar
Division Operations Manager

GEF/ljb
Enclosures

cc: Colorado Oil & Gas Conservation Commission
Bureau of Land Management, Craig, Colorado
Moffat County Planning Department