



RECEIVED

NOV 21 1968

COLO. OIL & GAS CONS. COMM.

R. 49 W

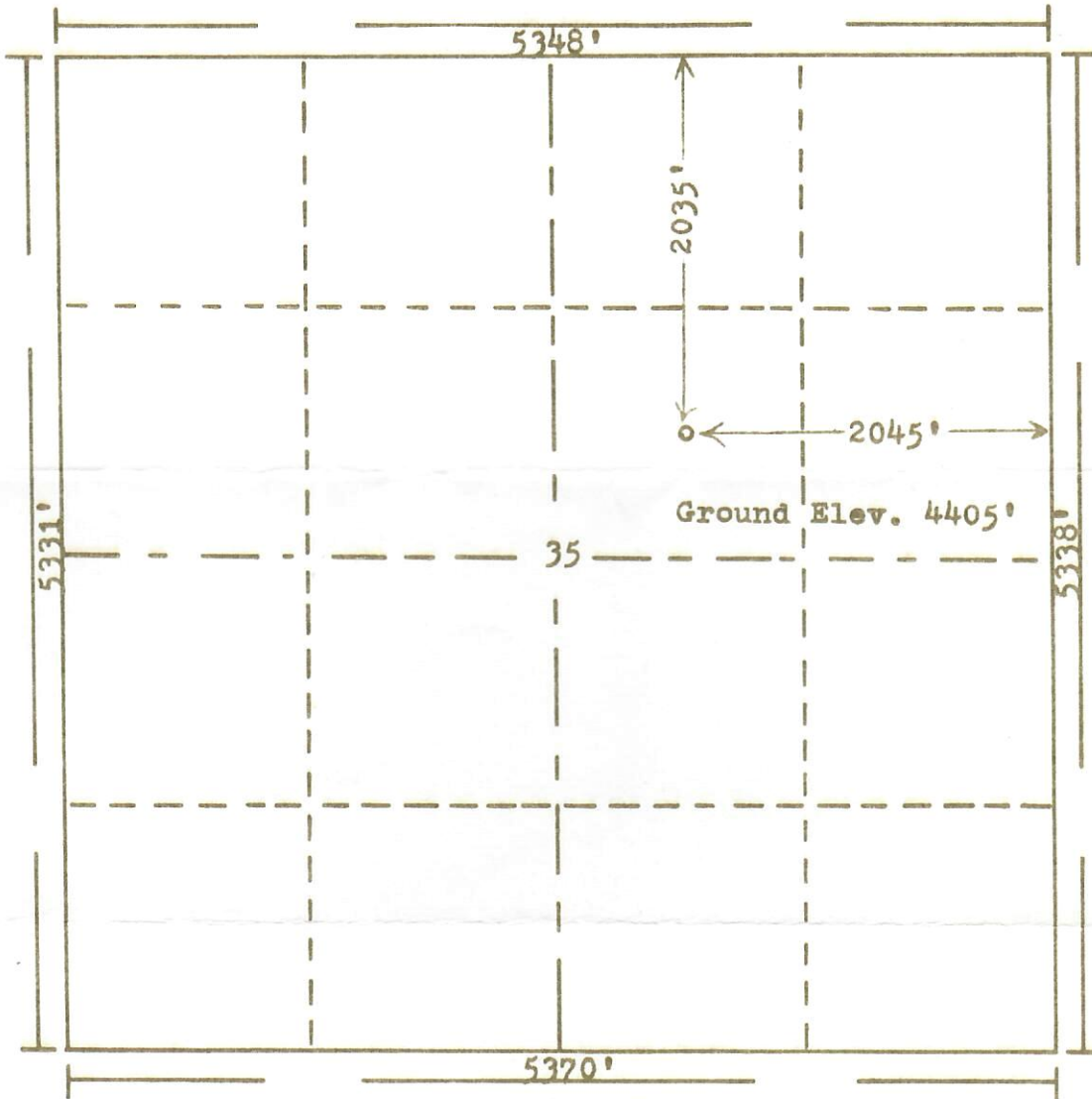

T.
3
S

Scale... 1" = 1000'

Powers Elevation Company, Inc. of Denver, Colorado
 has in accordance with a request from **Mary Abel**
 for **Jim Snyder & Exeter Drilling Co.**
 determined the location of **No.1 Simpson**
 to be **50' SW of C SW NE** **Section 35** **Township 3 South**
Range 49 West of the 6th Principal Meridian
Washington County, Colorado

I hereby certify that this plat is an
 accurate representation of a correct
 survey showing the location of

Date: 11-17-68

Billy J. Hollen

Licensed Land Surveyor No. 2853
 State of Colorado

68-471