

RECEIVED

SEP 17 1979

COLD. OIL & GAS CONS. COMMI.

T 9 N, R 89 W, 6th P.M.

PROJECT
CONOCO INCORPORATED

Well location, FEDERAL 21#1,
located as shown in the SW1/4SW1/4
Section 21, T9N, R89W, 6th P.M.
Moffat County, Colorado.

NOTE:

Basis of Bearings is from Solar
Observations.

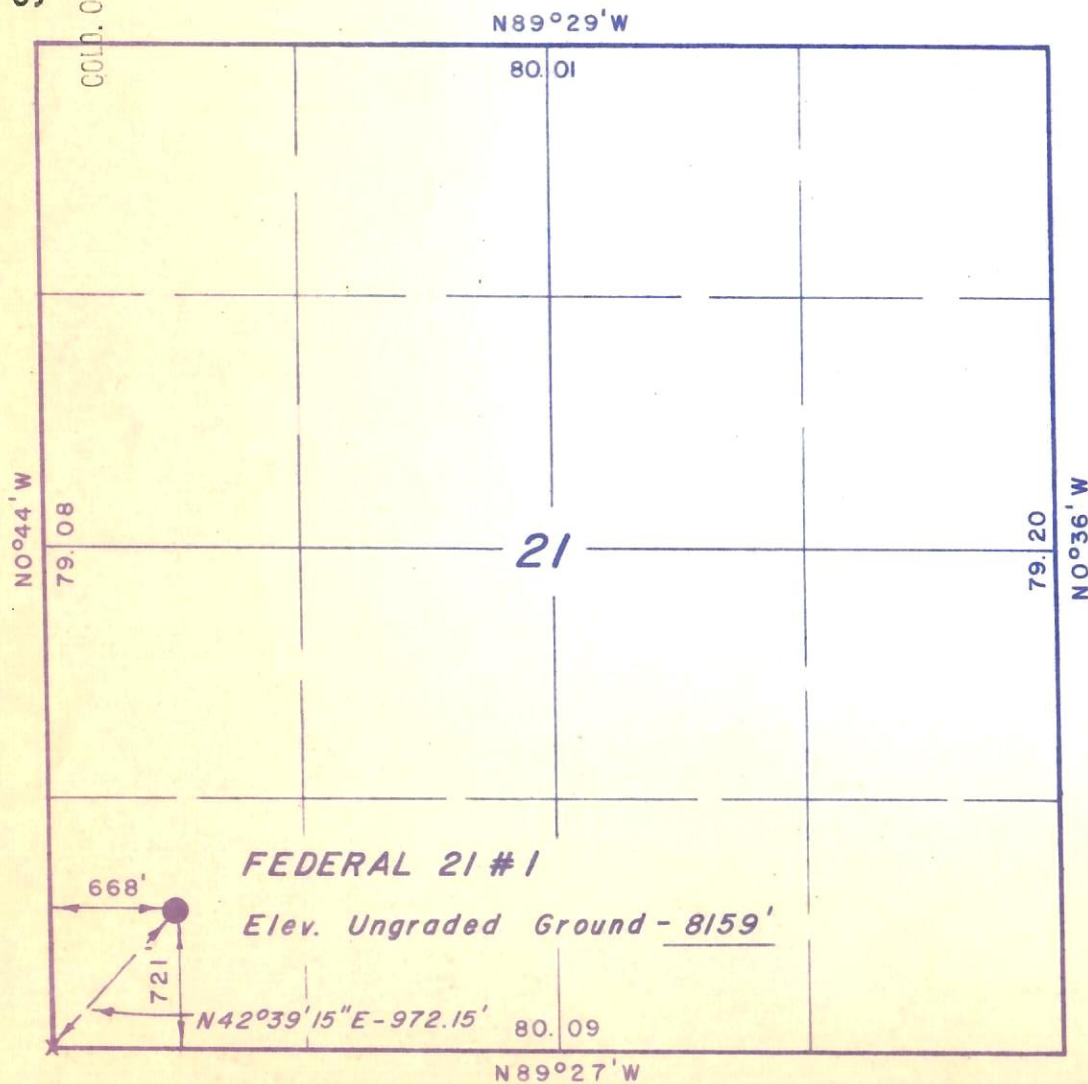

X = Section Corners Located



CERTIFICATE

THIS IS TO CERTIFY THAT THE ABOVE PLAT WAS PREPARED FROM
FIELD NOTES OF ACTUAL SURVEYS MADE BY ME OR UNDER MY
SUPERVISION AND THAT THE SAME ARE TRUE AND CORRECT TO THE
BEST OF MY KNOWLEDGE AND BELIEF.

Archie L. ...
REGISTERED LAND SURVEYOR
REGISTRATION No 9019
STATE OF COLORADO

UINTAH ENGINEERING & LAND SURVEYING
P.O. BOX Q - 110 EAST - FIRST SOUTH
VERNAL, UTAH - 84078

SCALE	1" = 1000'	DATE	9 / 5 / 79
PARTY	R.K. D.B. D.K. S.B.	REFERENCES	GLO Plat
WEATHER	Clear & Warm	FILE	CONOCO