



SECTION 33

T. 9 N., R. 81 W., 6th P. M.

JACKSON COUNTY, COLORADO

RECEIVED

SEP 7 1973

COLO. DIV. OF GAS CONS. COMM.



SCALE

1" = 20 Chains

DISTANCES ARE EXPRESSED IN CHAINS EXCEPT AS INDICATED.

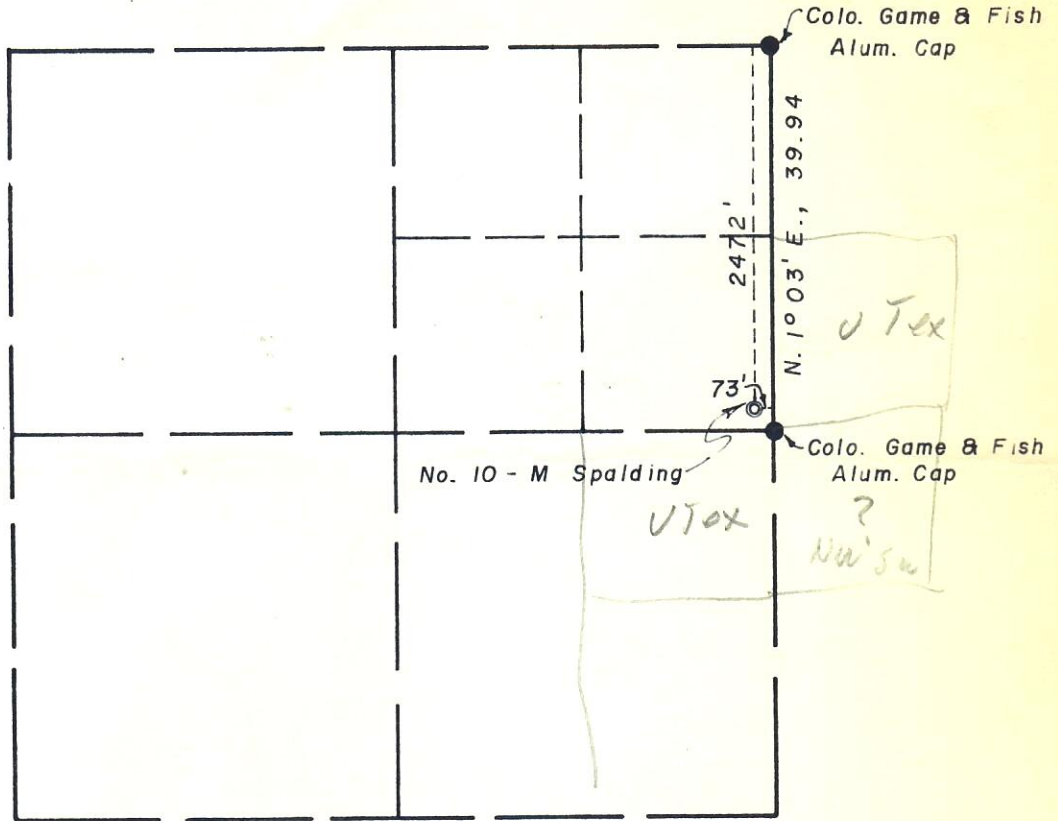

LEGEND

- U. S. Government Brass Cap corner ○
- Original stone corner, properly marked, firmly set ●
- Iron pipe set at proportionate distance ■
- Corner established by others as indicated □
- Brass cap set B.C.
- Temporary corner set this survey ▲
- Dependent Resurvey ————
- Protraction - - - - -
- Well location ⊙

ELEVATIONS:
Before grading.

LOCATION..... 8812
 R. P. 100' S. 8797
 R. P. 100' E. 8813

ELEV 'S. REFERRED TO:

28	27	ELEV. 8365
33	34	

SURVEY AND PLAT BY:

WILLIAM G. LADD consulting engineer

SUITE 304 WESTERN RESOURCES BLDG., CASPER, WYOMING

Direct solar lines and electronically measured distances, Ref. Bk. No. 103, P. 60

PLATTED FIELD NOTES OF SURVEY

MARKING WELL LOCATION

SE 1/4 NE 1/4, SECTION 33

FOR

BURTON - HAWKS INC., CASPER, WYO.

William G. Ladd

CERTIFIED TRUE & CORRECT, SURVEYOR
WYOMING REG. NO. 519 P.E. & L.S.

Refund
Fee

4-11-74

10 Spaulden

28-9N-8/16

Returned
Bond

4/16/74

They will send in
Letter requesting
refund