



00261312

RECEIVED

OCT - 4 1982

R.47W

GOLD OIL & GAS CONS. COMM.

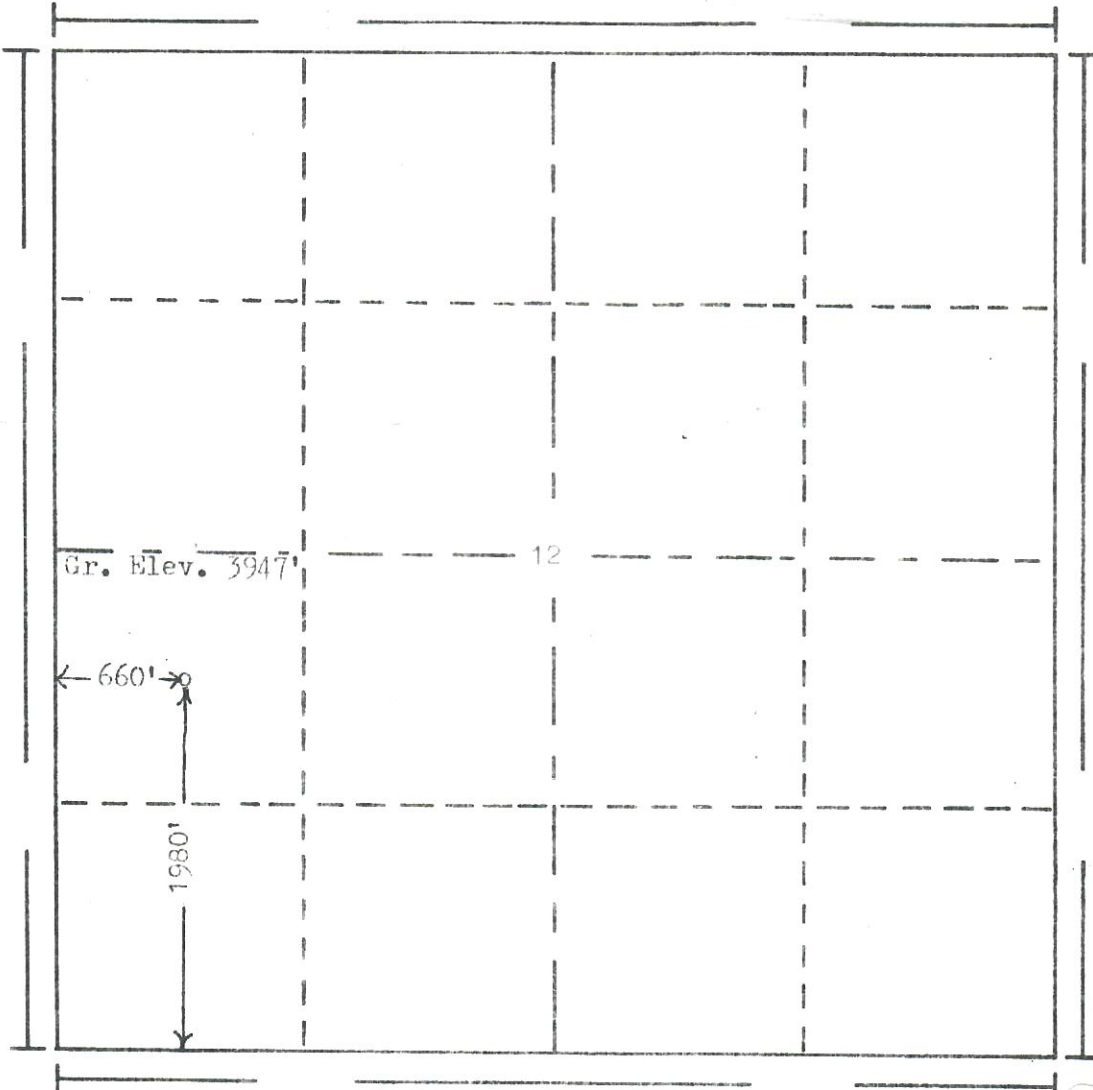

T.10N

Scale... 1" = 1000'

BEST COPY AVAILABLE

Powers Elevation of Denver, Colorado
 has in accordance with a request from Mr. Rogers
 for Intercontinental Energy Corp.
 determined the location of No.2 State
 to be C-NW-SW Section 12 Township 10N
 Range 47W of the 6th Principal Meridian
 Sedgewick County, Colorado

I hereby certify that this plat is an
 accurate representation of a correct
 survey showing the location of



Date: 9-24-82

Billy J. Holloway
 Licensed Land Surveyor No. 2853
 State of Colorado

23