

RECEIVED
JUL 20 1985
COLO. OIL & GAS CONS. COMM.

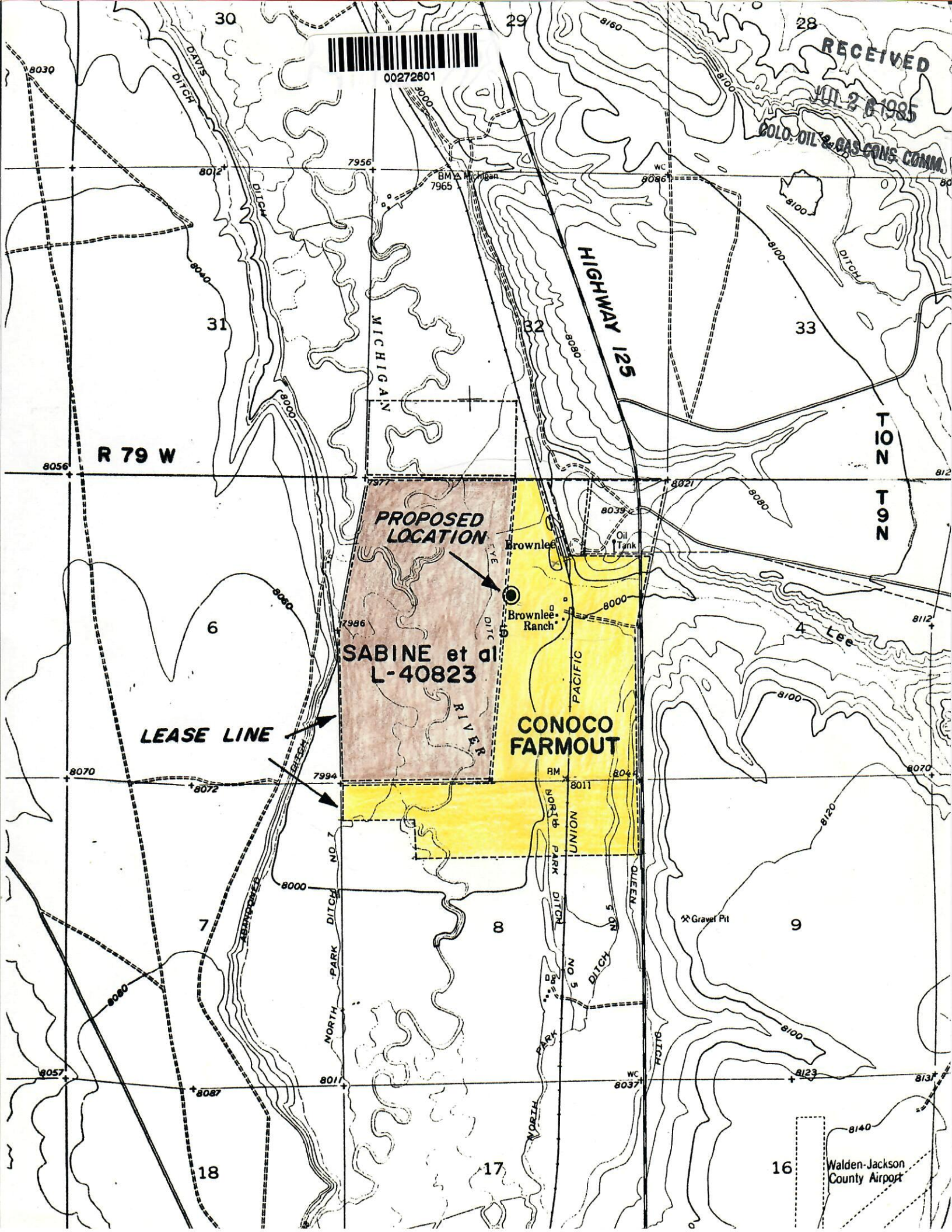

PROPOSED LOCATION

SABINE et al
L-40823

CONOCO FARMOUT

LEASE LINE

R 79 W

T 29 N

HIGHWAY 125

MICHIGAN

PACIFIC

NORTH PARK UNION

NORTH PARK DITCH NO. 1

QUEEN

Walden-Jackson
County Airport

18

17

16

31

32

33

30

29

28

6

7

8

9

4 Lee

8030

8012

7956

BM A 7965

WC 8086

8056

8070

8072

7994

RM 8011

804

8070

8057

8087

8017

WC 8037

8123

8137

8140

8160

8100

8080

8100

8080

8100

8120

8100

8000

8000

8080

8000

8080

8000

8080

8140

8140

Walden-Jackson
County Airport