

Legend

- P&A'd Wellhead
- Soil Sample
- Soil Screening
- Soil Vapor Point (SVP)
- Approximate Location of Flowline (To-Be-Removed)
- Approximate Location of Flowline (Removed)
- Excavation Extent

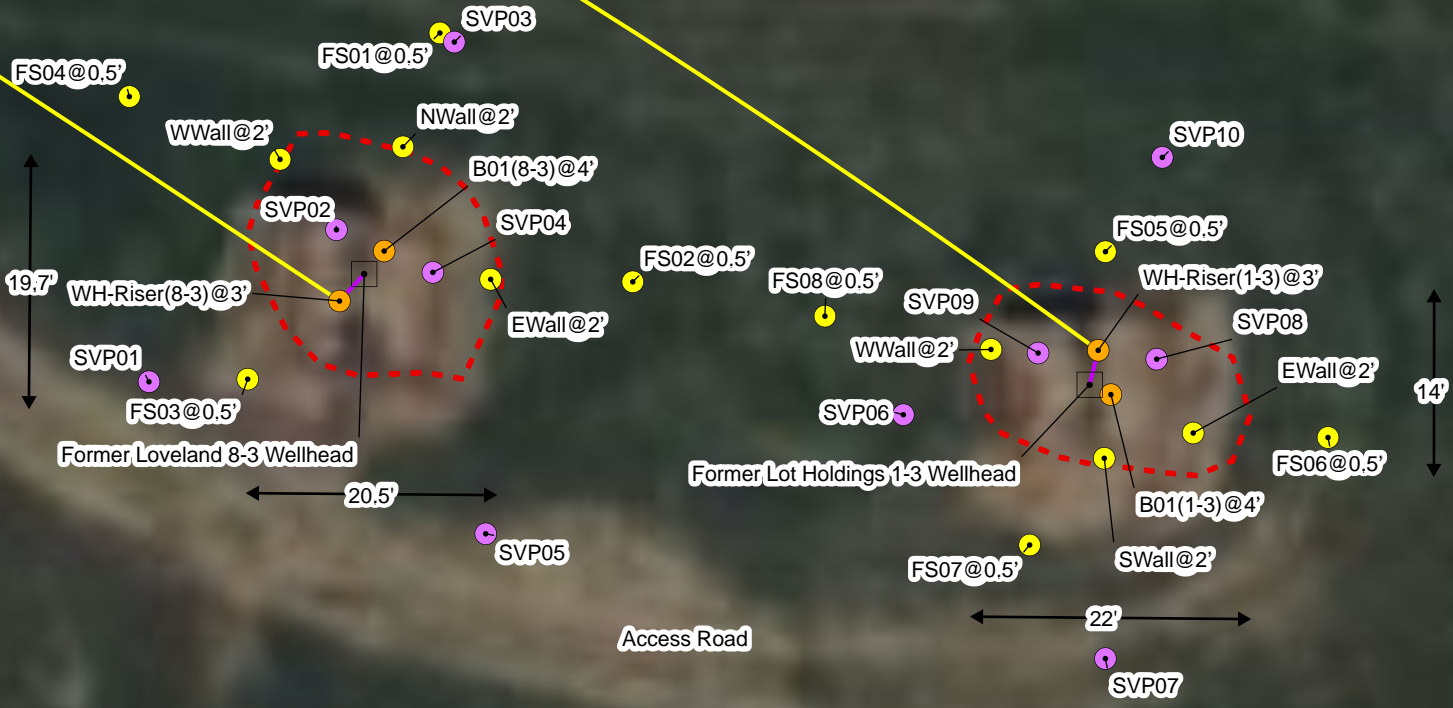

Rangeland



Default Folder: C:\Users\Margan\OneDrive - ENSOLUM, LLC\Ensolium GIS\0 - Projects\Kerr-McGee Oil & Gas Onshore, LP\09A14171459 - Lot Holdings 1-3 Wellhead

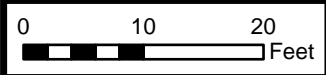

Sources: Environmental Systems Research Institute (ESRI)

Wellhead Excavation Site Map

Lot Holdings 1-3 & Loveland 8-3 Wellheads
 Kerr-McGee Oil & Gas Onshore, LP
 SENE SEC 3-T4N-R67W
 Weld County, CO

Project Number: 09A14171459

FIGURE
1

