



Sampling Photographic Log

Citation Arapahoe Unit 151 (43-21)

Arapahoe Unit 151 (43-21)
7/18/2022



AU_151_SS_01@6'

X

Description:

AU_151_SS_01@6'

View to the North.

Arapahoe Unit 151 (43-21)
7/18/2022



Description:

AU_151_SS_02 @6'

View to North.

Arapahoe Unit 151 (43-21)
7/18/2022



AU_151_SS_02@6'

Description:

AU_151_SS_02@6'
view to South.

Arapahoe Unit 151 (43-21)
7/18/2022



AU_151_SS_03@6'

Description:

AU_151_SS_03@6'
View to South
towards wellhead.

Arapahoe Unit 151 (43-21)
7/18/2022



AU_151_SS_BG_01@6'
X

Description:

AU_151_SS_BG_01@6'

View to the North.

Arapahoe Unit 151 (43-21)
7/18/2022

AU_151_SS_BG_02@3'

X

Description:

AU_151_SS_BG_02@3'

View to North.

4/2/25, 7:09 PM
+38.818699,-102.111346
330° NW
Cheyenne County
Arapahoe Unit 151



Description:

AU_151_SS01
AU_151_SS02

Samples taken at:

0-6"
6-12"
12-24"

4/2/25, 7:09 PM
+38.818699,-102.111346
271° W
Cheyenne County
Arapahoe Unit 151

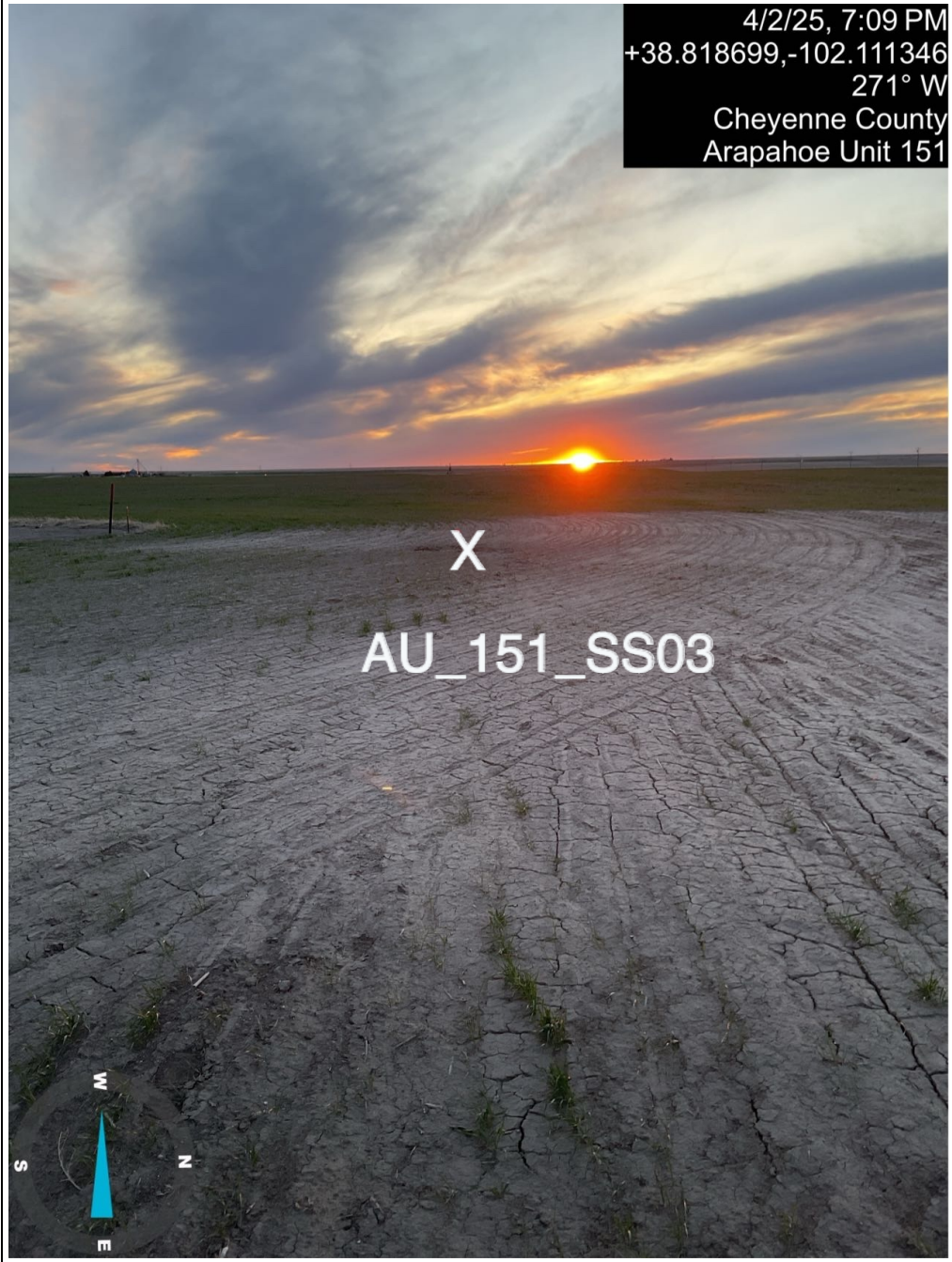

X
AU_151_SS03

Description:

AU_151_SS03

Samples taken at:

0-6"

6-12"

12-24"

4/2/25, 7:10 PM
+38.818567,-102.110986
257° W
Cheyenne County
Arapahoe Unit 151



AU_151_BG01

X



Description:

AU_151_BG01

Samples taken at:

0-6"

6-12"

12-24"