

Puritan 4-4-34 Facility

NWSE Sec. 34-T2N-R68W

API #: 123-31747

Facility ID: 336332

Remediation Project #: 42829

Form 19 Data Package

December 2025

Prepared by Tasman, Inc.



On behalf of Crestone Peak Resources Operating, LLC



PHOTO LOG



Photographic Log

Equipment ID:		Equipment Type:	Equipment ID:		Equipment Type:
Material:	Volume:	Contents:	Material:	Volume:	Contents:
Notes/Conditions: Soil sampling and screening locations			Notes/Conditions:		



Photographic Log

<p>Equipment ID: _____ Equipment Type: _____</p>			<p>Equipment ID: _____ Equipment Type: _____</p>		
<p>Material: _____</p>		<p>Volume: _____</p>	<p>Material: _____</p>		<p>Volume: _____</p>
<p>Contents: _____</p>			<p>Contents: _____</p>		
<p>Notes/Conditions: Soil sampling and screening locations</p>			<p>Notes/Conditions: Soil screening location</p>		



Photographic Log

274°W (T) ● 40°5'34"N, 104°59'17"W ±157ft ▲ 5015ft			98°E (T) ● 40°5'34"N, 104°59'16"W ±9ft ▲ 5007ft				
Equipment ID:		Equipment Type:		Equipment ID:		Equipment Type:	
Material:	Volume:	Contents:		Material:	Volume:	Contents:	
Notes/Conditions: Soil sampling locations				Notes/Conditions: Soil sampling locations			



Photographic Log

Equipment ID:		Equipment Type:	Equipment ID:		Equipment Type:
Material:	Volume:	Contents:	Material:	Volume:	Contents:
Notes/Conditions: Soil sampling location			Notes/Conditions: Soil sampling location		



Photographic Log

Equipment ID:		Equipment Type:		Equipment ID:		Equipment Type:	
Material:		Volume:		Material:		Volume:	
		Contents:				Contents:	
Notes/Conditions: Soil sampling locations				Notes/Conditions:			

FIGURES

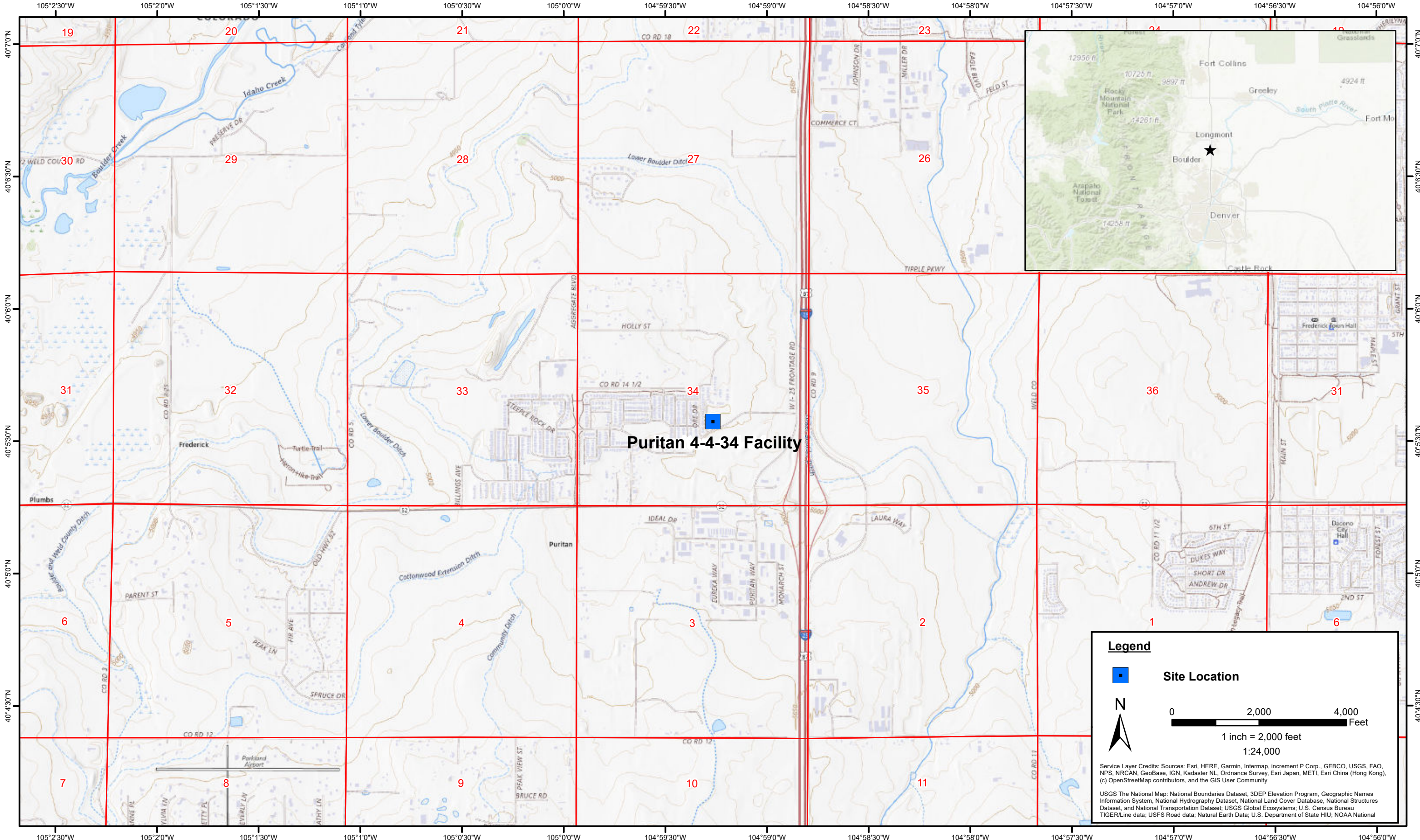

DATE:	December 2025
DESIGNED BY:	S. Vogt
DRAWN BY:	L. Reed



Tasman, Inc.
4725 Independence St.
Wheat Ridge, CO 80033

Crestone Peak Resources Operating, LLC
Puritan 4-4-34 Facility
 NWSE Sec. 34-T2N-R68W
 Weld County, Colorado

Site Location Map

Figure
1



Legend

- Soil sample location – Field Screened (Collected via Trimble GPS)
- Soil sample location – Submitted for Laboratory Analysis (Collected via Trimble GPS)
- Soil sample location – Submitted for Laboratory Analysis – Elevated PID Readings, HC Staining, and/or HC Odor (Collected via Trimble GPS)
- Excavation extent
- Stockpile location – Submitted for Laboratory Analysis (Collected via Trimble GPS)
- Stockpile location – Submitted for Laboratory Analysis – Elevated PID Readings, HC Staining, and/or HC Odor (Collected via Trimble GPS)
- Dumpline Location

Notes

Crestone Peak Resources Operating, LLC site infrastructure has been removed.

All locations are approximate unless otherwise noted.

GPS = Global Positioning System
 PID = Photoionization Detector
 HC = Hydrocarbon

0 ft. 30 ft. 60 ft.

Image Source: Google Earth

DATE: December 18, 2025

DESIGNED BY: S. Vogt

DRAWN BY: L. Molson



Tasman, Inc.
 4725 Independence St.
 Wheat Ridge, CO 80033

Crestone Peak Resources Operating, LLC
 Puritan 4-4-34 Facility
 NWSE Sec. 34-T2N-R68W
 Weld County, Colorado

Facility Soil Sample
 Location Map
 (12/18/2025)

Figure
 2