



RECEIVED

FEB 18 1976

COLO. OIL & GAS CONS. COMM.

R. 47W

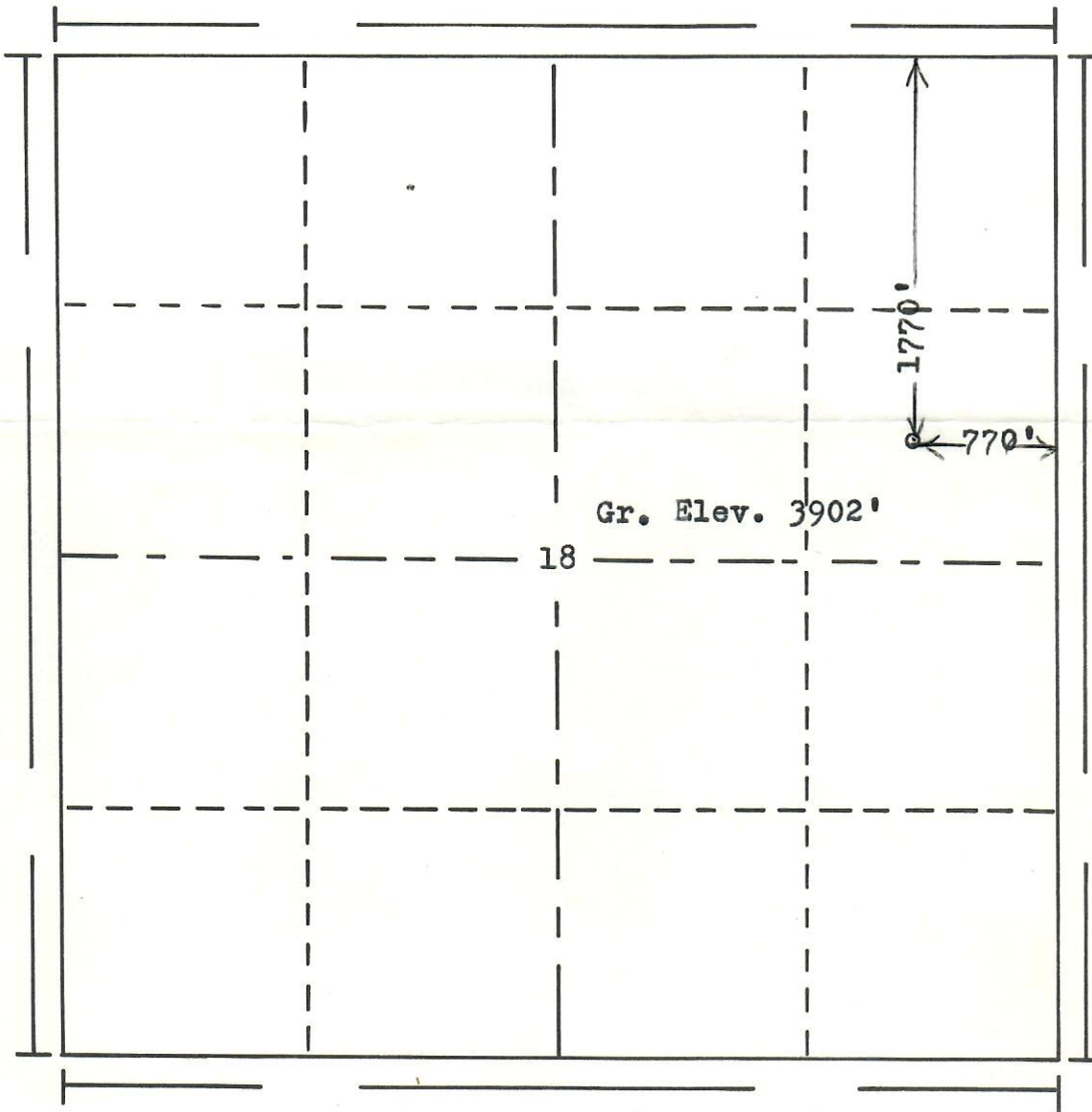

T. 10 N

Scale... 1" = 1000'

Powers Elevation Company, Inc. of Denver, Colorado has in accordance with a request from Mr. Johnson for E.Lyle Johnson determined the location of No.18-1 Sonnenberg-Sprague to be 1770'FN & 770'FE Section 18 Township 10N Range 47W of the 6th Principal Meridian Sedgwick County, Colorado

I hereby certify that this plat is an accurate representation of a correct survey showing the location of

Date: 2-6-76

B. G. Hollenbeck
 Licensed Land Surveyor No. 2853
 State of Colorado

RECEIVED
FEBRUARY 1978



Reg. log
12-15-77
es

12-27-77 reg. log from
W.H. Cobb, Sterling, es

Mr. Johnson
1770' & 220' 43
of the 6th Principal
Bedwick Colorado

Handwritten signature or initials at the bottom left.

