



Site Specific Final Reclamation Completion Notice – Abandoned Location Drone Imagery

Permit Closure Report – Abandoned Location

Location ID: 310246

Location Name: Avey/12-9

Report Date:

12/10/2024

H2E has conducted a thorough review of the data provided in this report. This report was developed in accordance with ECMC Operator Guidance – Operator supplied abandoned location drone imagery and information for submitting a final reclamation completion notice.

Abandoned Location Type

This site was permitted, but no construction or drilling was completed for the location.

Inspection:

Performed by	H2E Inc.
Date	12/6/2024

All pertinent data, imagery, and materials are included at the end of this report.

Location Checklist



Operator / #	PDC Energy / 69175		
Name / Location ID	Avey/12-9 - 310246		
County	Weld		
Well Information	Well Name: AVEY #12-9		
	Well API #: 05-123-26128		
	Lat/Long Planned: 40.070590 / -104.784190		
	Plug date & Form 6S Doc. #: N/A		
Facility Entities		Tank Battery	Pits
	X	Wells	On-Location Flowlines (Form 42): Doc. #
		Domestic Taps	Off-Location Flowlines (Form 44): Doc. #
Equipment on Site	X	None	Debris
		Pit mouse/rat holes, cellars backfilled	
Access Road		Regraded	Contoured
		Culverts removed	Gravel removed
		Pre-existing: must provide supporting documentation	
Reclamation Status		Location and associated disturbances reclaimed	
		Subsidence	
Spills or Releases (Form 19)	X	No	Yes
Remediation (Form 27/27A)	X	No	Yes
On-Location Flowlines	X	No	Yes
Off-Location Flowlines	X	No	Yes
Inspection Corrective Actions	X	No	Yes
Sundry Notice (Form 4)	Form 4 Doc. # & Date: 400853712 - 06/15/2015		
	Purpose: Abandon Permit		
	Comments: Per operator checked to also abandon the location.		
	Attachments: N/A		
Drone Information	Make & Model: DJI M300		
	Image Processing Software: Pix4Dmapper		
	Pilot Name & FAA Certificate #: Ian Hattabaugh - 5069217		
	Date of FAA Certificate Issuance: 10/4/2024		



Designated Land Use Observations

The following imagery sources were reviewed during this investigation:

Historic Google Earth imagery from 1985-2023, and 2024 drone imagery.

Site Observation Notes

No Additional Information

Closure Information

This final reclamation completion notice is intended to close the Avey/12-9 location which consists of the AVEY #12-9 (API # 05-123-26128) well. This location is not shared with any other wells or tank batteries. This location was permitted but never constructed and no wells were drilled, so there are no associated tank batteries or flowlines to be abandoned. The Sundry Notice (Form 4) attached to this submission (Doc # 400853712) indicates that the well was not drilled.

The Avey/12-9 location is in Weld County, Colorado east of County Road 29 and south of County Road 12.

No remediation plans were associated with this location due to the lack of construction and drilling/production of the well(s). During the records review, no inspections or corrective actions (CA's) were identified.

Drone imagery confirms that no oil and gas-related disturbances were associated with this location. Kerr McGee developed a location (Location ID 442775) in the immediate vicinity of the Avey/12-9 location, all construction and development is associated with the Kerr McGee location. There is also a residential development being constructed, including streets and sidewalks associated with this development.

Summary Acreage Table

Description	Acres
Historic Disturbance Extent	N/A
Access Road	N/A
Flowline	Not Included
Tank Battery	Not Included
Well Pad	N/A

Location Summary





Name	Avey/12-9		
Type	Wellhead		
Location ID	310246		
Operator / #	PDC Energy / 69175		
Field	Wattenberg		
County, State	Weld, Colorado		
Lat/Long	40.070590 / -104.784190		
	<input checked="" type="checkbox"/>	Planned Location	<input type="checkbox"/> As Drilled
Location	NENW 9 1N66W 6		
Location Status - Date	AL - 6/15/2015		
Facility Entities	<input type="checkbox"/>	Tank Battery	<input type="checkbox"/> Pits
	<input checked="" type="checkbox"/>	Wells	<input type="checkbox"/> Off-Location Flowlines (Form 44)
	<input type="checkbox"/>	Domestic Taps	<input type="checkbox"/> On-Location Flowlines (Form 42)
	<input type="checkbox"/>	Electric Utilities	
Equipment on Site	<input checked="" type="checkbox"/>	No	<input type="checkbox"/> Yes
	If yes, list:		
	<input type="checkbox"/>	Pit mouse/rat holes, cellars backfilled	
Access Road	<input type="checkbox"/>	Regraded	<input type="checkbox"/> Contoured
	<input type="checkbox"/>	Culverts Removed	<input type="checkbox"/> Gravel Removed
	<input type="checkbox"/>	Pre-Existing (Must provide supporting documentation):	
Variance Requests	N/A		
Sundry Notice (Form 4)	Form 4 Doc. # & Date: 400853712 - 06/15/2015		
	Purpose: Abandon Permit		
	Comments: Per operator checked to also abandon the location.		
	Attachments: N/A		
On Location Flowlines (Form 42)	N/A		
Off-Location Flowlines (Form 44)	N/A		
Field Inspection Form (Form INSP)	Form INSP Doc # & Date: N/A		
	Status Summary: N/A		
	Inspected Facilities: N/A		
	Inspection Status: N/A		
	Inspection Date & Inspector: N/A		
	Comments: N/A		
Inspection Corrective Actions (CAs)	No Corrective Actions detected		
Environmental Incidents & Remediation	<input checked="" type="checkbox"/>	None	<input type="checkbox"/> Spill or Release (Form 19)
	<input type="checkbox"/>	Remediation (Form 27/27A)	
Spill or Release (Form 19)	N/A		
Site Investigation and Remediation Workplan (Form 27/27A)	N/A		
COGIS Tank Location Information (Scout Card)	Tank Battery Name: N/A		
	Location ID: N/A		
	Status & Date: N/A		
	Lat/Long: N/A		
	Notes: N/A		
	Form 4 Doc # & Date: N/A		
	Purpose: N/A		
COGIS Well Information (Scout Card)	Well Name: AVEY #12-9		
	Facility ID: 291702		
	Status & Date: AL - 6/15/2015		
	Lat/Long: 40.070590 / -104.784190		
	Notes: N/A		
	Form 4 Doc # & Date: 400853712 - 06/15/2015		
Purpose: Abandon Permit			

Pre-Permitted Overview

2003

Legend

 AVEY #12-9

40.070590 / -104.784190  AVEY #12-9



Abandoned Location Overview



**PDC Form 4 Final Reclamation - Abandoned Location
Overview**

Avey 12-9

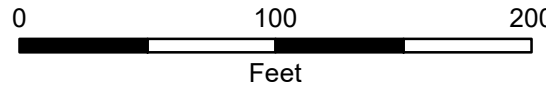
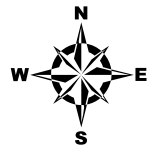

Editor: CDenison
File: PDC_Drone_Rec_AbandonedLocation_DDP

Prepared by:
Scale: 1:900
Date: 12/24/2024

Well Head

2024 Drone Imagery

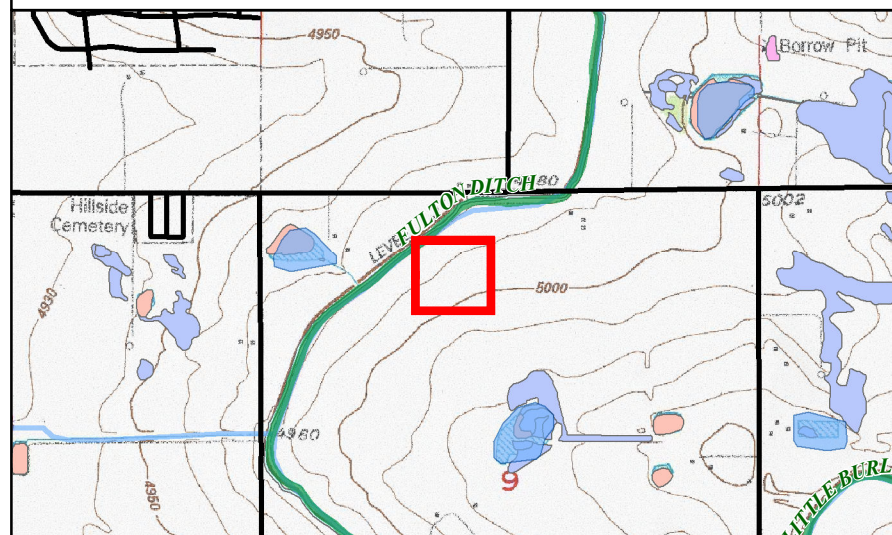

Cardinal Direction Drone Photos of the Abandoned Location Area

Photo Dates:

12/6/2024

Drone Photo Height:

85'

North of Disturbance Facing South
Lat/Long: 40.07127622 / -104.78419506



South of Disturbance Facing North
Lat/Long: 40.06986933 / -104.78414208



West of Disturbance Facing East
Lat/Long: 40.07058044 / -104.78505858



East of Disturbance Facing West
Lat/Long: 40.07062561 / -104.78331728



State of Colorado
Oil and Gas Conservation Commission

1120 Lincoln Street, Suite 801, Denver, Colorado 80203
Phone: (303) 894-2100 Fax: (303) 894-2109



DE	ET	OE	ES
Document Number: 400853712			
Date Received: 06/15/2015			

SUNDRY NOTICE

Submit a signed original. This form is to be used for general, technical and environmental sundry information. For proposed or completed operations, describe in full in Comments or provide as an attachment. Identify Well by API Number; identify Oil and Gas Location by Location ID Number; identify other Facility by Facility ID Number.

OGCC Operator Number: 69175 Contact Name Halle Milne
 Name of Operator: PDC ENERGY INC Phone: (303) 318-6153
 Address: 1775 SHERMAN STREET - STE 3000 Fax: ()
 City: DENVER State: CO Zip: 80203 Email: halle.milne@pdce.com

Complete the Attachment
Checklist

OP OGCC

API Number : 05- 123 26128 00 OGCC Facility ID Number: 291702
 Well/Facility Name: Avey Well/Facility Number: 12-9
 Location QtrQtr: NENW Section: 9 Township: 1N Range: 66W Meridian: 6
 County: WELD Field Name: WATTENBERG
 Federal, Indian or State Lease Number: _____

Survey Plat		
Directional Survey		
Srfc Eqpmt Diagram		
Technical Info Page		
Other		

CHANGE OF LOCATION OR AS BUILT GPS REPORT

- Change of Location * As-Built GPS Location Report As-Built GPS Location Report with Survey

* Well location change requires new plat. A substantive surface location change may require new Form 2A.

SURFACE LOCATION GPS DATA Data must be provided for Change of Surface Location and As Built Reports.

Latitude _____ PDOP Reading _____ Date of Measurement _____
 Longitude _____ GPS Instrument Operator's Name _____

LOCATION CHANGE (all measurements in Feet)

Well will be: _____ (Vertical, Directional, Horizontal)

Change of **Surface** Footage **From** Exterior Section Lines:

Change of **Surface** Footage **To** Exterior Section Lines:

Current **Surface** Location **From** QtrQtr NENW Sec 9

New **Surface** Location **To** QtrQtr _____ Sec _____

Change of **Top of Productive Zone** Footage **From** Exterior Section Lines:

Change of **Top of Productive Zone** Footage **To** Exterior Section Lines:

Current **Top of Productive Zone** Location **From** Sec _____

New **Top of Productive Zone** Location **To** Sec _____

Change of **Bottomhole** Footage **From** Exterior Section Lines:

Change of **Bottomhole** Footage **To** Exterior Section Lines:

Current **Bottomhole** Location Sec _____ Twp _____

New **Bottomhole** Location Sec _____ Twp _____

Is location in High Density Area? _____

Distance, in feet, to nearest building _____, public road: _____, above ground utility: _____, railroad: _____,

property line: _____, lease line: _____, well in same formation: _____

Ground Elevation _____ feet Surface owner consultation date _____

FNL/FSL		FEL/FWL	
<u>805</u>	<u>FNL</u>	<u>2093</u>	<u>FWL</u>
_____	_____	_____	_____
Twp <u>1N</u>	Range <u>66W</u>	Meridian <u>6</u>	
Twp _____	Range _____	Meridian _____	
_____	_____	_____	_____
_____	_____	_____	_____
Twp _____	Range _____		
Twp _____	Range _____		
_____	_____	_____	_____
_____	_____	_____	_____
_____	_____	_____	_____
_____	_____	_____	_____

**

**

** attach deviated drilling plan

Comments:

ENGINEERING AND ENVIRONMENTAL WORK

NOTICE OF CONTINUED TEMPORARILY ABANDONED STATUS

Indicate why the well is temporarily abandoned and describe future plans for utilization in the COMMENTS box below or provide as an attachment, as required by Rule 319.b.(3).

Date well temporarily abandoned _____ Has Production Equipment been removed from site? _____

Mechanical Integrity Test (MIT) required if shut in longer than 2 years. Date of last MIT _____

SPUD DATE: _____

TECHNICAL ENGINEERING AND ENVIRONMENTAL WORK

Details of work must be described in full in the COMMENTS below or provided as an attachment.

NOTICE OF INTENT Approximate Start Date _____

REPORT OF WORK DONE Date Work Completed _____

<input type="checkbox"/> Intent to Recomplete (Form 2 also required)	<input type="checkbox"/> Request to Vent or Flare	<input type="checkbox"/> E&P Waste Mangement Plan
<input type="checkbox"/> Change Drilling Plan	<input type="checkbox"/> Repair Well	<input type="checkbox"/> Beneficial Reuse of E&P Waste
<input type="checkbox"/> Gross Interval Change	<input type="checkbox"/> Rule 502 variance requested. Must provide detailed info regarding request.	
<input type="checkbox"/> Other _____	<input type="checkbox"/> Status Update/Change of Remediation Plans for Spills and Releases	

COMMENTS:

CASING AND CEMENTING CHANGES

Casing Type	Size	Of	/	Hole	Size	Of	/	Casing	Wt/Ft	Csg/LinTop	Setting Depth	Sacks of Cement	Cement Bottom	Cement Top

H2S REPORTING

Data Fields in this section are intended to document Sample and Location Data associated with the collection of a Gas Sample that is submitted for Laboratory Analysis.

Gas Analysis Report must be attached.

H2S Concentration: _____ in ppm (parts per million) Date of Measurement or Sample Collection _____

Description of Sample Point:

Absolute Open Flow Potential _____ in CFPD (cubic feet per day)

Description of Release Potential and Duration (If flow is not open to the atmosphere, identify the duration in which the container or pipeline would likely be opened for servicing operations.):

Distance to nearest occupied residence, school, church, park, school bus stop, place of business, or other areas where the public could reasonably be expected to frequent: _____

Distance to nearest Federal, State, County, or municipal road or highway owned and principally maintained for public use: _____

COMMENTS:

Best Management Practices

No BMP/COA Type

Description

<u>No BMP/COA Type</u>	<u>Description</u>

Operator Comments:

I hereby certify all statements made in this form are, to the best of my knowledge, true, correct, and complete.

Signed: _____ Print Name: Halle Milne
Title: Regulatory Analyst Email: halle.milne@pdce.com Date: 6/15/2015

Based on the information provided herein, this Sundry Notice (Form 4) complies with COGCC Rules and applicable orders and is hereby approved.

COGCC Approved: GARRISON, PENNY Date: 6/22/2015

CONDITIONS OF APPROVAL, IF ANY:

COA Type

Description

<u>COA Type</u>	<u>Description</u>

General Comments

User Group

Comment

Comment Date

Permit	Per operator checked to also abandon the location.	6/22/2015 9:51:38 AM
--------	--	-------------------------

Total: 1 comment(s)

Attachment Check List

Att Doc Num

Name

400853712	FORM 4 SUBMITTED
-----------	------------------

Total Attach: 1 Files