



Site Specific Final Reclamation Completion Notice – Cropland Drone Imagery

Permit Closure Report – Cropland

Location ID: 323264

Location Name: BUDERUS-65N65W/23NENE

Report Date:

10/29/2025

H2E has conducted a thorough review of the data provided in this report. This report was developed in accordance with ECMC Operator Guidance – Operator supplied cropland drone imagery and information for submitting a final reclamation completion notice.

Crop Year and Type

Crop 2025 – Corn

Crop 2024 – Corn

Inspection:

Performed by	H2E Inc.
Date	8/6/2025

All pertinent data, imagery, and materials are included at the end of this report.

Location Checklist



Location Name	BUDERUS-65N65W/23NENE			
Location ID	323264			
Type	Well Location			
Operator / #	PDC ENERGY INC - 69175			
Field	WATTENBERG - #90750			
County, State	Weld, CO			
COGIS Well Information (Scout Card)	Well Name: BUDERUS #1-23			
	Facility ID: 244990			
	Well API #: 05-123-12785			
	Status & Date: PA - 12/7/2018			
	Lat/Long: 40.390000, -104.623333			
Location	NENE 23 5N65W			
Location Status - Date	PA - 12/7/2018			
Facility Entities	<input type="checkbox"/>	Tank Battery	<input type="checkbox"/>	Pits
	<input checked="" type="checkbox"/>	Wells	<input checked="" type="checkbox"/>	Off-Location Flowlines (Form 44)
	<input type="checkbox"/>	Domestic Taps	<input type="checkbox"/>	On-Location Flowlines (Form 42)
	<input type="checkbox"/>	Electric Utilities	<input type="checkbox"/>	
Equipment on Site	<input checked="" type="checkbox"/>	No	<input type="checkbox"/>	Yes
	If yes, list:			
	<input type="checkbox"/>	Pit mouse/rat holes, cellars backfilled		
Access Road	<input checked="" type="checkbox"/>	Regraded	<input checked="" type="checkbox"/>	Contoured
	<input type="checkbox"/>	Culverts Removed	<input checked="" type="checkbox"/>	Gravel Removed
	<input checked="" type="checkbox"/>	Revegetated	<input type="checkbox"/>	
	<input checked="" type="checkbox"/>	Pre-Existing (Must provide supporting documentation):		
Reclamation Status	<input checked="" type="checkbox"/>	Location and associated disturbances reclaimed		
	<input type="checkbox"/>	Subsidence		
Plug date & Form 6S Doc. #:	12/07/2018 - #401894082			
Spills or Releases (Form 19)	<input checked="" type="checkbox"/>	No	<input type="checkbox"/>	Yes
Remediation (Form 27/27A)	<input checked="" type="checkbox"/>	No	<input type="checkbox"/>	Yes
On-Location Flowlines	<input checked="" type="checkbox"/>	No	<input type="checkbox"/>	Yes
Off-Location Flowlines	<input type="checkbox"/>	No	<input checked="" type="checkbox"/>	Yes
Inspection Corrective Actions	<input checked="" type="checkbox"/>	No	<input type="checkbox"/>	Yes
Variance Requests	No variance requests were identified.			
Sundry Notice (Form 4)	No sundry notice pertaining to series 900-1200 rules was identified.			

Off-Location Flowlines (Form 44)	Form 44 Doc # & Date: #403906190 - 08/29/2024
	Purpose: FLOWLINE SYSTEM ABANDONMENT VERIFICATION
	Removal Date: 1/2/2019
	ECMC Approval Date & Signee: 12/31/2024 - Director of ECMC
	Operator Comments: NA
	Flowline Facility Information
	ECMC Flowline ID: 479253
	Operator Flowline ID: PDC Flowline System
	Status & Date: AC - 10/27/2025
	Flowline Type: Wellhead line
	Type of Fluids Transported: Produced fluids
	Start Point Location ID: 323264
	Start Point Riser Lat/Long: 40.390000, -104.623333
	Equipment at Start Point: Wellhead
End Point Location ID: 472157	
End Point Riser Lat/Long: 40.390289, -104.625720	
Equipment at End Point: Separator	
Field Inspection Form (Form INSP)	Form INSP Doc # & Date: #673803198 - 05/18/2016
	Status Summary: SATISFACTORY
	Inspected Facilities: Well
	Inspection Status: PR
	Inspection Date & Inspector: 05/18/2016 - Gomez, Jason
Comments:	
Inspection Corrective Actions (CAs)	No Corrective Actions identified.
Spill or Release (Form 19)	No spill or release identified.
Site Investigation and Remediation Workplan (Form 27/27A)	No Site Investigation and Remediation Workplan.
COGIS Tank Facilities Information (Scout Card)	Tank Battery Name: Buderusock/ 2-23
	Location ID: 472157
	Status & Date: AC - 2/27/2020
	Lat/Long: 40.390258, -104.625689
Notes:	
Drone Information	Make & Model: DJI M3E MultiSpectral
	Image Processing Software: Pix4D Mapper
	Pilot Name & FAA Certificate #: Peter Nelson - 4974559
	Date of FAA Certificate Issuance: 3/19/2024



Imagery Sources

The following imagery sources were reviewed during this investigation:

NAIP Imagery from 2009-2023, historic Google Earth imagery from 1985-2025, and Netronline Historic Aerials from 1948-2023.

Site Observation Notes

No Additional Information

Closure Information

This final reclamation completion notice is intended to close the BUDERUS-65N65W/23NENE (323264) location which consists of the BUDERUS #1-23 (API # 05-123-12785) wellhead. This wellhead does not share a disturbance with any other wells or tank batteries. There is one off-location flowline associated with this well that transported produced fluids to the associated tank battery and was removed in January of 2019. The associated tank battery has its own location ID (472157) which will remain open until final reclamation has been achieved.

BUDERUS #1-23 was reclaimed and returned to the landowner for agricultural use in 2018. The wellhead was accessed from a pre-existing agricultural service road with entrances off US HWY 34 and County Road 45 ½. The access roads to the BUDERUS #1-23 wellhead from the agricultural service road were reclaimed and returned to agriculture in conjunction with the reclamation of the well location.

No Spills or Releases (Form 19), Remediation Workplans (Form 27), or Inspection Corrective Actions (CA's) were identified for this location.

Drone imagery confirms that no equipment was left on site at this location after reclamation activities occurred.

Pre-Plugging Active Operations Location Overview

PDC Form 4 Final Reclamation - Pre Plugging Overview



Prepared by:

Editor: CDenison
 File: PDC_PrePlugging_v1

Scale: 1:2,000
 Date: 10/30/2025

- Well Head
- Flowline - Removed
- Access Road - Reclaimed
- Pre-Existing Access Road
- Former Separator
- Reclaimed Tank Battery
- Reclaimed Well Pad
- Highway
- County/Local Road

NAIP 2013 Imagery

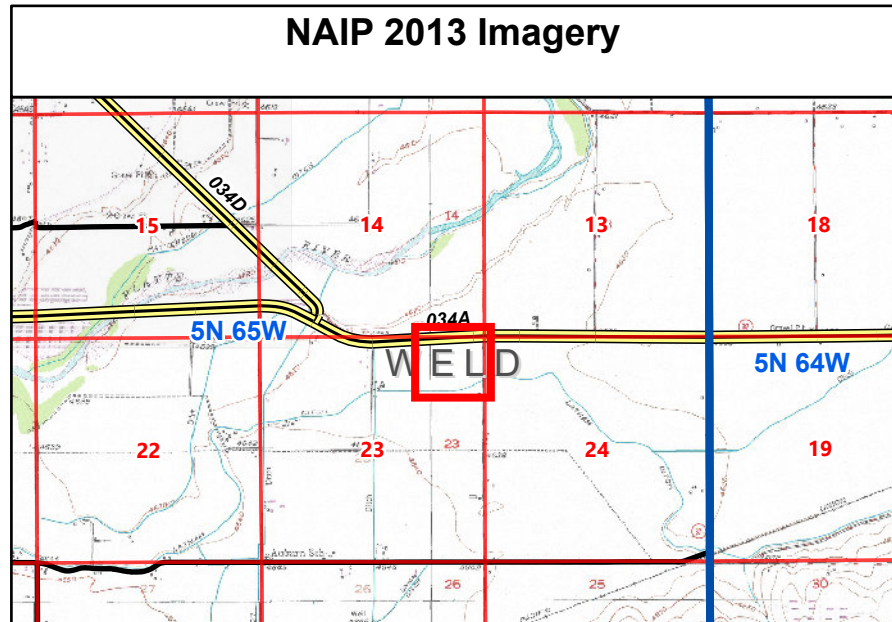









PDC Form 4 Final Reclamation - Pre Plugging Overview



Editor: CDenison
File: PDC_PrePlugging_v1

Scale: 1:2,000
Date: 10/30/2025

-  Well Head
-  Flowline - Removed
-  Access Road - Reclaimed
-  Pre-Existing Access Road
-  Former Separator
-  Reclaimed Tank Battery
-  Reclaimed Well Pad
-  Highway
-  County/Local Road

NAIP 2013 Imagery

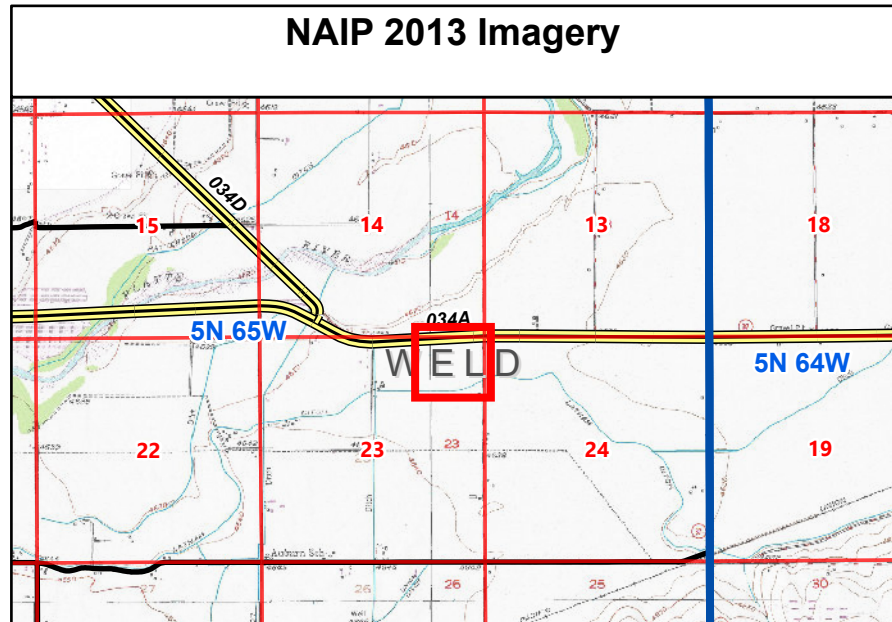

Pre-Existing Access Road

104.6236671°W 40.3902111°N go ← purchase image and/or print Post

aerials	2023
1984	2021
topos	2019
atlases	2017
	2015
compare	2013
overlays	2011
measure	2009
	2005
	2004
	1999
	1984
	1978
	1969
	1957
	1949
	1948

50 m
200 ft
40.38956 104.62687
© OpenStreetMap, © NETRonline

Post-Plugging and Abandonment Location Overview



PDC Energy Form 4 Final Reclamation - Post Plugging Overview

BUDERUS-65N65W/23NENE



Prepared by:
Scale: 1:1,700
Date: 11/14/2025

Editor: CDenison

File: PDC_PostPlugging_v1

⊕ Well Head

- - - Flowline - Removed

— Access Road - Reclaimed

— Pre-Existing Access Road

— Highway

— County/Local Road

— Weld Local

2025 Drone Imagery

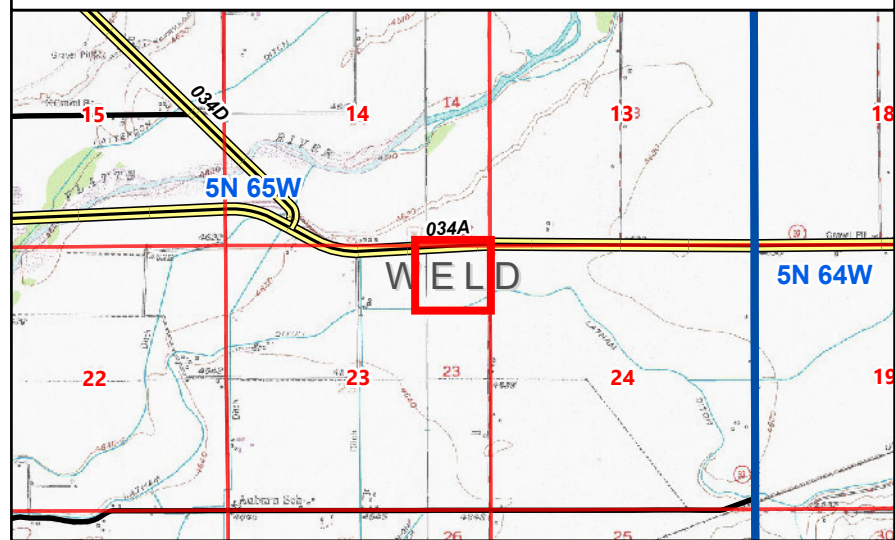

Cardinal Direction Drone Photos

Photo Dates:

08/06/2025

Drone Photo Height:

85'

North of Disturbance Facing South
Lat/Long: 40.390855 / -104.623547



South of Disturbance Facing North
Lat/Long: 40.389550 / -104.623554



West of Disturbance Facing East
Lat/Long: 40.390184 / -104.624343



East of Disturbance Facing West
Lat/Long: 40.390184 / -104.622696



Access Road Drone Photo

Photo Dates:

08/06/2025

Drone Photo Height:

85'

Access Road Photo Facing East
Lat/Long: 40.390184 / -104.624343



Access Road Photo Facing West
Lat/Long: 40.390184 / -104.622696



Flowline Drone Photo

Photo Dates:

08/06/2025

Drone Photo Height:

85'

Flowline Photo Facing North
Lat/Long: 40.389549 / -104.625698

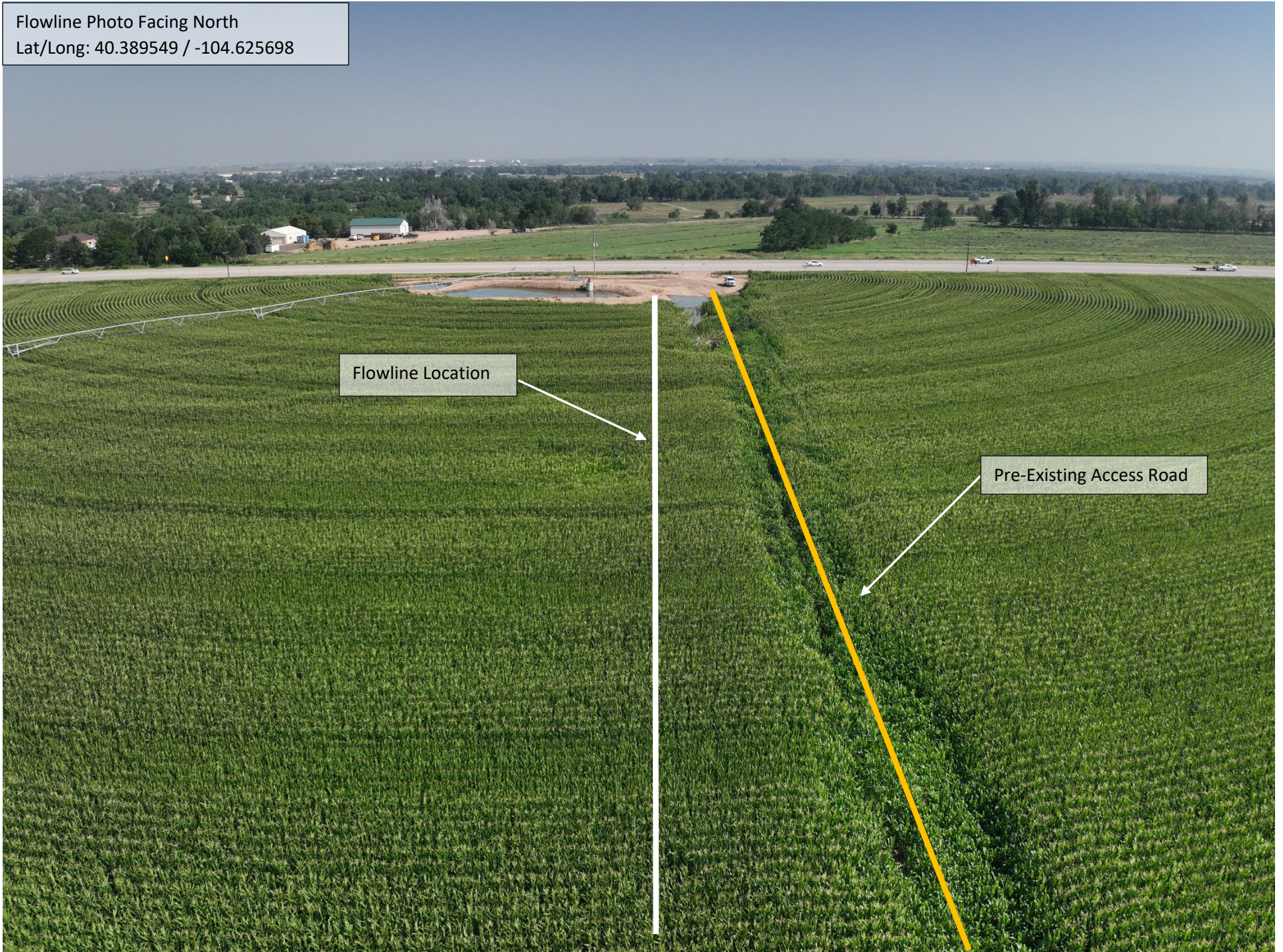

Flowline Location

Pre-Existing Access Road

Flowline Photo Facing East
Lat/Long: 40.390184 / -104.624343



Reference Photo for Crop Growth Stage

Cropland Reference Photo (Corn)
Lat/Long: 40.391481 / -104.62548



08.06.2025