

PROJECT

CONTINENTAL OIL COMPANY

Well location, *SOUTH McCALLUM UNIT*
No 21-4, located as shown in the NE 1/4
SE 1/4 Section 21, T9N, R78W, 6th P.M.
Jackson County, Colorado.

T 9 N, R 78 W, 6th P.M.

RECEIVED

AUG 16 1978

COLO. OIL & GAS TOWNS, COMM.

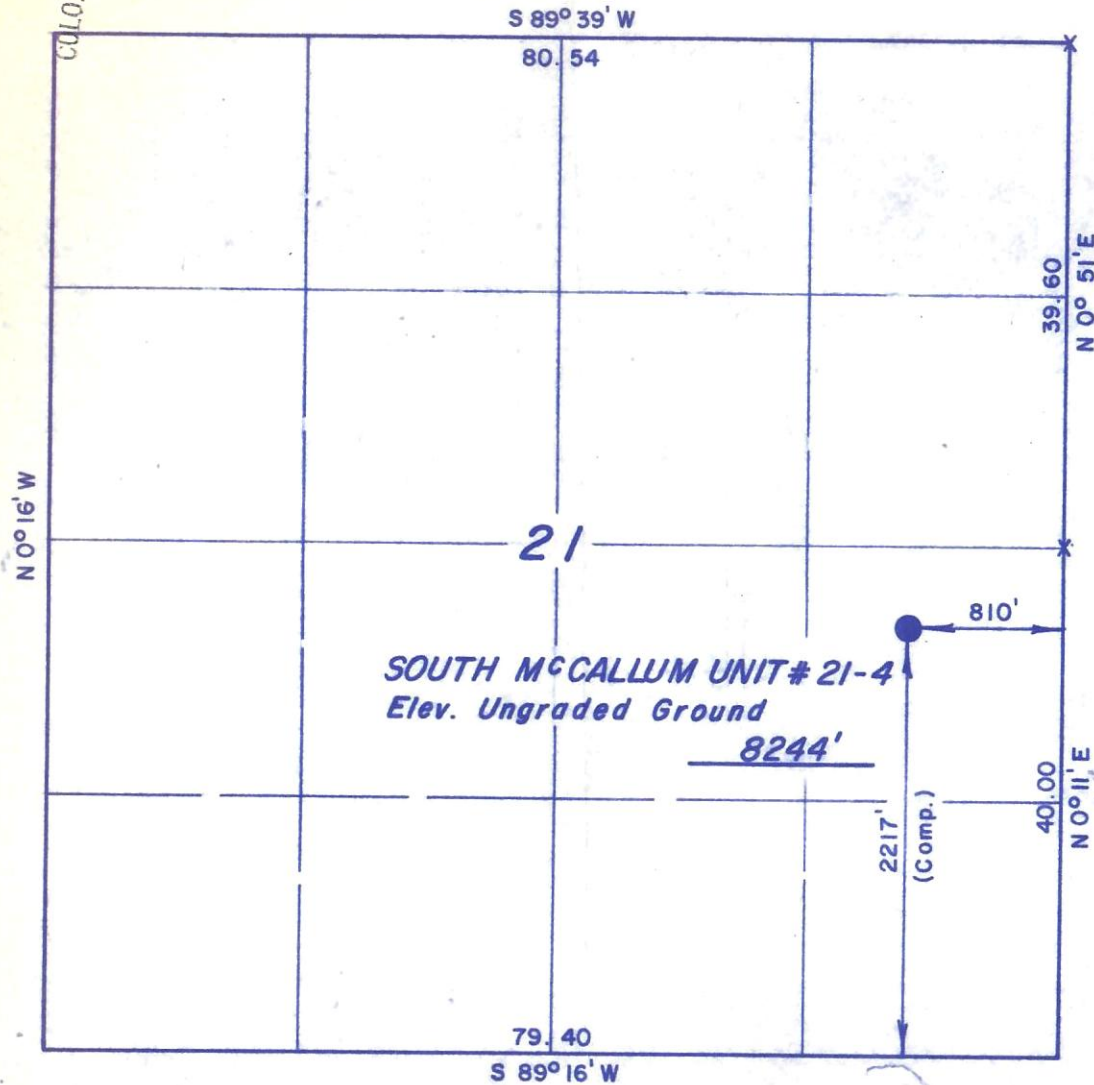

X = Section Corners Located



CERTIFICATE

THIS IS TO CERTIFY THAT THE ABOVE PLAT WAS PREPARED FROM
FIELD NOTES OF ACTUAL SURVEYS MADE BY ME OR UNDER MY
SUPERVISION AND THAT THE SAME ARE TRUE AND CORRECT TO THE
BEST OF MY KNOWLEDGE AND BELIEF.

Nelson J. Marshall

REGISTERED LAND SURVEYOR
REGISTRATION No 5839
STATE OF COLORADO

Revised 8-7-78

UINTAH ENGINEERING & LAND SURVEYING
P. O. BOX Q - 110 EAST - FIRST SOUTH
VERNAL, UTAH - 84078

SCALE 1" = 1000'	DATE 4 / 26 / 78
PARTY R.K. J.B. S.S. B.N. BFW	REFERENCES GLO Plat
WEATHER Cold	FILE CONTINENTAL OIL CO.