



00272495

3-9N-79W

RECEIVED

JUL 14 1986

COLORADO OIL & GAS COMM. COMM.



**REPORT  
of  
SUB-SURFACE  
DIRECTIONAL  
SURVEY**

CONOCO, INC.

COMPANY

MCCALLUM #125

WELL NAME

JACKSON COUNTY, COLORADO

LOCATION

JOB NUMBER

RM1185 D1916

TYPE OF SURVEY

COMPLETION REPORT

DATE

10-JAN-86

SURVEY BY  
WAYNE CRAIG

OFFICE  
RM 410

AR



CONOCO, INC.  
 MC CALLUM NO. 125  
 JACKSON COUNTY, COLORADO

PBHL : N 26 1 E

DATE PRINTED : 10-JAN-86  
 OUR REF. NO. : S02090.000  
 JOB NUMBER :

PAGE NO. 2

MEASURED DEPTH	DRIFT ANGLE		DRIFT DIRECTION		COURSE LENGTH	TRUE VERTICAL DEPTH	VERTICAL SECTION	RECTANGULAR COORDINATES		DUGLEO SEVERITY			
	D	M	D	M									
0.00	0	0	N	0	0 E	0.00	0.00	0.00	N	0.00	E	0.00	
118.00	0	15	S	77	0 E	118.00	0.06	0.06	S	0.25	E	0.21	
296.00	0	0	S	77	0 E	178.00	0.14	0.14	S	0.63	E	0.14	
543.00	1	0	N	76	0 E	247.00	1.53	0.38	N	2.72	E	0.40	
735.00	2	0	N	60	0 E	192.00	5.25	2.25	N	7.36	E	0.56	
952.00	1	30	N	68	0 E	217.00	951.82	10.48	5.16	N	13.32	E	0.26
1138.00	1	45	N	51	0 E	186.00	1137.74	14.86	7.82	N	17.84	E	0.29
1425.00	2	30	N	50	0 E	287.00	1424.54	24.54	14.59	N	26.06	E	0.26
1676.00	3	15	N	47	0 E	251.00	1675.22	36.18	22.94	N	35.49	E	0.30
1895.00	4	15	N	41	0 E	219.00	1893.75	49.79	33.23	N	45.43	E	0.49
2163.00	5	45	N	38	0 E	268.00	2160.73	72.50	51.26	N	60.29	E	0.57
2394.00	6	45	N	37	0 E	231.00	2390.35	97.15	71.21	N	75.59	E	0.44
2647.00	7	45	N	35	0 E	253.00	2641.32	128.59	97.03	N	94.36	E	0.41
2899.00	8	30	N	37	0 E	252.00	2890.79	163.66	125.85	N	115.29	E	0.32
3148.00	9	0	N	39	0 E	249.00	3136.89	200.72	155.69	N	138.61	E	0.24
3244.00	9	0	N	37	0 E	96.00	3231.71	215.40	167.53	N	147.86	E	0.33
3406.00	10	0	N	39	0 E	162.00	3391.49	241.56	188.60	N	164.32	E	0.65
3532.00	9	30	N	39	0 E	126.00	3515.67	262.35	205.18	N	177.75	E	0.40
3658.00	8	45	N	40	0 E	126.00	3640.07	281.78	220.60	N	190.46	E	0.61
3815.00	9	30	N	42	0 E	157.00	3795.08	305.83	239.39	N	206.79	E	0.52
3940.00	10	0	N	42	0 E	125.00	3918.28	326.18	255.12	N	220.95	E	0.40
4067.00	9	45	N	44	0 E	127.00	4043.40	347.01	271.04	N	235.81	E	0.33
4167.00	8	18	N	37	0 E	100.00	4142.16	362.18	282.96	N	245.99	E	1.82
4230.00	6	54	N	30	0 E	63.00	4204.60	370.44	289.91	N	250.58	E	2.66
4293.00	5	36	N	21	0 E	63.00	4267.23	377.29	296.09	N	253.53	E	2.58
4355.00	4	15	N	10	0 E	62.00	4328.99	382.52	301.21	N	254.95	E	2.65
4502.00	4	0	N	11	0 E	147.00	4475.61	392.70	311.61	N	256.88	E	0.18
4692.00	4	45	N	13	0 E	190.00	4665.06	406.77	325.79	N	259.89	E	0.40
4817.00	5	45	N	15	0 E	125.00	4789.53	417.95	336.88	N	262.66	E	0.81
4943.00	6	45	N	20	0 E	126.00	4914.78	431.51	349.96	N	266.78	E	0.90

CONTINUED ON NEXT PAGE ...



CONOCO, INC.  
MC CALLUM NO. 125  
JACKSON COUNTY, COLORADO

PBHL : N 26 1 E

DATE PRINTED : 10-JAN-86  
OUR REF. NO. : S02090.000  
JOB NUMBER :

PAGE NO. 3

MEASURED DEPTH	DRIFT ANGLE D M	DRIFT DIRECTION D M	COURSE LENGTH	TRUE VERTICAL DEPTH	VERTICAL SECTION	R E C T A N G U L A R C O O R D I N A T E S		DOGLEO SEVERITY
5092.00	7 0	N 22 0 E	149.00	5062.71	449.28	366.61 N	273.17 E	0.23
5219.00	6 45	N 25 0 E	127.00	5188.80	464.46	380.54 N	279.23 E	0.34
5376.00	6 15	N 25 0 E	157.00	5344.79	482.23	396.65 N	286.74 E	0.32
5483.00	6 0	N 26 0 E	107.00	5451.18	493.65	406.96 N	291.66 E	0.25
5577.00	5 45	N 27 0 E	94.00	5544.68	503.27	415.57 N	295.95 E	0.29
5639.00	5 45	N 30 0 E	62.00	5606.37	509.47	421.03 N	298.92 E	0.48
5891.00	6 0	N 33 0 E	252.00	5857.05	535.15	443.02 N	312.39 E	0.16

CLOSURE - DISTANCE : 542.08  
DIRECTION : N 35 11 E

REPORT UNITS : Feet  
SURVEY CALCULATION METHOD : Radius of curvature

SURVEY RUN INFORMATION

0' - 4067' SINGLE SHOT SURVEYS  
4067' - 4293' D.O.T. SURVEYS  
4293' - SINGLE SHOT SURVEYS  
11-28-85 / RM1185 D1916 / WAYNE CRAIG

--COMPLETION REPORT--



FINAL STATION:  
DEPTH: 5891.00 MD. 5857.05 TVD  
443.02 NORTH. 312.39 EAST  
CLOSURE: 542.08 AT N 35 11 E  
2043.02 FSL. 2187.61 FEL  
SECTION 3. T 9 N. R 79 W

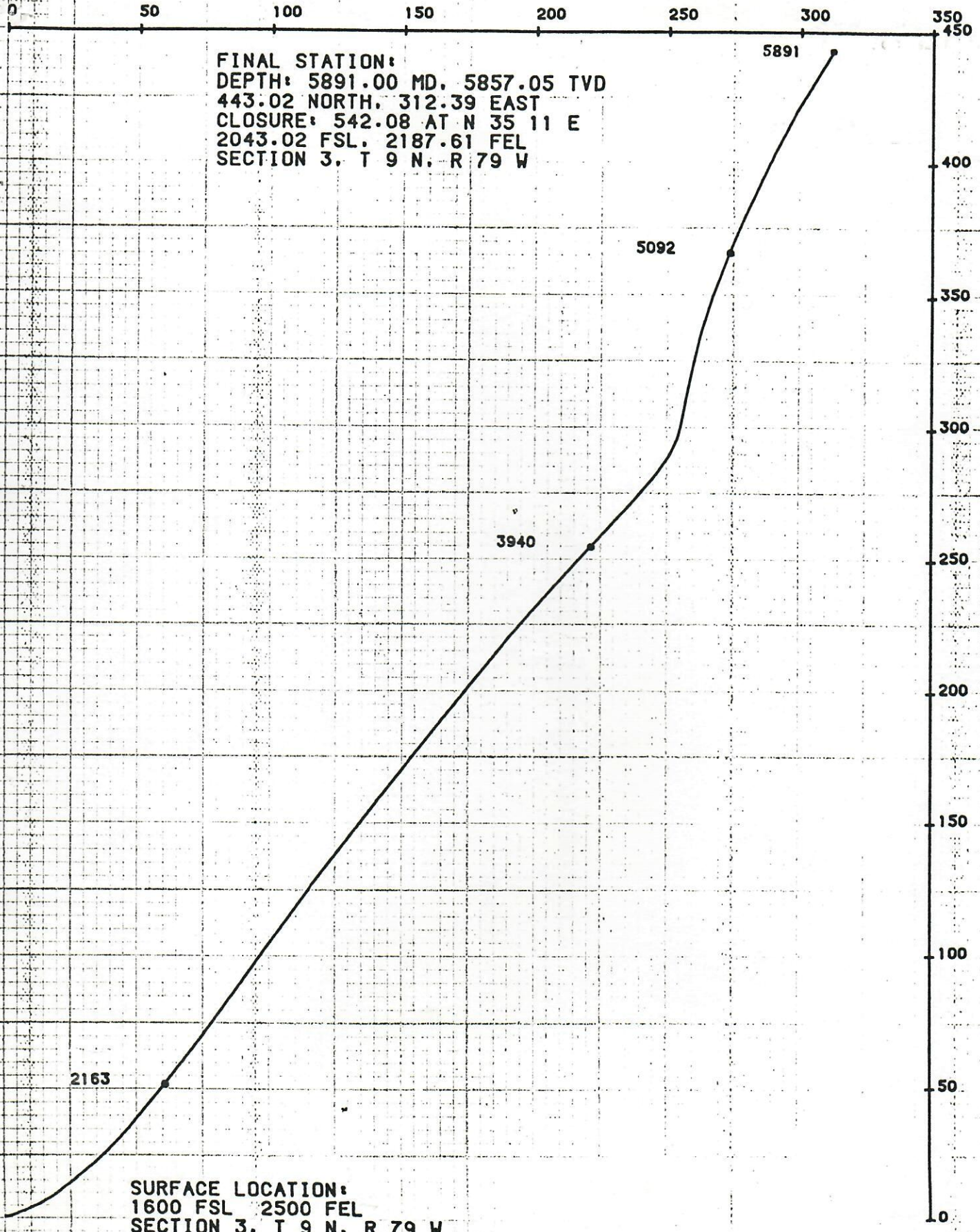

SURFACE LOCATION:  
1600 FSL 2500 FEL  
SECTION 3. T 9 N. R 79 W

SCALE 1"=50FT.

NOTE: COORDINATES RELATIVE  
TO SLOT

CONOCO, INC.  
MC CALLUM NO. 125  
JACKSON COUNTY, COLORADO

WELL: MC CALLUM #125

SLOT: 1