

RECEIVED

AUG 16 1978

U.S. COUNTY

T 9 N, R 78 W, 6th P.M.

PROJECT  
 CONTINENTAL OIL COMPANY  
 Well location, SOUTH McCALLUM UNIT  
 No 22-2, located as shown in the NW 1/4  
 SW 1/4 Section 22, T 9 N, R 78 W, 6th  
 P.M. Jackson County, Colorado.

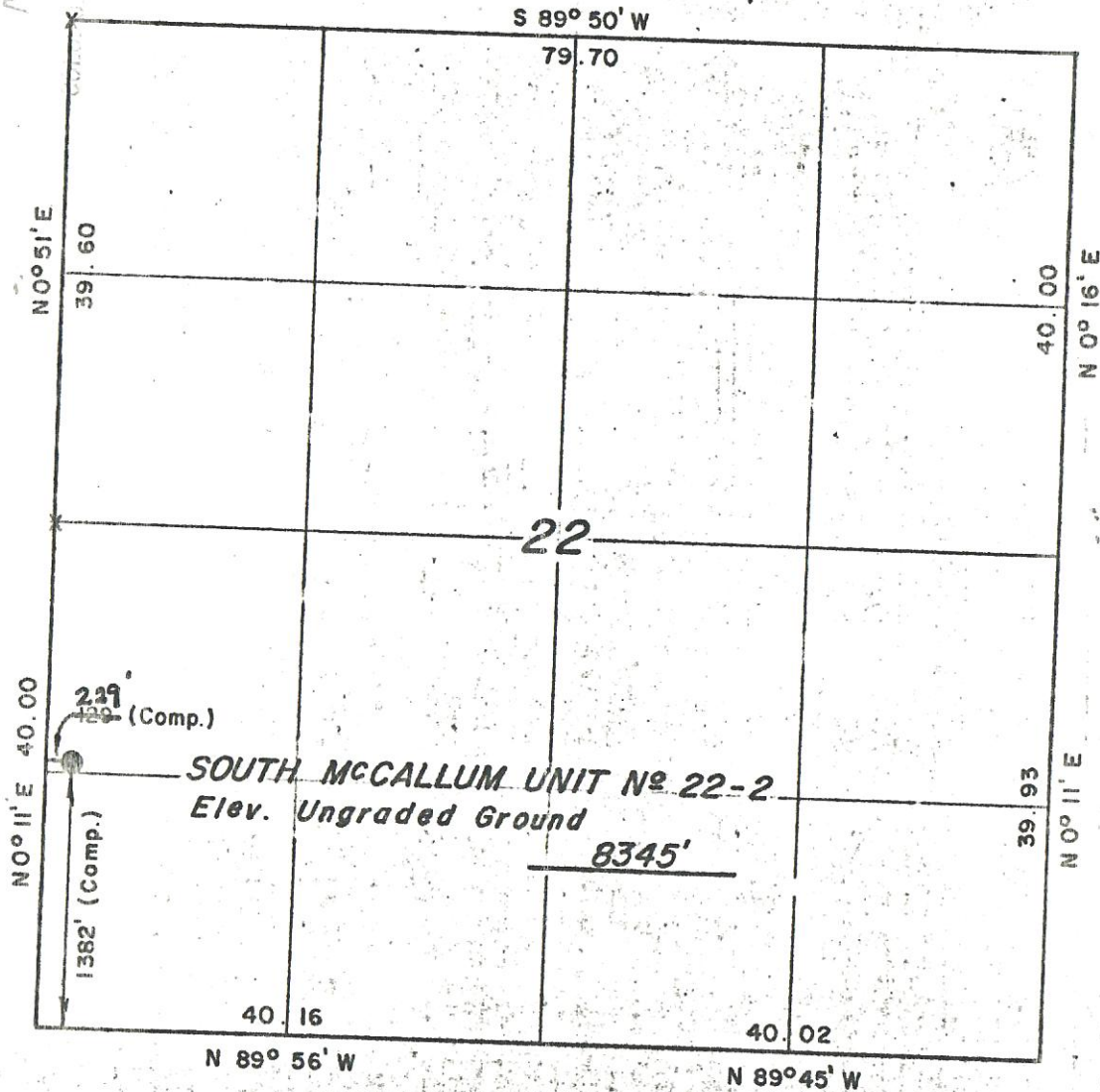

X = Section Corners Located



CERTIFICATE

THIS IS TO CERTIFY THAT THE ABOVE PLAT WAS PREPARED FROM  
 FIELD NOTES OF ACTUAL SURVEYS MADE BY ME OR UNDER MY  
 SUPERVISION AND THAT THE SAME ARE TRUE AND CORRECT TO THE  
 BEST OF MY KNOWLEDGE AND BELIEF.

*Robert James Bell*  
 REGISTERED LAND SURVEYOR  
 REGISTRATION No 5839  
 STATE OF COLORADO

Revised 8-7-78

UINTAH ENGINEERING & LAND SURVEYING  
 P.O. BOX Q - 110 EAST - FIRST SOUTH  
 VERNAL, UTAH - 84078

SCALE 1" = 1000'	DATE 4 / 26 / 78
PARTY R.K. S.S. J.B. B.N. BFW	REFERENCES GLO PK
WEATHER Cold	FILE