

Chevron Rockies Business Unit

Field Qualitative Criteria for ECMC Reporting Associated with the Discovery of Potentially Impacted Material

If answered **Yes** to any of the questions listed below, this may suggest the presence of potentially impacted materials as outlined in ECMC Rule 912. Out of an abundance of caution, a “Yes” response will be reported to the ECMC within 24 hours after discovery, regardless of laboratory results. **Immediately notify the RBU Remediation Team.** Include a copy of this Field Qualitative Spill Criteria Checklist in the field Report.

Please answer the following questions when on-site:

1. Is there visible petroleum hydrocarbon staining in the soil?
Yes
2. Does the soil sample from the stained area have a petroleum odor?
Yes
3. Is there a petroleum hydrocarbon sheen on the nearby surface water?
No
4. Does there appear to be a sheen of the surface of accumulated groundwater or seeps within the excavation indicative of petroleum?
No
5. Is stained soil in contact with groundwater?
No

Please Include relevant photos of the site conditions for items 1-5.

Location name: Great Western Sugar 1 (API #05-123-07599)

Please Circle Facility Type: Wellhead / Flowline

Form 19 Information Summary

Site Name	Great Western Sugar 1
API #	05-123-07599
REM #	42731
Facility ID	NA
Coordinates	40.332553, -104.891426 (FLR01@2')
S/T/R	NENE/9/4N/67W
Cause of Release	Presumed production activities
Date of Discovery	10/30/2025
Spill Type	Historical
Land Use	Grassland
Weather Conditions	40's and cloudy
Surface Water	Freshwater Pond 0.04mi SE, 0.09mi S
Number of Water Wells within ½ Mile Radius	20
Distance to Closest Water Well	0.12mi W
Approximate Depth to Groundwater	> 20 feet below ground surface
Distance to Nearest Wetland	Freshwater Emergent Wetland 0.16mi S
Sensitive Area / Habitat	<p>Aquatic Native Species Conservation Waters HPH 0.16mi SE</p> <p>Freshwater Pond 0.04/0.1mi SE, 0.09mi S, 0.11mi E</p> <p>Forested/Shrub Wetland 0.23mi SE, 0.24mi S</p> <p>Riverine 0.24mi SE</p> <p>Freshwater Emergent Wetland 0.16/0.25mi S</p> <p>Farm Structure</p> <p>0.06/0.07/0.09/0.11/0.12/0.13/0.14/0.15/1.6/0.2/0.24mi W, 0.09mi SW, 0.21mi E, 0.12mi NW</p>
100 Year Floodplain	No
Release in Municipality	No
Fluid Released	Presumed production fluids
Volume of Release	Unknown
Livestock Present	No
Closest Building	Farm Structure 0.06mi W
Soil Type(s)	SW
Disposal Facility	N/A
Excavation Dimensions	N/A
<p>Notes:</p> <p><i>On Thursday, October 30, 2025, Montrose personnel mobilized to the Great Western Sugar 1 wellhead location (40.332530, -104.891400) to collect confirmation soil samples and perform soil screening as part of flowline decommissioning activities. Soil sampling and screening locations were based on ECOMC regulations. During</i></p>	



decommissioning activities at the flowline riser sampling location (FLR01; 40.332553, -104.891426), visibly stained soil was observed, which produced a petroleum odor. A PID reading of 30.2 parts per million (ppm) was measured from this material at a depth of approximately two (2) feet below ground surface (bgs). Per Chevron guidance, a soil sample was collected from the FLR01 sample location at a depth of two (2) feet bgs (FLR01@2') and was submitted for the full ECMC Table 915-1 suite of analyses. Laboratory analyses are pending and will be submitted upon their receipt.

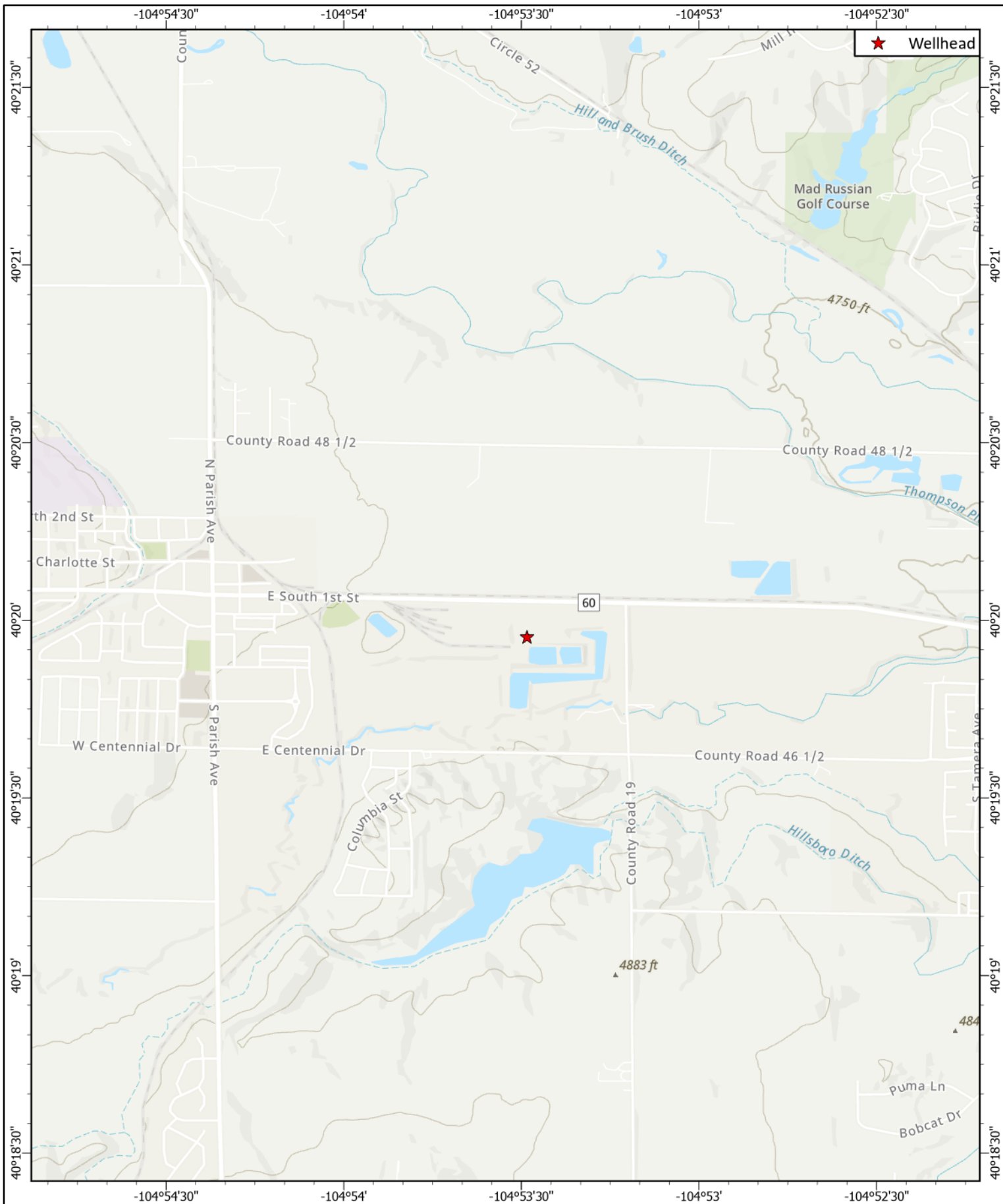

Topographic Map of Great Western Sugar 1

PDC-69175 Facility Number: 239811
 NENE/S9/T4N/R67W REM Number: 42731
 Weld County, Colorado API Number: 05-123-07599

Figure 1



Montrose Environmental Group
 Date: 10/30/2025

Reviewed By: H. Spencer
 Author: H. Judy

Coord. Sys.: GCS North American 1983



Montrose Environmental Group
Date: 10/30/2025

Reviewed By: H. Spencer
Author: H. Judy

Possible Release Location (10/30/2025)
Great Western Sugar 1

PDC-69175
NENE/S9/T4N/R67W
Weld County, Colorado

Facility Number: 239811
REM Number: 42731
API Number: 05-123-07599

Figure 2



Coord. Sys.: GCS North American 1983

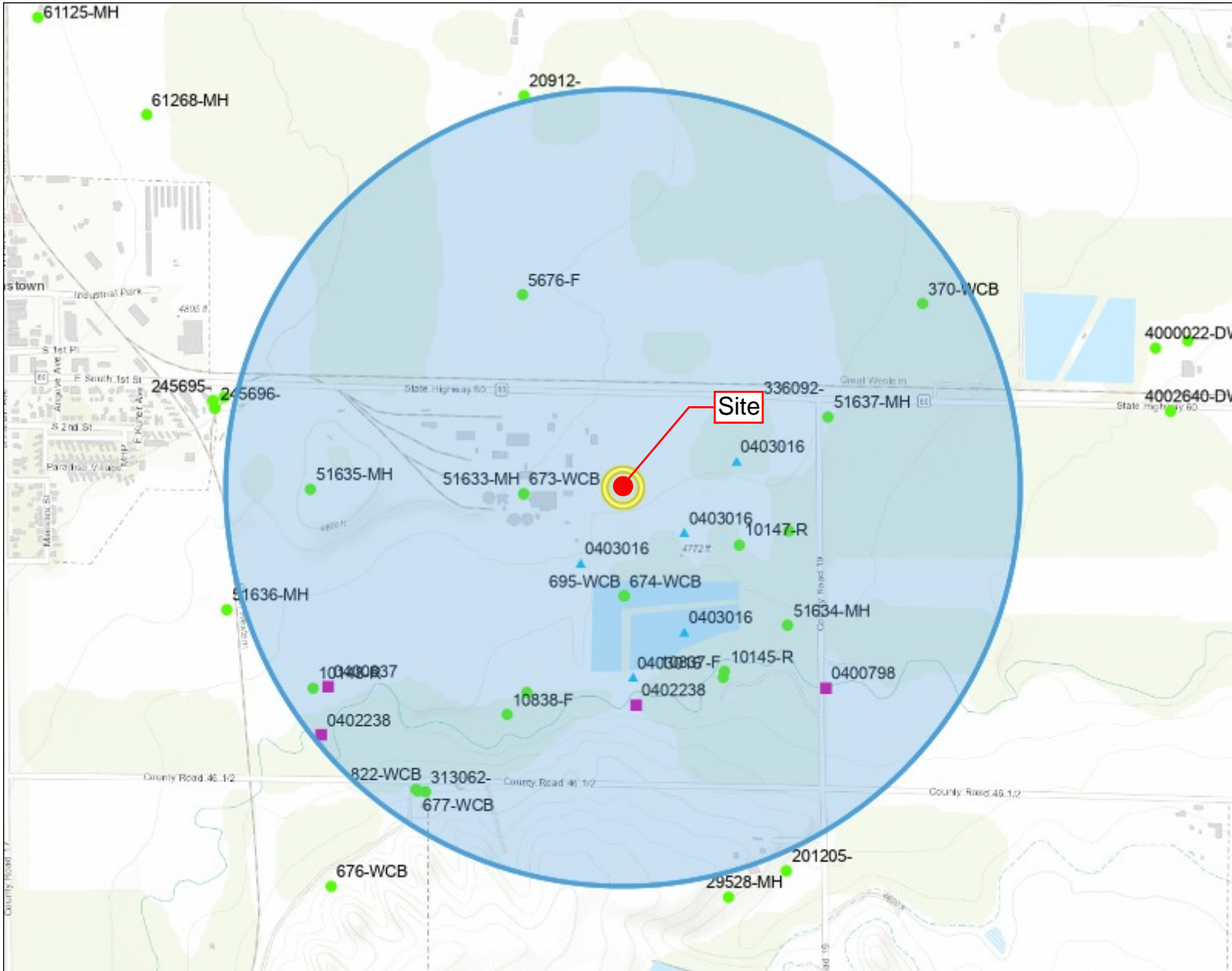

Legend

- Surface Water
- ▲ All Points of Interest
- Well Constructed
- Final Permit
- ✕ Geophysical Log
- ⊕ Active Gage - Diversion
- ⊕ Active Gage - Reservoir
- ⊕ Active Gage - Stream
- All Stations
- County

Location

Notes

Great Western Sugar 1
REM# 42731

2,000 0 1,000 2,000 Feet



1: 12,000



This product is for informational purposes and may not have been prepared for, or be suitable for legal, engineering, or surveying purposes. Users of this information should review or consult the primary data and information sources to ascertain the usability of the information.

Date Prepared: 10/30/2025 11:33:42 AM

National Flood Hazard Layer FIRMMette



104°53'48"W 40°20'11"N



Legend

SEE FIS REPORT FOR DETAILED LEGEND AND INDEX MAP FOR FIRM PANEL LAYOUT

- | | | |
|------------------------------------|--|---|
| SPECIAL FLOOD HAZARD AREAS | | Without Base Flood Elevation (BFE)
Zone A, V, A99 |
| | | With BFE or Depth Zone AE, AO, AH, VE, AR |
| | | Regulatory Floodway |
| OTHER AREAS OF FLOOD HAZARD | | 0.2% Annual Chance Flood Hazard, Areas of 1% annual chance flood with average depth less than one foot or with drainage areas of less than one square mile Zone X |
| | | Future Conditions 1% Annual Chance Flood Hazard Zone X |
| | | Area with Reduced Flood Risk due to Levee. See Notes. Zone X |
| | | Area with Flood Risk due to Levee Zone D |
| OTHER AREAS | | NO SCREEN Area of Minimal Flood Hazard Zone X |
| | | Effective LOMRs |
| GENERAL STRUCTURES | | Area of Undetermined Flood Hazard Zone D |
| | | Channel, Culvert, or Storm Sewer |
| | | Levee, Dike, or Floodwall |
| OTHER FEATURES | | Cross Sections with 1% Annual Chance Water Surface Elevation |
| | | Coastal Transect |
| | | Base Flood Elevation Line (BFE) |
| | | Limit of Study |
| | | Jurisdiction Boundary |
| MAP PANELS | | Coastal Transect Baseline |
| | | Profile Baseline |
| | | Hydrographic Feature |
| | | Digital Data Available |
| | | No Digital Data Available |
| | | Unmapped |

The pin displayed on the map is an approximate point selected by the user and does not represent an authoritative property location.

This map complies with FEMA's standards for the use of digital flood maps if it is not void as described below. The basemap shown complies with FEMA's basemap accuracy standards

The flood hazard information is derived directly from the authoritative NFHL web services provided by FEMA. This map was exported on 10/30/2025 at 5:22 PM and does not reflect changes or amendments subsequent to this date and time. The NFHL and effective information may change or become superseded by new data over time.

This map image is void if the one or more of the following map elements do not appear: basemap imagery, flood zone labels, legend, scale bar, map creation date, community identifiers, FIRM panel number, and FIRM effective date. Map images for unmapped and unmodernized areas cannot be used for regulatory purposes.

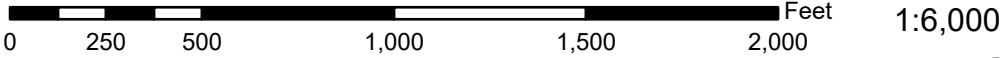

Basemap Imagery Source: USGS National Map 2023

Great Western Sugar 1 REM# 42731



-  National Wetlands Inventory (USF)
-  Freshwater Emergent
-  Freshwater Forested/Shrub
-  Freshwater Pond
-  Freshwater Lake
-  Riverine
-  Other
-  Aerial Imagery
-  2021 (NAIP)

Client Name: Chevron	Project Name: Great Western Sugar 1	Project Location: 40.332530, -140.891400	REM Number: 42731
--------------------------------	---	--	-----------------------------

Photo: 1	Date: 10/30/2025	Description: Representative picture of general conditions at soil sample location FLR01 (flowline riser; 40.332553, -104.891426) in well graded sand (SW) (PID: 30.2 ppm). Soil staining and petroleum odor observed.
--------------------	----------------------------	--



Photo: 2	Date: 10/30/2025	Description: Soil staining in well graded sand (SW) at sample location FLR01 (40.332553, -104.891426) at a depth of approximately two (2) feet bgs (PID: 30.2 ppm).
--------------------	----------------------------	--



Client Name: Chevron	Project Name: Great Western Sugar 1	Project Location: 40.332530, -140.891400	REM Number: 42731
--------------------------------	---	--	-----------------------------

Photo: 3	Date: 10/30/2025	Description: Soil staining in well graded sand (SW) at sample location FLR01 (40.332553, -104.891426) at a depth of approximately two (2) feet bgs (PID: 30.2 ppm).
--------------------	----------------------------	--



Photo: 4	Date: 10/30/2025	Description: Representative picture of general conditions at soil sampling location FLR01 (40.332553, -104.891426) in well graded sand (SW) (PID: 30.2 ppm). Soil staining and petroleum odor observed.
--------------------	----------------------------	--



TABLE 1
FIELD DATA SUMMARY TABLE
PDC 69175
GREAT WESTERN SUGAR 1, WELD COUNTY, COLORADO
REM # 42731

Sample ID	Sample Date	Depth (ft)	GPS Data Latitude/Longitude		PDOP Value	VOC Concentration (ppm)
FLR01@2'	10/30/2025	2.0	40.332553	104.891426	0.9	30.2

1. Global Positioning System (GPS) data is provided in decimal degrees using North American Datum (NAD) 83 UTMZone 13 North.

2. Volatile organic compound (VOC) concentrations are measured in the field using a photoionization detector (PID).

PDOP = Position Dilution of Precision

ppm = Parts per million

in. = Inches

ft. = Feet

bgs = Below ground surface