

Zisch 23-6

SWSW Sec. 6-T3N-R68W

API #: 123-36900

Facility ID: 472749

Remediation Project #: 40005

Wellhead and Flowline Decommissioning Package

July & August 2025

Prepared by Tasman, Inc.



On behalf of Crestone Peak Resources Operating, LLC



FIELD NOTES AND PHOTO LOG

WELLHEAD AND FLOWLINE DECOMMISSIONING



Civitas Decommissioning Form

SITE NAME: Zisch 23-6								DATE: 7/10/2025 - 8/4/2025		REM. PROJECT #: 40005		WEATHER: 75 (F), Cloudy	
SITE DIRECTIONS: Weld Co Rd 36 & E Co Line Rd, E 0.12 mi, N 0.06 mi INTO								CLIENT: Crestone Peak Resources Operating, LLC					
LEGALS AND LAT/LONG: 40.248285, -105.052816								TASMAN PERSONNEL: Isabel Eikermann					
SOIL TYPES: SM - silty sand, SC - Clayey sand, & ML - Silt								SURFACE GRADIENT: North					
SURROUNDING LAND USE: Rangeland								CROP: N/A					
SOIL SAMPLING								FACILITY INFRASTRUCTURE					
Date/Time	Soil Sample ID	PID (ppm)	Visual	Olfactory	Photo? (Y/N)	USCS	Lab (Y/N)	EQUIPMENT		Quantity			
								Above Ground Storage Tank (AST)					
7/10/2025 09:30	WH-B01@6'	0.2	No Staining	No Odor	Y	SM	Y	Produced Water Vessel (PWV)					
7/10/2025 09:35	WH-N01@5'	0.9	No Staining	No Odor	Y	SM	N	Separator (SEP)					
7/10/2025 09:40	WH-S01@5'	0.4	No Staining	No Odor	Y	SM	N	Emission Control Device (ECD)					
7/10/2025 09:45	WH-E01@5'	1.4	No Staining	No Odor	Y	SM	N	Dump Line (DL)					
7/10/2025 09:50	WH-W01@5'	0.8	No Staining	No Odor	Y	SM	N	Wellhead (WH)		1			
7/10/2025 09:55	WHS-N01@3"	0.3	No Staining	No Odor	Y	SW	N	Flowline (FL)		1			
7/10/2025 10:00	WHS-E01@3"	0.4	No Staining	No Odor	Y	SW	N	FL Method of Closure		Abandoned in Place			
7/10/2025 10:05	WHS-W01@3"	0.9	No Staining	No Odor	Y	SW	N	FL Footage Removed					
7/10/2025 10:10	FL-B01@4'	0.1	No Staining	No Odor	Y	SM	Y	Footaged Abandoned in Place		1920			
7/10/2025 10:15	FL-B02@4'	0.1	No Staining	No Odor	Y	SM	Y	Other:					
7/31/2025 14:00	FL-B03@4'	0.1	No Staining	No Odor	Y	SC	N	Soil Loads Removed					
7/31/2025 14:05	FL-B04@4'	0.0	No Staining	No Odor	Y	SC	Y	IMPACTED SOIL IDENTIFIED? Yes					
7/31/2025 14:10	FL-B05@4'	0.0	No Staining	No Odor	Y	SC	N	ESTIMATED VOLUME OF IMPACTS: Assessment Activities Ongoing					
7/31/2025 14:15	FL-B06@4'	0.0	No Staining	No Odor	Y	SC	N	Date	Number	CY			
7/31/2025 14:20	FL-B07@4'	0.0	No Staining	No Odor	Y	SC	N						
7/31/2025 14:25	FL-B08@4'	0.0	No Staining	No Odor	Y	SC	N						
7/31/2025 14:30	FL-B09@4'	1.3	No Staining	No Odor	Y	SC	N						
7/31/2025 14:35	FL-B10@4'	1.3	No Staining	No Odor	Y	SC	N						
7/31/2025 14:40	FL-B11@4'	1.1	No Staining	No Odor	Y	SC	N	Total Removed		0	0		
7/31/2025 14:45	FL-B12@4'	2.3	No Staining	No Odor	Y	SC	N	Disposal Facility:					
7/31/2025 14:50	FL-B13@4'	0.9	No Staining	No Odor	Y	SC	Y	Groundwater Recovery					
7/31/2025 14:55	FL-B14@4'	0.3	No Staining	No Odor	Y	SC	Y	DATE GW ENCOUNTERED: N/A		DEPTH:			
8/4/2025 12:00	BG01@4'	0.2	No Staining	No Odor	Y	ML	Y	GROUNDWATER IN CONTACT WITH IMPACTED SOIL?					
8/4/2025 12:05	BG01@6'	0.5	No Staining	No Odor	Y	ML	Y						
8/4/2025 12:10	BG02@4'	0.4	No Staining	No Odor	Y	ML	Y	LNAPL OR SHEEN OBSERVED ON GW?					
GROUNDWATER SAMPLING								Date		BBLs			
Date/Time	Groundwater Sample ID	Depth Collected	Turbid?	Sheen?	Odor?	Photo?							
								Total Removed		0			
								Disposal Facility:					



Photographic Log

Equipment ID:		Equipment Type:		Equipment ID:		Equipment Type:	
Material:	Volume:	Contents:		Material:	Volume:	Contents:	
Notes/Conditions: Soil screening locations				Notes/Conditions: Soil sampling and screening locations			



Photographic Log

<p>Equipment ID: _____ Equipment Type: _____</p>			<p>Equipment ID: _____ Equipment Type: _____</p>		
<p>Material: _____</p>	<p>Volume: _____</p>	<p>Contents: _____</p>	<p>Material: _____</p>	<p>Volume: _____</p>	<p>Contents: _____</p>
<p>Notes/Conditions: Soil screening locations</p>			<p>Notes/Conditions: Soil sampling location</p>		



Photographic Log

<p>☉ 316°NW (T) ● 40°14'52"N, 105°2'50"W ±16ft ▲ 5162ft</p>			<p>☉ 338°N (T) ● 40°14'51"N, 105°3'9"W ±16ft ▲ 5171ft</p>		
<p>FL-B02@4' X</p> <p>10 Jul 2025, 11:30:25</p>			<p>FL-B03@4' X</p> <p>31 Jul 2025, 14:38:03</p>		
Equipment ID:		Equipment Type:	Equipment ID:		Equipment Type:
Material:	Volume:	Contents:	Material:	Volume:	Contents:
Notes/Conditions: Soil sampling location			Notes/Conditions: Soil screening location		



Photographic Log

<p>☉ 79°E (T) ● 40°14'50"N, 105°3'9"W ±16ft ▲ 5174ft</p>			<p>☉ 346°N (T) ● 40°14'50"N, 105°3'8"W ±16ft ▲ 5176ft</p>		
Equipment ID:			Equipment Type:		
Material:	Volume:	Contents:	Material:	Volume:	Contents:
Notes/Conditions: Soil sampling location			Notes/Conditions: Soil screening location		



Photographic Log

<p>☉ 98°E (T) ● 40°14'50"N, 105°3'6"W ±16ft ▲ 5176ft</p>			<p>☉ 81°E (T) ● 40°14'50"N, 105°3'3"W ±16ft ▲ 5173ft</p>		
<p>FL-B06@4' X</p> <p>31 Jul 2025, 15:03:30</p>			<p>FL-B07@4' X</p> <p>31 Jul 2025, 15:11:19</p>		
Equipment ID:		Equipment Type:	Equipment ID:		Equipment Type:
Material:	Volume:	Contents:	Material:	Volume:	Contents:
Notes/Conditions: Soil screening location			Notes/Conditions: Soil screening location		



Photographic Log

Equipment ID:		Equipment Type:		Equipment ID:		Equipment Type:	
Material:		Volume:		Material:		Volume:	
Contents:				Contents:			
Notes/Conditions: Soil screening location				Notes/Conditions: Soil screening location			



Photographic Log

<p>☉ 61°NE (T) ● 40°14'50"N, 105°2'56"W ±16ft ▲ 5166ft</p>			<p>☉ 52°NE (T) ● 40°14'50"N, 105°2'53"W ±16ft ▲ 5162ft</p>				
Equipment ID:		Equipment Type:		Equipment ID:		Equipment Type:	
Material:		Volume:		Material:		Volume:	
Contents:				Contents:			
Notes/Conditions: Soil screening location				Notes/Conditions: Soil screening location			



Photographic Log

☀ 26°NE (T) ● 40°14'50"N, 105°2'51"W ±49ft ▲ 5163ft			☀ 14°N (T) ● 40°14'50"N, 105°2'50"W ±16ft ▲ 5161ft		
31 Jul 2025, 15:53:14			31 Jul 2025, 15:58:02		
Equipment ID:			Equipment Type:		
Material:	Volume:	Contents:	Material:	Volume:	Contents:
Notes/Conditions: Soil screening location			Notes/Conditions: Soil sampling location		



Photographic Log

<p>⊙ 49°NE (T) ● 40°14'52"N, 105°2'51"W ±16ft ▲ 5161ft</p>			<p>⊙ 133°SE (T) ● 40°14'54"N, 105°3'11"W ±16ft ▲ 5163ft</p>		
<p>31 Jul 2025, 16:22:58</p>			<p>04 Aug 2025, 11:52:22</p>		
Equipment ID:		Equipment Type:	Equipment ID:		Equipment Type:
Material:	Volume:	Contents:	Material:	Volume:	Contents:
Notes/Conditions: Soil sampling location			Notes/Conditions: Background soil sampling location.		



Photographic Log

<p>NE 30 60 90 120 150 180 S 105°E (T) ● 40°14'53"N, 105°3'12"W ±16ft ▲ 5162ft BG02@4.6' X 04 Aug 2025 11:58:10</p>			<p>NE 30 60 90 120 150 180 S 97°E (T) ● 40°14'53"N, 105°3'12"W ±16ft ▲ 5163ft BG03@4.6' X 04 Aug 2025 12:03:32</p>		
Equipment ID:		Equipment Type:	Equipment ID:		Equipment Type:
Material:	Volume:	Contents:	Material:	Volume:	Contents:
Notes/Conditions: Background soil sampling location.			Notes/Conditions: Background soil sampling location.		



Photographic Log

<p style="text-align: center;">04 Aug 2025 12:26:17</p>			<p style="text-align: center;">04 Aug 2025 12:27:24</p>				
Equipment ID:		Equipment Type:		Equipment ID:		Equipment Type:	
Material:	Volume:	Contents:		Material:	Volume:	Contents:	
Notes/Conditions: Background soil sampling location.				Notes/Conditions: Background soil sampling location.			



Photographic Log



Equipment ID:		Equipment Type:		Equipment ID:		Equipment Type:	
Material:		Volume:		Material:		Volume:	
Contents:				Contents:			
Notes/Conditions: Background soil sample lithology.				Notes/Conditions:			

FIGURES

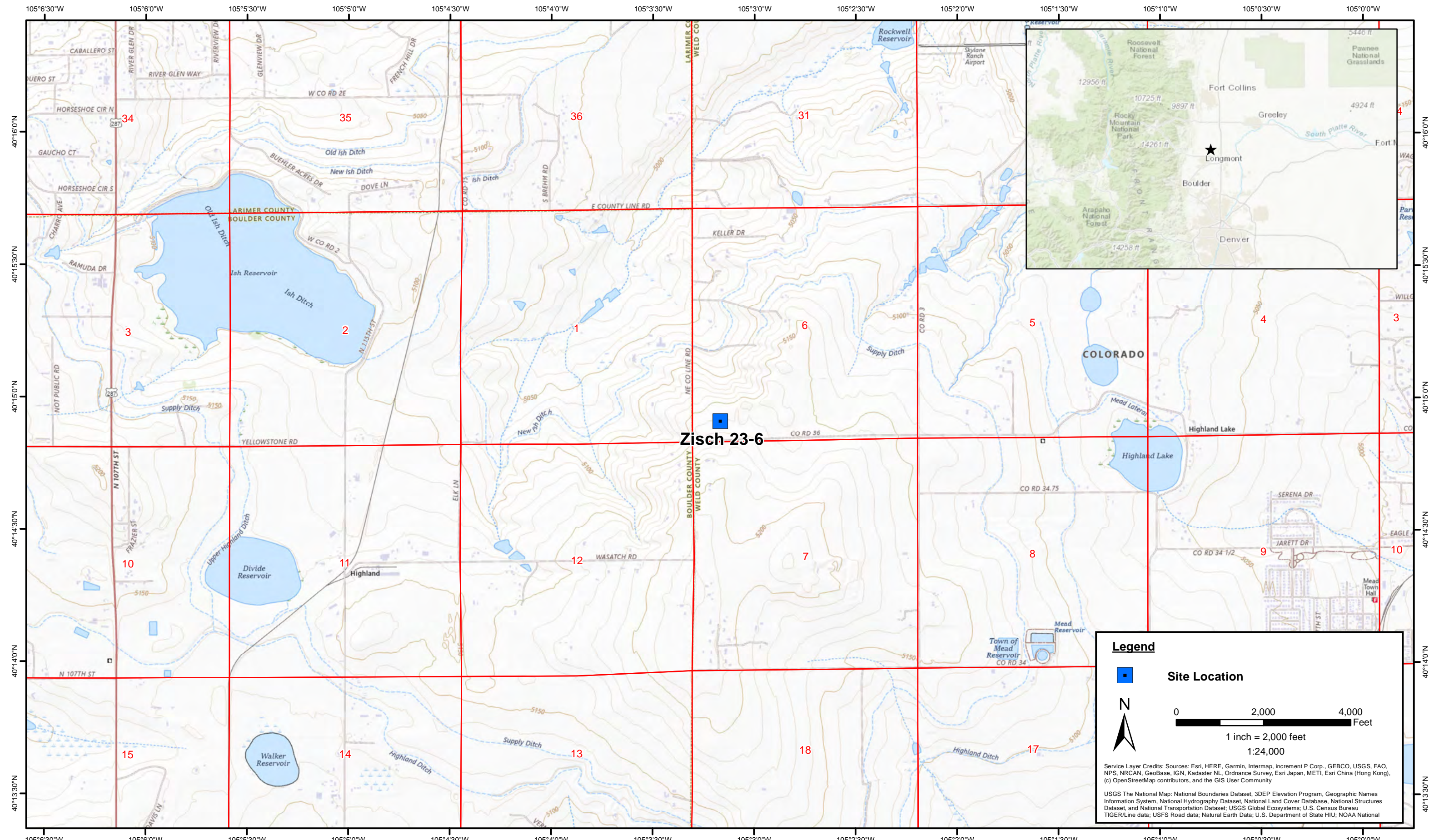

DATE: July 2025
 DESIGNED BY: S. Vogt
 DRAWN BY: J. Woffinden



Tasman, Inc.
 4725 Independence St.
 Wheat Ridge, CO 80033

Crestone Peak Resources Operating, LLC
Zisch 23-6
 SWSW Sec. 6-T3N-R68W
 Weld County, Colorado

Site Location Map

Figure
 1



Legend

- Soil sample location – Field Screened (Collected via Trimble GPS)
- Soil sample location – Below ECMC Table 915-1 Soil Standards (Collected via Trimble GPS)
- Excavation extent
- Flowline Location

Notes

Crestone Peak Resources Operating, LLC site infrastructure has been removed

All locations are approximate unless otherwise noted.

GPS = Global Positioning System

ECMC = Colorado Energy & Carbon Management Commission

0 ft. 10 ft. 20 ft.

Image Source: Google Earth

DATE:	September 25, 2025
DESIGNED BY:	S. Vogt
DRAWN BY:	A. Martin



Tasman, Inc.
 4725 Independence St.
 Wheat Ridge, CO 80033

Crestone Peak Resources Operating, LLC
 Zisch 23-6
 SWSW Sec. 6-T3N-R68W
 Weld County, Colorado

Wellhead Soil Sample
 Location Map
 (07/10/2025)

Figure
 2

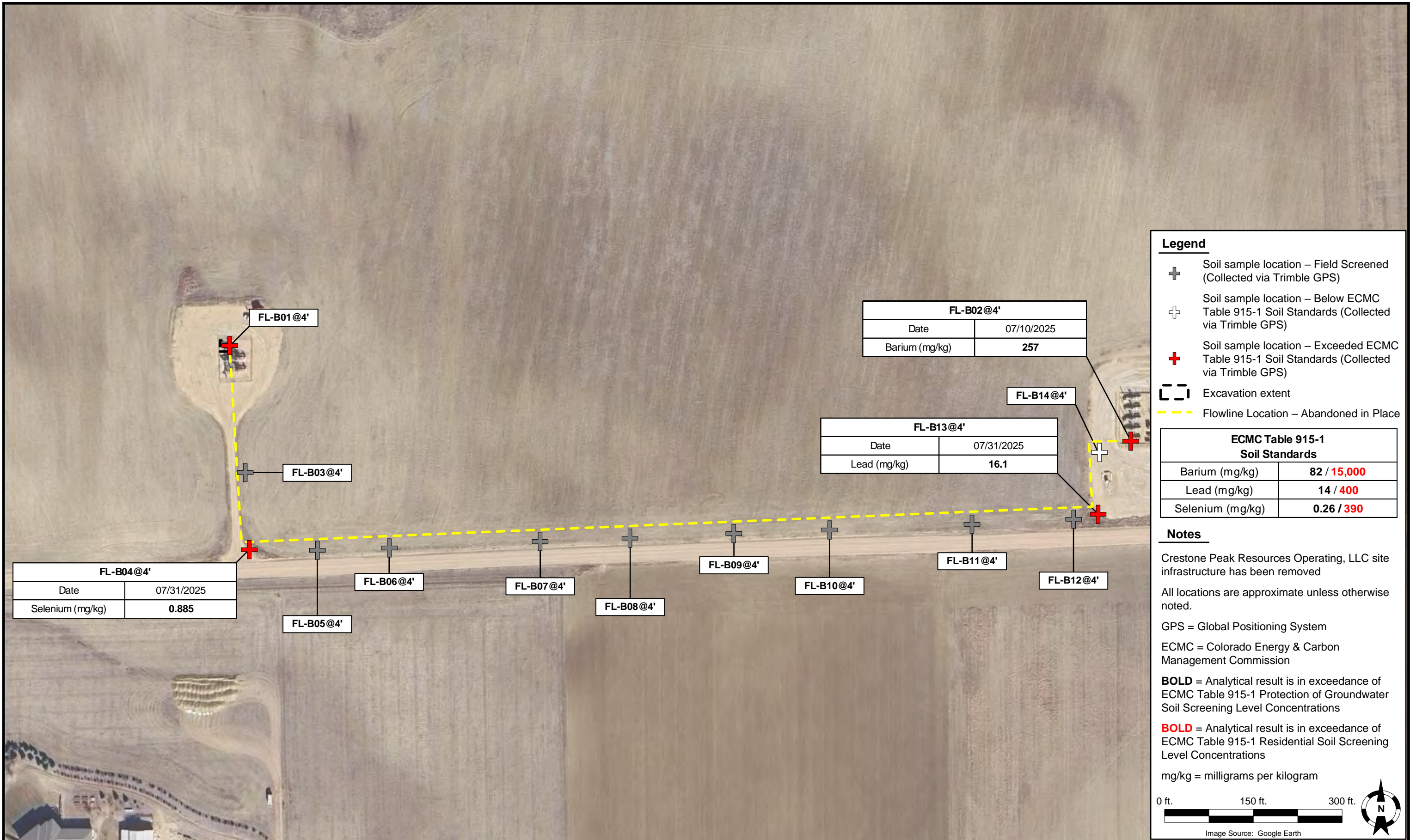

DATE: September 25, 2025

DESIGNED BY: S. Vogt

DRAWN BY: A. Martin



Tasman, Inc.
 4725 Independence St.
 Wheat Ridge, CO 80033

Crestone Peak Resources Operating, LLC
 Zisch 23-6
 SWSW Sec. 6-T3N-R68W
 Weld County, Colorado

Flowline Soil Sample
 Location Map
 (07/10/2025 & 07/31/2025)

Figure
 3



Legend

- Background soil sample location (Collected via Trimble GPS)
- Excavation extent
- Flowline Location

Notes

Crestone Peak Resources Operating, LLC site infrastructure has been removed.

All locations are approximate unless otherwise noted.

GPS = Global Positioning System

ECMC = Colorado Energy & Carbon Management Commission

0 ft. 150 ft. 300 ft.

Image Source: Google Earth

DATE:	September 25, 2025
DESIGNED BY:	S. Vogt
DRAWN BY:	A. Martin



Tasman, Inc.
 4725 Independence St.
 Wheat Ridge, CO 80033

Crestone Peak Resources Operating, LLC
 Zisch 23-6
 SWSW Sec. 6-T3N-R68W
 Weld County, Colorado

Background Soil Sample
 Location Map
 (08/04/2025)

Figure
 4

TABLES

TABLE 1
ZISCH 23-6
SOIL SAMPLE LOCATIONS
CRESTONE PEAK RESOURCES OPERATING, LLC



Soil Sample Location	Depth	Date	PID Reading (ppm)	Latitude	Longitude	GPS PDOP Value	Lab (Y/N)
WH-B01@6'	6'	07/10/2023	0.2	40.248274	-105.052809	-	Y
WH-N01@5'	5'	07/10/2023	0.9	40.248286	-105.052810	0.8	N
WH-S01@5'	5'	07/10/2023	0.4	40.248265	-105.052809	-	N
WH-E01@5'	5'	07/10/2023	1.4	40.248272	-105.052798	0.8	N
WH-W01@5'	5'	07/10/2023	0.8	40.248274	-105.052819	0.9	N
WHS-N01@3"	3"	07/10/2023	0.3	40.248289	-105.052811	0.8	N
WHS-E01@3"	3"	07/10/2023	0.4	40.248272	-105.052794	0.9	N
WHS-W01@3"	3"	07/10/2023	0.9	40.248276	-105.052829	0.9	N
FL-B01@4'	4'	07/10/2023	0.1	40.248274	-105.052786	0.8	Y
FL-B02@4'	4'	07/10/2023	0.1	40.247833	-105.047325	0.9	Y
FL-B03@4'	4'	07/31/2025	0.1	40.247689	-105.052680	0.8	N
FL-B04@4'	4'	07/31/2025	0.0	40.247343	-105.052600	0.7	Y
FL-B05@4'	4'	07/31/2025	0.0	40.247320	-105.052249	0.7	N
FL-B06@4'	4'	07/31/2025	0.0	40.247335	-105.051815	0.7	N
FL-B07@4'	4'	07/31/2025	0.0	40.247369	-105.050899	0.7	N
FL-B08@4'	4'	07/31/2025	0.0	40.247383	-105.050347	0.8	N
FL-B09@4'	4'	07/31/2025	1.3	40.247401	-105.049727	0.8	N
FL-B10@4'	4'	07/31/2025	1.3	40.247415	-105.049145	0.7	N
FL-B11@4'	4'	07/31/2025	1.1	40.247437	-105.048281	0.8	N
FL-B12@4'	4'	07/31/2025	2.3	40.247457	-105.047666	0.7	N
FL-B13@4'	4'	07/31/2025	0.9	40.247468	-105.047479	0.7	Y
FL-B14@4'	4'	07/31/2025	0.3	40.247808	-105.047482	0.8	Y
BACKGROUND							
BG01@4'	4'	08/04/2025	0.2	40.248390	-105.053314	1.0	Y
BG01@6'	6'	08/04/2025	0.5	40.248390	-105.053314	1.0	Y
BG02@4'	4'	08/04/2025	0.4	40.248313	-105.053317	0.9	Y
BG02@6'	6'	08/04/2025	1.2	40.248313	-105.053317	0.9	Y
BG03@4'	4'	08/04/2025	0.7	40.248228	-105.053349	1.2	Y
BG03@6'	6'	08/04/2025	0.7	40.248228	-105.053349	1.2	Y
BG04@4'	4'	08/04/2025	0.3	40.248155	-105.053320	1.0	Y
BG04@6'	6'	08/04/2025	0.9	40.248155	-105.053320	1.0	Y
BG05@4'	4'	08/04/2025	0.9	40.248082	-105.053322	1.0	Y
BG05@6'	6'	08/04/2025	0.1	40.248082	-105.053322	1.0	Y

Notes:

PID = Photoionization Detector

ppm = parts per million

GPS = Global Positioning System

PDOP = Position Dilution of Precision

TABLE 1
ZISCH 23-6
SOIL SAMPLE LOCATIONS
CRESTONE PEAK RESOURCES OPERATING, LLC



Soil Sample Location	Depth	Date	PID Reading (ppm)	Latitude	Longitude	GPS PDOP Value	Lab (Y/N)
----------------------	-------	------	-------------------	----------	-----------	----------------	-----------

- = Not applicable



TABLE 2
ZISCH 23-6
SOIL ANALYTICAL DATA - VOCs
CRESTONE PEAK RESOURCES OPERATING, LLC

Soil Sample Location	Depth	Date	Benzene (mg/kg)	Toluene (mg/kg)	Ethylbenzene (mg/kg)	Total Xylenes (mg/kg)	Naphthalene (mg/kg)	TVPH-GRO (mg/kg)	TEPH-DRO (mg/kg)	TEPH-ORO (mg/kg)	1,2,4-TMB (mg/kg)	1,3,5-TMB (mg/kg)
ECMC Organic Compounds in Soils - GSSL ⁽¹⁾			0.0026	0.69	0.78	9.9	0.0038	500			0.0081	0.0087
ECMC Organic Compounds in Soils - RSSL ⁽²⁾			1.2	490	5.8	58	2	500			30	27
WH-B01@6'	6'	07/10/2023	<0.0012	<0.0023	<0.0023	<0.0023	<0.0023	<0.23	<4.2	<6.3	<0.0023	<0.0023
FL-B01@4'	4'	07/10/2023	<0.0012	<0.0024	<0.0024	<0.0024	<0.0025	<0.24	<4.8	<7.2	<0.0024	<0.0024
FL-B02@4'	4'	07/10/2023	<0.0012	<0.0023	<0.0023	<0.0023	<0.0025	<0.23	<4.3	<6.5	<0.0023	<0.0023
FL-B04@4'	4'	07/31/2025	<0.00100	<0.0100	<0.0100	<0.100	<0.00300	<2.50	<4.00	4.57	<0.00500	<0.00500
FL-B13@4'	4'	07/31/2025	<0.00100	<0.0100	<0.0100	<0.100	<0.00300	<2.50	<4.00	4.32	<0.00500	<0.00500
FL-B14@4'	4'	07/31/2025	<0.00100	<0.0100	<0.0100	<0.100	<0.00300	<2.50	<4.00	3.25	<0.00500	<0.00500

Notes:

VOCs = Volatile Organic Compounds

(1) Standards for soil are taken from ECMC Table 915-1: Organic Compounds in Soils - Protection of Groundwater Soil Screening Level Concentrations (Effective January 15, 2021)

(2) Standards for soil are taken from ECMC Table 915-1: Organic Compounds in Soils - Residential Soil Screening Level Concentrations (Effective January 15, 2021)

ECMC = Colorado Energy & Carbon Management Commission

GSSL = Protection of Groundwater Soil Screening Level

RSSL = Residential Soil Screening Level

(<) = Analytical result is less than the indicated laboratory detection limit

mg/kg = milligrams per kilogram

TVPH - GRO = Total Volatile Petroleum Hydrocarbons - Gasoline Range Organics

TEPH - DRO = Total Extractable Petroleum Hydrocarbons - Diesel Range Organics

TEPH - ORO = Total Extractable Petroleum Hydrocarbons - Oil Range Organics

1,2,4 - TMB = 1,2,4 - Trimethylbenzene

1,3,5 - TMB = 1,3,5 - Trimethylbenzene

BOLD = Analytical result is in exceedance of ECMC Table 915-1: Organic Compounds in Soils - Protection of Groundwater Soil Screening Level Concentrations

BOLD = Analytical result is in exceedance of ECMC Table 915-1: Organic Compounds in Soils - Residential Soil Screening Level Concentrations



TABLE 3
ZISCH 23-6
SOIL ANALYTICAL DATA - PAHs
CRESTONE PEAK RESOURCES OPERATING, LLC

Soil Sample Location	Depth	Date	Acenaphthene (mg/kg)	Anthracene (mg/kg)	Benzo(a)A (mg/kg)	Benzo(b)F (mg/kg)	Benzo(k)F (mg/kg)	Benzo(a)P (mg/kg)	Chrysene (mg/kg)	D (a,h) A (mg/kg)	Fluoranthene (mg/kg)	Fluorene (mg/kg)	1,2,3-CD (mg/kg)	1-M (mg/kg)	2-M (mg/kg)	Pyrene (mg/kg)
ECMC Organic Compounds in Soils - GSSL ⁽¹⁾			0.55	5.8	0.011	0.3	2.9	0.24	9	0.96	8.9	0.54	0.98	0.006	0.019	1.3
ECMC Organic Compounds in Soils - RSSL ⁽²⁾			360	1,800	1.1	1.1	11	0.11	110	0.11	240	240	1.1	18	24	180
WH-B01@6'	6'	07/10/2023	<0.0047	<0.0047	<0.0059	<0.0047	<0.0047	<0.0047	<0.0047	<0.0047	<0.0047	<0.0047	<0.0047	<0.0047	<0.0047	<0.0047
FL-B01@4'	4'	07/10/2023	<0.0050	<0.0062	<0.0050	<0.0050	<0.0050	<0.0050	<0.0050	<0.0050	<0.0050	<0.0050	<0.0050	<0.0050	<0.0050	<0.0050
FL-B02@4'	4'	07/10/2023	<0.0050	<0.0062	<0.0050	<0.0050	<0.0050	<0.0050	<0.0050	<0.0050	<0.0050	<0.0050	<0.0050	<0.0050	<0.0050	<0.0050
FL-B04@4'	4'	07/31/2025	<0.0330	<0.0330	<0.00600	<0.0330	<0.0330	<0.0330	<0.0330	<0.0330	<0.0330	<0.0330	<0.0330	<0.00300	<0.0120	<0.0330
FL-B13@4'	4'	07/31/2025	<0.0330	<0.0330	<0.00600	<0.0330	<0.0330	<0.0330	<0.0330	<0.0330	<0.0330	<0.0330	<0.0330	<0.00300	<0.0120	<0.0330
FL-B14@4'	4'	07/31/2025	<0.0330	<0.0330	<0.00600	<0.0330	<0.0330	<0.0330	<0.0330	<0.0330	<0.0330	<0.0330	<0.0330	<0.00300	<0.0120	<0.0330

Notes:

PAHs = Polycyclic Aromatic Hydrocarbons

(1) Standards for soil are taken from ECMC Table 915-1: Organic Compounds in Soils - Protection of Groundwater Soil Screening Level Concentrations (Effective January 15, 2021)

(2) Standards for soil are taken from ECMC Table 915-1: Organic Compounds in Soils - Residential Soil Screening Level Concentrations (Effective January 15, 2021)

ECMC = Colorado Energy & Carbon Management Commission

GSSL = Protection of Groundwater Soil Screening Level

RSSL = Residential Soil Screening Level

(<) = Analytical result is less than the indicated laboratory detection limit

mg/kg = milligrams per kilogram

Benzo(a)A = Benzo(a)Anthracene

Benzo(b)F = Benzo(b)Fluoranthene

Benzo(k)F = Benzo(k)Fluoranthene

Benzo(a)P = Benzo(a)Pyrene

D (a,h) A = Dibenz(a,h)Anthracene

1,2,3-CD = Indeno(1,2,3-cd)Pyrene

1-M = 1-Methylnaphthalene

2-M = 2-Methylnaphthalene

BOLD = Analytical result is in exceedance of ECMC Table 915-1: Organic Compounds in Soils - Protection of Groundwater Soil Screening Level Concentrations

BOLD = Analytical result is in exceedance of ECMC Table 915-1: Organic Compounds in Soils - Residential Soil Screening Level Concentrations



TABLE 4
ZISCH 23-6
SOIL ANALYTICAL DATA - METALS
CRESTONE PEAK RESOURCES OPERATING, LLC

Soil Sample Location	Depth	Date	Arsenic (mg/kg)	Barium (mg/kg)	Cadmium (mg/kg)	Chromium (VI) (mg/kg)	Copper (mg/kg)	Lead (mg/kg)	Nickel (mg/kg)	Selenium (mg/kg)	Silver (mg/kg)	Zinc (mg/kg)
ECMC Metals in Soils - GSSL ⁽¹⁾			0.29	82	0.38	0.00067	46	14	26	0.26	0.8	370
ECMC Metals in Soils - RSSL ⁽²⁾			0.68	15,000	71	0.3	3,100	400	1,500	390	390	23,000
WH-B01@6'	6'	07/10/2023	3.4*	35.2	<0.12	<0.47	2.9	7.5	8.9	<0.47	<0.12	28.0
FL-B01@4'	4'	07/10/2023	4.6*	203*	0.14	<0.52	9.3	10.4	11.8	<0.50	<0.13	42.1
FL-B02@4'	4'	07/10/2023	4.6*	257	0.14	<0.52	9.5	10.4	11.7	<0.47	<0.12	42.2
FL-B04@4'	4'	07/31/2025	5.98*	101*	0.123	<0.200	10.3	11.7	15.7	0.885	<0.500	52.6
FL-B13@4'	4'	07/31/2025	6.42*	158*	0.263	0.211*	17.3	16.1	20.6	0.613*	<0.500	81.6
FL-B14@4'	4'	07/31/2025	6.26*	161*	0.199	0.351*	16.4	14.8*	19.9	0.609*	<0.500	78.9
BACKGROUND												
BG01@4'	4'	08/04/2025	2.63	71.2	<0.100	<0.200	<10.0	<10.0	<10.0	0.187	<0.500	<50.0
BG01@6'	6'	08/04/2025	1.95	57.6	<0.100	<0.200	<10.0	<10.0	<10.0	0.183	<0.500	<50.0
BG02@4'	4'	08/04/2025	5.96	155	0.152	0.348	12.8	11.9	15.7	0.421	<0.500	58.0
BG02@6'	6'	08/04/2025	4.48	175	<0.100	0.315	<10.0	<10.0	12.0	0.267	<0.500	<50.0
BG03@4'	4'	08/04/2025	5.79	146	0.139	0.241	11.5	10.9	14.6	0.347	<0.500	51.8
BG03@6'	6'	08/04/2025	2.92	77.4	<0.100	<0.200	<10.0	<10.0	<10.0	0.319	<0.500	<50.0
BG04@4'	4'	08/04/2025	7.48	165	0.145	0.250	11.3	10.6	14.2	0.651	<0.500	<50.0
BG04@6'	6'	08/04/2025	3.95	104	<0.100	<0.200	<10.0	<10.0	<10.0	0.427	<0.500	<50.0
BG05@4'	4'	08/04/2025	3.46	86.5	<0.100	<0.200	<10.0	<10.0	<10.0	0.420	<0.500	<50.0
BG05@6'	6'	08/04/2025	2.95	80.3	<0.100	<0.200	<10.0	<10.0	<10.0	0.388	<0.500	<50.0
Highest Background @ 4' - 6' x1.25 (ML)			9.35	219	0.190	0.435	16.0	14.9	19.6	0.814	-	72.5

Notes:

(1) Standards for soil are taken from ECMC Table 915-1: Metals in Soils - Protection of Groundwater Soil Screening Level Concentrations (Effective January 15, 2021)

(2) Standards for soil are taken from ECMC Table 915-1: Metals in Soils - Residential Soil Screening Level Concentrations (Effective January 15, 2021)

ECMC = Colorado Energy & Carbon Management Commission



TABLE 4
ZISCH 23-6
SOIL ANALYTICAL DATA - METALS
CRESTONE PEAK RESOURCES OPERATING, LLC

Soil Sample Location	Depth	Date	Arsenic (mg/kg)	Barium (mg/kg)	Cadmium (mg/kg)	Chromium (VI) (mg/kg)	Copper (mg/kg)	Lead (mg/kg)	Nickel (mg/kg)	Selenium (mg/kg)	Silver (mg/kg)	Zinc (mg/kg)
ECMC Metals in Soils - GSSL ⁽¹⁾			0.29	82	0.38	0.00067	46	14	26	0.26	0.8	370
ECMC Metals in Soils - RSSL ⁽²⁾			0.68	15,000	71	0.3	3,100	400	1,500	390	390	23,000

GSSL = Protection of Groundwater Soil Screening Level

RSSL = Residential Soil Screening Level

(<) = Analytical result is less than the indicated laboratory detection limit

Chromium (VI) = Hexavalent Chromium

mg/kg = milligrams per kilogram

ML = Silt

BOLD = Analytical result is in exceedance of ECMC Table 915-1: Metals in Soils - Protection of Groundwater Soil Screening Level Concentrations

BOLD = Analytical result is in exceedance of ECMC Table 915-1: Metals in Soils - Residential Soil Screening Level Concentrations

Highest background concentration x1.25

Italics = Laboratory minimum detection limit exceeds the ECMC Table 915-1 Standard

* Result exceeded the ECMC Table 915-1 standard, but was within site-specific 1.25x background multiplier levels

TABLE 5
ZISCH 23-6
SOIL ANALYTICAL DATA - SOIL RECLAMATION
CRESTONE PEAK RESOURCES OPERATING, LLC



Soil Sample Location	Depth	Date	pH	SAR	EC (mmhos/cm)	Boron (mg/L)
ECMC Soil Suitability for Reclamation⁽¹⁾			6 - 8.3	< 6	< 4	2
WH-B01@6'	6'	07/10/2023	8.53*	0.799	0.51	<0.25
FL-B01@4'	4'	07/10/2023	8.41*	0.654	0.27	<0.25
FL-B02@4'	4'	07/10/2023	8.43*	0.652	0.26	<0.25
FL-B04@4'	4'	07/31/2025	7.93	1.46	2.450	0.0322
FL-B13@4'	4'	07/31/2025	8.09	0.518	0.493	0.0415
FL-B14@4'	4'	07/31/2025	7.72	0.734	0.900	0.0299
BACKGROUND						
BG01@4'	4'	08/04/2025	8.01	2.38	0.716	0.162
BG01@6'	6'	08/04/2025	8.26	3.85	0.772	0.128
BG02@4'	4'	08/04/2025	7.76	0.445	0.618	<0.0199
BG02@6'	6'	08/04/2025	7.90	0.627	0.589	<0.0199
BG03@4'	4'	08/04/2025	8.49	1.55	0.538	0.184
BG03@6'	6'	08/04/2025	8.78	2.71	0.466	0.125
BG04@4'	4'	08/04/2025	8.60	1.56	0.438	0.130
BG04@6'	6'	08/04/2025	8.89	3.07	0.480	0.154
BG05@4'	4'	08/04/2025	8.23	2.72	0.743	0.182
BG05@6'	6'	08/04/2025	8.50	3.11	0.638	0.137
Highest Background @ 4' - 6' (ML)			8.89	3.85	0.772	0.184

Notes:

(1) Standards for soil are taken from ECMC Table 915-1: Soil Suitability for Reclamation (Effective January 15, 2021)

ECMC = Colorado Energy & Carbon Management Commission

(<) = Analytical result is less than the indicated laboratory detection limit

mmhos/cm = millimhos per centimeter

mg/L = milligrams per liter

pH = Potential of Hydrogen

SAR = Sodium Adsorption Ratio

EC = Electrical Conductivity

ML = Silt

BOLD = Analytical result is in exceedance of ECMC Table 915-1: Soil Suitability for Reclamation Concentrations

Highest background concentration

* Result exceeded the ECMC Table 915-1 standard, but was within site-specific background concentrations