



Remediation Soil & Groundwater Sampling Fieldsheet

* * * Facility Information * * *

O&G Site Name	McDonald 2-4A Wellhead	Client	Oxy	REM Project #	37209
Weather	Cloudy and snowing 30	Surface Flow Direction	Flat		
API/TB#	05-123-21831	Liner present?	No	Site Coordinates	40.260830, -104.893800

Directions to Well: CR 19 & CR 38, S. 4/10, W. 1/2 INTO

* * * Sampling Information * * *

Sample Date	11/7/2024
Sampler(s)	TS, SE

Sample ID	Time	Date	Lab?	PID (ppm)	Location Description	Staining/ Odor	Color/ Lithology	
WH-B01 @ 6'	9:00	11/7/2024	Yes	0.0	Base of wellhead	None	Brown	SANDY CLAY
WH-N01 @ 3'	9:04	11/7/2024	No	0.1	North wall of wellhead	No	Brown	LOAMY SAND
WH-S01 @ 3'	9:05	11/7/2024	No	0.1	South wall of wellhead	No	Brown	LOAMY SAND
WH-E01 @ 3'	9:06	11/7/2024	No	0.2	East wall of wellhead	No	Brown	SANDY CLAY
WH-W01 @ 3'	9:07	11/7/2024	No	0.1	West wall of wellhead	No	Brown	LOAMY SAND
FL-B01 @ 3'	9:10	11/7/2024	Yes	0.0	Flowline riser at wellhead	No	Brown	SANDY CLAY
WHS-N01 @ 3"	10:00	11/7/2024	No	0.0	North of wellhead	No	Brown	CLAY LOAM
WHS-S01 @ 3"	10:05	11/7/2024	No	0.0	South of Wellhead	No	Brown	CLAY LOAM
WHS-E01 @ 3"	10:10	11/7/2024	No	0.0	East of wellhead	No	Brown	SILTY CLAY
WHS-W01 @ 3"	10:20	11/7/2024	No	0.1	West of wellhead	No	Brown	SILTY CLAY
WH-BG01 @ 3"	9:15	11/7/2024	Yes	0.1	75' to the North of the wellhead	No	Brown	SILT LOAM
WH-BG01 @ 3'	9:20	11/7/2024	Yes	0.1	75' to the North of the wellhead	No	Brown	SILTY CLAY
WH-BG01 @ 6'	9:25	11/7/2024	Yes	0.0	75' to the North of the wellhead	No	Brown	SILTY CLAY
WH-BG02 @ 3"	9:30	11/7/2024	Yes	0.1	75' to the East of the wellhead	No	Brown	SILT LOAM
WH-BG02 @ 3'	9:35	11/7/2024	Yes	0.2	75' to the East of the wellhead	No	Brown	SILTY CLAY
WH-BG02 @ 6'	9:40	11/7/2024	Yes	0.1	75' to the East of the wellhead	No	Brown	SAND
WH-BG03 @ 3"	9:45	11/7/2024	Yes	0.1	75' to the South of the wellhead	No	Brown	SILTY CLAY
WH-BG03 @ 3'	9:50	11/7/2024	Yes	0.2	75' to the South of the wellhead	No	Brown	SILTY CLAY
WH-BG03 @ 6'	9:55	11/7/2024	Yes	0.1	75' to the South of the wellhead	No	Brown	SILTY CLAY
FL-B02 @ 6'	12:00	11/7/2024	Yes	0.0	Flowline 90 west of WH	No	Brown	SILTY CLAY
FL-B03 @ 5'	12:10	11/7/2024	No	0.1	Flowline south of wellhead along fence	No	Brown	SILTY CLAY
FL-B04 @ 5'	12:12	11/7/2024	No	0.4	Flowline south of wellhead along fence	No	Brown	SILTY CLAY
FL-B05 @ 5'	12:17	11/7/2024	No	0.1	Flowline south of wellhead along fence	No	Brown	SILTY CLAY
FL-B06 @ 5'	12:20	11/7/2024	No	0.3	Flowline south of wellhead along fence	No	Brown	SILTY CLAY
FL-B07 @ 5'	12:30	11/7/2024	No	0.2.3	Flowline south of wellhead along fence	No	Brown	SILTY CLAY

Decon Methods: Alconox & DI Water **Depth GW observed:** None

GW Sampling

Sample ID	Date	Time	Odor?	Sheen?	Sample ID	Date	Time	Odor?	Sheen?

Site Comments:



Sampling Photographic Log

McDonald 2-4A Wellhead



Description:

- WH-BG01@3"
- WH-BG01@3'
- WH-BG01@6'



11/7/24, 9:57 AM
+40.260648, -104.893621
326° NW
McDonald 2-4 A wellhead

X WH-BG02@3"

X WH-BG02@3'

X WH-BG02@6'

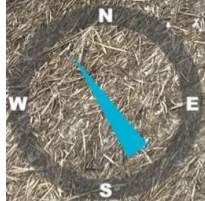

Description:
WH-BG02@3"
WH-BG02@3'
WH-BG02@6'

11/7/24, 9:56 AM
+40.260967,-104.893616
255° W
McDonald 2-4 A wellhead



Description:

WH-BG03@3"

WH-BG03@3'

WH-BG03@6'



Description:

- WH-S01@3'
- WH-W01@3'
- WH-S01@3'
- WH-N01@3'
- WH-B01@6'
- FL-B01@6'

11/7/24, 11:57 AM
+40.260781,-104.893788
310° NW
McDonald 2-4 A wellhead



Description:

- SVP01
- SVP02

11/7/24, 11:56 AM
+40.260856,-104.893709
301° NW
McDonald 2-4 A wellhead



Description:
SVP03

11/7/24, 11:57 AM
+40.260781,-104.893788
14° N
McDonald 2-4 A wellhead



Description:
SVP04

11/7/24, 11:57 AM
+40.260808,-104.893909
134° SE
McDonald 2-4 A wellhead

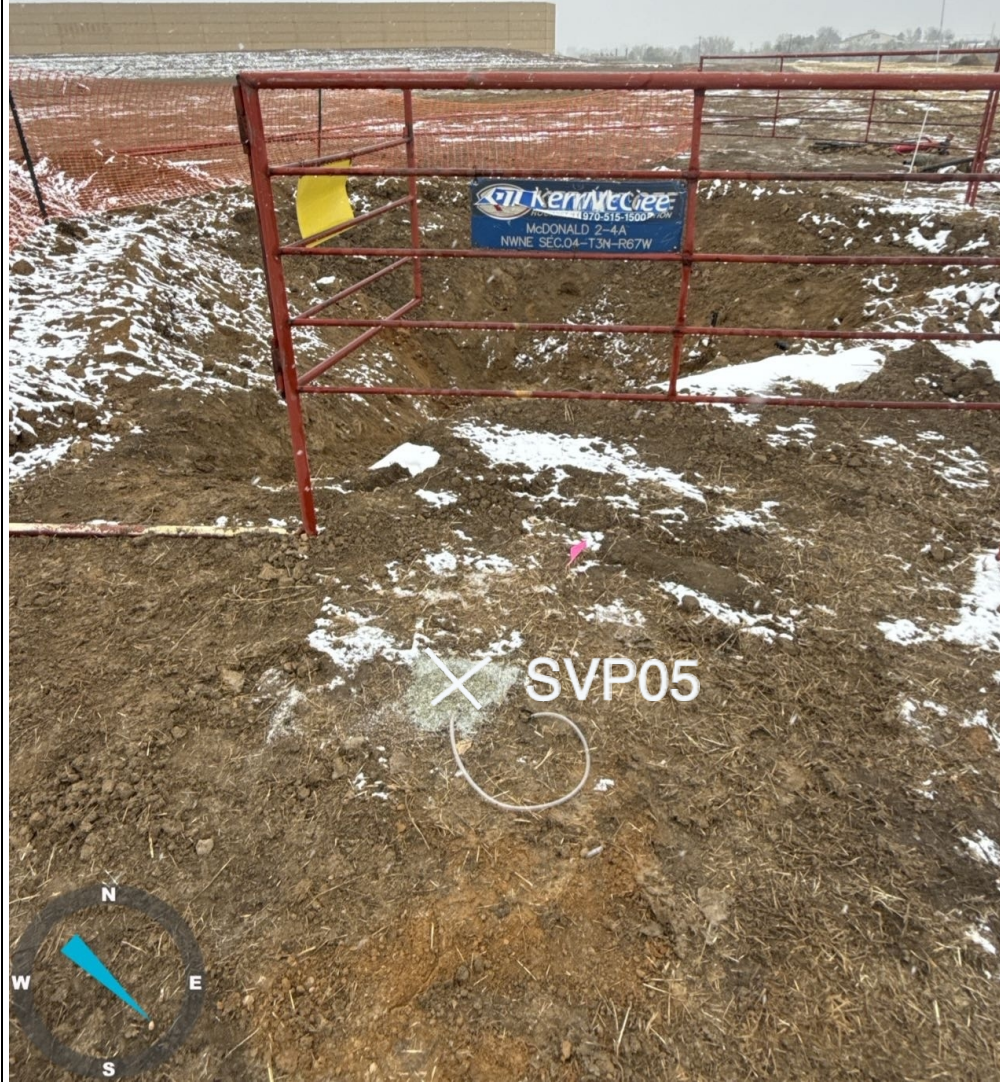

Description:
SVP05



11/7/24, 11:07 AM
+40.260879, -104.893862
150° SE
McDonald 2-4 A wellhead

WHS-W01@3"



Description:
WHS-W01@3"



Description:
WHS-S01@3"



11/7/24, 11:08 AM
+40.260784, -104.893839
304° NW
McDonald 2-4 A wellhead

X WHS-E01 @ 3"

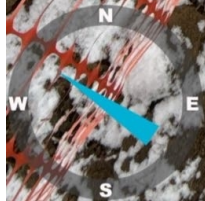

Description:
WHS-E01 @ 3"



Description:
WHS-N03@3"

11/7/24, 12:23 PM
+40.260726,-104.894075
332° NW
McDonald 2-4 A wellhead



Description:

FL-B02@6'



Description:

FL-B03@5'

11/7/24 12:31 PM
+40.260239 -104.893850
134° SE
McDonald 2-4 A wellhead

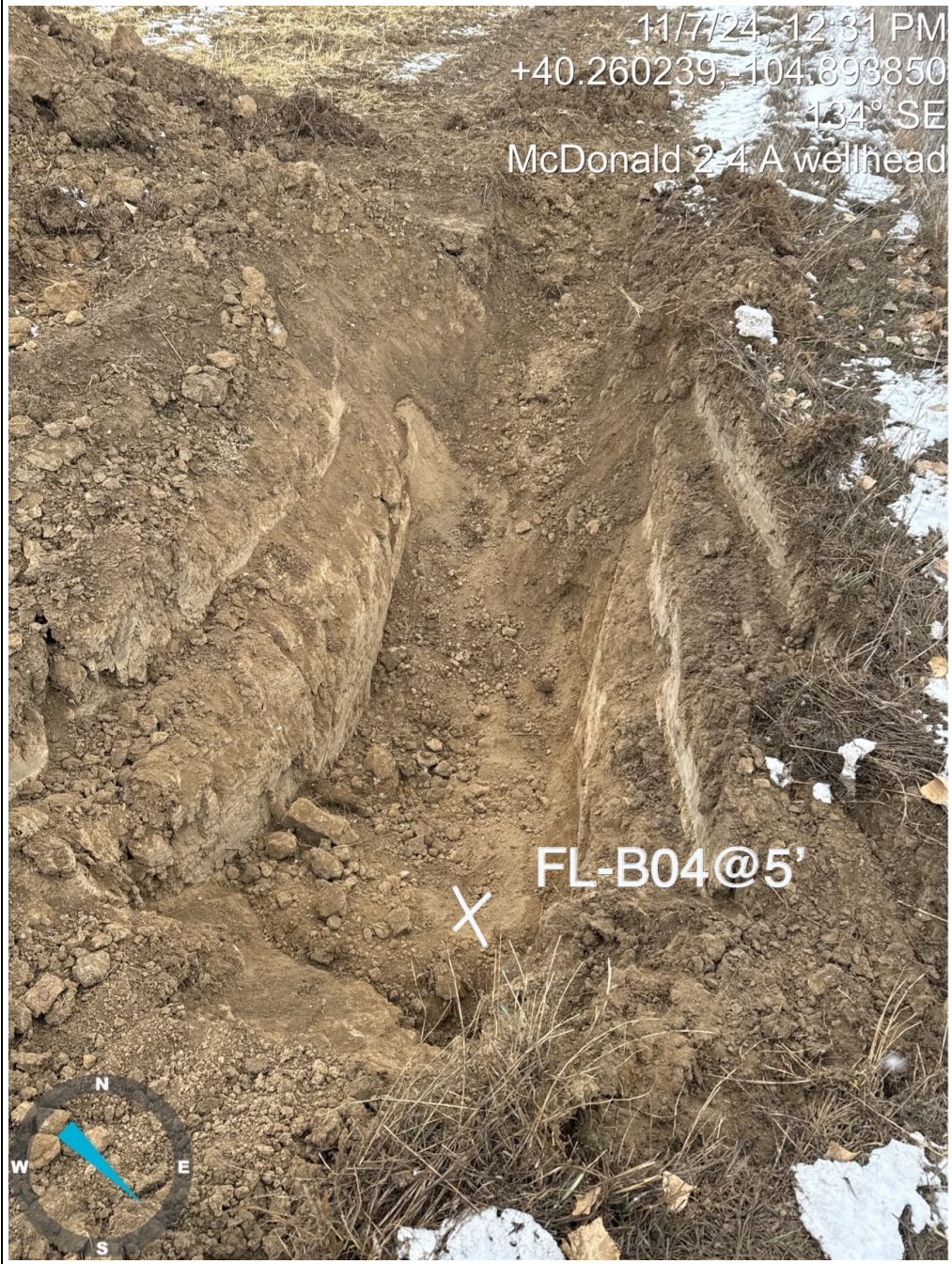

Description:
FL-B04@5'



11/7/24, 12:33 PM
+40.260013, -104.893715
151° SE
McDonald 2-4 A wellhead

FL-B05@5'

Description:
FL-B05@5'



Description:
FL-B06@5'



11/7/24, 12:51 PM
+40.259291, -104.893494
186° S
McDonald 2-4 A wellhead

FL-B07@5'



Description:
FL-B07@5'



11/7/24, 12:53 PM
+40.259080, -104.893276
217° SW
McDonald 2-4 A wellhead

FL-B08@4'

Description:
FL-B08@4'



Description:
FL-B09@5'

11/7/24, 1:05 PM
+40.258850,-104.892745
110° E
McDonald 2-4 A wellhead



FL-B10@4'

Description:

FL-B10@4'

11/11/24, 1:27 PM
+40.258623, -104.892523
283° W
McDonald 2-4 A wellhead

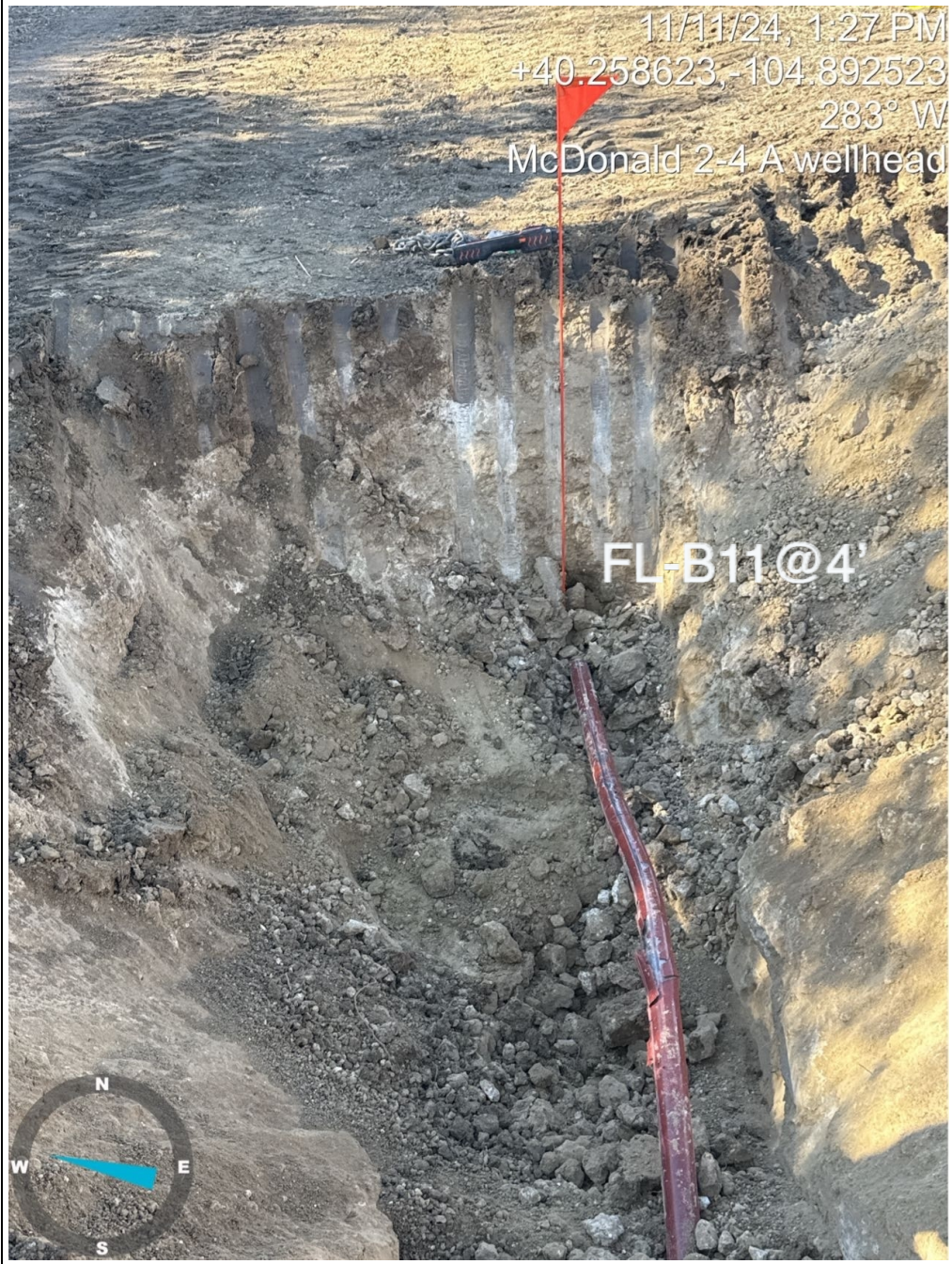

FL-B11@4'



Description:

FL-B11@4'



11/11/24, 12:47 PM
+40.258301, -104.891891
119° SE
McDonald 2-4 A wellhead

FL-B12@4'

Description:
FL-B12@4'

11/11/24, 12:52 PM
+40.257998, -104.891411
120° SE
McDonald 2-4 A wellhead



FL-B13@4'

Description:

FL-B13@4'



11/11/24, 12:57 PM
+40.257863, -104.891013
90° E
McDonald 2-4 A wellhead

FL-B14@4'

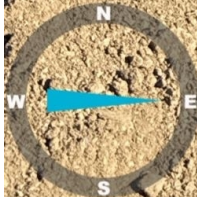

Description:
FL-B14@4'

11/11/24, 1:03 PM
+40.257869, -104.890565
26° NE
McDonald 2-4 A wellhead



FL-B15@4'

Description:

FL-B15@4'

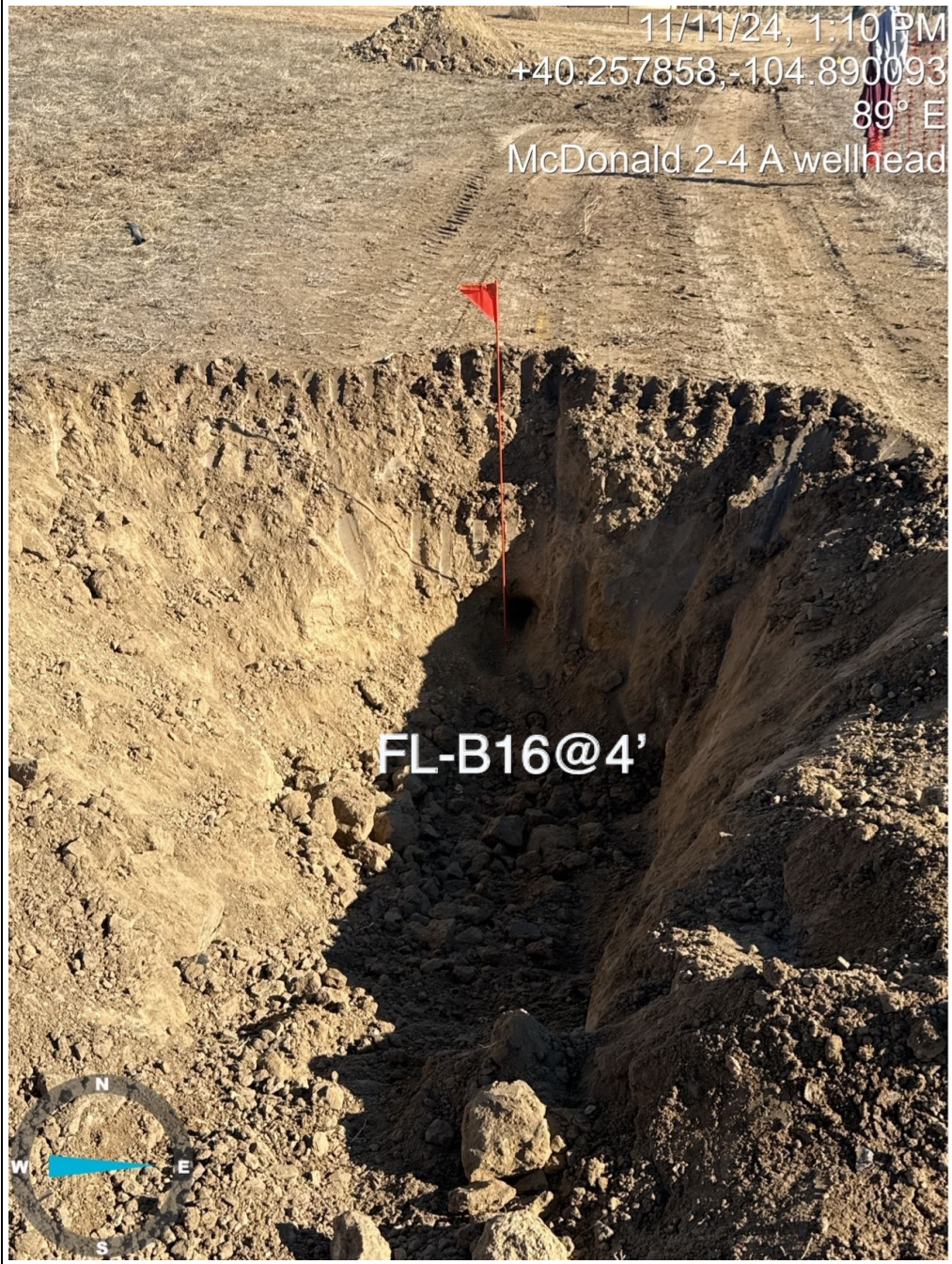

11/11/24, 1:10 PM
+40.257858, -104.890093
89° E
McDonald 2-4 A wellhead

FL-B16@4'



Description:
FL-B16@4'

11/11/24, 1:53 PM
+40.257796, -104.889786
107° E
McDonald 2-4 A wellhead



Description:
FL-B17@4'

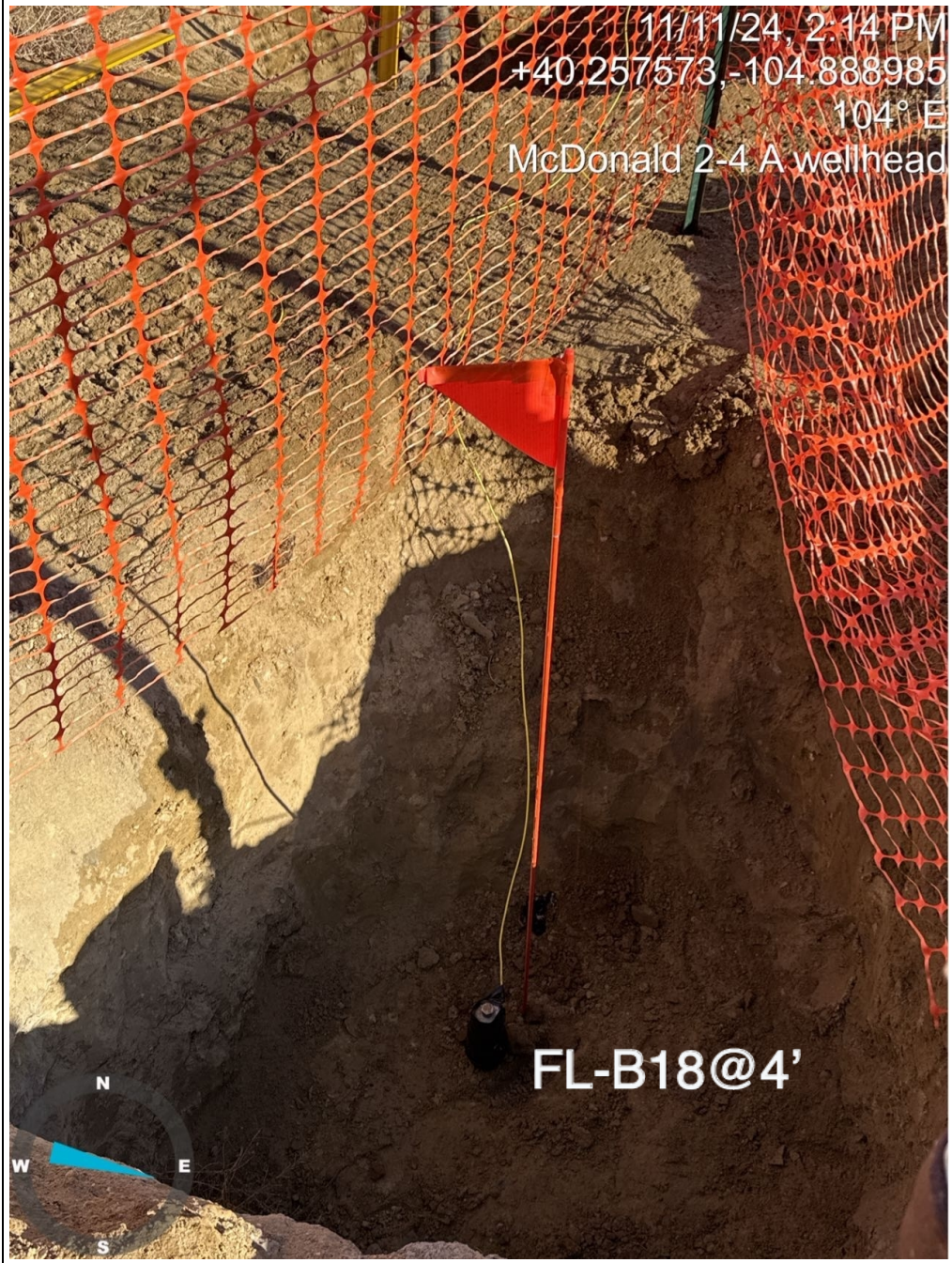

Description:

FL-B18@4'



12/17/24, 12:26 PM
+40.257475,-104.888824
266° W
Weld County
McDonald 4-13 Wellhead

Description:
FL-B18@4'V

1/14/25, 12:02 PM
+40.260838,-104.893795
213° SW
Weld County
McDonald 2-4A Wellhead



Description:
WH-B01@6V



Description:

FL-B10@4'