

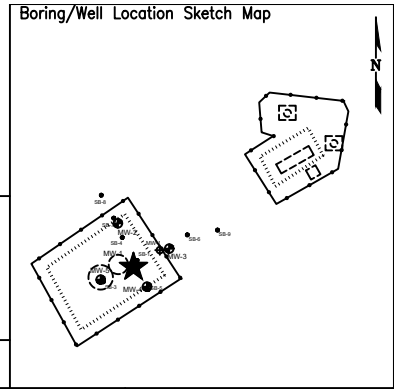

BORING/WELL CONSTRUCTION LOG



Page 1 of 1

Boring/Well No. MW-1		Total Depth 16'	Location Noble Energy, Inc. Cornelius-63N65W 11SWNW SWNW Sec. 11, T3N, R65W, 6th PM Weld County, Colorado			
Project No./Name CO23-125/ Noble Cornelius-63N65W 11SWNW			Approved By			
Drilling Contractor/Driller Drill Pro						
Geologist/Office Ethan Black / Fremont Environmental, Inc.			Size/Type of Bit 2.5" direct push		Sampling Method direct push	Start/Finish Date 5/20/2025
Drilling Equipment/Method Geoprobe						
Well Installed? Yes <input checked="" type="checkbox"/> No <input type="checkbox"/>		Casing Mtrl./Dia. PVC 1"	Screen: Type slotted Mtrl. PVC Length 10' Dia. 1" Slot Size 0.010"			
Elevation of: (ft. above datum)		Ground Surface 3.89	Top of Well Casing 98.44	Top of Screen -	Bottom of Screen -	Ground Water Surface/Date Measured 4.45 5/20/2025

DEPTH (feet)	WELL CONSTRUCTION		LITHOLOGY		Penetration Rate (blows/6")	Recovery (%)	Sample Interval (feet)	PID Values (ppm)
			GRAPHIC LOG	VISUAL DESCRIPTION				
	Bentonite	1" Blank	NR	No Recovery 0' to 2'				NS
			SP	Sand: brown, fine, moist		60%		NS 0.0 0.0
5			NR	No Recovery 4' to 5'				NS
	#10-20 Silica Sand	1" Screen	SP	- black and gray 6" lens		75%		0.0 0.0 44.2 0.0
10			SC	Sandy-clay: brown, plastic, fine sand, wet		100%		31.4 0.0 0.0 0.0 0.0 0.0 0.0
15								0.0
								0.0
20								0.0



BORING/WELL CONSTRUCTION LOG

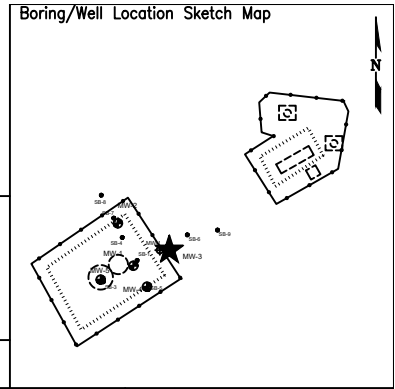

Page 1 of 1

Boring/Well No. MW-3		Total Depth 16'	Location Noble Energy, Inc. Cornelius-63N65W 11SWNW SWNW Sec. 11, T3N, R65W, 6th PM Weld County, Colorado			
Project No./Name CO23-125/ Noble Cornelius-63N65W 11SWNW		Drilling Contractor/Driller Drill Pro				
Geologist/Office Ethan Black / Fremont Environmental, Inc.		Approved By				
Drilling Equipment/Method Geoprobe		Size/Type of Bit 2.5" direct push	Sampling Method direct push	Start/Finish Date 5/20/2025		
Well Installed? Yes <input checked="" type="checkbox"/> No <input type="checkbox"/>	Casing Mtrl./Dia. PVC 1"	Screen: Type slotted Mtrl. PVC Length 10' Dia. 1" Slot Size 0.010"				
Elevation of: (ft. above datum)	Ground Surface 4.83	Top of Well Casing 97.50	Top of Screen -	Bottom of Screen -	Ground Water Surface/Date Measured 9.00 5/20/2025	

DEPTH (feet)	WELL CONSTRUCTION	LITHOLOGY		Penetration Rate (blows/6")	Recovery (%)	Sample Interval (feet)	PID Values (ppm)
		GRAPHIC LOG	VISUAL DESCRIPTION				
		NR	No Recovery 0' to 1'				
	Bentonite	1" Blank	Sand: brown, fine, moist		75%		NS
5		SP					0.0
							0.0
							0.0
							0.0
							98.3
							115.4
	#10-20 Silica Sand	1" Screen	Clay: gray and black, plastic, saturated				
			- black 8" SP lens at 10'				25.6
10		CH					0.0
		SP					0.0
		SP	Sand: beige, very fine, wet				0.0
							0.0
							0.0
15			- increasing fines				0.0
							0.0
							0.0
							0.0
20			TD 16'				0.0



BORING/WELL CONSTRUCTION LOG

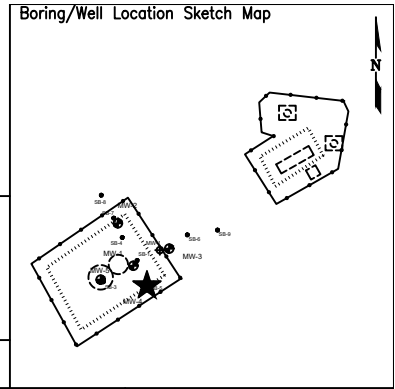

Page 1 of 1

Boring/Well No. MW-4	Total Depth 16'	Location Noble Energy, Inc. Cornelius-63N65W 11SWNW SWNW Sec. 11, T3N, R65W, 6th PM Weld County, Colorado			
Project No./Name CO23-125/ Noble Cornelius-63N65W 11SWNW		Drilling Contractor/Driller Drill Pro			
Geologist/Office Ethan Black / Fremont Environmental, Inc.		Approved By			
Drilling Equipment/Method Geoprobe		Size/Type of Bit 2.5" direct push	Sampling Method direct push	Start/Finish Date 5/20/2025	
Well Installed? Yes <input checked="" type="checkbox"/> No <input type="checkbox"/>	Casing Mtrl./Dia. PVC 1"	Screen: Type slotted Mtrl. PVC Length 10' Dia. 1" Slot Size 0.010"			
Elevation of: (ft. above datum)	Ground Surface 4.23	Top of Well Casing 98.10	Top of Screen -	Bottom of Screen -	Ground Water Surface/Date Measured 9.32 5/20/2025

DEPTH (feet)	WELL CONSTRUCTION	LITHOLOGY		Penetration Rate (blows/6")	Recovery (%)	Sample Interval (feet)	PID Values (ppm)
		GRAPHIC LOG	VISUAL DESCRIPTION				
5	Bentonite		Sand: dry sand with fill, brown, saturated	-	60%	-	0.0
	1" Blank		0.0				
	1" Screen		0.0				
	Clay: green, gray, brown, moist		0.0				
	Clay: green, gray, brown, moist		0.0				
10	#10-20 Silica Sand	SW	Sand: saturated, brown	-	90%	-	0.0
	1" Screen	0.0					
	Sand: saturated, brown	0.0					
	-sand, increasing fines, saturated	0.0					
	-sand, increasing fines, saturated	0.0					
15				-	100%	-	0.0
							0.0
							0.0
							0.0
							0.0
20			TD 16'				0.0



BORING/WELL CONSTRUCTION LOG

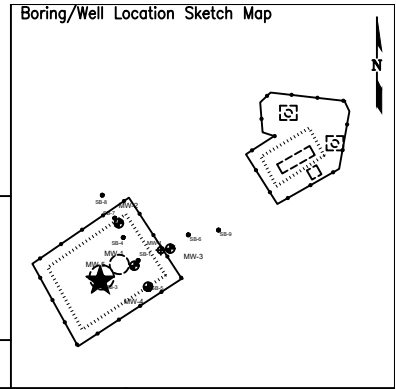

Page 1 of 1

Boring/Well No. MW-5		Total Depth 16'	Location Noble Energy, Inc. Cornelius-63N65W 11SWNW SWNW Sec. 11, T3N, R65W, 6th PM Weld County, Colorado			
Project No./Name CO23-125/ Noble Cornelius-63N65W 11SWNW			Approved By			
Drilling Contractor/Driller Drill Pro						
Geologist/Office Ethan Black / Fremont Environmental, Inc.			Drilling Equipment/Method Geoprobe		Size/Type of Bit 2.5" direct push	Sampling Method direct push
Well Installed? Yes <input checked="" type="checkbox"/> No <input type="checkbox"/>		Casing Mtrl./Dia. PVC 1"	Screen: Type slotted Mtrl. PVC Length 10' Dia. 1" Slot Size 0.010"			
Elevation of: (ft. above datum)		Ground Surface 4.03	Top of Well Casing 98.30	Top of Screen -	Bottom of Screen -	Ground Water Surface/Date Measured 9.49 5/20/2025

DEPTH (feet)	WELL CONSTRUCTION		LITHOLOGY		Penetration Rate (blows/6")	Recovery (%)	Sample Interval (feet)	PID Values (ppm)
			GRAPHIC LOG	VISUAL DESCRIPTION				
5	Bentonite	1" Blank	SW	Sand: brown with fill		50%	-	0.0
			SC	Sandy Clay- wet, plastic at 7.5'		75%	-	0.0
	#10-20 Silica Sand	1" Screen	SP	Sand: wet		100%	-	0.0
			SW	Sand, coarsening with depth - wet		100%	-	0.0
15			SC	Sandy Clay: plastic			-	0.0
20				TD 16'			-	0.0