

FL08@4.0'		FL01@5.0' (Z)		FL08@4.0'		FL01@5.0' (Z)	
4/3/2024		5/7/2025		4/3/2024		5/7/2025	
4.0 Ft		5.0 Ft		4.0 Ft		5.0 Ft	
As	3.45	As	2.11	pH	8.88	pH	8.28
BA	58.5	BA	50.7	EC	0.101	EC	0.288
CD	<-0.200	CD	<-0.200	SAR	0.0908	SAR	0.725
CR(VI)	<-0.30	CR(VI)	<-0.300*	B	<2.00	B	<-0.200
CU	1.66	CU	<-10.0				
PB	2.67	PB	<-10.0				
NI	2.04	NI	<-10.0				
SE	<-0.260	SE	0.502				
AG	<-0.0200	AG	<-0.500				
Z	8.08	Z	<-50.0				

FL01@5.0'		FL08@5.0' (Z)		FL01@5.0'		FL08@5.0' (Z)	
4/3/2024		5/7/2025		4/3/2024		5/7/2025	
5.0 Ft		5.0 Ft		5.0 Ft		5.0 Ft	
As	2.16	As	5.03	pH	9.42	pH	8.21
BA	50.3	BA	48.9	EC	0.172	EC	0.121
CD	<-0.200	CD	<-0.200	SAR	0.514	SAR	0.283
CR(VI)	<-0.30	CR(VI)	<-0.300*	B	<2.00	B	<-0.200
CU	5.25	CU	<-10.0				
PB	3.64	PB	<-10.0				
NI	2.20	NI	<-10.0				
SE	<-0.260	SE	0.427				
AG	<-0.0200	AG	<-0.500				
Z	10.1	Z	<-50.0				

**Resample WH-FS-01@6' for Full Table 915-1 Suite**

**LEGEND**

- WELL HEAD LOCATION
- ABOVE GROUND STORAGE TANK
- ⊗ SOIL SAMPLE LOCATION
- FORMER FACILITY
- FORMER FLOW LINE
- FENCE LINE
- CONTAINMENT BERM
- CONTAINMENT WALL

SAMPLE	SAMPLE ID	SAMPLE DATE	SAMPLE ID	SAMPLE DATE
As	ARSENIC (mg/kg)	4/3/2024	As	ARSENIC (mg/kg)
BA	BARIUM (mg/kg)	4/3/2024	BA	BARIUM (mg/kg)
CD	CADMIUM (mg/kg)	4/3/2024	CD	CADMIUM (mg/kg)
CR(VI)	CHROMIUM (mg/kg)	4/3/2024	CR(VI)	CHROMIUM (mg/kg)
CU	COPPER (mg/kg)	4/3/2024	CU	COPPER (mg/kg)
PB	LEAD (mg/kg)	4/3/2024	PB	LEAD (mg/kg)
NI	NICKEL (mg/kg)	4/3/2024	NI	NICKEL (mg/kg)
SE	SELENIUM (mg/kg)	4/3/2024	SE	SELENIUM (mg/kg)
AG	SILVER (mg/kg)	4/3/2024	AG	SILVER (mg/kg)
Z	ZINC (mg/kg)	4/3/2024	Z	ZINC (mg/kg)

Figure 1  
**PROPOSED SITE INVESTIGATION PLAN**

**NOBLE ENERGY INC ~ UPV-5-5H3**  
 SWNW Sec. 5, T5N, R63W, 6th PM  
 Weld County, Colorado  
 40.429766°, -104.467816°

Project No. <b>C024-072</b>	API # <b>05-123-18860</b>	Facility #
Date <b>7/14/25</b>	Remediation # <b>30272</b>	Filename <b>24072QFL</b>



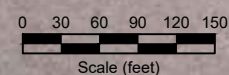
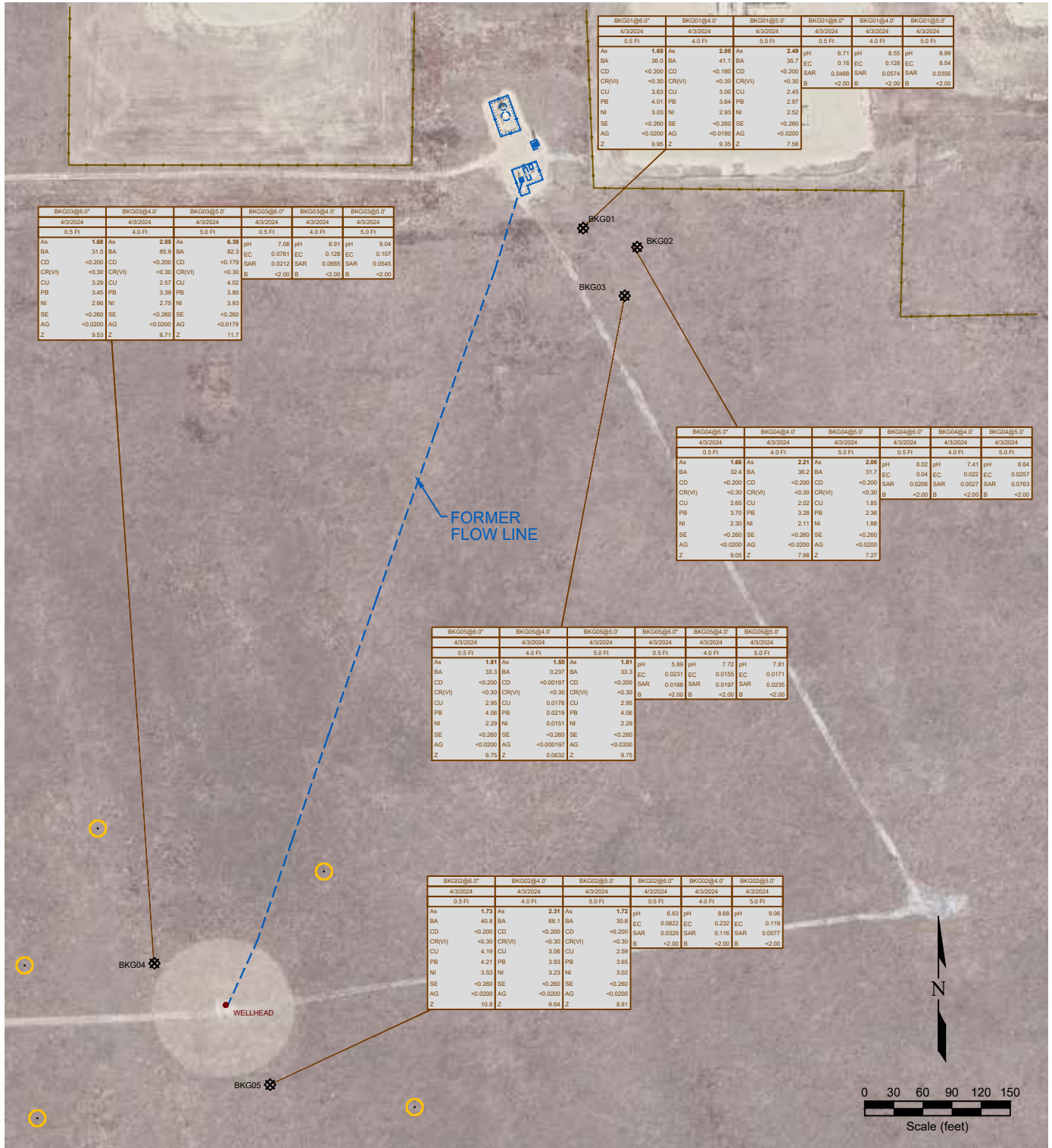

**LEGEND**

- WELL HEAD LOCATION
- ABOVE GROUND STORAGE TANK
- FORMER FACILITY
- FORMER FLOW LINE
- FENCE LINE
- ||||| CONTAINMENT BERM
- CONTAINMENT WALL
- ⊗ SOIL SAMPLE LOCATION

● Additional Local Background Sample Locations

SAMPLE	SAMPLE ID	DATE SAMPLED	DEPTH (ft)	SAMPLE	SAMPLE ID	DATE SAMPLED	DEPTH (ft)
As	ARSENIC (mg/kg)			pH	pH (pH units)		
BA	BARIUM (mg/kg)			EC	EC (mmhos/cm)		
CD	CADMIUM (mg/kg)			SAR	SAR		
CR(VI)	CHROMIUM (mg/kg)			B	BORON (mg/L)		
CU	COPPER (mg/kg)						
PB	LEAD (mg/kg)						
NI	NICKEL (mg/kg)						
SE	SELENIUM (mg/kg)						
AG	SILVER (mg/kg)						
Z	ZINC (mg/kg)						

Figure 2  
**PROPOSED ADDITIONAL BACKGROUND SAMPLE LOCATIONS**

**NOBLE ENERGY INC ~ UPV-5-5H3**  
SWNW Sec. 5, T5N, R63W, 6th PM  
Weld County, Colorado  
40.429766°, -104.467816°

Project No. <b>C024-072</b>	API # <b>05-123-18860</b>	Facility #
Date <b>7/14/25</b>	Remediation # <b>30272</b>	Filename <b>24072QFL</b>

