

CATAMOUNT ENERGY PARTNERS: OUTPOST 33-8 TANK PAD TEMPORARY USE AREA  
 NE/4, SECTION 26, T-33-N, R-8-W, N.M.P.M., LA PLATA COUNTY, CO.  
 GRADED PAD ELEVATION: 6608.9'

CONSTRUCTION LAYOUT DRAWING - PLAN VIEW

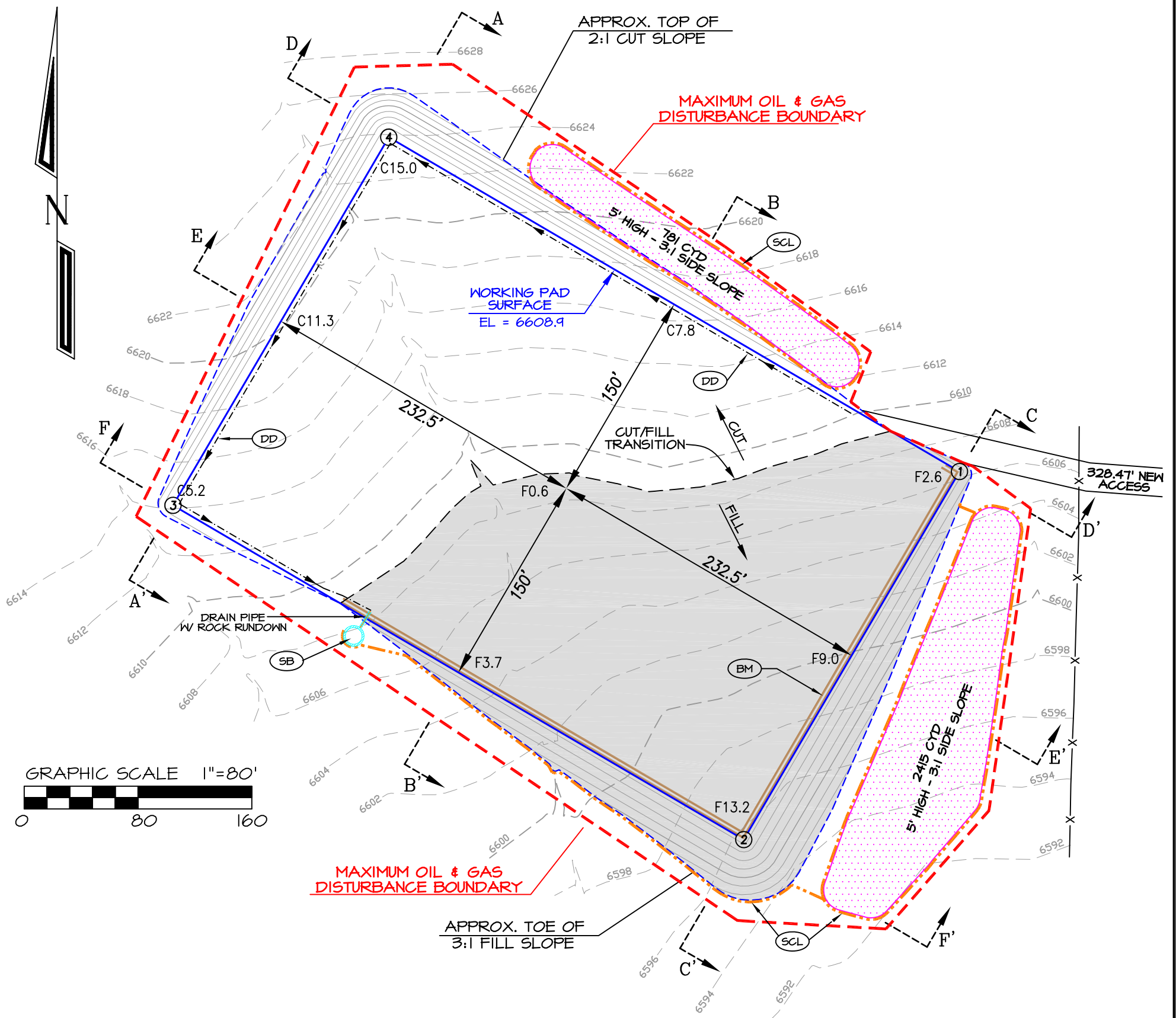

WORKING PAD SURFACE: 3.20 ACRES
PAD DISTURBANCE AREA (Cut/Fill Slopes, Stockpiles): 3.79 ACRES
MAXIMUM OIL & GAS LOCATION DISTURBANCE BOUNDARY: 5.18 ACRES
ACCESS ROADS: 0.15 AC.
PIPELINES: 0.0 AC.

NO COMPACTION OR EXPANSION ADJUSTMENT UTILIZED  
 6" TOPSOIL STRIPPING

APPROXIMATE EARTHWORKS
TOPSOIL: 3,196 CUBIC YARDS
CUT: 16,152 CUBIC YARDS
FILL: 16,152 CUBIC YARDS
NET EXPORT: 0.0 CUBIC YARDS

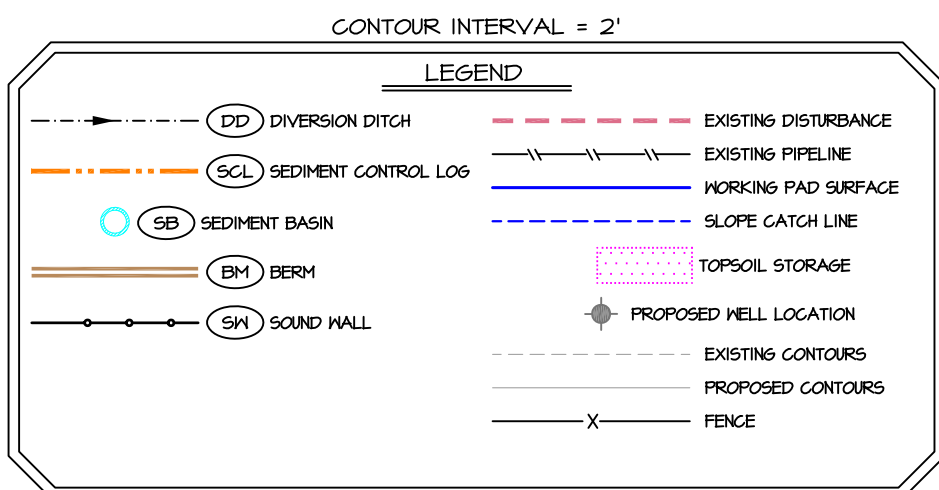

FIGURE 1

REVISED: 5/16/25	PREPARED FOR:
DRAWN BY: K.R.	CATAMOUNT ENERGY PARTNERS
CHECKED BY: K.R.	
FILE NO.: CEP737T1	
SURVEYED: 10/31/24	
DRAWN: 11/17/24	
JOB NO.: CEP73	

**NORTHSTAR**  
 SURVEYING & MAPPING, INC.

768 County Rd. 308  
 DURANGO, CO. 81303  
 (970) 385-0851

CATAMOUNT ENERGY PARTNERS: OUTPOST 33-8 TANK PAD TEMPORARY USE AREA  
 NE/4, SECTION 26, T-33-N, R-8-W, N.M.P.M., LA PLATA COUNTY, CO.  
 GRADED PAD ELEVATION: 6608.9'

CONSTRUCTION LAYOUT DRAWING  
 CROSS SECTION DETAIL

VERTICAL SCALE: 1" = 40' / HORIZONTAL SCALE: 1" = 80'

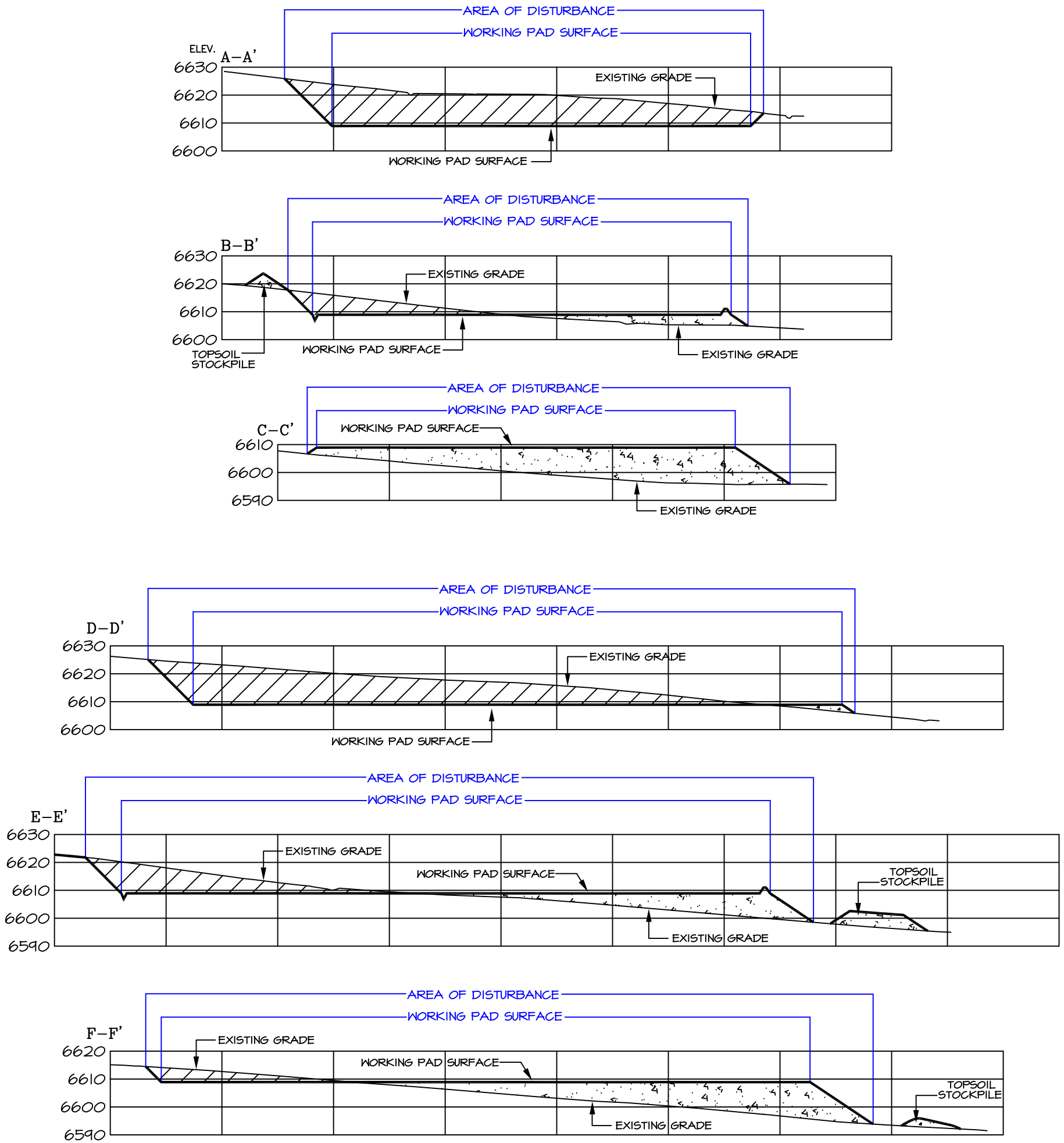

CUT SLOPE = 2:1  
 FILL SLOPE = 3:1

**NOTE**  
 FOR CORRECT SCALE TO BE DISPLAYED  
 DRAWING MUST BE PRINTED ON 11" X 17" PAGE

**FIGURE 2**

CATAMOUNT ENERGY PARTNERS: OUTPOST 33-8 TANK PAD TEMPORARY USE AREA  
 NE/4, SECTION 26, T-33-N, R-8-W, N.M.P.M., LA PLATA COUNTY, CO.  
 GRADED PAD ELEVATION: 6608.9'

PRELIMINARY WELL COMPLETION AND STIMULATION LAYOUT DRAWING

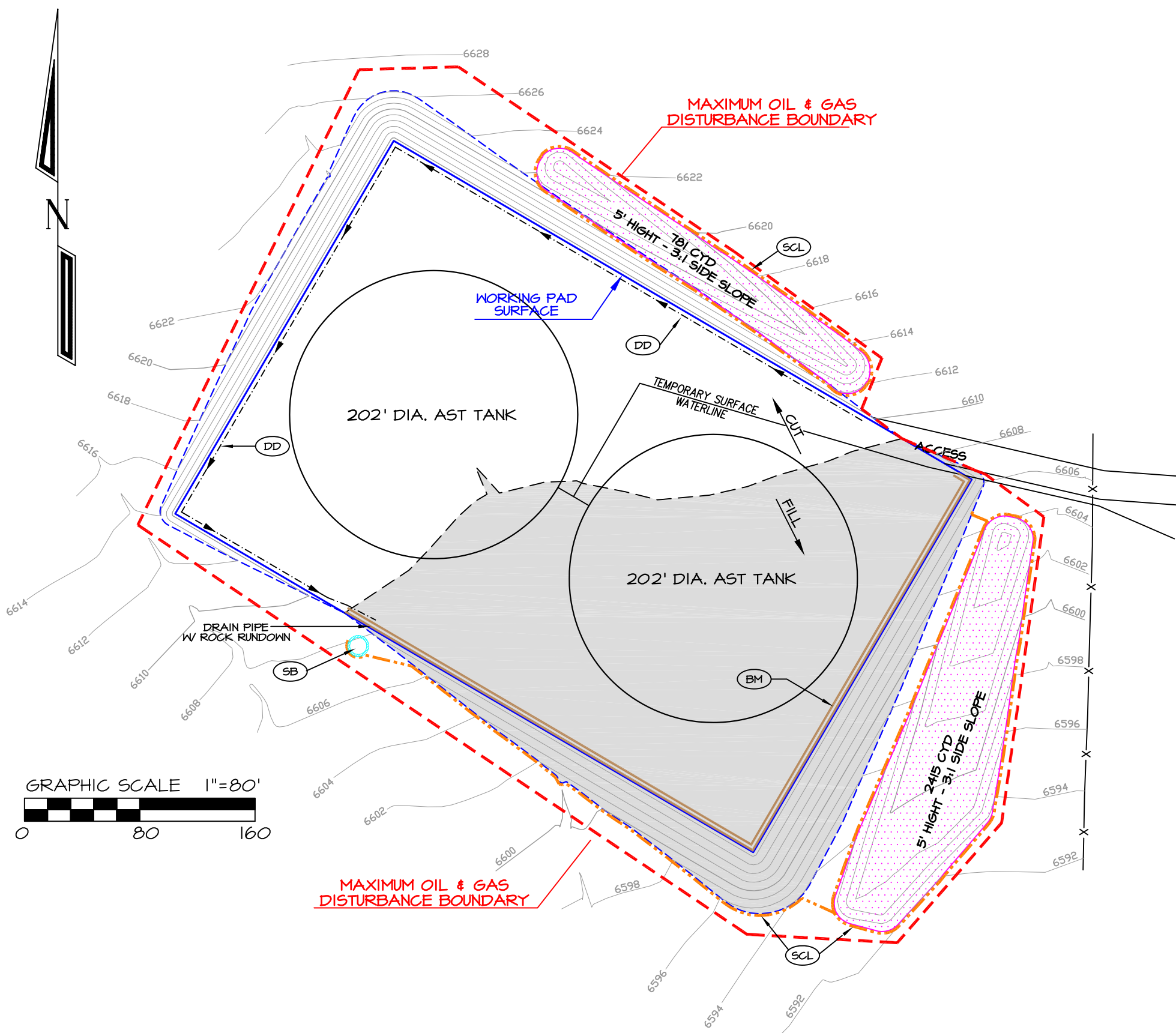

CONTOUR INTERVAL = 2'

LEGEND	
	DD DIVERSION DITCH
	SCL SEDIMENT CONTROL LOG
	SB SEDIMENT BASIN
	BM BERM
	SW SOUND WALL
	EXISTING DISTURBANCE
	EXISTING PIPELINE
	WORKING PAD SURFACE
	SLOPE CATCH LINE
	TOPSOIL STORAGE
	PROPOSED WELL LOCATION
	EXISTING CONTOURS
	PROPOSED CONTOURS
	FENCE

**FIGURE 3**

REVISED: 5/16/25	PREPARED FOR:
DRAWN BY: K.R.	CATAMOUNT ENERGY PARTNERS
CHECKED BY: K.R.	
FILE NO. CEP731F3	
SURVEYED: 10/31/24	
DRAWN: 11/6/24	
JOB NO. CEP73	

**NORTHSTAR**  
 SURVEYING & MAPPING, INC.

768 County Rd. 308  
 DURANGO, CO. 81303  
 (970) 385-0851

