

JAN 30 1981

COLO. OIL & GAS CONS. COMM. RECEIVED

JAN 30 1981

RECEIVED  
JAN 5 1987  
COLO. OIL & GAS CONS. COMM.

FORM F-100



R. 58W

COLO. OIL & GAS CONS. COMM.

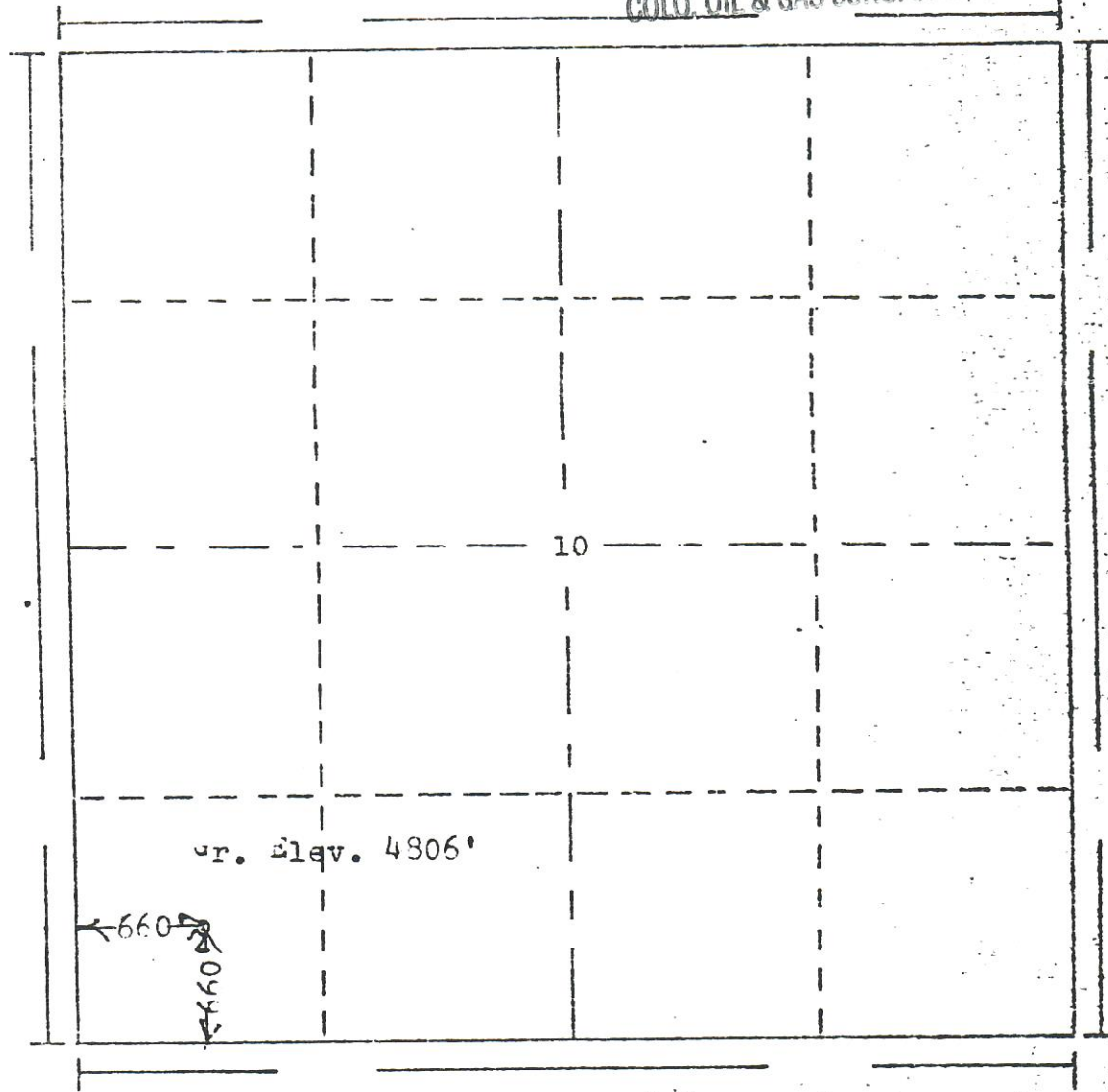

T.  
7  
N

Scale... 1" = 1000'

**Powers Elevation of Denver, Colorado**  
 has in accordance with a request from Mr. Mueller  
 for Vaughn Bros. Oil Co.  
 determined the location of No.1 Eldon Schmeckle  
 to be 660'FS & 660'FW Section 10 Township 7N  
 Range 58W of the 6th Principal Meridian  
 Weld County, Colorado

I hereby certify that this plot is an  
 accurate representation of a correct  
 survey showing the location of

Date: 8-29-80

*[Signature]*  
 Licensed Land Surveyor No. 2853  
 State of Colorado