

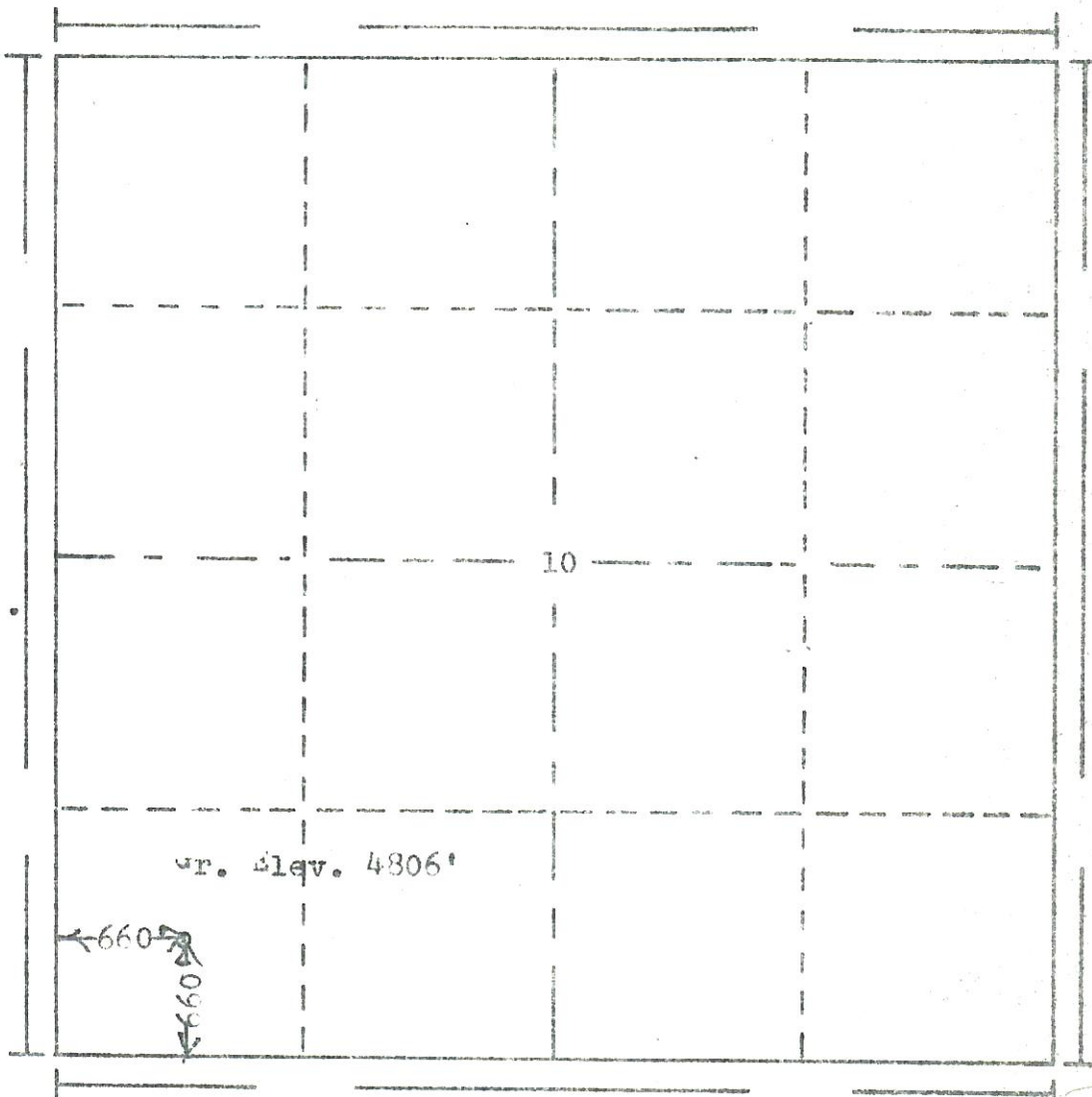

R. 58W



T. 7 N

Scale... 1" = 1000'

BEST COPY AVAILABLE

Powers Elevation of Denver, Colorado
 has in accordance with a request from Mr. Mueller
 for Vaughn Bros. Oil Co.
 determined the location of No.1 Eldon Schmeckle
 to be 660'FS & 660'FW Section 10 Township 7N
 Range 58W of the 6th Principal Meridian
weld County, Colorado

I hereby certify that this plat is an
 accurate representation of a correct
 survey showing the location of

Date: 8-29-80

R. J. Hoover

Licensed Land Surveyor No. 2853
 State of Colorado