

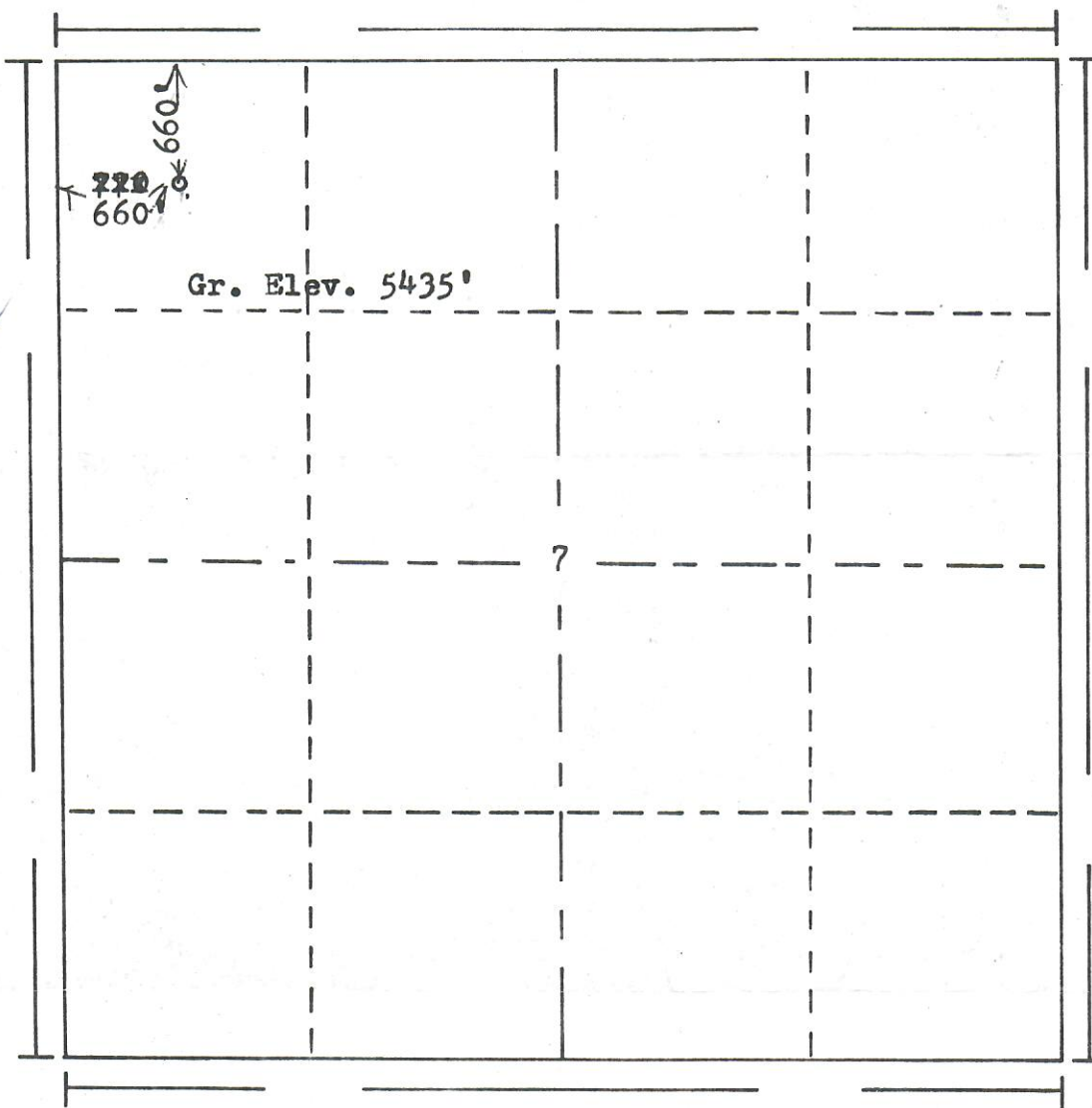

R. 64W

RECEIVED  
NOV 20 1975  
COLO. OIL & GAS CONS. COMM.

Scale... 1" = 1000'

Powers Elevation Company, Inc. of Denver, Colorado  
has in accordance with a request from Mr. McMillian  
for Amoco Production Co.

determined the location of No. 249 Champlin-Amoco No. 1  
to be 660'FN & 660'FW Section 7 Township 3S  
Range 64W of the 6th Principal Meridian  
Adams County, Colorado

I hereby certify that this plat is an  
accurate representation of a correct  
survey showing the location of

Date: 11-10-75

*Barry H. McMillian*  
\_\_\_\_\_  
Licensed Land Surveyor No. 2853  
State of Colorado