



POCO OPERATING



BOREHOLE	WELL	FIELD	STRUCTURE
CONNER 24-13-1CDH	CONNER 24-13-1CDH	WATTENBERG	POCO OPERATING, CONNER 19-18 PAD

GRAVITY & MAGNETICS PARAMETERS			SURFACE LOCATION NAD83 Colorado State Plane, Northern Zone, US Feet		
Model HDGM 2025 GARM	Dip 66.019°	Date 11-Mar-25	Lat 39°56'39.54"N	Northing 1,223,554.58 ftUS	Grid Conv 0.512°
MagDec 7.657°	FS 51,164.551nT	Gravity FS 998.977mgn (9.80665 Based)	Lon 104°42'29.06"W	Easting 3,222,039.98 ftUS	Scale Fact 0.99997107
MISCELLANEOUS					
Slot CONNER 24-13-1CDH	TVD Reference RKB (5142.000 ft above MSL)				
Plan Trajectory	Seabed / Ground Elevation 5142.000 ft above MSL				

Critical Point	MD (ft)	Incl (°)	Azim (°)	TVD (ft)	VSEC (ft)	NS (ft)	EW (ft)	DLS (deg/100ft)
Tie in	0.00	0.00	257.85	0.00	0.00	0.00	0.00	
KOP	650.00	0.00	257.85	650.00	0.00	0.00	0.00	0.00
	2,377.71	34.55	257.85	2,274.87	96.42	-106.40	-494.05	2.00
	8,140.50	34.55	257.85	7,021.04	720.00	-794.57	-3,689.36	0.00
CONNER 24-13-1CDH EP	9,347.91	90.00	359.53	7,683.00	1,548.57	-86.83	-4,141.67	8.00
CONNER 24-13-1CDH BH	19,313.63	90.00	359.53	7,683.00	10,743.83	9,878.55	-4,224.23	0.00

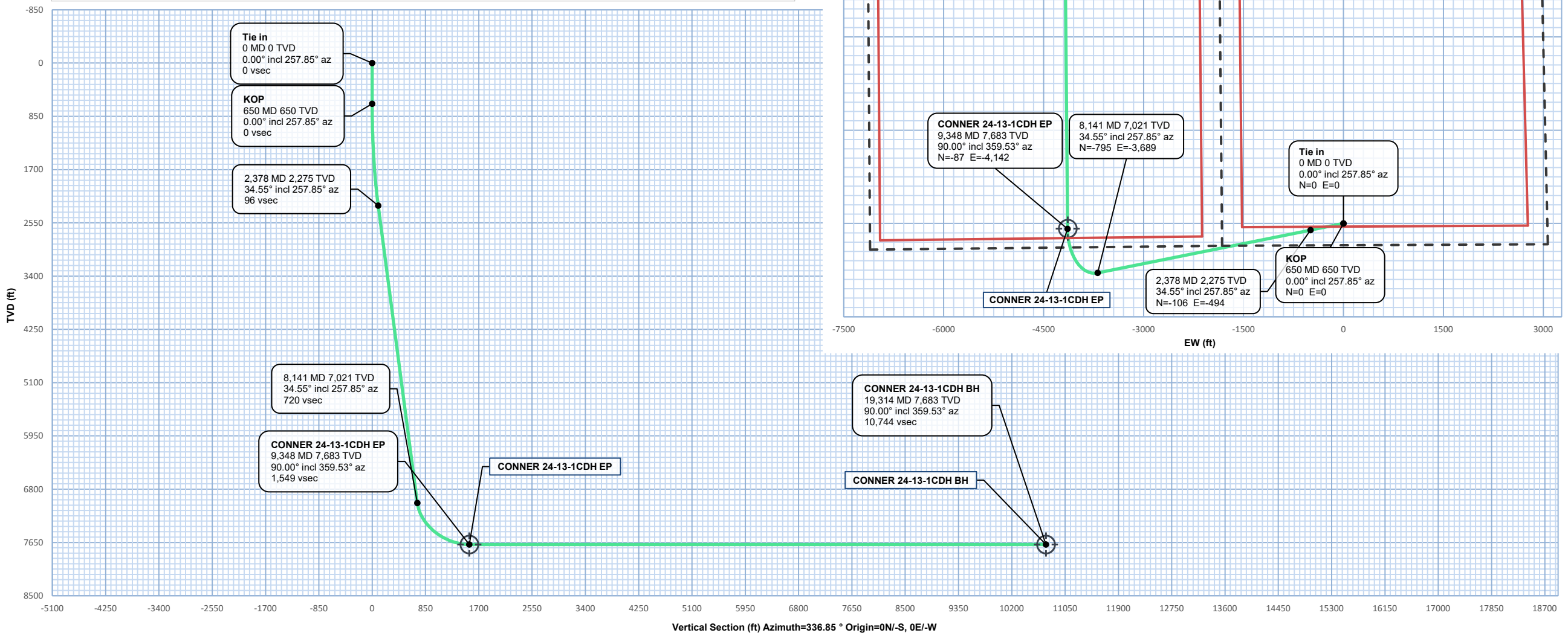
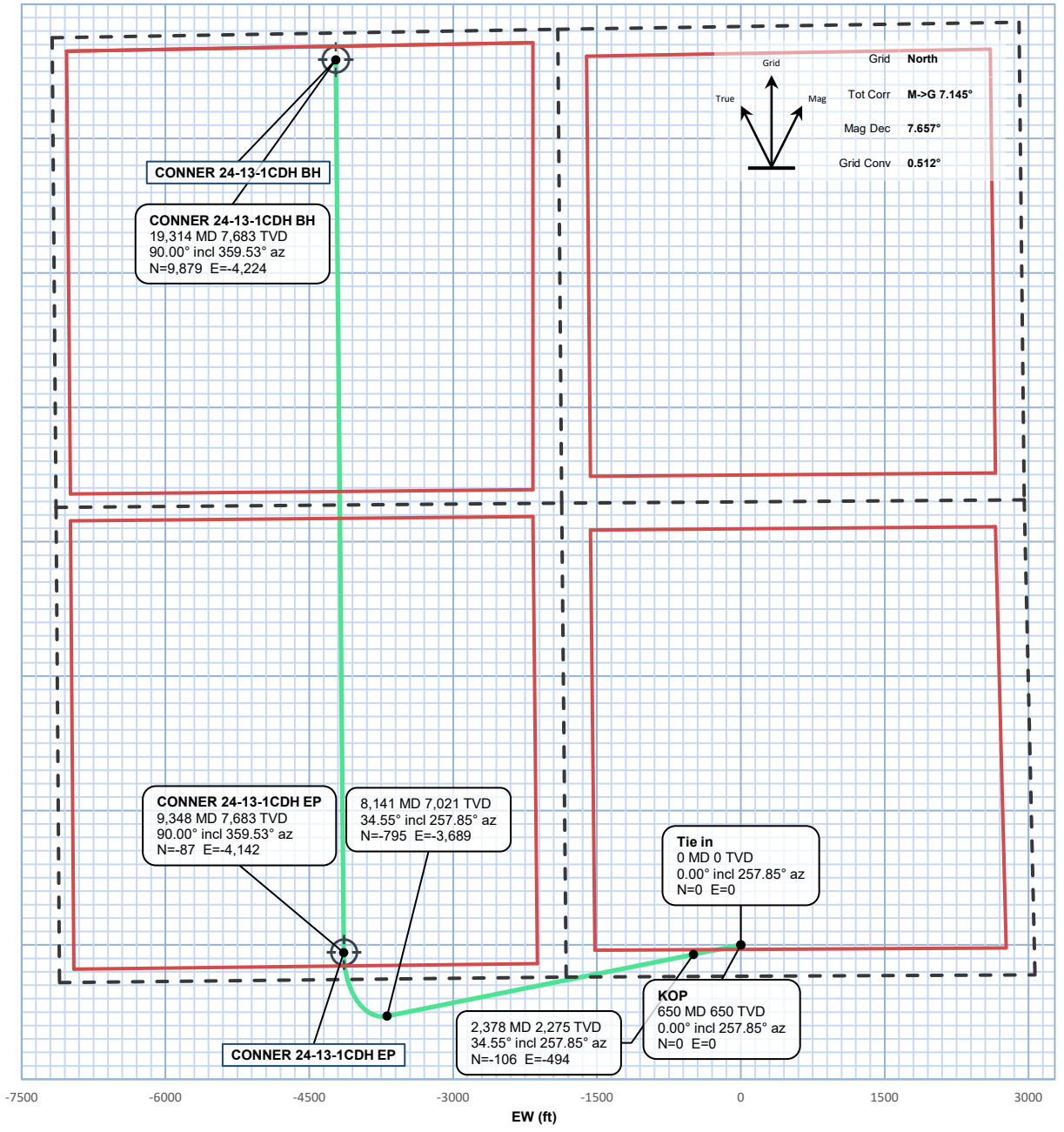



Trajectory Proposal Geodetic Report

Def Plan

Report Date: March 17, 2025 - 10:15 PM (UTC 0)
Client: POCO OPERATING
Field: WATTENBERG
Structure / Slot: POCO OPERATING, CONNER 19-18 PAD / CONNER 24-13-1CDH
Well: CONNER 24-13-1CDH
Borehole: CONNER 24-13-1CDH
UBHI / API#: Unknown / Unknown
Survey Name: Trajectory
Survey Date: March 17, 2025
Top / AHD / DDI / ERD Rate: 131.147' / 14680.607 ft / 6.685' / 1.911
Coordinate Reference System: NAD83 Colorado State Plane, Northern Zone, US Feet
Location Lat / Long: 39°56'39.54184"N, 104°42'29.05520"W
Location Grid NE YX: N 1223554.578 RUS, E 3222039.981 RUS
CRS Grid Convergence Angle: 0.512°
Grid Scale Factor: 0.99997107(Applied)
Version / Patch: 2024.5.0.1

Survey / DLS Computation: Minimum Curvature / Lubinski
Vertical Section Azimuth: 86.848 (GRID North)
Vertical Section Origin: 0.000 ft, 0.000 ft
TVD Reference Datum: RKB
TVD Reference Elevation: 5142.000 ft above MSL
Seabed / Ground Elevation: 5142.000 ft above MSL
Magnetic Declination: 7.657°
Total Gravity Field Strength: 998.9766mgn (9.80665 Based)
Gravity Model: GARM
Total Magnetic Field Strength: 51164.551 nT
Magnetic Dip Angle: -2.30
Declination Date: March 11, 2025
Magnetic Declination Model: HDGM 2025
North Reference: Grid North
Grid Convergence Used: Grid North
Total Corr Mag North->Grid North: 7.145°
Local Coord Referenced To: Well Head

Comments	MD (ft)	Incl (°)	Azim (°)	TVD (ft)	TVSS (ft)	VSEC (ft)	NS (ft)	EW (ft)	Northing (RUS)	Easting (RUS)	Latitude (°)	Longitude (°)	DLS (°/100ft)	BR (°/100ft)	TR (°/100ft)
Tie in	0.00	0.00	257.85	0.00	-5.142.00	0.00	0.00	0.00	1,223,554.58	3,222,039.98	39.94431718	-104.70807089			
	100.00	0.00	257.85	100.00	-5.042.00	0.00	0.00	0.00	1,223,554.58	3,222,039.98	39.94431718	-104.70807089	0.00	0.00	0.00
	200.00	0.00	257.85	200.00	-4.942.00	0.00	0.00	0.00	1,223,554.58	3,222,039.98	39.94431718	-104.70807089	0.00	0.00	0.00
	300.00	0.00	257.85	300.00	-4.842.00	0.00	0.00	0.00	1,223,554.58	3,222,039.98	39.94431718	-104.70807089	0.00	0.00	0.00
	400.00	0.00	257.85	400.00	-4.742.00	0.00	0.00	0.00	1,223,554.58	3,222,039.98	39.94431718	-104.70807089	0.00	0.00	0.00
	500.00	0.00	257.85	500.00	-4.642.00	0.00	0.00	0.00	1,223,554.58	3,222,039.98	39.94431718	-104.70807089	0.00	0.00	0.00
	600.00	0.00	257.85	600.00	-4.542.00	0.00	0.00	0.00	1,223,554.58	3,222,039.98	39.94431718	-104.70807089	0.00	0.00	0.00
	650.00	0.00	257.85	650.00	-4.492.00	0.00	0.00	0.00	1,223,554.58	3,222,039.98	39.94431718	-104.70807089	0.00	0.00	0.00
	700.00	1.00	257.85	700.00	-4.442.00	0.08	-0.09	-0.43	1,223,554.49	3,222,039.55	39.94431694	-104.70807241	2.00	2.00	0.00
	800.00	3.00	257.85	799.93	-4.342.07	0.75	-0.83	-3.84	1,223,553.75	3,222,036.14	39.94431500	-104.70808460	2.00	2.00	0.00
	900.00	5.00	257.85	899.98	-4.242.32	1.30	-1.06	-10.86	1,223,552.28	3,222,029.32	39.94431114	-104.70810989	2.00	2.00	0.00
	1,000.00	7.00	257.85	899.13	-4.142.87	4.07	-4.50	-20.88	1,223,550.08	3,222,019.11	39.94430535	-104.70814548	2.00	2.00	0.00
	1,100.00	9.00	257.85	1,098.15	-4.043.85	6.73	-7.43	-34.48	1,223,547.15	3,222,005.50	39.94429764	-104.70819409	2.00	2.00	0.00
	1,200.00	11.00	257.85	1,196.63	-3.945.37	10.04	-11.08	-51.45	1,223,543.50	3,221,988.53	39.94428802	-104.70825474	2.00	2.00	0.00
	1,300.00	13.00	257.85	1,294.44	-3.847.56	14.01	-15.46	-71.78	1,223,539.12	3,221,968.20	39.94427650	-104.70832736	2.00	2.00	0.00
	1,400.00	15.00	257.85	1,391.46	-3.750.54	18.62	-20.55	-95.43	1,223,534.03	3,221,944.56	39.94426310	-104.70841187	2.00	2.00	0.00
	1,500.00	17.00	257.85	1,487.58	-3.654.42	23.88	-26.35	-122.37	1,223,528.22	3,221,917.61	39.94424783	-104.70850114	2.00	2.00	0.00
	1,600.00	19.00	257.85	1,582.92	-3.559.32	29.78	-32.86	-152.36	1,223,521.72	3,221,887.41	39.94423071	-104.70859588	2.00	2.00	0.00
	1,700.00	21.00	257.85	1,678.65	-3.465.35	36.30	-40.06	-186.01	1,223,514.52	3,221,853.97	39.94421177	-104.70869354	2.00	2.00	0.00
	1,800.00	23.00	257.85	1,769.36	-3.372.64	43.45	-47.95	-222.63	1,223,506.63	3,221,817.36	39.94419102	-104.70879639	2.00	2.00	0.00
	1,900.00	25.00	257.85	1,860.71	-3.281.29	51.21	-56.51	-262.39	1,223,498.07	3,221,777.60	39.94416848	-104.70900846	2.00	2.00	0.00
	2,000.00	27.00	257.85	1,950.59	-3.191.41	59.57	-65.74	-305.24	1,223,488.84	3,221,734.75	39.94414420	-104.70916157	2.00	2.00	0.00
	2,100.00	29.00	257.85	2,038.88	-3.103.12	68.53	-75.62	-351.14	1,223,478.96	3,221,688.85	39.94411819	-104.70932556	2.00	2.00	0.00
	2,200.00	31.00	257.85	2,125.48	-3.016.52	78.06	-86.15	-400.01	1,223,469.43	3,221,639.98	39.94409049	-104.70950000	2.00	2.00	0.00
	2,300.00	33.00	257.85	2,210.28	-2.931.72	88.17	-97.31	-451.82	1,223,457.22	3,221,586.18	39.94406114	-104.70968529	2.00	2.00	0.00
	2,377.71	34.55	257.85	2,274.87	-2.867.13	96.42	-106.40	-494.05	1,223,445.18	3,221,529.85	39.94403270	-104.70983620	2.00	2.00	0.00
	2,400.00	34.55	257.85	2,293.22	-2.848.78	98.83	-109.06	-506.41	1,223,445.52	3,221,533.59	39.94403020	-104.70988036	2.00	2.00	0.00
	2,500.00	34.55	257.85	2,375.58	-2.766.42	109.65	-121.01	-561.86	1,223,433.58	3,221,478.14	39.94399877	-104.71007848	0.00	0.00	0.00
	2,600.00	34.55	257.85	2,457.94	-2.684.06	120.47	-132.95	-617.30	1,223,421.63	3,221,422.70	39.94396735	-104.71027660	0.00	0.00	0.00
	2,700.00	34.55	257.85	2,540.30	-2.601.70	131.29	-144.89	-672.75	1,223,409.69	3,221,367.25	39.94393592	-104.71047472	0.00	0.00	0.00
	2,800.00	34.55	257.85	2,622.66	-2.519.34	142.11	-156.83	-728.20	1,223,397.75	3,221,311.81	39.94390450	-104.71067284	0.00	0.00	0.00
	2,900.00	34.55	257.85	2,705.02	-2.436.98	152.93	-168.77	-783.64	1,223,385.81	3,221,256.36	39.94387308	-104.71087096	0.00	0.00	0.00
	3,000.00	34.55	257.85	2,787.38	-2.354.62	163.75	-180.69	-839.09	1,223,373.82	3,221,200.82	39.94384167	-104.71106908	0.00	0.00	0.00
	3,100.00	34.55	257.85	2,869.74	-2.272.26	174.57	-192.65	-894.54	1,223,361.93	3,221,145.47	39.94381022	-104.71126720	0.00	0.00	0.00
	3,200.00	34.55	257.85	2,952.10	-2.189.90	185.39	-204.60	-949.99	1,223,349.99	3,221,090.02	39.94377880	-104.71146532	0.00	0.00	0.00
	3,300.00	34.55	257.85	3,034.46	-2.107.54	196.22	-216.54	-1,005.43	1,223,338.05	3,221,034.58	39.94374737	-104.71166344	0.00	0.00	0.00
	3,400.00	34.55	257.85	3,116.81	-2.025.19	207.04	-228.48	-1,060.88	1,223,326.11	3,220,979.13	39.94371595	-104.71186156	0.00	0.00	0.00
	3,500.00	34.55	257.85	3,199.17	-1.942.83	217.86	-240.42	-1,116.33	1,223,314.16	3,220,923.69	39.94368452	-104.71205968	0.00	0.00	0.00
	3,600.00	34.55	257.85	3,281.53	-1.860.47	228.68	-252.36	-1,171.78	1,223,302.22	3,220,868.24	39.94365309	-104.71225780	0.00	0.00	0.00
	3,700.00	34.55	257.85	3,363.89	-1.778.11	239.50	-264.29	-1,228.22	1,223,290.28	3,220,812.80	39.94362166	-104.71245592	0.00	0.00	0.00
	3,800.00	34.55	257.85	3,446.25	-1.695.75	250.32	-276.25	-1,284.67	1,223,278.34	3,220,757.35	39.94359024	-104.71265403	0.00	0.00	0.00
	3,900.00	34.55	257.85	3,528.61	-1.613.39	261.14	-288.19	-1,338.12	1,223,266.40	3,220,701.91	39.94355881	-104.71285215	0.00	0.00	0.00
	4,000.00	34.55	257.85	3,610.97	-1.531.03	271.96	-300.13	-1,393.56	1,223,254.46	3,220,646.46	39.94352738	-104.71305027	0.00	0.00	0.00
	4,100.00	34.55	257.85	3,693.33	-1.448.67	282.78	-312.07	-1,449.01	1,223,242.52	3,220,591.01	39.94349595	-104.71324838	0.00	0.00	0.00
	4,200.00	34.55	257.85	3,775.69	-1.366.31	293.60	-324.01	-1,504.46	1,223,230.58	3,220,535.57	39.94346452	-104.71344650	0.00	0.00	0.00
	4,300.00	34.55	257.85	3,858.05	-1.283.95	304.42	-335.95	-1,559.91	1,223,218.63	3,220,480.12	39.94343309	-104.71364462	0.00	0.00	0.00
	4,400.00	34.55	257.85	3,940.40	-1.201.59	315.24	-347.89	-1,615.36	1,223,206.69	3,220,424.67	39.94340166	-104.71384273	0.00	0.00	0.00
	4,500.00	34.55	257.85	4,022.76	-1.119.24	326.07	-359.84	-1,670.80	1,223,194.75	3,220,369.23	39.94337023	-104.71404085	0.00	0.00	0.00
	4,600.00	34.55	257.85	4,105.12	-1.036.88	336.89	-371.78	-1,726.25	1,223,182.81	3,220,313.79	39.94333880	-104.71423897	0.00	0.00	0.00
	4,700.00	34.55	257.85	4,187.48	-0.954.52	347.71	-383.72	-1,781.69	1,223,170.87	3,220,258.34	39.94330737	-104.71443708	0.00	0.00	0.00
	4,800.00	34.55	257.85	4,269.84	-0.872.16	358.53	-395.66	-1,837.14	1,223,158.93	3,220,202.90	39.94327594	-104.71463520	0.00	0.00	0.00
	4,900.00	34.55	257.85	4,352.20	-0.789.80	369.35	-407.60	-1,892.59	1,223,146.99	3,220,147.45	39.94324451	-104.71483332	0.00	0.00	0.00
	5,000.00	34.55	257.85	4,434.56	-0.707.44	380.17	-419.54	-1,948.04	1,223,135.05	3,220,092.00	39.94321307	-104.71503143	0.00	0.00	0.00
	5,100.00	34.55	257.85	4,516.92	-0.625.08	390.99	-431.49	-2,003.49	1,223,123.11	3,220,036.55	39.94318164	-104.71522955	0.00	0.00	0.00
	5,200.00	34.55	257.85	4,599.28	-0.542.72	401.81	-443.43	-2,058.93	1,223,111.16	3,220,000.00	39.94315021	-104.71542766	0.00	0.00	0.00
	5,300.00	34.55	257.85	4,681.64	-0.460.36	412.63	-455.37	-2,114.38	1,223,099.22	3,219,925.67	39.94311877	-104.71562578	0.00	0.00	0.00
	5,400.00	34.55	257.85	4,764.00	-0.378.00	423.45	-467.31	-2,169.83	1,223,087.28	3,219,870.22	39.94308734	-104.71582389	0.00	0.00	0.00
	5,500.00	34.55	257.85	4,846.35	-0.295.65	434.27	-479.25	-2,225.27	1,223,075.34	3,219,814.78	3				

Comments	MD (ft)	Incl (°)	Azim (°)	TVD (ft)	TVSS (ft)	VSEC (ft)	NS (ft)	EW (ft)	Northing (RUS)	Easting (RUS)	Latitude (°)	Longitude (°)	DLS (°/100ft)	BR (°/100ft)	TR (°/100ft)
	9,800.00	90.00	359.53	7,683.00	2,541.00	1,985.24	365.24	-1,145.41	1,223,919.81	3,217,884.69	39.94542044	-104.72284331	0.00	0.00	0.00
	9,900.00	90.00	359.53	7,683.00	2,541.00	2,057.98	465.24	-1,146.24	1,224,019.80	3,217,893.87	39.94569946	-104.72284314	0.00	0.00	0.00
	10,000.00	90.00	359.53	7,683.00	2,541.00	2,150.25	565.23	-1,147.07	1,224,119.79	3,217,893.04	39.94569947	-104.72284297	0.00	0.00	0.00
	10,100.00	90.00	359.53	7,683.00	2,541.00	2,242.51	665.23	-1,147.90	1,224,219.78	3,217,892.21	39.94624398	-104.72284280	0.00	0.00	0.00
	10,200.00	90.00	359.53	7,683.00	2,541.00	2,334.78	765.23	-1,148.73	1,224,319.78	3,217,891.38	39.94651849	-104.72284263	0.00	0.00	0.00
	10,300.00	90.00	359.53	7,683.00	2,541.00	2,427.05	865.22	-1,149.56	1,224,419.77	3,217,890.55	39.94679300	-104.72284246	0.00	0.00	0.00
	10,400.00	90.00	359.53	7,683.00	2,541.00	2,519.32	965.22	-1,150.39	1,224,519.77	3,217,889.72	39.94570875	-104.72284228	0.00	0.00	0.00
	10,500.00	90.00	359.53	7,683.00	2,541.00	2,611.59	1,065.22	-1,151.21	1,224,619.76	3,217,888.89	39.94734202	-104.72284211	0.00	0.00	0.00
	10,600.00	90.00	359.53	7,683.00	2,541.00	2,703.86	1,165.21	-1,152.04	1,224,719.75	3,217,888.07	39.94761654	-104.72284194	0.00	0.00	0.00
	10,700.00	90.00	359.53	7,683.00	2,541.00	2,796.13	1,265.21	-1,152.87	1,224,819.75	3,217,887.24	39.94789105	-104.72284177	0.00	0.00	0.00
	10,800.00	90.00	359.53	7,683.00	2,541.00	2,888.40	1,365.21	-1,153.70	1,224,919.74	3,217,886.41	39.94816556	-104.72284160	0.00	0.00	0.00
	10,900.00	90.00	359.53	7,683.00	2,541.00	2,980.67	1,465.20	-1,154.53	1,225,019.73	3,217,885.58	39.94844007	-104.72284143	0.00	0.00	0.00
	11,000.00	90.00	359.53	7,683.00	2,541.00	3,072.93	1,565.20	-1,155.36	1,225,119.73	3,217,884.75	39.94871458	-104.72284126	0.00	0.00	0.00
	11,100.00	90.00	359.53	7,683.00	2,541.00	3,165.20	1,665.20	-1,156.19	1,225,219.72	3,217,883.92	39.94898909	-104.72284109	0.00	0.00	0.00
	11,200.00	90.00	359.53	7,683.00	2,541.00	3,257.47	1,765.19	-1,157.01	1,225,319.72	3,217,883.10	39.94926360	-104.72284092	0.00	0.00	0.00
	11,300.00	90.00	359.53	7,683.00	2,541.00	3,349.74	1,865.19	-1,157.84	1,225,419.71	3,217,882.27	39.94953812	-104.72284075	0.00	0.00	0.00
	11,400.00	90.00	359.53	7,683.00	2,541.00	3,442.01	1,965.19	-1,158.67	1,225,519.70	3,217,881.44	39.94981263	-104.72284058	0.00	0.00	0.00
	11,500.00	90.00	359.53	7,683.00	2,541.00	3,534.28	2,065.18	-1,159.50	1,225,619.70	3,217,880.61	39.95008714	-104.72284041	0.00	0.00	0.00
	11,600.00	90.00	359.53	7,683.00	2,541.00	3,626.55	2,165.18	-1,160.33	1,225,719.69	3,217,879.78	39.95036165	-104.72284024	0.00	0.00	0.00
	11,700.00	90.00	359.53	7,683.00	2,541.00	3,718.82	2,265.18	-1,161.16	1,225,819.68	3,217,878.95	39.95063616	-104.72284007	0.00	0.00	0.00
	11,800.00	90.00	359.53	7,683.00	2,541.00	3,811.09	2,365.17	-1,161.99	1,225,919.68	3,217,878.13	39.95091067	-104.72283990	0.00	0.00	0.00
	11,900.00	90.00	359.53	7,683.00	2,541.00	3,903.37	2,465.17	-1,162.81	1,226,019.67	3,217,877.30	39.95118518	-104.72283973	0.00	0.00	0.00
	12,000.00	90.00	359.53	7,683.00	2,541.00	3,995.62	2,565.16	-1,163.64	1,226,119.66	3,217,876.47	39.95145970	-104.72283956	0.00	0.00	0.00
	12,100.00	90.00	359.53	7,683.00	2,541.00	4,087.89	2,665.16	-1,164.47	1,226,219.66	3,217,875.64	39.95173421	-104.72283939	0.00	0.00	0.00
	12,200.00	90.00	359.53	7,683.00	2,541.00	4,180.16	2,765.16	-1,165.30	1,226,319.65	3,217,874.81	39.95200872	-104.72283922	0.00	0.00	0.00
	12,300.00	90.00	359.53	7,683.00	2,541.00	4,272.43	2,865.15	-1,166.13	1,226,419.64	3,217,873.98	39.95228323	-104.72283905	0.00	0.00	0.00
	12,400.00	90.00	359.53	7,683.00	2,541.00	4,364.70	2,965.15	-1,166.96	1,226,519.64	3,217,873.15	39.95255774	-104.72283888	0.00	0.00	0.00
	12,500.00	90.00	359.53	7,683.00	2,541.00	4,456.97	3,065.15	-1,167.79	1,226,619.63	3,217,872.33	39.95283225	-104.72283871	0.00	0.00	0.00
	12,600.00	90.00	359.53	7,683.00	2,541.00	4,549.24	3,165.14	-1,168.61	1,226,719.62	3,217,871.50	39.95310676	-104.72283854	0.00	0.00	0.00
	12,700.00	90.00	359.53	7,683.00	2,541.00	4,641.50	3,265.14	-1,169.44	1,226,819.62	3,217,870.67	39.95338128	-104.72283837	0.00	0.00	0.00
	12,800.00	90.00	359.53	7,683.00	2,541.00	4,733.77	3,365.14	-1,170.27	1,226,919.61	3,217,869.84	39.95365579	-104.72283820	0.00	0.00	0.00
	12,900.00	90.00	359.53	7,683.00	2,541.00	4,826.04	3,465.13	-1,171.10	1,227,019.60	3,217,869.01	39.95393030	-104.72283803	0.00	0.00	0.00
	13,000.00	90.00	359.53	7,683.00	2,541.00	4,918.31	3,565.13	-1,171.93	1,227,119.60	3,217,868.18	39.95420481	-104.72283786	0.00	0.00	0.00
	13,100.00	90.00	359.53	7,683.00	2,541.00	5,010.58	3,665.13	-1,172.75	1,227,219.59	3,217,867.35	39.95447932	-104.72283769	0.00	0.00	0.00
	13,200.00	90.00	359.53	7,683.00	2,541.00	5,102.85	3,765.12	-1,173.58	1,227,319.58	3,217,866.53	39.95475383	-104.72283752	0.00	0.00	0.00
	13,300.00	90.00	359.53	7,683.00	2,541.00	5,195.12	3,865.12	-1,174.41	1,227,419.58	3,217,865.70	39.95502834	-104.72283735	0.00	0.00	0.00
	13,400.00	90.00	359.53	7,683.00	2,541.00	5,287.39	3,965.12	-1,175.24	1,227,519.57	3,217,864.87	39.95530285	-104.72283718	0.00	0.00	0.00
	13,500.00	90.00	359.53	7,683.00	2,541.00	5,379.66	4,065.11	-1,176.07	1,227,619.57	3,217,864.04	39.95557737	-104.72283701	0.00	0.00	0.00
	13,600.00	90.00	359.53	7,683.00	2,541.00	5,471.92	4,165.11	-1,176.90	1,227,719.56	3,217,863.21	39.95585188	-104.72283684	0.00	0.00	0.00
	13,700.00	90.00	359.53	7,683.00	2,541.00	5,564.19	4,265.11	-1,177.72	1,227,819.55	3,217,862.39	39.95612639	-104.72283667	0.00	0.00	0.00
	13,800.00	90.00	359.53	7,683.00	2,541.00	5,656.46	4,365.10	-1,178.55	1,227,919.55	3,217,861.56	39.95640090	-104.72283650	0.00	0.00	0.00
	13,900.00	90.00	359.53	7,683.00	2,541.00	5,748.73	4,465.10	-1,179.38	1,228,019.54	3,217,860.73	39.95667541	-104.72283633	0.00	0.00	0.00
	14,000.00	90.00	359.53	7,683.00	2,541.00	5,841.00	4,565.10	-1,180.21	1,228,119.53	3,217,859.90	39.95694992	-104.72283616	0.00	0.00	0.00
	14,100.00	90.00	359.53	7,683.00	2,541.00	5,933.27	4,665.09	-1,181.04	1,228,219.52	3,217,859.07	39.95722443	-104.72283599	0.00	0.00	0.00
	14,200.00	90.00	359.53	7,683.00	2,541.00	6,025.54	4,765.09	-1,181.87	1,228,319.52	3,217,858.24	39.95749895	-104.72283582	0.00	0.00	0.00
	14,300.00	90.00	359.53	7,683.00	2,541.00	6,117.81	4,865.09	-1,182.70	1,228,419.51	3,217,857.41	39.95777346	-104.72283565	0.00	0.00	0.00
	14,400.00	90.00	359.53	7,683.00	2,541.00	6,210.07	4,965.08	-1,183.52	1,228,519.51	3,217,856.59	39.95804797	-104.72283548	0.00	0.00	0.00
	14,500.00	90.00	359.53	7,683.00	2,541.00	6,302.34	5,065.08	-1,184.35	1,228,619.50	3,217,855.76	39.95832248	-104.72283531	0.00	0.00	0.00
	14,600.00	90.00	359.53	7,683.00	2,541.00	6,394.61	5,165.08	-1,185.18	1,228,719.49	3,217,854.93	39.95859699	-104.72283514	0.00	0.00	0.00
	14,700.00	90.00	359.53	7,683.00	2,541.00	6,486.88	5,265.07	-1,186.01	1,228,819.49	3,217,854.10	39.95887150	-104.72283497	0.00	0.00	0.00
	14,800.00	90.00	359.53	7,683.00	2,541.00	6,579.15	5,365.07	-1,186.84	1,228,919.48	3,217,853.27	39.95914601	-104.72283480	0.00	0.00	0.00
	14,900.00	90.00	359.53	7,683.00	2,541.00	6,671.42	5,465.07	-1,187.67	1,229,019.47	3,217,852.44	39.95942052	-104.72283463	0.00	0.00	0.00
	15,000.00	90.00	359.53	7,683.00	2,541.00	6,763.69	5,565.06	-1,188.49	1,229,119.47	3,217,851.61	39.95969504	-104.72283446	0.00	0.00	0.00
	15,100.00	90.00	359.53	7,683.00	2,541.00	6,855.96	5,665.06	-1,189.32	1,229,219.46	3,217,850.79	39.95996955	-104.72283429	0.00	0.00	0.00
	15,200.00	90.00	359.53	7,683.00	2,541.00	6,948.23	5,765.05	-1,190.15	1,229,319.45	3,217,849.96	39.96024406	-104.72283412	0.00	0.00	0.00
	15,300.00	90.00	359.53	7,683.00	2,541.00	7,040.49	5,865.05	-1,190.98	1,229,419.45	3,217,849.13	39.96051857	-104.72283395	0.00	0.00	0.00
	15,400.00	90.00	359.53	7,683.00	2,541.00	7,132.76	5,965.05	-1,191.81	1,229,519.44	3,217,848.30	39.96079308	-104.72283378	0.00	0.00	0.00
	15,500.00	90.00	359.53	7,683.00	2,541.00	7,225.03	6,065.04	-1,192.64	1,229,619.43	3,217,847.47	39.96106759	-104.72283361	0.00	0.00	0.00
	15,600.00	90.00	359.53	7,683.00	2,541.00	7,317.30	6,165.04	-1,193.47	1,229,719.43	3,217,846.64	39.96134210	-104.72283344	0.00	0.00	0.00
	15,700.00	90.00	359.53	7,683.00	2,541.00	7,409.57	6,265.04	-1,194.29	1,229,819.42	3,217,845.81	39.96161661	-104.72283327	0.00	0.00	0.00