

FLOWLINE DECOMMISSIONING REPORT IVEY LC 02-033HC FLOWLINE

ECMC REMEDIATION # 39541

Prepared for:



PDC ENERGY

1099 18th Street
Suite 1500
Denver, CO 80202

Prepared by:



4725 Independence Street
Wheat Ridge, CO 80033

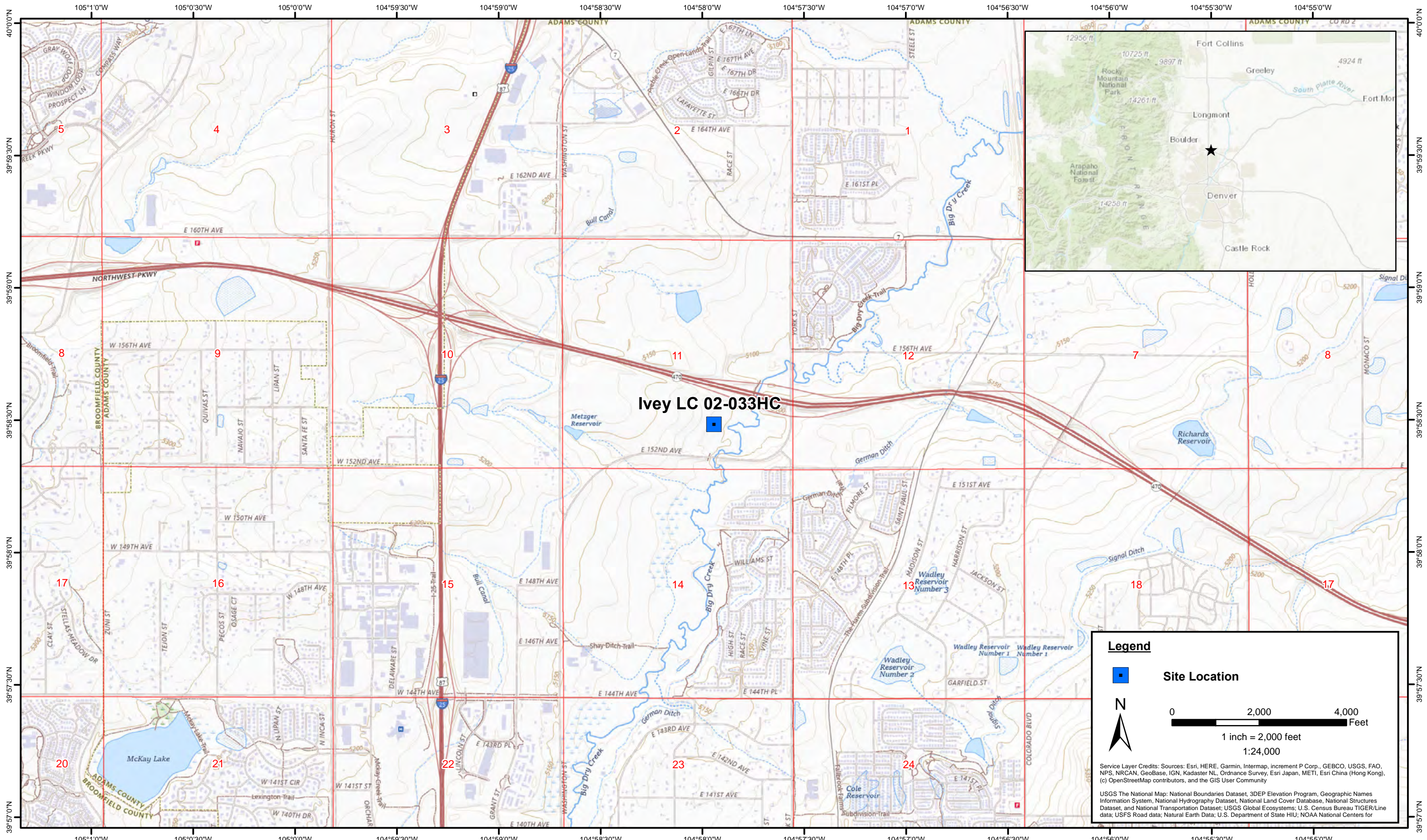

DATE:	June 2025
DESIGNED BY:	B. Nelson
DRAWN BY:	L. Reed



Tasman, Inc.
4725 Independence St.
Wheat Ridge, CO 80033

PDC Energy, Inc. – 69175 – DJ Basin
Ivey LC 02-033HC
 SWSE, Section 11, Township 1 South, Range 68 West
 Adams County, Colorado

Site Location Map

Figure
1



DATE: June 2, 2025

DESIGNED BY: J. Whritenour

DRAWN BY: A. Haug



PDC Energy – 69175 – DJ Basin
Ivey LC 02-033HC
SWSE, Section 11, Township 1 South, Range 68 West
Weld County, Colorado

SOIL SAMPLE LOCATION MAP
(4/17/2025)

FIGURE
2

TABLE 1
FIELD DATA SUMMARY TABLE
PDC ENERGY, INC. - 69175
IVEY LC 02-033HC FLOWLINE, ADAMS COUNTY, COLORADO
REM #39541



Sample ID	Sample Date	Depth (ft. bgs)	GPS Data ⁽¹⁾ Latitude/Longitude		PDOP Value	VOC Concentration ⁽²⁾ (ppm)
FL01R-S@3'	4/17/2025	3	39.974578	-104.965985	0.9	0.1
FL01R-W@3'	4/17/2025	3	39.974801	-104.965685	1.1	0.1
BKG01@1'	4/17/2025	1	39.975065	-104.965940	0.9	0.0
BKG01@3'	4/17/2025	3	39.975065	-104.965940	0.9	0.0
BKG02@1'	4/17/2025	1	39.975242	-104.965843	0.9	0.0
BKG02@3'	4/17/2025	3	39.975242	-104.965843	0.9	0.0

1. Global Positioning System (GPS) data is provided in decimal degrees using North American Datum (NAD) 83 UTM Zone 13 North.

2. Volatile organic compound (VOC) concentrations are measured in the field using a photoionization detector (PID).

NC = Not Calculated

PDOP = Position Dilution of Precision

ppm = Parts per million

ft. = Feet

bgs = Below ground surface

Source material characterization sample, excavated and transported off site for disposal.

Material excavated and transported off site for disposal.

TABLE 2
SUMMARY OF VOLATILE ORGANIC SOIL CHEMISTRY DATA
PDC ENERGY, INC. - 69175
IVEY LC 02-033HC FLOWLINE, ADAMS COUNTY, COLORADO
REM #39541



Sample ID	Sample Date	Depth (ft. bgs)	Benzene (mg/kg)	Toluene (mg/kg)	Ethyl-Benzene (mg/kg)	Xylenes (mg/kg)	1,2,4-Trimethyl-Benzene (mg/kg)	1,3,5-Trimethyl-Benzene (mg/kg)	Naphthalene (mg/kg)	TPH (mg/kg)	TPH GRO (mg/kg)	TPH DRO (mg/kg)	TPH ORO (mg/kg)
ECMC Table 915-1 Limits (Residential SSL)			1.2	490	5.8	58	30	27	2	500	500**		
ECMC Table 915-1 Limits (Protection of Groundwater SSL)			0.0026	0.69	0.78	9.9	0.0081	0.0087	0.0038	500	500**		
FL01R-S@3'	4/17/2025	3	<0.0020	<0.0050	<0.0050	<0.010	<0.0050	<0.0050	<0.0038	<50	<0.50	<50	<50
FL01R-W@3'	4/17/2025	3	<0.0020	<0.0050	<0.0050	<0.010	<0.0050	<0.0050	<0.0038	<50	<0.50	<50	<50

1. Bold values exceed the ECMC Table 915-1 limit(s)
 2. Red & blue highlighted soil analytical values indicate an exceedance of the referenced soil screening level (SSL)
 3. ** Summation of GRO+DRO+ORO must be less than 500 mg/kg
- (<) = Analytical result is less than the indicated laboratory reporting limit.
TPH-GRO = Total petroleum hydrocarbons - gasoline range organics
TPH-DRO = Total petroleum hydrocarbons - diesel range organics
TPH-ORO = Total petroleum hydrocarbons - oil range organics
mg/kg = Milligrams per kilogram
ECMC = Energy & Carbon Management Commission
ft. = Feet
bgs = Below ground surface
NA - Not analyzed

TABLE 3
SUMMARY OF POLYCYCLIC AROMATIC HYDROCARBON SOIL CHEMISTRY DATA
PDC ENERGY, INC. - 69175
IVEY LC 02-033HC FLOWLINE, ADAMS COUNTY, COLORADO
REM #39541



Sample ID	Sample Date	Depth (ft. bgs)	Acenaphthene (mg/kg)	Anthracene (mg/kg)	Benzo (a) Anthracene (mg/kg)	Benzo (a) Pyrene (mg/kg)	Benzo (b) Fluoranthene (mg/kg)	Benzo (k) Fluoranthene (mg/kg)	Chrysene (mg/kg)	Dibenzo (a,h) Anthracene (mg/kg)	Fluoranthene (mg/kg)	Fluorene (mg/kg)	Indeno (1,2,3-cd) Pyrene (mg/kg)	Pyrene (mg/kg)	1-Methyl - Naphthalene (mg/kg)	2-Methyl- Naphthalene (mg/kg)
ECMC Table 915-1 Limits (Residential SSL)			360	1800	1.1	0.11	1.1	11	110	0.11	240	240	1.1	180	18	24
ECMC Table 915-1 Limits (Protection of Groundwater SSL)			0.55	5.8	0.011	0.24	0.3	2.9	9	0.096	8.9	0.54	0.98	1.3	0.006	0.019
FL01R-S@3'	4/17/2025	3	<0.00500	<0.00500	<0.00500	<0.00500	<0.00500	<0.00500	<0.00500	<0.00500	<0.00500	<0.00500	<0.00500	<0.00500	<0.00500	<0.00500
FL01R-W@3'	4/17/2025	3	<0.00500	0.0154	0.0116	0.0121	<0.00500	<0.00500	0.0272	<0.00500	0.0167	<0.00500	<0.00500	0.0534	<0.00500	<0.00500

1. Bold values exceed the ECMC Table 915-1 limit(s)
2. Red & blue highlighted soil analytical values indicate an exceedance of the referenced soil screening level (SSL)
3. * Indicates laboratory minimum detection limit in excess of SSL
(<) = Analytical result is less than the indicated laboratory reporting limit.
mg/kg = Milligrams per kilogram
ECMC = Energy & Carbon Management Commission
ft. = Feet
bgs = Below ground surface
NA - Not analyzed

TABLE 4
SUMMARY OF SOIL SUITABILITY FOR RECLAMATION
PDC ENERGY, INC. - 69175
IVEY LC 02-033HC FLOWLINE, ADAMS COUNTY, COLORADO
REM #39541



Sample ID	Sample Date	Depth (ft. bgs)	pH (Standard Units)	EC (mmhos/cm)	SAR (Standard Units)	Boron (mg/L)
ECMC Table 915-1 Soil Suitability Limits			6 - 8.3	<4	<6	2
FL01R-S@3'	4/17/2025	3	8.75	0.212	2.30	<2.00
FL01R-W@3'	4/17/2025	3	8.71	0.268	2.91	<2.00
BKG01@1'	4/17/2025	1	8.63	0.343	4.97	<2.00
BKG01@3'	4/17/2025	3	8.65	0.719	5.13	<2.00
BKG02@1'	4/17/2025	1	8.75	0.278	4.50	<2.00
BKG02@3'	4/17/2025	3	8.97	0.205	5.21	<2.00
Maximum Background Concentration			8.97	-	-	-

- Bold** faced values exceed the ECMC Table 915-1 limit(s), but are within background concentrations.
- Bold** faced values exceed the ECMC Table 915-1 limit(s) and native background concentrations.
- Brown highlighted soil analytical values indicate a regulatory exceedance.

mg/L = Milligrams per liter

(<) = Analytical result is less than the indicated laboratory reporting limit.

ECMC = Energy & Carbon Management Commission

ft. = Feet

bgs = Below ground surface

mmhos/cm = Millimohs per centimeter

NA - Not analyzed

TABLE 4
SUMMARY OF SOIL SUITABILITY FOR RECLAMATION
PDC ENERGY, INC. - 69175
IVEY LC 02-033HC FLOWLINE, ADAMS COUNTY, COLORADO
REM #39541



Sample ID	Sample Date	Depth (ft. bgs)	Arsenic (mg/kg)	Barium (mg/kg)	Cadmium (mg/kg)	Chromium (VI) ⁽⁴⁾ (mg/kg)	Copper (mg/kg)	Lead (mg/kg)	Nickel (mg/kg)	Selenium (mg/kg)	Silver (mg/kg)	Zinc (mg/kg)
ECMC Table 915-1 Limits (Residential SSL)			0.68	15000	71	0.3	3100	400	1500	390	390	23000
ECMC Table 915-1 Limits (Protection of Groundwater SSL)			0.29	82	0.38	0.00067	46	14	26	0.26	0.8	370
FL01R-S@3'	4/17/2025	3	1.92	190	<0.200	<0.30	17.7	12.0	17.1	<0.260	0.0475	58.8
FL01R-W@3'	4/17/2025	3	1.65	138	0.203	<0.30	11.6	7.17	10.6	<0.260	0.0355	43.6
BKG01@1'	4/17/2025	1	1.33	246	<0.200	<0.30	11.4	5.77	6.47	<0.260	0.0250	32.2
BKG01@3'	4/17/2025	3	1.34	294	<0.200	<0.30	15.4	9.97	8.32	<0.260	0.0341	37.1
BKG02@1'	4/17/2025	1	1.59	298	<0.200	<0.30	10.1	7.03	8.21	<0.260	0.0350	33.3
BKG02@3'	4/17/2025	3	1.45	308	<0.200	<0.30	52.0	10.5	7.21	<0.260	0.454	30.5
1.25x Maximum Background Concentration			1.99	385	-	-	-	-	-	-	-	-

1. **Bold** faced values exceed the ECMC Table 915-1 limit(s), but are within 1.25x background concentrations.
 2. **Red** faced values exceed the ECMC Table 915-1 limit(s) and native background concentrations.
 3. Red & blue highlighted soil analytical values indicate an exceedance of the referenced soil screening level (SSL).
 4. Compound falls within ECMC Table 915-1 Footnote 9.
 5. Non-detect background results accounted for in the highest background concentration by using the reporting limit.
 6. * Indicates laboratory minimum detection limit in excess of SSL
- ECMC = Energy & Carbon Management Commission
(<) = Analytical result is less than the indicated laboratory reporting limit.
mg/kg = Milligrams per kilogram
ft. = Feet
bgs = Below ground surface
NA - Not analyzed



SITE NAME: IVEY LC 02-033HC FLOWLINE							DATE: 4/16/2025	REM. PROJECT #: 39541	WEATHER: Clear, 70		
SITE DIRECTIONS: York street and E 152nd parkway, 0.1 mi west, N into site							CLIENT: PDC				
LEGALS AND LAT/LONG: 39.974826, -104.965668							TASMAN PERSONNEL: C. Kenigsberg				
SOIL TYPES: Clayey Sand - SC							SURFACE GRADIENT: West				
SOIL SAMPLING							FACILITY INFRASTRUCTURE				
Date/Time	Soil Sample ID	PID (ppm)	Visual	Olfactory	Photo?	Grab or Lab Sample?	EQUIPMENT	Quantity	Photo?		
							Above Ground Storage Tank (AST)				
4/17/2025 13:22	FL01R-S@3'	0.1	No Staining	No Odor	Yes	Lab	Buried or Partially Buried Vessel				
4/17/2025 11:24	FL01R-W@3'	0.1	No Staining	No Odor	Yes	Lab	Separator				
							Emission Control Device (ECD)				
4/17/2025 13:59	BKG01@1'	0.0	No Staining	No Odor	Yes	Lab	Dump Line				
4/17/2025 14:00	BKG01@3'	0.0	No Staining	No Odor	Yes	Lab	Wellhead				
4/17/2025 14:02	BKG02@1'	0.0	No Staining	No Odor	Yes	Lab	Flowline	1	✓		
4/17/2025 14:03	BKG02@3'	0.0	No Staining	No Odor	Yes	Lab	Other:				
							Soil Loads Removed				
							IMPACTED SOIL IDENTIFIED?				
							ESTIMATED VOLUME OF IMPACTS:				
							Date	Number	CY		
							Total Removed	0	0		
							Disposal Facility:				
							Groundwater Recovery				
							DATE GW ENCOUNTERED:	DEPTH:			
							GROUNDWATER IN CONTACT WITH IMPACTED SOIL?				
							LNAPL OR SHEEN OBSERVED ON GW?				
GROUNDWATER SAMPLING							Date	BBLs			
Date/Time	Groundwater Sample ID	Depth Collected	Turbid?	Sheen?	Odor?	Photo?					
							Total Removed	0			
							Disposal Facility:				

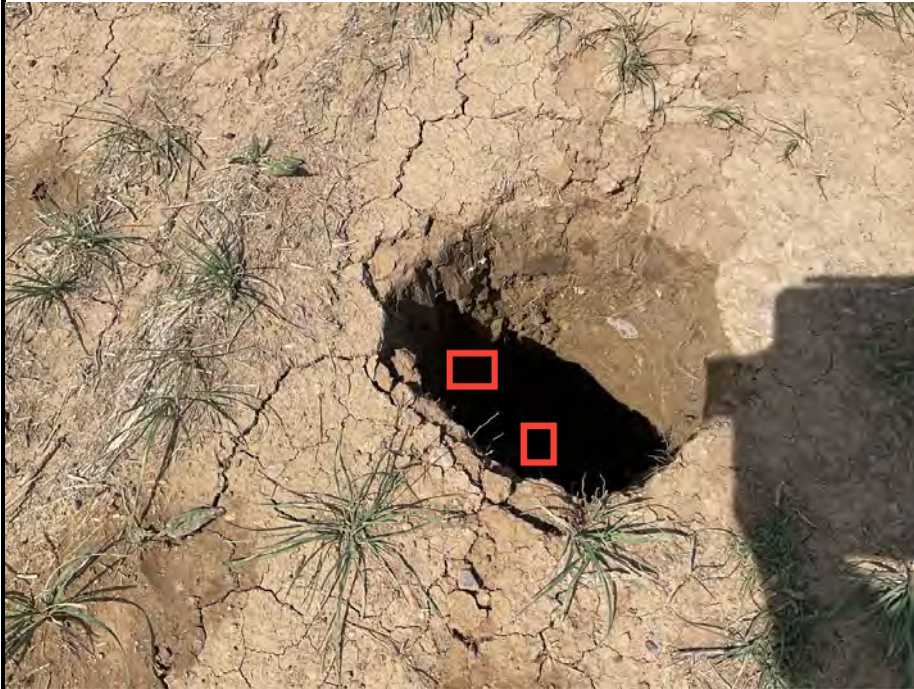

Equipment ID: FL01R-W@3'		Equipment Type:		Equipment ID: FL01R-S@3'		Equipment Type:	
Material:	Volume:	Contents:		Material:	Volume:	Contents:	
Notes/Conditions: Facing East , water in hole due to HVAC				Notes/Conditions: Facing East, water due to HVAC			

					
Equipment ID: BKG01@1', BKG01@3'		Equipment Type:	Equipment ID: BKG02@1', BKG02@3'		Equipment Type:
Material:	Volume:	Contents:	Material:	Volume:	Contents:
Notes/Conditions: Facing north			Notes/Conditions: Facing north		