

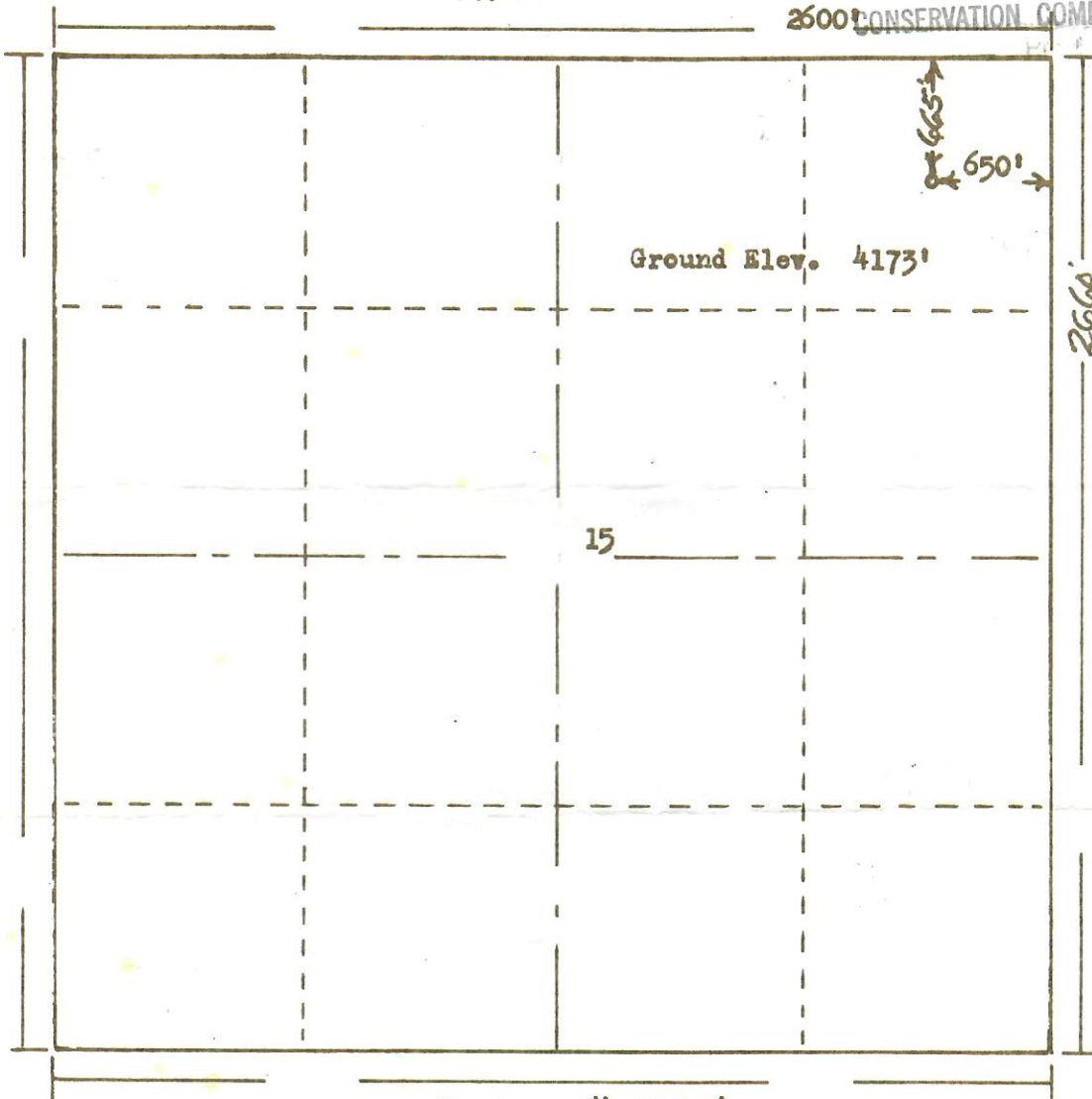

NOV23 1965

R. 53W

OIL & GAS
2600' CONSERVATION COMMISSION



T. 10 N

Scale ... 1" = 1000'

Powers Surveyors, Inc. of Denver, Colorado
has in accordance with a request from Mr. Hula
for C.F. Raymond & Exeter Drlg. determined the
Location of No.2 State
to be CNE NE Section 15 Township 10N
Range 53W of the 6th Principal Meridian
Logan County, Colorado

BEST COPY AVAILABLE

I hereby certify that this plat is an
accurate representation of a correct
survey showing the location of

Date: 11-15-65

Bill G. Hollaway
Licensed Land Surveyor No. 12855
State of Colorado

65491

X
C

1