

**LEGEND**

- SOIL BORING LOCATION
- ⊗ SOIL SAMPLE LOCATION
- ABOVE GROUND STORAGE TANK
- ▭ FORMER FACILITY
- FLOW LINE
- ▨ CONTAINMENT BERM
- ▩ CONTAINMENT WALL
- FENCE LINE

| 10/13/2023 | DATE SAMPLED | 10/13/2023 | DATE SAMPLED | 10/13/2023 | DATE SAMPLED |
|------------|--------------|------------|--------------|------------|--------------|
| FLU (F)    | FLU (F)      | FLU (F)    | FLU (F)      | FLU (F)    | FLU (F)      |
| ACE        | <-0.0050     | ACE        | <-0.0050     | ACE        | <-0.0050     |
| Ant        | <-0.0050     | Ant        | <-0.0050     | Ant        | <-0.0050     |
| BaA        | <-0.0050     | BaA        | <-0.0050     | BaA        | <-0.0050     |
| BbF        | <-0.0050     | BbF        | <-0.0050     | BbF        | <-0.0050     |
| BaP        | <-0.0050     | BaP        | <-0.0050     | BaP        | <-0.0050     |
| Chr        | <-0.0050     | Chr        | <-0.0050     | Chr        | <-0.0050     |
| DBahAnt    | <-0.0050     | DBahAnt    | <-0.0050     | DBahAnt    | <-0.0050     |
| FLU        | <-0.0050     | FLU        | <-0.0050     | FLU        | <-0.0050     |
| 1123cdPY   | <-0.0050     | 1123cdPY   | <-0.0050     | 1123cdPY   | <-0.0050     |
| 1MN        | <-0.0050     | 1MN        | <-0.0050     | 1MN        | <-0.0050     |
| 2MN        | <-0.0050     | 2MN        | <-0.0050     | 2MN        | <-0.0050     |
| PY         | <-0.0050     | PY         | <-0.0050     | PY         | <-0.0050     |

**Figure 1  
PROPOSED SITE INVESTIGATION PLAN**

**NOBLE ENERGY INC - BARNARD-64N65W 4SNNW**  
 SNNW Sec. 4, T4N, R65W, 6th PM  
 Weld County, Colorado  
 40.346296°, -104.674571°

|                              |                               |                             |
|------------------------------|-------------------------------|-----------------------------|
| Project #<br><b>CO23-264</b> | API #                         | Facility #<br><b>330172</b> |
| Date<br><b>4/19/24</b>       | Remediation #<br><b>28824</b> | Filename<br><b>23264Q</b>   |

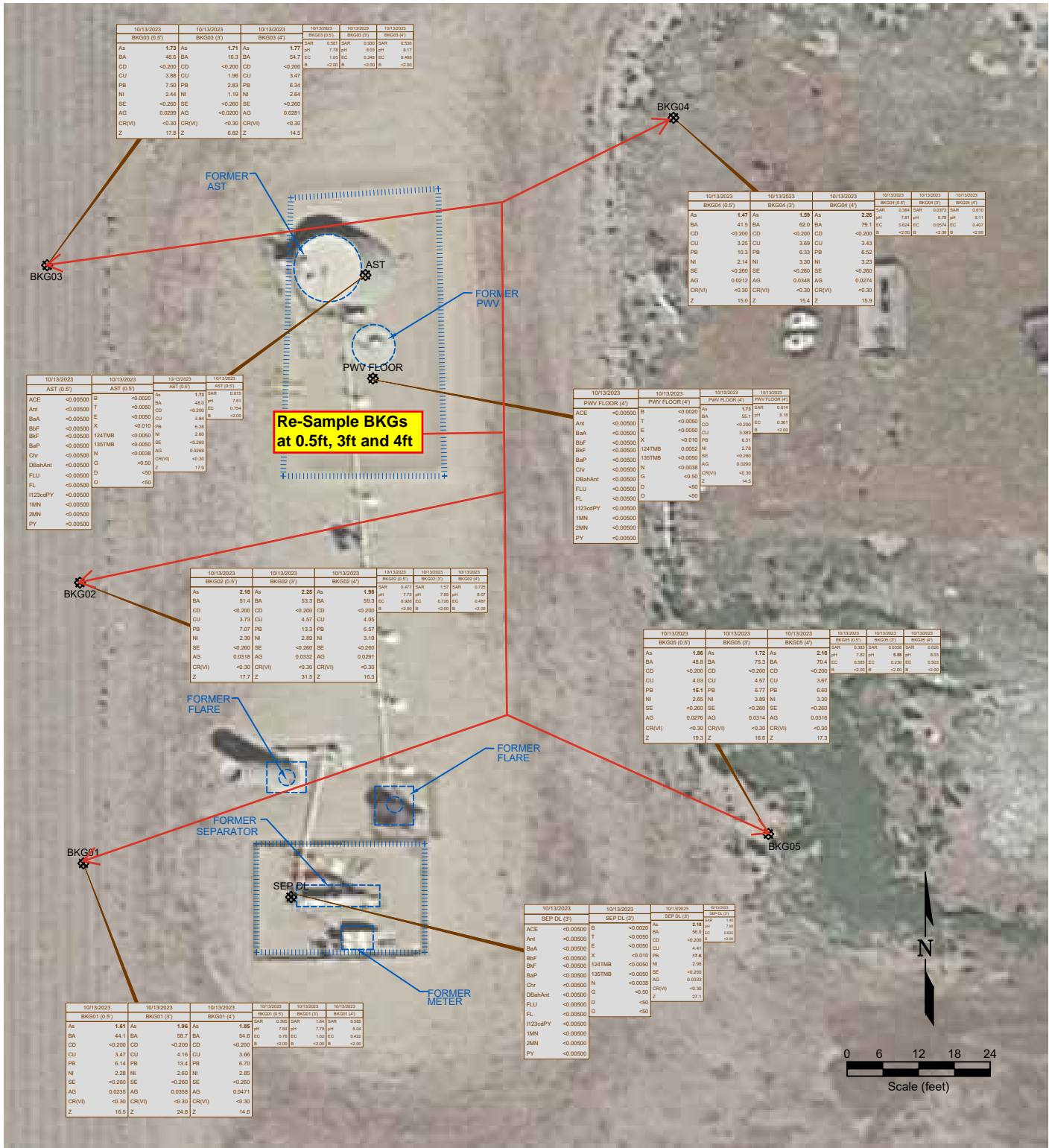

**LEGEND**

- SOIL BORING LOCATION
- ⊗ SOIL SAMPLE LOCATION
- ABOVE GROUND STORAGE TANK
- FORMER FACILITY
- FLOW LINE
- ▤ CONTAINMENT BERM
- ▥ CONTAINMENT WALL
- FENCE LINE

| 10/13/2023 | 10/13/2023 | 10/13/2023 | 10/13/2023 | 10/13/2023 | 10/13/2023 |
|------------|------------|------------|------------|------------|------------|
| FLU (4)    | BKG01 (2)  | BKG01 (4)  | BKG01 (2)  | BKG01 (4)  | BKG01 (4)  |
| As         | 1.41       | As         | 1.96       | As         | 1.88       |
| BA         | 44.1       | BA         | 58.7       | BA         | 54.8       |
| CD         | <0.200     | CD         | <0.200     | CD         | <0.200     |
| CU         | 3.47       | CU         | 4.16       | CU         | 3.66       |
| PB         | 6.14       | PB         | 13.4       | PB         | 6.70       |
| NI         | 2.23       | NI         | 2.60       | NI         | 2.85       |
| SE         | <0.260     | SE         | <0.260     | SE         | <0.260     |
| AG         | 0.0235     | AG         | 0.0368     | AG         | 0.0471     |
| CR(VI)     | <0.30      | CR(VI)     | <0.30      | CR(VI)     | <0.30      |
| Z          | 16.5       | Z          | 24.8       | Z          | 14.6       |

| 10/13/2023 | 10/13/2023 | 10/13/2023 | 10/13/2023 | 10/13/2023 | 10/13/2023 |
|------------|------------|------------|------------|------------|------------|
| FLU (4)    | FLU (4)    | FLU (4)    | FLU (4)    | FLU (4)    | FLU (4)    |
| As         | <0.001     | As         | <0.001     | As         | <0.001     |
| Ant        | <0.0050    | Ant        | <0.0050    | Ant        | <0.0050    |
| BaA        | <0.0050    | BaA        | <0.0050    | BaA        | <0.0050    |
| BbF        | <0.0050    | BbF        | <0.0050    | BbF        | <0.0050    |
| BaP        | <0.0050    | BaP        | <0.0050    | BaP        | <0.0050    |
| Chr        | <0.0050    | Chr        | <0.0050    | Chr        | <0.0050    |
| DBahAnt    | <0.0050    | DBahAnt    | <0.0050    | DBahAnt    | <0.0050    |
| FLU        | <0.0050    | FLU        | <0.0050    | FLU        | <0.0050    |
| 1123cdPY   | <0.0050    | 1123cdPY   | <0.0050    | 1123cdPY   | <0.0050    |
| 1MN        | <0.0050    | 1MN        | <0.0050    | 1MN        | <0.0050    |
| 2MN        | <0.0050    | 2MN        | <0.0050    | 2MN        | <0.0050    |
| PY         | <0.0050    | PY         | <0.0050    | PY         | <0.0050    |

| 10/13/2023 | 10/13/2023 | 10/13/2023 | 10/13/2023 | 10/13/2023 | 10/13/2023 |
|------------|------------|------------|------------|------------|------------|
| FLU (4)    | FLU (4)    | FLU (4)    | FLU (4)    | FLU (4)    | FLU (4)    |
| As         | <0.001     | As         | <0.001     | As         | <0.001     |
| Ant        | <0.0050    | Ant        | <0.0050    | Ant        | <0.0050    |
| BaA        | <0.0050    | BaA        | <0.0050    | BaA        | <0.0050    |
| BbF        | <0.0050    | BbF        | <0.0050    | BbF        | <0.0050    |
| BaP        | <0.0050    | BaP        | <0.0050    | BaP        | <0.0050    |
| Chr        | <0.0050    | Chr        | <0.0050    | Chr        | <0.0050    |
| DBahAnt    | <0.0050    | DBahAnt    | <0.0050    | DBahAnt    | <0.0050    |
| FLU        | <0.0050    | FLU        | <0.0050    | FLU        | <0.0050    |
| 1123cdPY   | <0.0050    | 1123cdPY   | <0.0050    | 1123cdPY   | <0.0050    |
| 1MN        | <0.0050    | 1MN        | <0.0050    | 1MN        | <0.0050    |
| 2MN        | <0.0050    | 2MN        | <0.0050    | 2MN        | <0.0050    |
| PY         | <0.0050    | PY         | <0.0050    | PY         | <0.0050    |

**Figure 2  
PROPOSED SITE INVESTIGATION PLAN**

**NOBLE ENERGY INC - BARNARD-64N65W 4SNNW**  
 SWNW Sec. 4, T4N, R65W, 6th PM  
 Weld County, Colorado  
 40.346296° , -104.674571°

|                              |                               |                             |
|------------------------------|-------------------------------|-----------------------------|
| Project #<br><b>CO23-264</b> | API #                         | Facility #<br><b>330172</b> |
| Date<br><b>4/19/24</b>       | Remediation #<br><b>28824</b> | Filename<br><b>23264Q</b>   |