

Miller 12-27

SWNW Sec. 27-T2N-R68W

API #: 123-19855

Facility ID: 485466

Remediation Project #: 39723

Form 19 Data Package

May 2025

Prepared by Tasman, Inc.



On behalf of Crestone Peak Resources Operating, LLC



PHOTO LOG



Photographic Log

56°NE (T) ● 40°6'40"N, 104°59'48"W ±16ft ▲ 4976ft			135°SE (T) ● 40°6'40"N, 104°59'48"W ±16ft ▲ 4979ft		
05 May 2025, 10:06:23			05 May 2025, 12:40:38		
Equipment ID:		Equipment Type:	Equipment ID:		Equipment Type:
Material:	Volume:	Contents:	Material:	Volume:	Contents:
Notes/Conditions: Soil sampling and screening locations			Notes/Conditions: Soil screening location		



Photographic Log

Equipment ID:		Equipment Type:		Equipment ID:		Equipment Type:	
Material:	Volume:	Contents:		Material:	Volume:	Contents:	
Notes/Conditions: Soil screening location				Notes/Conditions: Soil screening location			



Photographic Log

<p>☉ 92°E (T) ● 40°6'40"N, 104°59'48"W ±16ft ▲ 4980ft</p>			<p>☉ 38°NE (T) ● 40°6'41"N, 104°59'47"W ±16ft ▲ 4979ft</p>		
<p style="text-align: right; color: yellow;">WHS-S01@3 X</p> <p style="text-align: right; color: gray;">05 May 2025, 12:44:50</p>			<p style="text-align: center; color: yellow;">FL-B02@3 X</p> <p style="text-align: right; color: gray;">09 May 2025, 09:30:03</p>		
<p>Equipment ID:</p>			<p>Equipment ID:</p>		
<p>Equipment Type:</p>			<p>Equipment Type:</p>		
<p>Material:</p>	<p>Volume:</p>	<p>Contents:</p>	<p>Material:</p>	<p>Volume:</p>	<p>Contents:</p>
<p>Notes/Conditions: Soil screening location.</p>			<p>Notes/Conditions: Soil screening location.</p>		



Photographic Log

<p>☉ 22°NE (T) ● 40°6'41"N, 104°59'47"W ±16ft ▲ 4977ft</p>			<p>☉ 189°S (T) ● 40°6'43"N, 104°59'46"W ±16ft ▲ 4975ft</p>		
<p style="text-align: center; color: yellow; font-weight: bold;">FL-B03@3' X</p> <p style="text-align: right; font-size: small;">09 May 2025, 09:38:50</p>			<p style="text-align: center; color: yellow; font-weight: bold;">FL-B04@3' X</p> <p style="text-align: right; font-size: small;">09 May 2025, 09:58:03</p>		
Equipment ID:		Equipment Type:	Equipment ID:		Equipment Type:
Material:	Volume:	Contents:	Material:	Volume:	Contents:
Notes/Conditions: Soil screening location.			Notes/Conditions: Soil screening location.		



Photographic Log

<p>☉ 355°N (T) ● 40°6'44"N, 104°59'46"W ±16ft ▲ 4971ft</p>			<p>☉ 220°SW (T) ● 40°6'45"N, 104°59'45"W ±16ft ▲ 4973ft</p>		
Equipment ID:		Equipment Type:	Equipment ID:		Equipment Type:
Material:	Volume:	Contents:	Material:	Volume:	Contents:
Notes/Conditions: Soil screening location.			Notes/Conditions: Soil screening location.		



Photographic Log

Equipment ID:		Equipment Type:	Equipment ID:		Equipment Type:
Material:	Volume:	Contents:	Material:	Volume:	Contents:
Notes/Conditions: Soil screening location.			Notes/Conditions: Soil screening location.		



Photographic Log

<p>NW 330 N 0 NE 30 E 60 90 SE 120</p> <p>☉ 42°NE (T) ☉ 40°6'48"N, 104°59'44"W ±13ft ▲ 4972ft</p>	<p>S 180 SW 210 W 240 NW 270 300 330</p> <p>☉ 262°W (T) ☉ 40°6'49"N, 104°59'43"W ±16ft ▲ 4964ft</p>		
<p>FL-B09@3' X</p> <p>09 May 2025, 10:39:39</p>	<p>FL-B10@3' X</p> <p>GW02 X</p> <p>09 May 2025, 10:47:31</p>		
Equipment ID:	Equipment Type:	Equipment ID:	Equipment Type:
Material:	Volume:	Contents:	Material:
Volume:	Contents:	Notes/Conditions: Soil and groundwater sampling locations.	
Notes/Conditions: Soil screening location.			



Photographic Log



Equipment ID:		Equipment Type:		Equipment ID:		Equipment Type:	
Material:	Volume:	Contents:		Material:	Volume:	Contents:	
Notes/Conditions: Soil sampling location.				Notes/Conditions:			

FIGURES

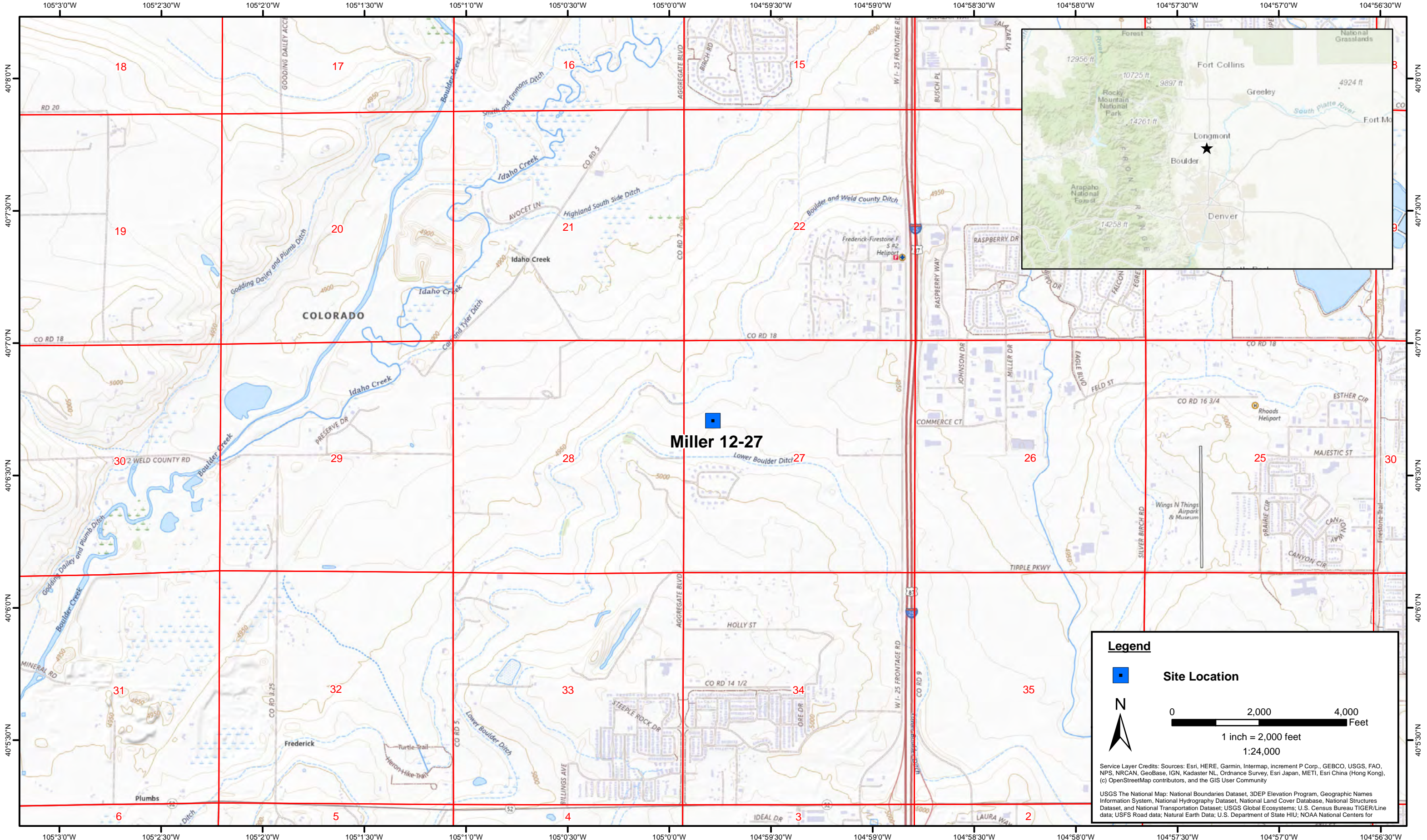

DATE: May 2025

DESIGNED BY: S. Vogt

DRAWN BY: L. Reed



Tasman, Inc.
4725 Independence St.
Wheat Ridge, CO 80033

Crestone Peak Resources Operating, LLC
Miller 12-27
SWNW Sec.27-T2N-R68W
Weld County, Colorado

Site Location Map

Figure
1



Legend

- Soil sample location – Field Screened (Collected via Trimble GPS)
- Soil sample location – Submitted for Laboratory Analysis (Collected via Trimble GPS)
- Groundwater sample location – Submitted for Laboratory Analysis (Collected via Trimble GPS)
- Excavation extent (Collected via Trimble GPS)
- Stockpile location – Submitted for Laboratory Analysis (Collected via Trimble GPS)
- Flowline Location

Notes

Crestone Peak Resources Operating, LLC site infrastructure has been removed.

All locations are approximate unless otherwise noted.

GPS = Global Positioning System

0 ft. 10 ft. 20 ft.

Image Source: Google Earth

DATE:	May 12, 2025
DESIGNED BY:	S. Vogt
DRAWN BY:	L. Molson



Tasman, Inc.
 4725 Independence St.
 Wheat Ridge, CO 80033

Crestone Peak Resources Operating, LLC
 Miller 12-27
 SWNW Sec. 27-T2N-R68W
 Weld County, Colorado

Wellhead Soil Sample
 Location Map
 (05/05/2025)

Figure
 2



Legend

- Soil sample location – Field Screened (Collected via Trimble GPS)
- Soil sample location – Submitted for Laboratory Analysis (Collected via Trimble GPS)
- Soil sample location – Submitted for Laboratory Analysis – Elevated PID Reading, HC Staining, and/or HC Odor (Collected via Trimble GPS)
- Groundwater sample location – Submitted for Laboratory Analysis (Collected via Trimble GPS)
- Excavation extent (Collected via Trimble GPS)
- Stockpile location – Submitted for Laboratory Analysis (Collected via Trimble GPS)
- Stockpile location – Submitted for Laboratory Analysis – Elevated PID Reading, HC Staining, and/or HC Odor (Collected via Trimble GPS)
- Flowline Location

Notes

Crestone Peak Resources Operating, LLC site infrastructure has been removed.

All locations are approximate unless otherwise noted.

GPS = Global Positioning System

PID = Photoionization Detector

HC = Hydrocarbon

0 ft. 10 ft. 20 ft.

Image Source: Google Earth

DATE: May 12, 2025

DESIGNED BY: S. Vogt

DRAWN BY: L. Molson



Tasman, Inc.
 4725 Independence St.
 Wheat Ridge, CO 80033

Crestone Peak Resources Operating, LLC
 Miller 12-27
 SWNW Sec. 27-T2N-R68W
 Weld County, Colorado

Flowline Soil Sample
 Location Map
 (05/05/2025 – 05/12/2025)

Figure
 3