

AUG 29 1966

OIL & GAS
CONSERVATION COMMISSION

R. 53W

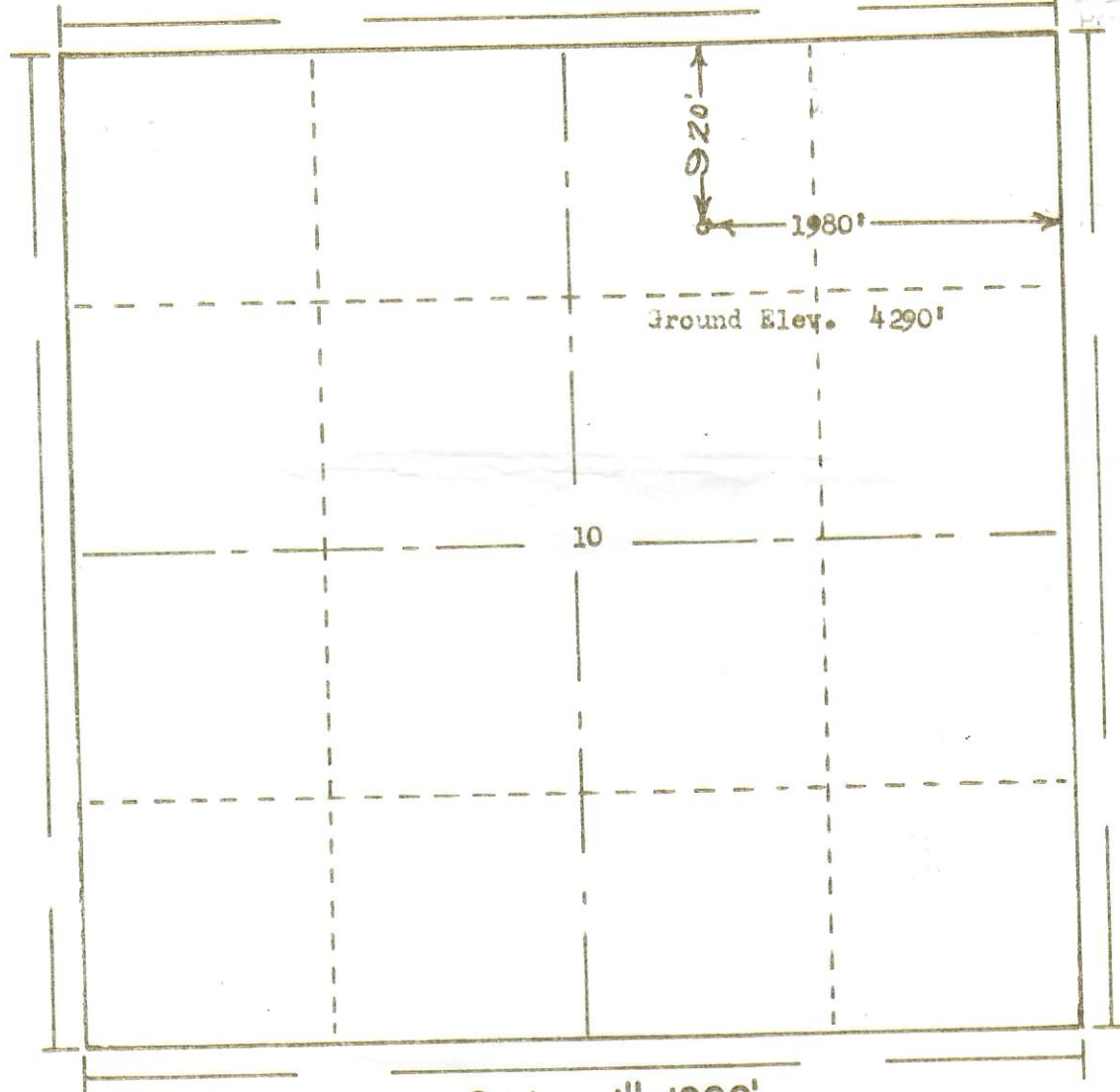

T.
10
N

Scale ... 1"=1000'

Powers Surveyors, Inc. of Denver, Colorado
has in accordance with a request from **Florence Johnston**
for **Stuareo Oil Co., Inc. et al** determined the
Location of **No. 2 Winslow Estate**
to be **920' N & 1980' E** Section 10 Township 10N
Range 53W of the 6th Principal Meridian
Logan County, Colorado

I hereby certify that this plat is an
accurate representation of a correct
survey showing the location of

Date: 8-23-66

Burr G. Holloman
Licensed Land Surveyor No. 2853
State of Colorado



00789032