

Mesquite HZ

Wildlife Habitat Map – HPHs within One Mile*

Legend

- HPH Review Area – within 1 mile of the Working Pad Surface
- Access Road
- Working Pad Surface
- Disturbance Area

*Prepared pursuant to Rule 304.b(7)C

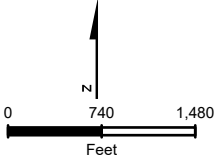
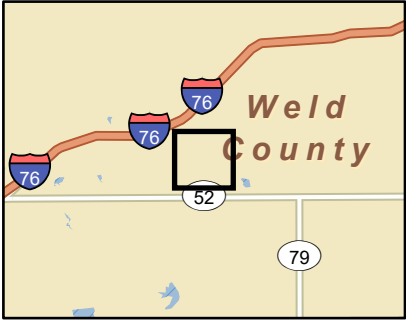

Inspector: KD
Inspection Date: 8/23/2024

Site Characteristics

Legal Location: Sec 25, T5N R68W
County: Larimer

Feature symbols not to scale

REVISED	BY	COMMENT
12/5/2024	MJW	Natural Resources Map

