



FORM F-106



00410214

RECEIVED

APR 17 1975

GOLD. OIL & GAS CONS. COMM.

R. 65W

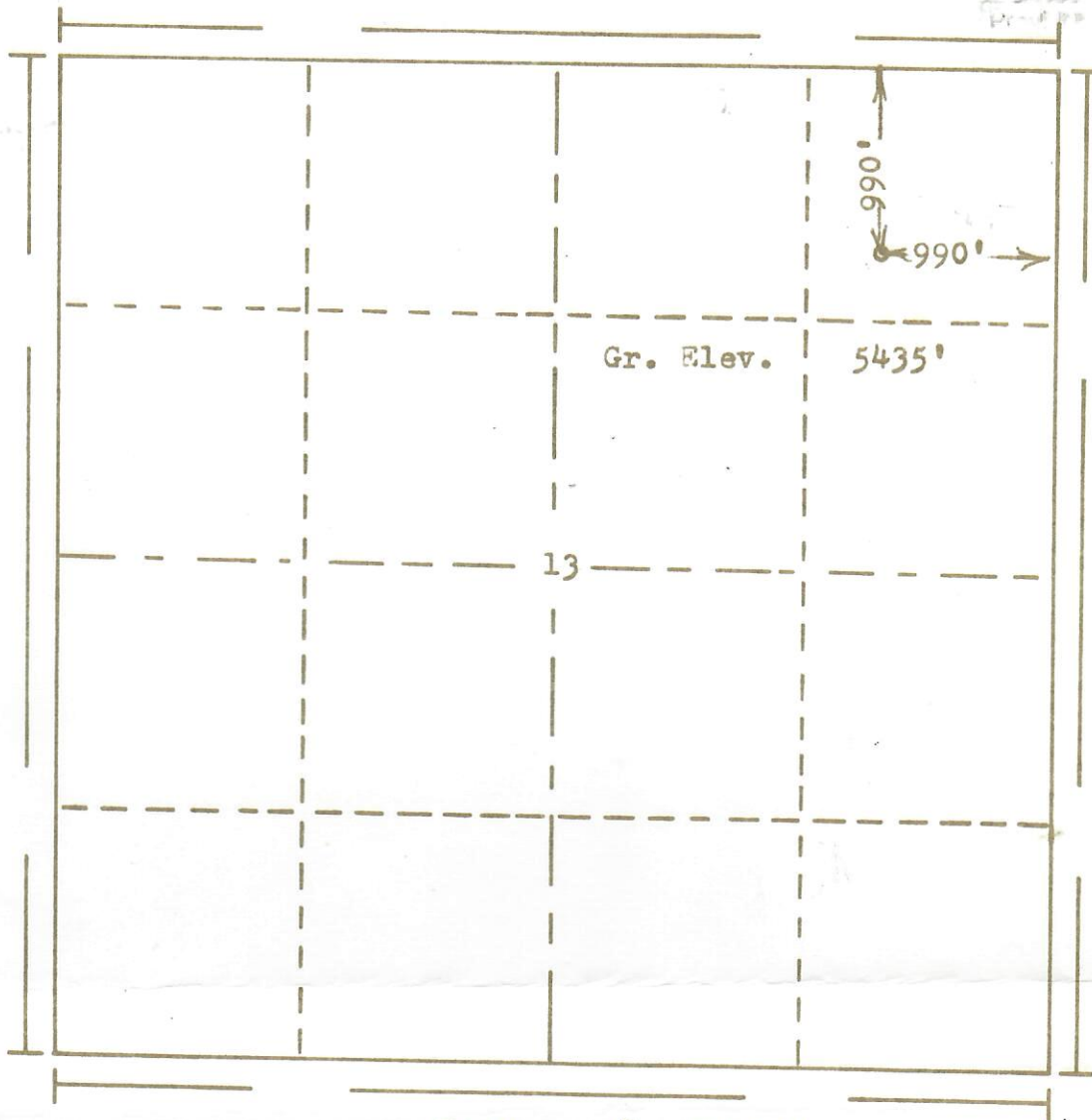

Scale... 1" = 1000'

Powers Elevation Company, Inc. of Denver, Colorado
has in accordance with a request from Sandee
for Webb Resources Inc.

determined the location of No. 13-1 Flader
to be CSW NE NE Section 13 Township 3S
Range 65W of the 6th Principal Meridian
Adams County, Colorado

75 290

I hereby certify that this plat is an
accurate representation of a correct
survey showing the location of

Date: 4-5-75

Ken D. Haden
Licensed Land Surveyor No. 2853
State of Colorado