



FORM F-106



R. 65W

AUG 13 1974

COLO. OIL &amp; GAS CONS. COMM.

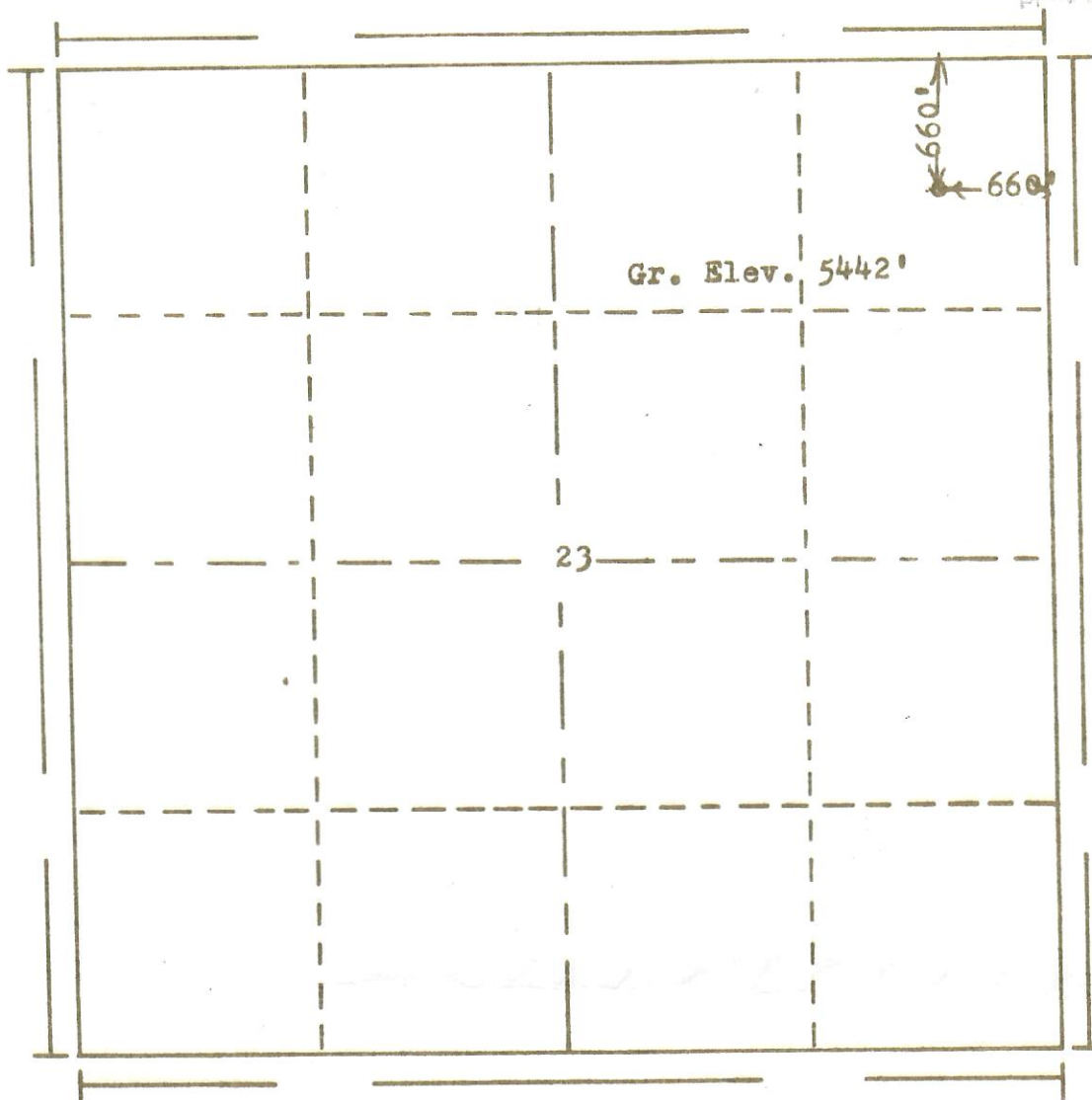

Scale... 1" = 1000'

Powers Elevation Company, Inc. of Denver, Colorado  
has in accordance with a request from Sandee  
for Webb Resources Inc.  
determined the location of No. 23-1 Jeff Drohan  
to be CNE NE Section 23 Township 39  
Range 65W of the 6th Principal Meridian  
Adams County, Colorado

I hereby certify that this plat is an  
accurate representation of a correct  
survey showing the location of

Date: 8-6-74

*Billy D. Hooley*  
Licensed Land Surveyor No. 2853  
State of Colorado