



RECEIVED

SEP 24 1975

COLO. OIL &amp; GAS CONS. COMM.

R. 65W

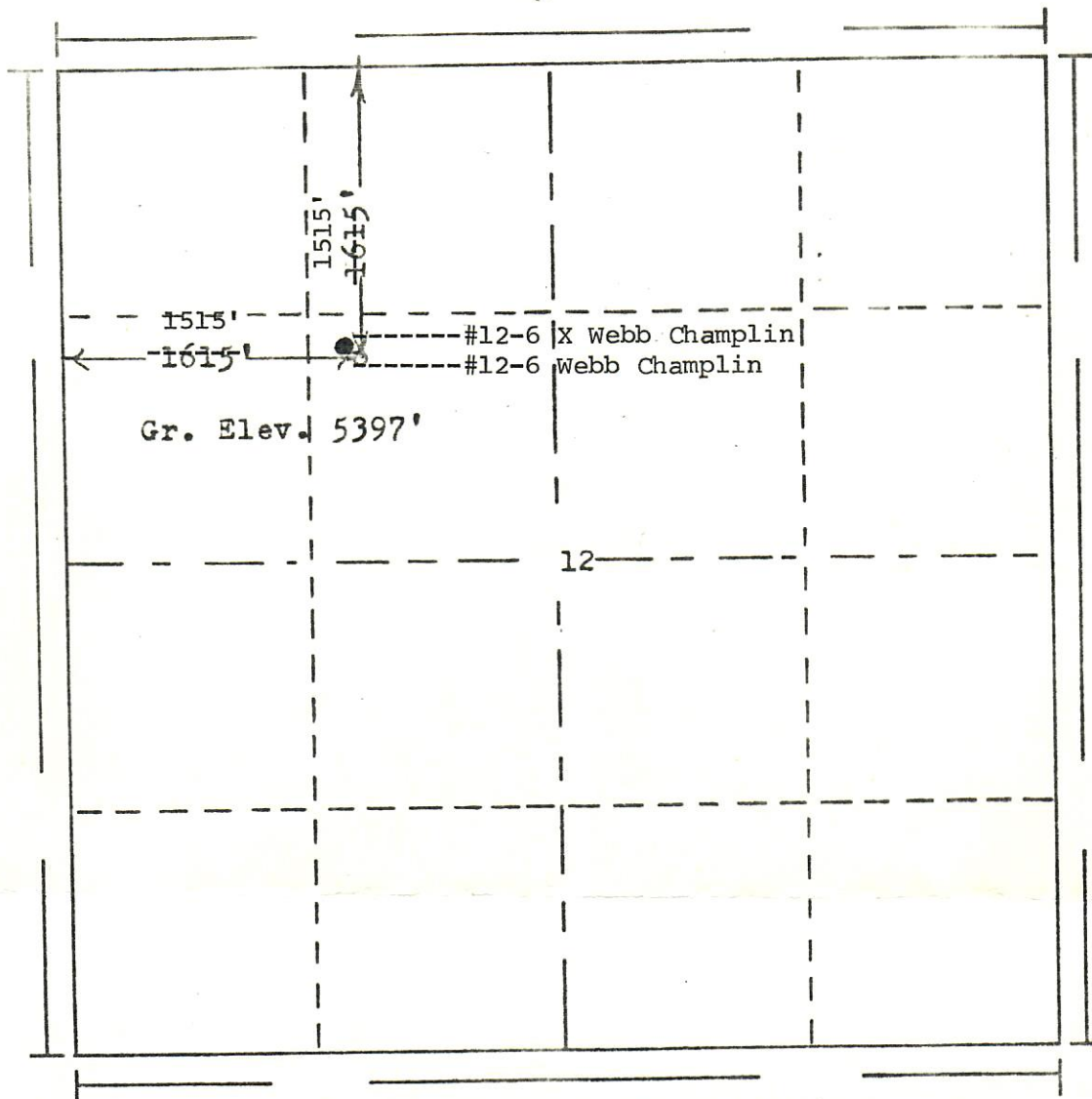
T.  
3  
S

Scale... 1" = 1000'

Powers Elevation Company, Inc. of Denver, Colorado  
has in accordance with a request from Sandee  
for Webb Resources Co.

determined the location of No. 12-6 Webb-Champlin  
to be 1515' FN & 1515' FW Section 12 Township 3S  
Range 65W of the 6th Principal Meridian  
Adams County, Colorado

75 838

I hereby certify that this plat is an  
accurate representation of a correct  
survey showing the location of

Date: 3-6-75

B. D. H. H. H.  
Licensed Land Surveyor No. 2853  
State of Colorado