

STATE OF COLORADO
OIL AND GAS CONSERVATION COMMISSION
DEPARTMENT OF NATURAL RESOURCES

RECEIVED

OCT 11 1983



APPLICATION
FOR PERMIT TO DRILL, DEEPEN, OR RE-ENTER AND OPERATE

5. LEASE DESIGNATION AND SERIAL NO.

FEE

6. IF INDIAN, ALLOTTEE OR TRIBE NAME

7. UNIT AGREEMENT NAME

8. FARM OR LEASE NAME

Bass Box Elder Farms

9. WELL NO.

6-32

10. FIELD AND POOL, OR WILDCAT

wildcat

11. SEC., T., R., M., OR BLK.
AND SURVEY OR AREA

6, T-3S, R-65W

12. COUNTY

Adams

13. STATE

Colorado

1a. TYPE OF WORK

DRILL DEEPEN RE-ENTER

b. TYPE OF WELL

OIL WELL GAS WELL OTHER SINGLE ZONE MULTIPLE ZONE

2. NAME OF OPERATOR

BASS ENTERPRISES PRODUCTION CO.
A DIVISION OF BASS BROTHERS ENTERPRISES, INC.

PHONE NO.

3. ADDRESS OF OPERATOR

1512 Larimer St., Ste 1000, Denver, CO 80202

4. LOCATION OF WELL (Report location clearly and in accordance with any State requirements.)

At surface

SWSE 651' FSL, 1956 FEL, Sec. 6, T-3S, R-65W

SW SE

At proposed prod. zone
Same

14. DISTANCE IN MILES AND DIRECTION FROM NEAREST TOWN OR POST OFFICE

6 miles NW of Watkins Colorado

15. DISTANCE FROM PROPOSED LOCATION TO NEAREST PROPERTY OR LEASE LINE, FT.
(Also to nearest drig, line, if any)

651

16. NO. OF ACRES IN LEASE*

705

17. NO. OF ACRES AND/OR DRILLING UNIT ASSIGNED TO THIS WELL

40

18. DISTANCE FROM PROPOSED LOCATION TO NEAREST WELL, DRILLING, COMPLETED, OR APPLIED FOR, ON THIS LEASE, FT.

0

19. PROPOSED DEPTH

8580

20. ROTARY OR CABLE TOOLS

Rotary

21. ELEVATIONS (Show whether DF, RT, GR, etc.)

GL 5376

FORMATION

J Sand

22. APPROX. DATE WORK WILL START

October 24, 1983

PROPOSED CASING AND CEMENTING PROGRAM

SIZE OF HOLE	SIZE OF CASING	WEIGHT PER FOOT	SETTING DEPTH	QUANTITY OF CEMENT
12-1/4	8-5/8	24#	300	220 sx
7-7/8	5-1/2	17#	8580	volume to be determined by pay zone and caliper log

24. IS SURFACE OWNER A PARTY TO LEASING AGREEMENT? YES NO

If NO, surface bond must be on file.

* DESCRIBE LEASE

Lots 1,2,3, SE 1/4, S1/2NE 1/4, SE1/4 NW1/4, Section 6, T-3S, R-65W
SE 1/4, Section 9
W1/2SW Section 10

24.

SIGNED

Kou Moor

TITLE

Asst. Production Foreman

DATE

10/5/83

(This space for Federal or State Office use)

PERMIT NO.

831274

APPROVAL DATE

OCT 17 1983

EXPIRATION DATE

FEB 14 1984

APPROVED BY

William Smith

TITLE

DIRECTOR
O & G Cons. Comm.

DATE

OCT 17 1983

CONDITIONS OF APPROVAL, IF ANY:

A.P.I. NUMBER

05 001 8328

COMPLY WITH RULE 317
(PARAGRAPHS C & K) PERTAINING
TO PROTECTION OF FRESH WATER ZONES

See Instructions On Reverse Side

RECEIVED

OCT 11 1983

COLO. OIL & GAS CONS. COMM.

R65W

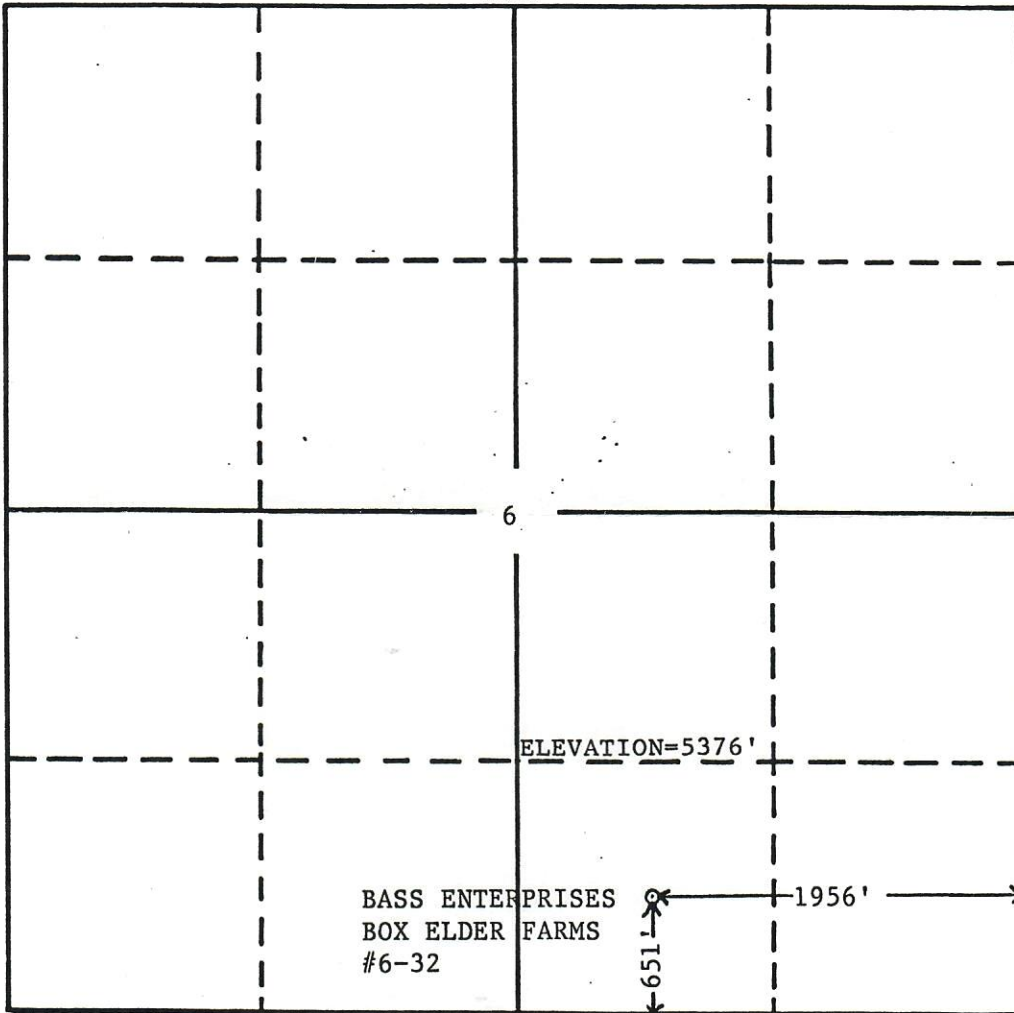

NORTH

T
3
S

ELEVATION=5376'

BASS ENTERPRISES
BOX ELDER FARMS
#6-32

1956'

651'

1"=1000'

Flatirons Surveying, in accordance with a request from BASS ENTERPRISES, has determined the location of the BOX ELDER FARMS #6-32 to be 651 FS L and 1956 FE L, in the SW 1/4 of the SE 1/4 of Section 6, T 3S, R 65W, 6TH Principal Meridian, ADAMS County, COLORADO.

Surveyor's Certificate

I, JOHN HALL, A R.L.S. in the State of COLORADO, do hereby certify that this survey was made under my direct supervision and that this plat represents said survey.



10-5-83
83-930



FLATIRONS SURVEYING
855 BROADWAY, STE. 4
BOULDER, CO 80302
(303) 443-7001