



FORM F-106

81-2262



R. 64W

RECEIVED

JAN 07 1982

COLO. OIL & GAS CONS. COMM.

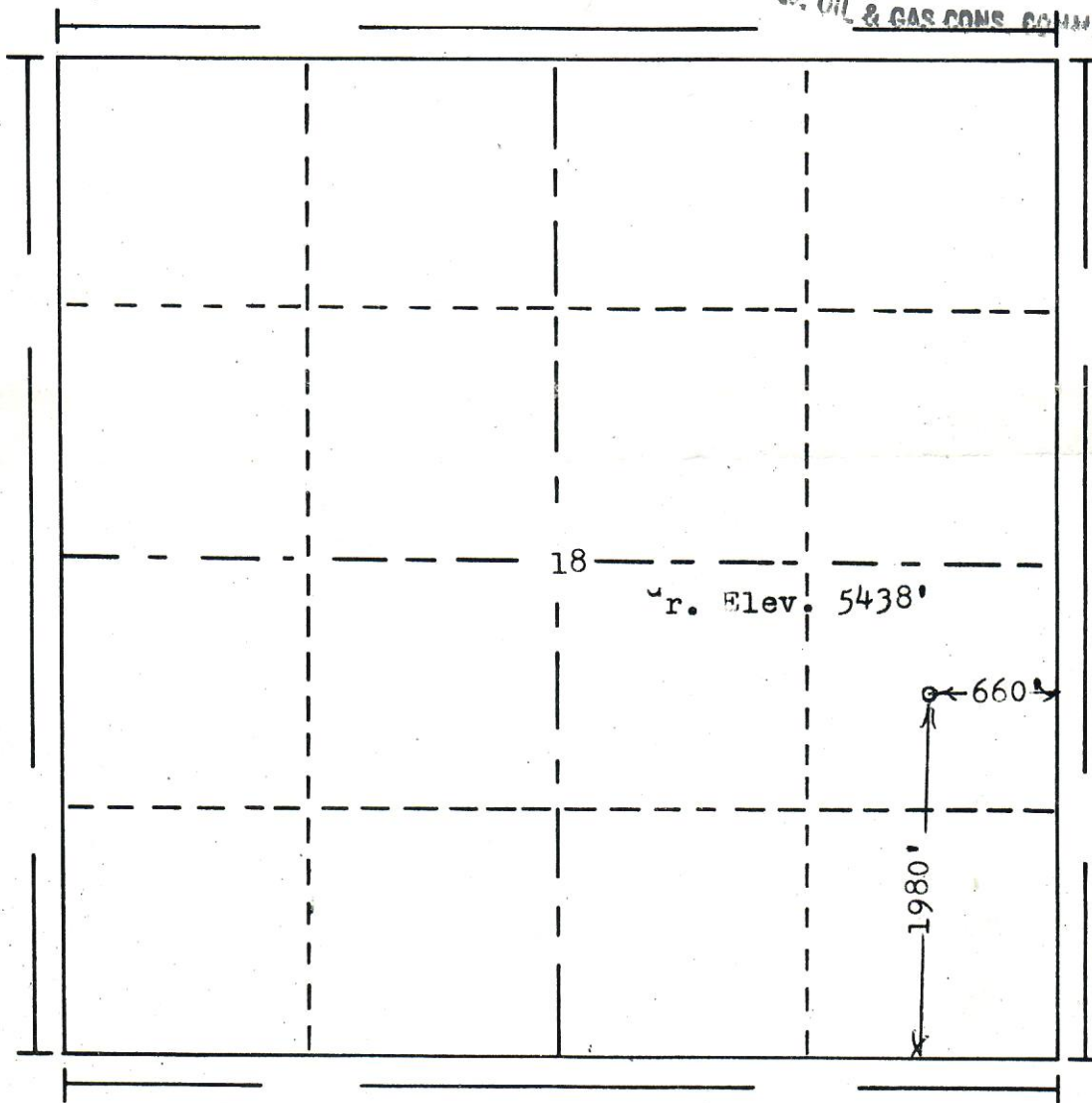
T.
3
S

Scale... 1" = 1000'

Powers Elevation of Denver, Colorado

has in accordance with a request from Mr. Danford
for Farm Ranch Exploration Corp.

determined the location of No. 1 Carlson
to be 1980' FS & 660' FE

Range 64W of the 6th Principal Meridian
Adams County, Colorado

Section 18 Township 3S

I hereby certify that this plat is an
accurate representation of a correct
survey showing the location of

Date

12-23-81

Ray H. Hoenig
Licensed Land Surveyor No. 2853
State of Colorado

