



Site Specific Final Reclamation Completion Notice – Land Use Change Drone Imagery

Permit Closure Report – Land Use Change

Location ID: 331859

Location Name: LINKUS-61N68W/24NENE

Report Date:

3/5/2025

H2E has conducted a thorough review of the data provided in this report. This report was developed in accordance with ECMC Operator Guidance – Operator supplied land use change drone imagery and information for submitting a final reclamation completion notice.

Land Use Change Type

The land use for this location has been taken over for industrial development.

Inspection:

Performed by	H2E Inc.
Date	2/26/2025

All pertinent data, imagery, and materials are included at the end of this report.

Location Checklist



Name	LINKUS-61N68W/24NENE		
Type	Wellhead		
Location ID	331859		
Operator / #	PDC ENERGY INC - 69175		
Field	WATTENBERG - #90750		
County, State	WELD, CO		
Lat/Long	40.042489 / -104.944685		
	Planned Location	X	As Drilled
Location	NENE 24 1N68W		
Location Status - Date	CL - 1/7/2020		
Facility Entities	X	Tank Battery	Pits
	X	Wells	X Off-Location Flowlines (Form 44)
		Domestic Taps	On-Location Flowlines (Form 42)
		Electric Utilities	
Equipment on Site	X	No	Yes
	If yes, list: Pit mouse/rat holes, cellars backfilled		
Access Road		Regraded	Contoured
		Culverts Removed	Gravel Removed
	X	Land Use Change	
		Pre-Existing (Must provide supporting documentation): Location and associated disturbances reclaimed	
Reclamation Status	X	Land Use Change	
		Subsidence	
		Plug date & Form 6S Doc. #: 01/02/2020 & 402298170	
Spills or Releases (Form 19)	X	No	Yes
Remediation (Form 27/27A)	X	No	Yes
On-Location Flowlines	X	No	Yes
Off-Location Flowlines		No	X Yes
Inspection Corrective Actions		No	X Yes
Variance Requests	No records found		
Sundry Notice (Form 4)	No sundry notice pertaining to series 900-1200 rules was identified.		
On Location Flowlines (Form 42)	NA		
Off-Location Flowlines (Form 44)	Form 44 Doc # & Date: #403917445 & 2/28/2020		
	Purpose: FLOWLINE SYSTEM ABANDONMENT VERIFICATION		
	Abandonment Date: 1/2/2020		
	ECMC Approval Date & Signee: 05-123-21408 Linkus 41-24 130552 Well Flowline 1/7/2020 Flushed and capped "Motocross track Prior 1105.d.(2) requirements"		
	Operator Comments:		
	Flowline Facility Information		
	ECMC Flowline ID: 471783		
	Operator Flowline ID: 267062		
	Status & Date: AC - 2/24/2020		
	Flowline Type: Wellhead line		
	Type of Fluids Transported: Produced fluids		
	Start Point Location ID: 331859		
	Start Point Riser Lat/Long: 40.042489 / -104.944685		
	Equipment at Start Point: Wellhead		
End Point Location ID: 471782			
End Point Riser Lat/Long: 40.043733, -104.946486			
Equipment at End Point: Separator			
Field Inspection Form (Form INSP)	1) 200221320 & 7/7/2009 2) 658500020 & 12/23/2011 Form INSP Doc # & Date: 3) 681901775 & 11/29/2016		
	1) Unsatisfactory 2) Satisfactory Status Summary: 3) No follow up inspection required		
	1) Tank Battery/ Well 2) Tank Battery/ Well Inspected Facilities: 3) Well		
	1) PR 2) PR Inspection Status: 3) PR		
	1) 7/7/2009 & Jim Precup 2) 12/23/2011 & Mike Hickey Inspection Date & Inspector: 3) 11/29/2016 & Gary Helgeland		
	1) PLACE BERM ON HORIZONTAL SEPARATOR / PAINT TANKS AND EQUIPMENT / CORRECTLY PLACARD TANKS 2) berms are all in place. Tanks and facilities are painted. 3) None		

Inspection Corrective Actions (CAs)	1) 200221320 - PLACE BERM ON HORIZONTAL SEPARATOR / PAINT TANKS AND EQUIPMENT / CORRECTLY PLACARD TANKS
Environmental Incidents & Remediation	<input checked="" type="checkbox"/> None <input type="checkbox"/> Spill or Release (Form 19) <input type="checkbox"/> Remediation (Form 27/27A)
Spill or Release (Form 19)	Spill/Release Facility ID: NA Status & Date: NA Form 19 Initial/Supplemental Doc # & Date: NA Date Closed: NA Date of Discovery: NA Spill Type: NA Reference Location Facility ID & Type: NA Operator: NA Operator Comments: NA Request for Closure: NA
Site Investigation and Remediation Workplan (Form 27/27A)	Remediation Project #: 14858 Form 27 Initial Doc # & Date: #402271211 - 12/26/2019 Purpose: 909.c.(1), Rule 905: Pit or PW vessel closure Notes: NA Form 27 Supplemental Docs # & Date: #402308712 - 02/11/2020 Purpose: 909.c.(1), Rule 905: Pit or PW vessel closure Operator Comments: PDC Energy is submitting a produced water vessel closure request for the Linkus 41-24 location. ECMC Comments: Based on the information presented, it appears that no further action is necessary at this time and the COGCC approves the closure request. However, should future conditions at the site indicate contaminant concentrations in soils exceeding COGCC standards or if groundwater is found to be impacted, then further investigation and/or remediation activities may be required. In addition, the surface area disturbed by the remediation activity shall be reclaimed in accordance with the 1000 Series Reclamation Rules. For locations with active ongoing oil and gas operations, comply with Rule 1003 interim reclamation requirements and for locations that will no longer have active oil and gas operations, comply with Rule 1004 Final Reclamation requirements. ECMC COAs: NA Closure Request Approved: CHRIS CANFIELD Final Resolution: 2/13/2020
COGIS Tank Facilities Information (Scout Card)	Tank Battery Name: Linkus/41-24 Location ID: 471782 Status & Date: AC - 3/12/2021 Lat/Long: 40.043665 / -104.946987 Notes: Form 4 Doc # & Date: Purpose:
COGIS Well Information (Scout Card)	Well Name: LINKUS #41-24 Facility ID: 267062 Well API #: 05-123-21408 Status & Date: PA - 1/7/2020 Lat/Long: 40.042489 / -104.944685 Notes: None Form 4 Doc # & Date: NA Purpose: NA
Drone Information	Make & Model: DJI Mavic 3M Image Processing Software: Pix4D Mapper Pilot Name & FAA Certificate #: Ian Hattabaugh - 5069217 Date of FAA Certificate Issuance: 10/4/2024



Designated Land Use Observations

The following imagery sources were reviewed during this investigation:

NAIP Imagery from 2013, 2023, and historic Google Earth imagery from 1985-2023.

Site Observation Notes

No Additional Information

Closure Information

This final reclamation completion notice is intended to close the LINKUS-61N68W/24NENE location (331859) which consists of the LINKUS #41-24 (API # 05-123-21408) wellhead. This wellhead does not share a disturbance with any other wells or tank batteries. There is one off-location flowline associated with this well that transported produced fluids to the associated tank battery, and was abandoned in January of 2020. The associated tank battery has its own location ID (471782) which will remain open until final reclamation has been achieved.

LINKUS #41-24 was plugged and abandoned in 2020. The wellhead was accessed from an unpaved access road originating from Summit Blvd. The access road was removed and the area taken over by the Chain Reaction Motorcycle School dirt bike track.

No Remediation Workplans were identified during records review.

One corrective action was identified during an inspection by Jim Precup during an inspection on 7/7/2009 (200221320). PLACE BERM ON HORIZONTAL SEPARATOR / PAINT TANKS AND EQUIPMENT / CORRECTLY PLACARD TANKS. These issues were confirmed addressed by Mike Hickey during an inspection on 12/23/2011 (658500020).

Drone imagery confirms that no equipment was left on site at this location after reclamation activities occurred.



Summary Acreage Table

Description	Acres
Historic Disturbance Extent	0.77
Access Road	0.37
Flowline	Not Included
Tank Battery	Not Included
Well Pad	0.4

Pre-Plugging Active Operations Location Overview



PDC Form 4 Final Reclamation - Pre Plugging Overview

Linkus 41-24 Pad

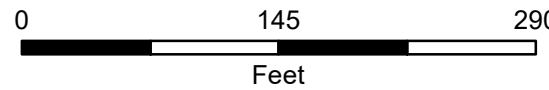
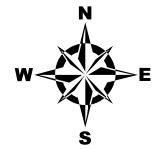

Prepared by:
Scale: 1:1,300
Date: 3/24/2025

Editor: CDenison
File: PDC_Drone_Rec_PrePlugging_DDP

- Well Head
- Former Access Road
- Former Tank Battery
- Former Well Pad
- Flowline - Abandoned

NAIP 2013 Imagery

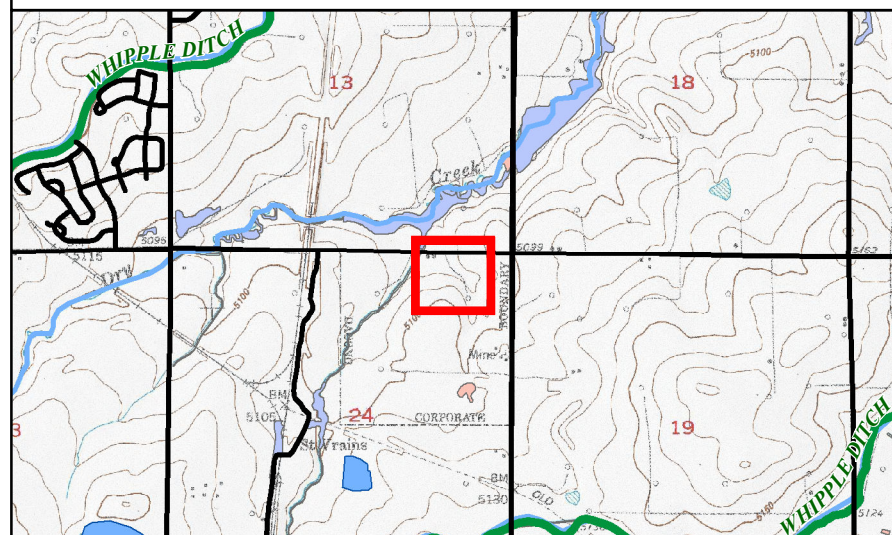

Historic Aerial Land use Map - 1984



Post-Plugging and Abandonment Location Overview



PDC Energy Form 4 Final Reclamation - Post Plugging Overview

Linkus 41-24 Pad

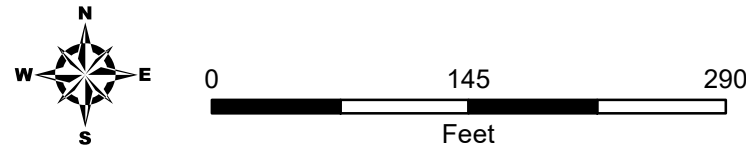

Prepared by:
Scale: 1:1,300
Date: 3/24/2025

Editor: CDenison
File: PDC_Drone_Rec_PostPlugging_DDP

- Well Head
- Former Access Road
- Former Tank Battery
- Former Well Pad
- Flowline - Abandoned
- County/Local Road
- County/Local Road

2025 Drone Imagery

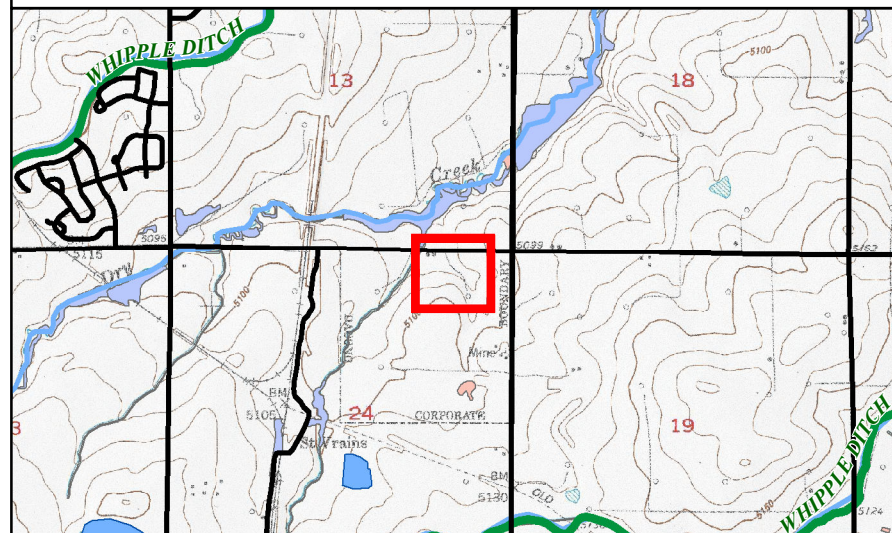

Cardinal Direction Drone Photos of the Reclaimed Area

Photo Dates:

2/26/2025

Drone Photo Height:

85'

North of Disturbance Facing South
Lat/Long: 40.04337822 / -104.94469764



South of Disturbance Facing North
Lat/Long: 40.04156806 / -104.94464425



West of Disturbance Facing East
Lat/Long: 40.04243636 / -104.94583436



East of Disturbance Facing West
Lat/Long: 40.04240781 / -104.94351108



South of Access Road facing North
Lat/Long: 40.04160753 / -104.94472850

