

Anderson MB 33-3J, 5, 6

NENW Sec. 33-T2N-R69W

Facility ID: 460731

Remediation Project #: 33505

Form 19 Data Package

December 2024

Prepared by Tasman, Inc.



On behalf of 8 North, LLC

PHOTO LOG



Photographic Log

<p>☉ 120°SE (T) ● 40°5'54"N, 105°7'35"W ±16ft ▲ 5136ft</p>			<p>☉ 295°NW (T) ● 40°5'54"N, 105°7'35"W ±16ft ▲ 5138ft</p>		
<p>AST-B01@3' X</p> <p>20 Dec 2024, 16:52:45</p>			<p>PWV-W01@4' X</p> <p>PWV-S01@4' X</p> <p>PWV-B01@5' X</p> <p>PWV-N01@4' X</p> <p>20 Dec 2024, 16:52:32</p>		
Equipment ID:		Equipment Type:	Equipment ID:		Equipment Type:
Material:	Volume:	Contents:	Material:	Volume:	Contents:
Notes/Conditions: Soil sampling location			Notes/Conditions: Soil sampling and screening locations		



Photographic Log

<p>☉ 38°NE (T) ● 40°5'54"N, 105°7'35"W ±16ft ▲ 5139ft</p>			<p>☉ 104°E (T) ● 40°5'54"N, 105°7'34"W ±16ft ▲ 5138ft</p>				
<p>20 Dec 2024, 16:52:38</p>			<p>20 Dec 2024, 16:53:32</p>				
Equipment ID:		Equipment Type:		Equipment ID:		Equipment Type:	
Material:	Volume:	Contents:		Material:	Volume:	Contents:	
Notes/Conditions: Soil sampling and screening locations				Notes/Conditions: Soil sampling locations			

FIGURES

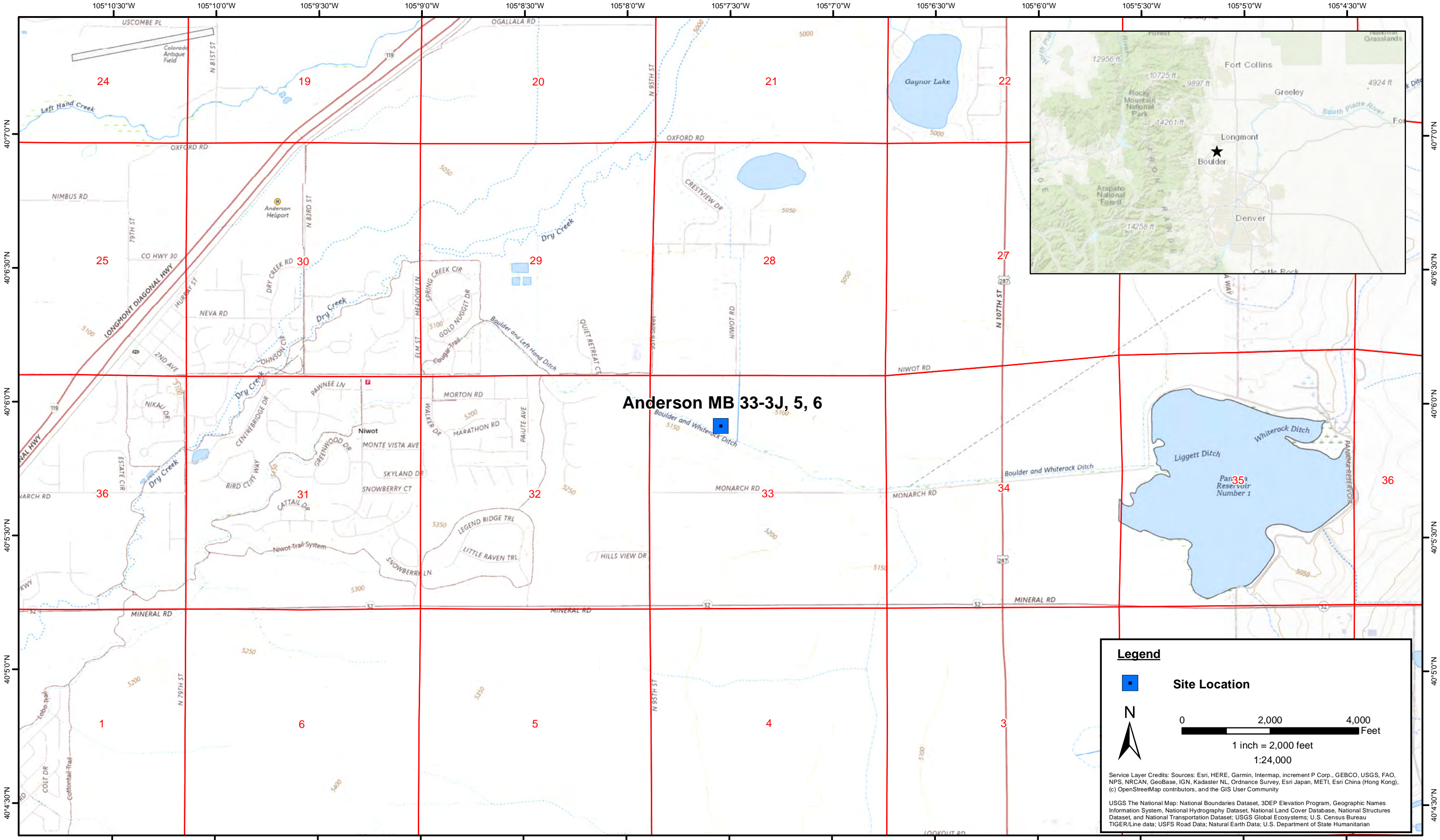

DATE:	February 2025
DESIGNED BY:	S. Vogt
DRAWN BY:	J. Woffinden



8 North, LLC
Anderson MB 33-3J, 5, 6
 NENW Sec. 33-T2N-R69W
 Boulder County, Colorado

Site Location Map

Figure
1



Legend

- Soil sample location – Field Screened (Collected via Trimble GPS)
- Soil sample location – Below ECMC Table 915-1 Soil Standards (Collected via Trimble GPS)
- Soil sample location – Exceeded ECMC Table 915-1 Soil Standards (Collected via Trimble GPS)
- Excavation extent (Collected via Trimble GPS)
- Stockpile location – Below ECMC Table 915-1 Soil Standards (Collected via Trimble GPS)
- Stockpile location – Exceeded ECMC Table 915-1 Soil Standards (Collected via Trimble GPS)
- Flowline Location

Notes

8 North, LLC site infrastructure has been removed.

All locations are approximate unless otherwise noted.

GPS = Global Positioning System

ECMC = Colorado Energy & Carbon Management Commission

0 ft. 25 ft. 50 ft.

Image Source: Google Earth

DATE:	February 20, 2025
DESIGNED BY:	S. Vogt
DRAWN BY:	L. Molson



Tasman, Inc.
 6855 W119th Ave.
 Broomfield, CO 80020

8 North, LLC
 Anderson MB 33-3J, 5, 6
 NENW Sec. 33-T2N-R69W
 Boulder County, Colorado

Facility Soil Sample
 Location Map
 (12/20/2024)

Figure
 2



DATE:	February 20, 2025
DESIGNED BY:	S. Vogt
DRAWN BY:	L. Molson

 **TASMAN** Tasman, Inc.
6855 W119th Ave.
Broomfield, CO 80020

8 North, LLC
Anderson MB 33-3J, 5, 6
NENW Sec. 33-T2N-R69W
Boulder County, Colorado

Background Soil Sample
Location Map
(05/03/2024 – 12/13/2024)

Figure
3

TABLES

TABLE 1
ANDERSON MB 33-3J, 5, 6
SOIL SAMPLE LOCATIONS
8 NORTH, LLC



Soil Sample Location	Depth	Date	PID Reading (ppm)	Latitude	Longitude	GPS PDOP Value	Lab (Y/N)
AST-B01@3"	3"	12/20/2024	1.2	40.098512	-105.126504	1	Y
PWV-B01@5'	5'	12/20/2024	0.8	40.098492	-105.126456	1.6	Y
PWV-N01@4'	4'	12/20/2024	0.0	40.098501	-105.126437	1.2	N
PWV-S01@4'	4'	12/20/2024	0.2	40.098472	-105.126451	1.1	Y
PWV-E01@4'	4'	12/20/2024	0.1	40.098483	-105.126429	1.1	N
PWV-W01@4'	4'	12/20/2024	0.1	40.098494	-105.126471	1.2	N
SEP-B01@4'	4'	12/20/2024	1.3	40.098442	-105.126264	1.6	Y
SEP-B02@4'	4'	12/20/2024	0.8	40.098448	-105.126221	1.6	Y
FL-B01@3'	3'	12/20/2024	0.4	40.098496	-105.126427	1.1	Y
FL-B02@3'	3'	12/20/2024	0.8	40.098451	-105.126261	1.6	Y
SP-CS01	-	12/20/2024	0.8	40.098440	-105.126433	-	Y
SP-CS02	-	12/20/2024	1.2	40.098396	-105.126300	-	Y
BACKGROUND							
BG01@3'*	3'	05/03/2024	0.8	40.096809	-105.124388	0.9	Y
BG01@6'*	6'	05/03/2024	0.4	40.096809	-105.124388	0.9	Y
BG02@3'*	3'	05/03/2024	0.9	40.096678	-105.124299	0.9	Y
BG02@6'*	6'	05/03/2024	1.1	40.096678	-105.124299	0.9	Y
BG03@3'*	3'	05/03/2024	0.3	40.096598	-105.124456	0.9	Y
BG03@6'*	6'	05/03/2024	0.3	40.096598	-105.124456	0.9	Y
BG04@3'*	3'	05/03/2024	2.1	40.096632	-105.124559	0.9	Y
BG04@6'*	6'	05/03/2024	1.7	40.096632	-105.124559	0.9	Y
BG05@4'*	4'	07/16/2024	1.5	40.096384	-105.124632	0.9	Y
BG05@9'*	9'	07/16/2024	1.1	40.096384	-105.124632	0.9	Y
BG06@4'*	4'	07/16/2024	0.7	40.096339	-105.124807	0.9	Y
BG06@9'*	9'	07/16/2024	1.3	40.096339	-105.124807	0.9	Y
BG07@6'*	6'	12/13/2024	0.0	40.096814	-105.123743	2	Y
BG07@9'*	9'	12/13/2024	0.0	40.096814	-105.123743	2	Y
BG08@6'*	6'	12/13/2024	0.0	40.096736	-105.123780	1.3	Y
BG08@9'*	9'	12/13/2024	0.0	40.096736	-105.123780	1.3	Y
BG09@6'*	6'	12/13/2024	0.1	40.096648	-105.123779	1.3	Y
BG09@9'*	9'	12/13/2024	0.0	40.096648	-105.123779	1.3	Y
BG10@6'*	6'	12/13/2024	0.0	40.096549	-105.123852	1.1	Y
BG10@9'*	9'	12/13/2024	0.0	40.096549	-105.123852	1.1	Y
BG11@6'*	6'	12/13/2024	0.0	40.096459	-105.123975	1.1	Y
BG11@9'*	9'	12/13/2024	0.0	40.096459	-105.123975	1.1	Y

Notes:

PID = Photoionization Detector

ppm = parts per million

TABLE 1
ANDERSON MB 33-3J, 5, 6
SOIL SAMPLE LOCATIONS
8 NORTH, LLC



Soil Sample Location	Depth	Date	PID Reading (ppm)	Latitude	Longitude	GPS PDOP Value	Lab (Y/N)
----------------------	-------	------	-------------------	----------	-----------	----------------	-----------

GPS = Global Positioning System

PDOP = Position Dilution of Precision

- = Not Applicable

*Sample collected as part of Anderson MB 33-6 site assessment (REM #: 33497)

TABLE 2
ANDERSON MB 33-3J, 5, 6
SOIL ANALYTICAL DATA - VOCs
8 NORTH, LLC



Soil Sample Location	Depth	Date	Benzene (mg/kg)	Toluene (mg/kg)	Ethylbenzene (mg/kg)	Total Xylenes (mg/kg)	Naphthalene (mg/kg)	TVPH-GRO (mg/kg)	TEPH-DRO (mg/kg)	TEPH-ORO (mg/kg)	1,2,4-TMB (mg/kg)	1,3,5-TMB (mg/kg)
ECMC Organic Compounds in Soils - GSSL ⁽¹⁾			0.0026	0.69	0.78	9.9	0.0038	500			0.0081	0.0087
ECMC Organic Compounds in Soils - RSL ⁽²⁾			1.2	490	5.8	58	2	500			30	27
AST-B01@3"	3"	12/20/2024	<0.0020	<0.0050	<0.0050	<0.010	<0.0038	<0.50	<50	<50	<0.0050	<0.0050
PWV-B01@5'	5'	12/20/2024	<0.0020	<0.0050	<0.0050	<0.010	<0.0038	<0.50	<50	<50	<0.0050	<0.0050
PWV-S01@4'	4'	12/20/2024	<0.0020	<0.0050	<0.0050	<0.010	<0.0038	<0.50	<50	<50	<0.0050	<0.0050
SEP-B01@4'	4'	12/20/2024	<0.0020	<0.0050	<0.0050	<0.010	<0.0038	<0.50	<50	<50	<0.0050	<0.0050
SEP-B02@4'	4'	12/20/2024	<0.0020	<0.0050	<0.0050	<0.010	<0.0038	<0.50	<50	<50	<0.0050	<0.0050
FL-B01@3'	3'	12/20/2024	<0.0020	<0.0050	<0.0050	<0.010	<0.0038	<0.50	<50	<50	<0.0050	<0.0050
FL-B02@3'	3'	12/20/2024	<0.0020	<0.0050	<0.0050	<0.010	<0.0038	<0.50	<50	<50	<0.0050	<0.0050
SP-CS01	-	12/20/2024	<0.0020	<0.0050	<0.0050	<0.010	<0.0038	<0.50	<50	<50	<0.0050	<0.0050
SP-CS02	-	12/20/2024	<0.0020	<0.0050	<0.0050	<0.010	<0.0038	<0.50	<50	<50	<0.0050	<0.0050

Notes:

VOCs = Volatile Organic Compounds

(1) Standards for soil are taken from ECMC Table 915-1: Organic Compounds in Soils - Protection of Groundwater Soil Screening Level Concentrations (Effective January 15, 2021)

(2) Standards for soil are taken from ECMC Table 915-1: Organic Compounds in Soils - Residential Soil Screening Level Concentrations (Effective January 15, 2021)

ECMC = Colorado Energy & Carbon Management Commission

GSSL = Protection of Groundwater Screening Level

RSL = Residential Soil Screening Level

(<) = Analytical result is less than the indicated laboratory reporting limit

mg/kg = milligrams per kilogram

TVPH - GRO = Total Volatile Petroleum Hydrocarbons - Gasoline Range Organics

TEPH - DRO = Total Extractable Petroleum Hydrocarbons - Diesel Range Organics

TEPH - ORO = Total Extractable Petroleum Hydrocarbons - Oil Range Organics

1,2,4 - TMB = 1,2,4 - Trimethylbenzene

1,3,5 - TMB = 1,3,5 - Trimethylbenzene

BOLD = Analytical result is in exceedance of ECMC Table 915-1: Organic Compounds in Soils - Protection of Groundwater Soil Screening Level Concentrations

BOLD = Analytical result is in exceedance of ECMC Table 915-1: Organic Compounds in Soils - Residential Soil Screening Level Concentrations

TABLE 3
ANDERSON MB 33-3J, 5, 6
SOIL ANALYTICAL DATA - PAHs
8 NORTH, LLC



Soil Sample Location	Depth	Date	Acenaphthene (mg/kg)	Anthracene (mg/kg)	Benzo(a)A (mg/kg)	Benzo(b)F (mg/kg)	Benzo(k)F (mg/kg)	Benzo(a)P (mg/kg)	Chrysene (mg/kg)	D (a,h) A (mg/kg)	Fluoranthene (mg/kg)	Fluorene (mg/kg)	1,2,3-CD (mg/kg)	1-M (mg/kg)	2-M (mg/kg)	Pyrene (mg/kg)
ECMC Organic Compounds in Soils - GSSL ⁽¹⁾			0.55	5.8	0.011	0.3	2.9	0.24	9	0.96	8.9	0.54	0.98	0.006	0.019	1.3
ECMC Organic Compounds in Soils - RSL ⁽²⁾			360	1,800	1.1	1.1	11	0.11	110	0.11	240	240	1.1	18	24	180
AST-B01@3"	3"	12/20/2024	<0.00500	<0.00500	<0.00500	<0.00500	<0.00500	<0.00500	<0.00500	<0.00500	<0.00500	<0.00500	<0.00500	<0.00500	<0.00500	<0.00500
PWV-B01@5'	5'	12/20/2024	<0.00500	<0.00500	<0.00500	<0.00500	<0.00500	<0.00500	<0.00500	<0.00500	<0.00500	<0.00500	<0.00500	<0.00500	<0.00500	<0.00500
PWV-S01@4'	4'	12/20/2024	<0.00500	<0.00500	<0.00500	<0.00500	<0.00500	<0.00500	<0.00500	<0.00500	<0.00500	<0.00500	<0.00500	<0.00500	<0.00500	<0.00500
SEP-B01@4'	4'	12/20/2024	<0.00500	<0.00500	<0.00500	<0.00500	<0.00500	<0.00500	<0.00500	<0.00500	0.00528	<0.00500	<0.00500	<0.00500	<0.00500	<0.00500
SEP-B02@4'	4'	12/20/2024	<0.00500	<0.00500	0.0104	0.0162	0.0051	0.00852	0.0112	<0.00500	0.0126	<0.00500	<0.00500	<0.00500	<0.00500	0.0158
FL-B01@3'	3'	12/20/2024	<0.00500	<0.00500	<0.00500	<0.00500	<0.00500	<0.00500	<0.00500	<0.00500	0.00714	<0.00500	<0.00500	<0.00500	<0.00500	<0.00500
FL-B02@3'	3'	12/20/2024	<0.00500	<0.00500	0.0136	0.0126	<0.00500	0.00684	0.0132	<0.00500	0.0332	<0.00500	<0.00500	<0.00500	<0.00500	0.0335
SP-CS01	-	12/20/2024	<0.00500	<0.00500	<0.00500	<0.00500	<0.00500	<0.00500	<0.00500	<0.00500	<0.00500	<0.00500	<0.00500	<0.00500	<0.00500	<0.00500
SP-CS02	-	12/20/2024	<0.00500	<0.00500	0.0138	0.0118	<0.00500	0.00718	0.0144	<0.00500	0.0321	<0.00500	<0.00500	<0.00500	<0.00500	0.0329

Notes:
PAHs = Polycyclic Aromatic Hydrocarbons
(1) Standards for soil are taken from ECMC Table 915-1: Organic Compounds in Soils - Protection of Groundwater Soil Screening Level Concentrations (Effective January 15, 2021)
(2) Standards for soil are taken from ECMC Table 915-1: Organic Compounds in Soils - Residential Soil Screening Level Concentrations (Effective January 15, 2021)
ECMC = Colorado Energy & Carbon Management Commission
GSSL = Protection of Groundwater Screening Level
RSL = Residential Soil Screening Level
(<) = Analytical result is less than the indicated laboratory reporting limit
mg/kg = milligrams per kilogram
Benzo(a)A = Benzo(a)Anthracene
Benzo(b)F = Benzo(b)Fluoranthene
Benzo(k)F = Benzo(k)Fluoranthene
Benzo(a)P = Benzo(a)Pyrene
D (a,h) A = Dibenz(a,h)Anthracene
1,2,3-CD = Indeno(1,2,3-cd)Pyrene
1-M = 1-Methylnaphthalene
2-M = 2-Methylnaphthalene

BOLD = Analytical result is in exceedance of ECMC Table 915-1: Organic Compounds in Soils - Protection of Groundwater Soil Screening Level Concentrations

BOLD = Analytical result is in exceedance of ECMC Table 915-1: Organic Compounds in Soils - Residential Soil Screening Level Concentrations

TABLE 4
ANDERSON MB 33-3J, 5, 6
SOIL ANALYTICAL DATA - METALS
8 NORTH, LLC



Soil Sample Location	Depth	Date	Arsenic (mg/kg)	Barium (mg/kg)	Cadmium (mg/kg)	Chromium (VI) (mg/kg)	Copper (mg/kg)	Lead (mg/kg)	Nickel (mg/kg)	Selenium (mg/kg)	Silver (mg/kg)	Zinc (mg/kg)
ECMC Metals in Soils - GSSL ⁽¹⁾			0.29	82	0.38	0.00067	46	14	26	0.26	0.8	370
ECMC Metals in Soils - RSL ⁽²⁾			0.68	15,000	71	0.3	3,100	400	1,500	390	390	23,000
AST-B01@3"	3"	12/20/2024	1.11*	47.8	<0.200	<0.30	5.79	4.59	5.66	<0.260	0.0304	19.5
PWV-B01@5'	5'	12/20/2024	1.84*	97.3*	0.217	<0.30	7.87	7.90	6.61	<0.260	0.0536	27.8
PWV-S01@4'	4'	12/20/2024	1.74*	66.2	<0.200	<0.30	6.35	6.53	6.02	<0.260	0.0393	24.1
SEP-B01@4'	4'	12/20/2024	2.54*	128*	0.270	<0.30	8.18	9.90	7.61	<0.260	0.0627	28.6
SEP-B02@4'	4'	12/20/2024	2.54*	77.9	<0.200	<0.30	5.88	7.45	6.04	<0.260	0.0335	22.1
FL-B01@3'	3'	12/20/2024	1.82*	84.8*	0.245	<0.30	9.07	10.7	7.59	<0.260	0.0571	34.2
FL-B02@3'	3'	12/20/2024	2.52*	90.2*	<0.200	<0.30	6.19	7.77	6.53	<0.260	0.0474	23.9
SP-CS01	-	12/20/2024	1.80*	88.5*	<0.200	<0.30	7.75	7.80	6.84	<0.260	0.0531	27.0
SP-CS02	-	12/20/2024	2.73*	95.3*	0.334	<0.30	7.90	10.4	6.64	<0.260	0.0410	26.1
BACKGROUND												
BG01@3' **	3'	05/03/2024	4.52	130	<0.200	<0.300	9.91	9.69	11.0	0.900	<0.0865	37.2
BG01@6' **	6'	05/03/2024	5.43	155	<0.200	<0.300	12.1	12.0	12.8	1.04	<0.0865	40.1
BG02@3' **	3'	05/03/2024	12.6***	126	<0.200	<0.300	7.94	9.24	9.56	0.765	<0.0865	36.5
BG02@6' **	6'	05/03/2024	5.05	129	<0.200	<0.300	11.9	11.8	12.8	1.17	<0.0865	40.4
BG03@3' ^{EXC} **	3'	05/03/2024	4.92	251	<0.200	<0.300	15.7	11.8	12.3	0.952	<0.0865	50.7
BG03@6' ^{EXC} **	6'	05/03/2024	4.34	149	<0.200	<0.300	8.88	8.81	9.39	0.806	<0.0865	46.6
BG04@3' ^{EXC} **	3'	05/03/2024	5.45	95.1	<0.200	<0.300	10.3	8.48	10.1	0.884	<0.0865	40.4
BG04@6' ^{EXC} **	6'	05/03/2024	5.38	109	<0.200	<0.300	7.85	7.77	9.65	0.573	<0.0865	33.1
BG05@4' **	4'	07/16/2024	7.5	165	0.18	<0.300	15.4	12.3	15.2	0.44	<0.20	49.2
BG05@9' **	9'	07/16/2024	6.5	174	0.19	<0.300	21.5	14.1	15.4	0.43	<0.19	62.7
BG06@4' **	4'	07/16/2024	8.4	125	0.13	<0.300	18.8	12.9	13.2	0.32	<0.19	58.1
BG06@9' **	9'	07/16/2024	6.3	248	0.20	<0.300	17.4	12.1	15.0	0.40	<0.19	55.8

TABLE 4
ANDERSON MB 33-3J, 5, 6
SOIL ANALYTICAL DATA - METALS
8 NORTH, LLC



Soil Sample Location	Depth	Date	Arsenic (mg/kg)	Barium (mg/kg)	Cadmium (mg/kg)	Chromium (VI) (mg/kg)	Copper (mg/kg)	Lead (mg/kg)	Nickel (mg/kg)	Selenium (mg/kg)	Silver (mg/kg)	Zinc (mg/kg)
ECMC Metals in Soils - GSSL ⁽¹⁾			0.29	82	0.38	0.00067	46	14	26	0.26	0.8	370
ECMC Metals in Soils - RSL ⁽²⁾			0.68	15,000	71	0.3	3,100	400	1,500	390	390	23,000
BG07@6'***	6'	12/13/2024	3.74	101	<0.200	<0.30	5.76	7.81	5.79	<0.260	0.0345	20.9
BG07@9'***	9'	12/13/2024	7.73	74.1	<0.200	<0.30	5.73	10.6	6.93	<0.260	0.0200	24.6
BG08@6'***	6'	12/13/2024	7.48	62.0	<0.200	<0.30	5.86	9.29	6.42	<0.260	0.0331	24.6
BG08@9'***	9'	12/13/2024	5.25	341	0.204	<0.30	6.40	10.2	6.79	<0.260	0.0367	26.1
BG09@6'***	6'	12/13/2024	4.44	116	0.227	<0.30	4.76	7.07	6.16	<0.260	0.0391	20.2
BG09@9'***	9'	12/13/2024	11.1***	29.1	0.350	<0.30	13.1	24.1***	6.01	0.317	0.105	35.6
BG10@6'***	6'	12/13/2024	4.78	64.3	<0.200	<0.30	4.41	6.91	5.26	<0.260	0.0269	21.5
BG10@9'***	9'	12/13/2024	5.65	151	0.255	<0.30	5.74	9.23	6.32	<0.260	0.0408	23.9
BG11@6'***	6'	12/13/2024	4.58	79.7	<0.200	<0.30	5.76	9.10	8.03	<0.260	0.0506	23.5
BG11@9'***	9'	12/13/2024	6.96	73.5	0.397	<0.30	12.7	17.8	6.65	<0.260	0.0774	35.0
Highest Background @ 0 - 9' x1.25 (Loam)			10.5	426	0.496	-	26.9	22.3	19.3	1.46	0.131	78.4

Notes:

(1) Standards for soil are taken from ECMC Table 915-1: Metals in Soils - Protection of Groundwater Soil Screening Level Concentrations (Effective January 15, 2021)

(2) Standards for soil are taken from ECMC Table 915-1: Metals in Soils - Residential Soil Screening Level Concentrations (Effective January 15, 2021)

ECMC = Colorado Energy & Carbon Management Commission

GSSL = Protection of Groundwater Screening Level

Loam = similar to equal parts of sand, silt, and clay.

RSL = Residential Soil Screening Level

(<) = Analytical result is less than the indicated laboratory minimum detection limit

mg/kg = milligrams per kilogram

BOLD = Analytical result is in exceedance of ECMC Table 915-1: Metals in Soils - Protection of Groundwater Soil Screening Level Concentrations

BOLD = Analytical result is in exceedance of ECMC Table 915-1: Metals in Soils - Residential Soil Screening Level Concentrations

Highest background concentration x1.25

Italics = Laboratory minimum detection limit exceeds the ECMC Table 915-1 Standard

* Result exceeded the ECMC Table 915-1 standard, but was within site-specific 1.25x background multiplier levels

**Sample collected as part of Anderson MB 33-6 site assessment (REM #: 33497)

***Result is considered anomalously high and not considered for site-specific background concentration

^{EXC} = Background location not considered for site-specific background comparison due to proximity to Anderson MB 33-6 wellhead excavation

TABLE 5
ANDERSON MB 33-3J, 5, 6
SOIL ANALYTICAL DATA - SOIL RECLAMATION
8 NORTH, LLC



Soil Sample Location	Depth	Date	pH	SAR	EC (mmhos/cm)	Boron (mg/L)
ECMC Soil Suitability for Reclamation⁽¹⁾			6 - 8.3	< 6	< 4	2
AST-B01@3"	3"	12/20/2024	8.63*	0.242	0.154	<2.00
PWV-B01@5'	5'	12/20/2024	8.45*	0.131	0.154	<2.00
PWV-S01@4'	4'	12/20/2024	8.63*	0.114	0.118	<2.00
SEP-B01@4'	4'	12/20/2024	8.92*	0.0424	0.0922	<2.00
SEP-B02@4'	4'	12/20/2024	8.82*	0.143	0.109	<2.00
FL-B01@3'	3'	12/20/2024	8.74*	0.454	0.161	<2.00
FL-B02@3'	3'	12/20/2024	8.81*	0.0508	0.108	<2.00
SP-CS01	-	12/20/2024	8.56*	0.128	0.146	<2.00
SP-CS02	-	12/20/2024	8.79*	0.0847	0.112	<2.00
BACKGROUND						
BG01@3'**	3'	05/03/2024	8.75	0.759	0.209	<2.00
BG01@6'**	6'	05/03/2024	8.29	0.275	0.172	<2.00
BG02@3'**	3'	05/03/2024	9.19	2.99	0.242	<2.00
BG02@6'**	6'	05/03/2024	8.35	0.815	0.196	<2.00
BG03@3' ^{EXC} **	3'	05/03/2024	9.41	9.45	0.526	<2.00
BG03@6' ^{EXC} **	6'	05/03/2024	8.62	1.87	0.238	<2.00
BG04@3' ^{EXC} **	3'	05/03/2024	9.35	4.46	0.303	<2.00
BG04@6' ^{EXC} **	6'	05/03/2024	9.03	0.761	0.207	<2.00
BG05@4'**	4'	07/16/2024	7.86	0.15	0.301	0.33
BG05@9'**	9'	07/16/2024	8.79	4.8	0.835	1.9
BG06@4'**	4'	07/16/2024	8.65	0.77	0.537	0.54
BG06@9'**	9'	07/16/2024	8.32	3.5	0.662	0.58
BG07@6'**	6'	12/13/2024	8.36	0.106	0.140	<2.00
BG07@9'**	9'	12/13/2024	9.77	0.418	0.497	<2.00
BG08@6'**	6'	12/13/2024	9.55	0.221	0.405	<2.00
BG08@9'**	9'	12/13/2024	9.04	7.79	0.855	<2.00
BG09@6'**	6'	12/13/2024	9.25	0.703	0.207	<2.00
BG09@9'**	9'	12/13/2024	8.92	6.65	0.940	<2.00
BG10@6'**	6'	12/13/2024	9.32	1.45	0.219	<2.00

TABLE 5
ANDERSON MB 33-3J, 5, 6
SOIL ANALYTICAL DATA - SOIL RECLAMATION
8 NORTH, LLC



Soil Sample Location	Depth	Date	pH	SAR	EC (mmhos/cm)	Boron (mg/L)
ECMC Soil Suitability for Reclamation⁽¹⁾			6 - 8.3	< 6	< 4	2
BG10@9'**	9'	12/13/2024	9.48	0.314	0.451	<2.00
BG11@6'**	6'	12/13/2024	8.82	0.856	0.230	<2.00
BG11@9'**	9'	12/13/2024	9.61	8.89	0.584	<2.00
Highest Background @ 0 - 9' (Loam)			9.77	8.89	0.940	1.9

Notes:

(1) Standards for soil are taken from ECMC Table 915-1: Soil Suitability for Reclamation (Effective January 15, 2021)

ECMC = Colorado Energy & Carbon Management Commission

(<) = Analytical result is less than the indicated laboratory reporting limit

Loam = similar to equal parts of sand, silt, and clay.

mmhos/cm = millimhos per centimeter

mg/L = milligrams per liter

pH = Potential of Hydrogen

SAR = Sodium Adsorption Ratio

EC = Electrical Conductivity

BOLD = Analytical result is in exceedance of ECMC Table 915-1: Soil Suitability for Reclamation Concentrations

Highest background concentration

* Result exceeded the ECMCC Table 915-1 standard, but was within site-specific background concentrations

**Sample collected as part of Anderson MB 33-6 site assessment (REM #: 33497)

^{EXC} = Background location not considered for site-specific background comparison due to proximity to Anderson MB 33-6 wellhead excavation