



GL01R-W@4'
(06/28/2024)

PID = 1.9 ppm

FL01R-W@4'
(06/28/2024)

PID = 1.7 ppm



GL01R-01@5'
(06/28/2024)

PID = 2.7 ppm

FL01R-S@4'
(06/28/2024)

PID = 2.5 ppm

Legend

-  Proposed Soil Sample Location
-  Soil Sample Location – No Organic Exceedances (Collected via Trimble GPS)

Notes

- 1) All locations are approximate unless otherwise noted.
- 2) Buried infrastructure has been spatially projected.
- 3) Color coded sample exceedances are in reference to ECMC Table 915-1 Organic Compounds in Soil.

GPS – Global Positioning System
 mg/kg – Milligrams per kilogram
 PID – Photoionization Detector
 ppm – Parts per million
 GSSL – Protection of Groundwater Soil Screening Levels
 RSSLs – Residential Soil Screening Levels

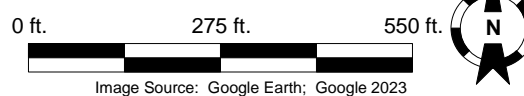

Image Source: Google Earth; Google 2023

DATE:	7/08/2024
DESIGNED BY:	JW
DRAWN BY:	LR



TASMAN Tasman, Inc.
 6855 W 119th Avenue
 Broomfield, CO 80020

**Noble Energy, Inc. (100322) – DJ Basin
 Wells Ranch AA35-69-1HNB**
 NWNW, Section 36, Township 6 North, Range 63 West
 Weld County, Colorado

Proposed Soil Sample
 Location Map
 (11/11/2024)

FIGURE
 1